

M. E. W. Enterprise

Dekalb #3

Chaves County, NM

Proposed Wellpath

Kickoff Point

M. Depth	=	830	N/S / Cord.	=	0
TVD	=	830	E/W Cord.	=	0
Inclination	=	0			
Azimuth	=	S55E			

Measured Depth	Inclination Degree	Drift Direction	Course Length	TVD	Vertical Section	Rectangular	off-sets	DLS deg/100'
830.00'	0.0	N-O-E	830.00'	830.00'	0	ON	OE	0
884.98'	90.00	S55.00E	54.98'	865.00'	35.00'	20.08S	28.67E	163.7
984.98'	100.00	S55.00E	100.00'	856.00'	134.49'	77.14S	110.17E	10.0
1084.98'	90.00	S55.00E	100.00'	847.59'	233.99'	134.21S	191.67E	10.0
1350.98'	90.00	S55.00E	266.00'	847.59'	499.99'	286.78S	409.56E	0.0

M. E. W. Enterprise

Horizontal Drilling Prognosis

Dekalb #3 - Chaves County, NM

1. MIRU WSU
2. POOH w/Rods, Pump, & Tbg.
3. TIH w/2 3/8" Workstring, Bit & Scraper
4. Circulate out hole to Plug Back Total Depth.
5. POOH w/Workstring, Bit & Scraper.
6. TIH w/2 3/8" Workstring/Spot Cmt Plug.
7. TOH w/2 3/8" Workstring.
8. Move out Tanks, Pumping Unit & all Equipment.
9. MIRU Reverse Unit.
10. TIH w/Bit & 2 3/8" Workstring
11. Dress off Cement to 830'.
12. Circulate hole clean.
13. POOH w/Bit & Workstring
14. MIRU Gyro Service.
15. Run Gyro to Determined Hole Direction.
16. POOH Rig Down Gyro.
17. MIRU VHV Directional Equipment.
18. TIH w/Pilot Hole Assembly.
19. Drill Pilot Hole from 820' to 830'.
20. POOH w/ Pilot Hole Assembly.
21. TIH w/Curve Drilling Assembly (CDA) and three Joints of composite drill pipe to 800'.
22. Hook up Power Swivel and Mud Pump.
23. Break Circulation - Ease CDA into hole at 825'.
24. Function test CDA.
25. RU Gyro for Orientation.
26. RIH w/Gyro and string into mule shoe.
27. Orient tool face to South 55 Degrees East.
28. POOH w/Gyro.
29. Commence drilling curve in one foot increments with CDA, re-alignment at end of each foot.
30. Drill approximately 30' to 860' MD.
31. Circulate bottoms up (a viscous pill is an excellent marker for bottoms up).
32. Run inclination survey pulling one foot stations.
33. Drill to 880' MD.
34. Circulate bottoms up.
35. Run inclination survey and tie into last 15' of first survey. Establish average build rate.
36. Drill remainder of curve (approximately 5') to 885' and an inclination of 90 degrees.
37. Circulate bottoms up.
38. Run third and final survey of curve and tie into second survey.
39. POOH w/CDA (swivel out of curve).
40. TIH w/Lateral Drilling Assembly (LDA) and 600' of composite pipe to bottom of curve at 885'.
41. Hook up swivel and mud pump.
42. Hook up pump and swivel Commence drilling lateral.
43. Drill +/- 500' of lateral to approximately 1335' MD and 84 1/2° TVD, Surveying every 100' and maintaining build rate of 1 degree per 100' to ending inclination of 95 degrees.
44. TOOH w/LDA (swivel out until LDA is at top of curve).
45. Rig down VHV directional equipment and move out.
46. RIH w/2 3/8" Workstring w/Packer and 1 1/2 Tail-Pipe.
47. Set Packer
48. Test backside to 500# PSI.
49. Swab test well, Swab Until fluid entry is clean.
50. MIRU Acid Company.
51. Acidize well as to recommendation.
52. RD Acid Company.
53. Swab Test Well.
54. POOH w/Packer and Workstring.
55. RIH w/Production Tbg, Rods & Pump.
56. Move in and reset Pumping Unit.
57. Space out.
58. RD WSU and move out.
59. Return Well To Producing.

Dekalb Federal #3
Vertical View
Vertical Section Plain - S55E

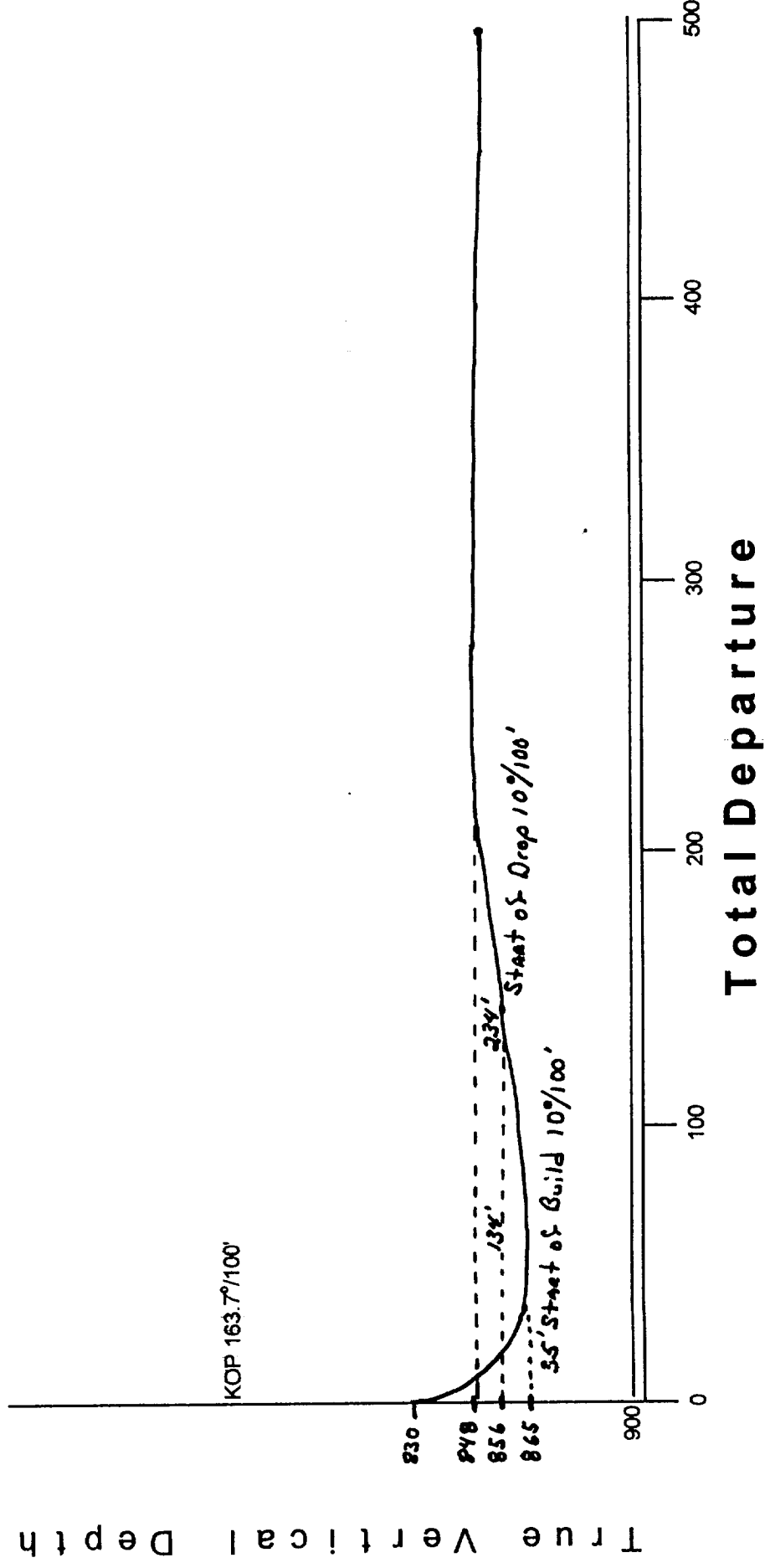

NEW MEXICO OIL CONSERVATION COMMISSION
WELL LOCATION AND ACREAGE DEDICATION PLAT

FORM C-128
 Revised 5/1/57

SEE INSTRUCTIONS FOR COMPLETING THIS FORM ON THE REVERSE SIDE

SECTION A

Operator J.F. McAdams			Lease DeKalb Federal		Well No. 3
Unit Letter E	Section 27	Township 10 South	Range 25 East	County Chaves County	
Actual Footage Location of Well: 1980 feet from the North line and 660 feet from the West line					
Ground Level Elev. 3474.5	Producing Formation		Pool	Dedicated Acreage: 40 Acres	

1. Is the Operator the only owner in the dedicated acreage outlined on the plat below? YES _____ NO _____. ("Owner" means the person who has the right to drill into and to produce from any pool and to appropriate the production either for himself or for himself and another. (65-3-29 (e) NMSA 1935 Comp.)
2. If the answer to question one is "no," have the interests of all the owners been consolidated by communitization agreement or otherwise? YES _____ NO _____. If answer is "yes," Type of Consolidation _____
3. If the answer to question two is "no," list all the owners and their respective interests below:

Owner	Land Description

SECTION B

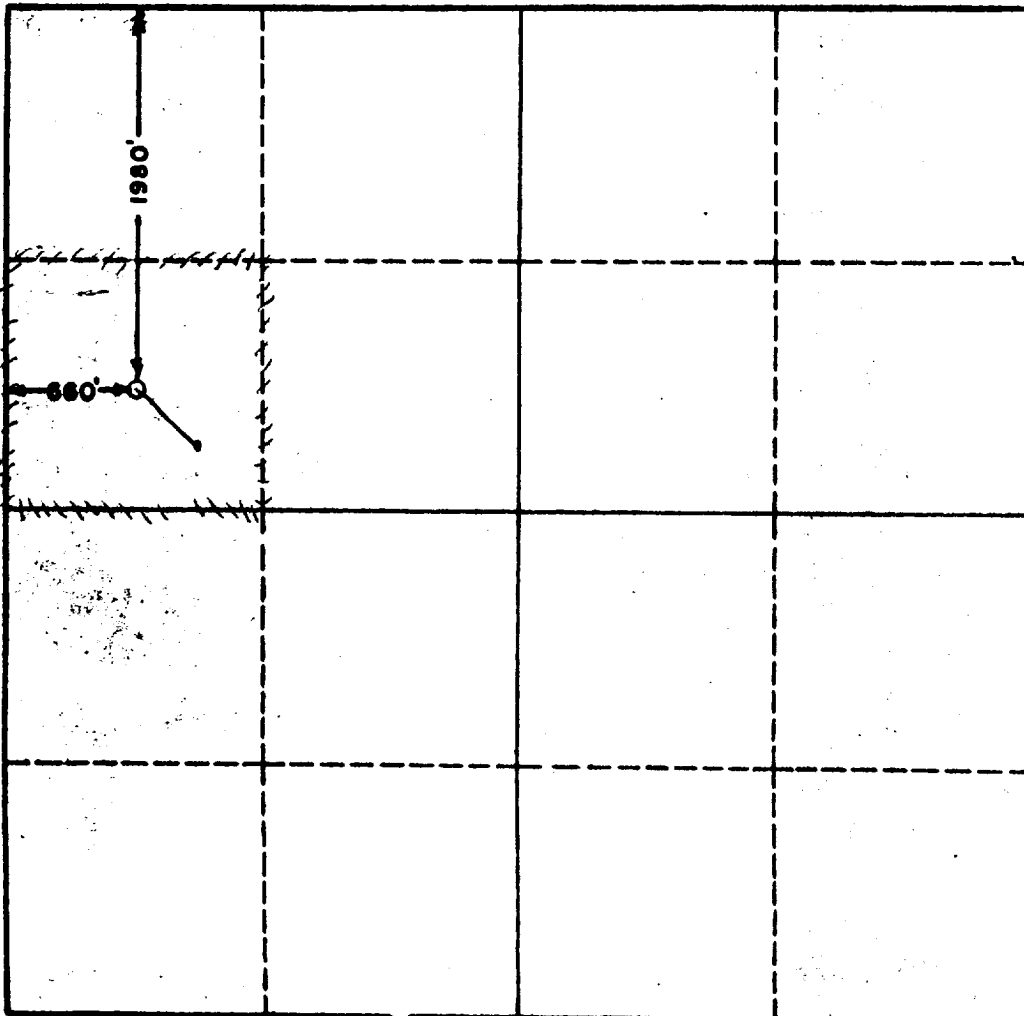

CERTIFICATION

I hereby certify that the information in SECTION A above is true and complete to the best of my knowledge and belief.

Name
Position
Company
Date

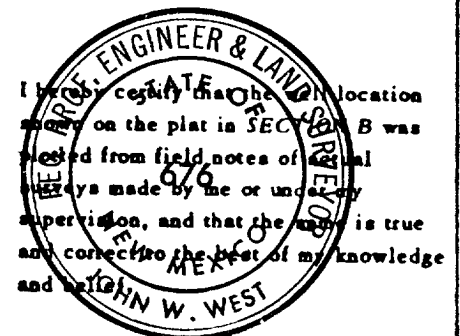

Date Surveyed 6-28-60
Registered Professional Engineer and/or Land Surveyor, JOHN W. WEST
Certificate No. N.M. - P.E. & L.S. NO. 676

0 330 660 990 1320 1650 1980 2310 2640 2000 1500 1000 500 0