

NEW MEXICO OIL CONSERVATION COMMISSION
Santa Fe, New Mexico

RECEIVED
(Form C-101)
(Revised 7/1/52)

NOTICE OF INTENTION TO DRILL OR RECOMPLETE

Notice must be given to the District Office of the Oil Conservation Commission and approval obtained before drilling or recompletion begins. If changes in the proposed plan are considered advisable, a copy of this notice showing such changes will be returned to the sender. Submit this notice in QUINTUPPLICATE. One copy will be returned following approval. See additional instructions in Rules and Regulations of the Commission.

Artesia, New Mexico

April 12, 1960

(Place)

(Date)

OIL CONSERVATION COMMISSION
SANTA FE, NEW MEXICO

Gentlemen:

You are hereby notified that it is our intention to commence the (Drilling) (~~Recompletion~~) of a well to be known as

J. F. Mc Adams - Etal.

(Company or Operator)

Mary Ann Cannon

(Lease)

Well No. 1, in K The well is

located 1980 feet from the West line and 1980 feet from the

South line of Section 27, T. 10 S, R. 25, NMPM.

(GIVE LOCATION FROM SECTION LINE) Pool, Chaves County

If State Land the Oil and Gas Lease is No.

If patented land the owner is Mary Ann Cannon - Est.

Address 1000 S. Kentuckey, Roswell, New Mexico

We propose to drill well with drilling equipment as follows: Rotary

The status of plugging bond is.

Drilling Contractor Steinburger Drilling Co.

We intend to complete this well in the San Andrea

formation at an approximate depth of 910 feet.

CASING PROGRAM

We propose to use the following strings of Casing and to cement them as indicated:

Size of Hole	Size of Casing	Weight per Foot	New or Second Hand	Depth	Sacks Cement
9 5/8	7"	24	SH.	700	Circulate
6 1/4	4 1/2"	11.60	New	915	50

If changes in the above plans become advisable we will notify you immediately.

ADDITIONAL INFORMATION (If recompletion give full details of proposed plan of work.)

Approved APR 21 1960, 19.....
Except as follows:

OIL CONSERVATION COMMISSION

By M. L. Armstrong
Title DISTRICT INSPECTOR

Sincerely yours,

J. F. McAdams - Etal.

(Company or Operator)

By

Position

owner operator
Send Communications regarding well to

Name J. F. McAdams

Address Box 1716
Hobbs, New Mexico

CIL CONSERVATION COMMISSION
ARIZONA DISTRICT OFFICE

By Order Received

DISTRIBUTION

	NO. FURNISHED	
ADMINISTRATOR		
MANAGER		
REGISTRATION OFFICE		
STATE LAND OFFICE		
U.S. G. S.		
TRANSPORTER		
WEE		
ADDITIONAL OFFICES		

RECEIVED

RECEIVED

NEW MEXICO OIL CONSERVATION COMMISSION

WELL LOCATION AND ACREAGE DEDICATION PLAT

FORM C-128
Revised 5/1/57

APR 18 1960

SEE INSTRUCTIONS FOR COMPLETING THIS FORM ON THE REVERSE SIDE.

SECTION A

Operator <i>J. S. McAdams et al</i>		Lease <i>Mary Ann Cannon</i>		Well No. <i>1</i>
Unit Letter <i>K</i>	Section <i>27</i>	Township <i>10</i>	Range <i>25</i>	County <i>Chavez</i>
Actual Footage Location of Well: feet from the _____ line and _____ feet from the _____ line				
Ground Level Elev. <i>23488</i>	Producing Formation <i>SA.</i>	Pool <i>Wildcat</i>	Dedicated Acreage: Acres	

1. Is the Operator the only owner in the dedicated acreage outlined on the plat below? YES _____ NO _____. ("Owner" means the person who has the right to drill into and to produce from any pool and to appropriate the production either for himself or for himself and another. (65-3-29 (e) NMSA 1935 Comp.)
2. If the answer to question one is "no," have the interests of all the owners been consolidated by communitization agreement or otherwise? YES _____ NO _____. If answer is "yes," Type of Consolidation _____
3. If the answer to question two is "no," list all the owners and their respective interests below:

Owner	Land Description

SECTION B

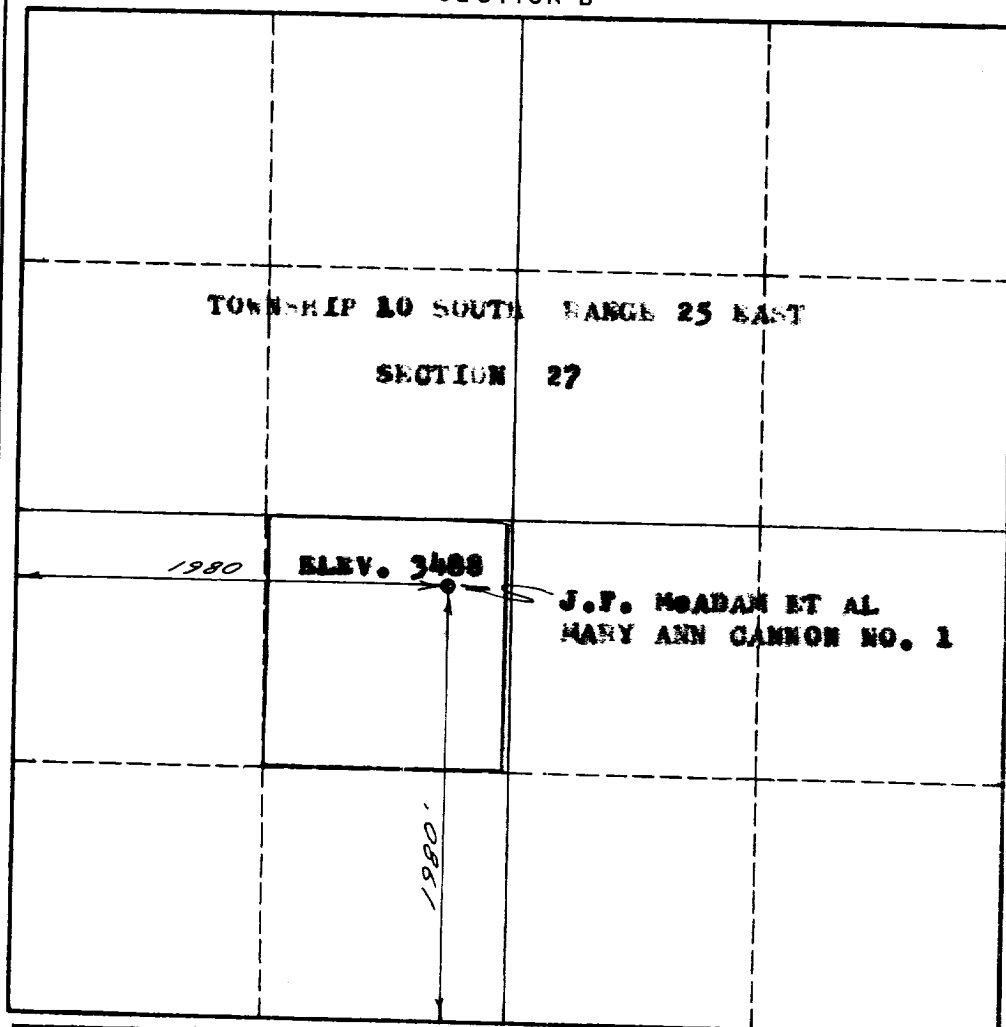

CERTIFICATION

I hereby certify that the information in SECTION A above is true and complete to the best of my knowledge and belief.

J.F. McAdams
Name
Operator
Position
J.F. McAdams & Son
Company
4/18/60
Date

I hereby certify that the well location shown on the plat in SECTION B was plotted from field notes of actual surveys made by me or under my supervision, and that the same is true and correct to the best of my knowledge and belief.

Date Surveyed
4-15-60
Registered Professional Engineer
and/or Land Surveyor
MANN ENGINEERING CO.
By: Raymond West
Certificate No. **1697**

0 330 660 990 1320 1650 1980 2310 2640 2000 1500 1000 500 0

INSTRUCTIONS FOR COMPLETION OF FORM C-128

1. Operator shall furnish and certify to the information called for in Section A.
2. Operator shall outline the dedicated acreage for *both* oil and gas wells on the plat in Section B.
3. A registered professional engineer or land surveyor registered in the State of New Mexico or approved by the Commission shall show on the plat the location of the well and certify this information in the space provided.
4. All distances shown on the plat must be from the outer boundaries of the Section.
5. If additional space is needed for listing owners and their respective interests as required in question 3 of Section A, please use space below.

OIL CONSERVATION COMMISSION		
ARTESIA DISTRICT OFFICE		
No. Copies Received		
DISTRIBUTION		
	NO FURNISHED	
OPERATOR	1	
SANTA FE	1	
PRORATION OFFICE		
STATE LAND OFFICE		
U. S. G. S.	2	
TRANSPORTER		
FILE	1	✓
BUREAU OF MINES		