

NEW MEXICO OIL CONSERVATION COMMISSION

Santa Fe, New Mexico

Form 6-101
Revised (12/1/55)

DEC 21 1959

NOTICE OF INTENTION TO DRILL

30-005-00088

Notice must be given to the District Office of the Oil Conservation Commission and approval obtained before drilling or recompletion begins. If changes in the proposed plan are considered advisable, a copy of this notice showing such changes will be returned to the sender. Submit this notice in QUINTUPPLICATE. One copy will be returned following approval. See additional instructions in Rules and Regulations of the Commission. If State Land submit 6 Copies Attach Form G-128 in triplicate to first 3 copies of form G-101

Wichita Falls, Texas

12/14/59

(Place)

(Date)

OIL CONSERVATION COMMISSION
SANTA FE, NEW MEXICO

Gentlemen:

You are hereby notified that it is our intention to commence the Drilling of a well to be known as
Westland Oil Development Corporation

(Company or Operator)

J. F. Wagner

(Lease)

Well No. 1, in "P" (Unit) The well is

located 970 feet from the South line and 560 feet from the East line of Section 18, T. -11-S, R. -25-E, NMPM.

(GIVE LOCATION FROM SECTION LINE) Wildcat Unnamed Pool, Chaves CountyIf State Land the Oil and Gas Lease is No. NoIf patented land the owner is J. F. WagnerAddress SE of RoswellWe propose to drill well with drilling equipment as follows: Rotary tools.

The status of plugging bond is Filed with New Mexico State Agent -
Howell Ernest, P.O. Box 486, Santa Fe, New Mexico

Drilling Contractor M. G. Peters Drilling Company
East 2nd. Street, Roswell New Mexico

We intend to complete this well in the San Andres formation at an approximate depth of 925 feet.

CASING PROGRAM

We propose to use the following strings of Casing and to cement them as indicated:

Size of Hole	Size of Casing	Weight per Foot	New or Second Hand	Depth	Sacks Cement
13 3/4"	10 3/4"	40.50	New	@ approx 825'	Circulate to surf.
7 7/8"	4 1/2"	9.5	New	@ approx 975	Est. 40 sacks

If changes in the above plans become advisable we will notify you immediately.

ADDITIONAL INFORMATION (If recompletion give full details of proposed plan of work.)

DEC 21 1959

Approved....., 19.....
Except as follows:

Sincerely yours,

WESTLAND OIL DEVELOPMENT CORPORATION

(Company or Operator)

By E. E. CornsPosition Petroleum Engineer

Send Communications regarding well to

Name Westland Oil Development Corp.Address 315 Oil and Gas Bldg., Wichita Falls, Tex

OIL CONSERVATION COMMISSION

By M. L. Armstrong

OIL AND GAS INSPECTION

NEW MEXICO OIL CONSERVATION COMMISSION
WELL LOCATION AND ACREAGE DEDICATION PLAT

RECEIVED

FORM C-128
Revised 5/1/57

DEC 21 1959

SEE INSTRUCTIONS FOR COMPLETING THIS FORM ON THE REVERSE SIDE

SECTION A

Operator Westland Oil Development Corp.		Lease J. F. Wagner		ARTESIA, OFFICE Well No. 1	
Unit Letter P	Section 18	Township 11-South	Range 25-East	County Chaves	
Actual Footage Location of Well: 970 feet from the South line and 560 feet from the East line					
Ground Level Elev. 3526	Producing Formation San Andres		Pool Wildcat		Dedicated Acreage: 38 Acres

1. Is the Operator the only owner in the dedicated acreage outlined on the plat below? **YES** NO . ("Owner" means the person who has the right to drill into and to produce from any pool and to appropriate the production either for himself or for himself and another. (65-3-29 (e) NMSA 1935 Comp.)
2. If the answer to question one is "no," have the interests of all the owners been consolidated by communitization agreement or otherwise? YES NO . If answer is "yes," Type of Consolidation
3. If the answer to question two is "no," list all the owners and their respective interests below:

Owner Cities Service Oil Company (Below 1,000')	Land Description SE/4, SE/4 Section 18, T-11-S, R-25-E
---	--

SECTION B

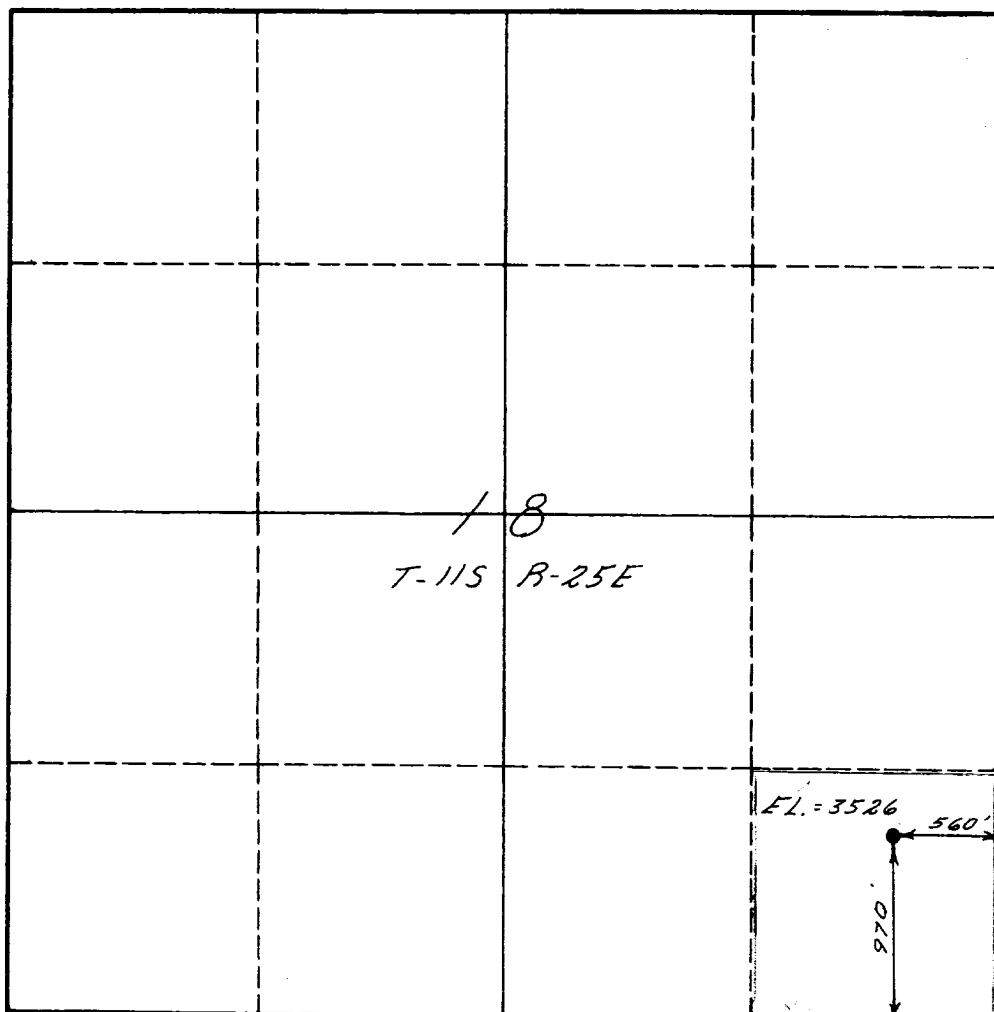

CERTIFICATION

I hereby certify that the information in SECTION A above is true and complete to the best of my knowledge and belief.

E. E. Combs
Name

Petroleum Engineer

Position

Westland Oil Development

Company

Wichita Falls, Texas

Date

12/14/59

I hereby certify that the well location shown on the plat in SECTION B was plotted from field notes of actual surveys made by me or under my supervision, and that the same is true and correct to the best of my knowledge and belief.

Date Surveyed

Dec. 11-1959

Registered Professional Engineer

and/or Land Surveyor

Mann Engineering Co.
By: L. J. Mann

Certificate No.

1697

0 330 660 990 1320 1650 1980 2310 2640 2000 1500 1000 500 0

INSTRUCTIONS FOR COMPLETION OF FORM C-128

1. Operator shall furnish and certify to the information called for in Section A.
2. Operator shall outline the dedicated acreage for *both* oil and gas wells on the plat in Section B.
3. A registered professional engineer or land surveyor registered in the State of New Mexico or approved by the Commission shall show on the plat the location of the well and certify this information in the space provided.
4. All distances shown on the plat must be from the outer boundaries of the Section.
5. If additional space is needed for listing owners and their respective interests as required in question 3 of Section A, please use space below.

OIL CONSERVATION COMMISSION		
ARTESIA DISTRICT OFFICE		
No. Copies Received	8	
DISTRIBUTION		
County Clerk	4	
County Engineer	1	
County Assessor		
State Land Office	2	
U. S. G. L.		
Washington		
NLE	1	✓
TOTAL COPIES		