

NEW MEXICO OIL CONSERVATION COM.  
Santa Fe, New Mexico

RECEIVED  
Form G-101  
Revised (12/1/55)  
JAN 7 1960

NOTICE OF INTENTION TO DRILL

Notice must be given to the District Office of the Oil Conservation Commission and approval obtained before drilling or recompletion begins. If changes in the proposed plan are considered advisable, a copy of this notice showing such changes will be returned to the sender. Submit this notice in QUINTUPPLICATE. One copy will be returned following approval. See additional instructions in Rules and Regulations of the Commission. If State Land submit 6 Copies Attach Form G-128 in triplicate to first 3 copies of form G-101

Wichita Falls, Texas  
(Place)

January 5, 1960.  
(Date)

OIL CONSERVATION COMMISSION  
SANTA FE, NEW MEXICO

Gentlemen:

You are hereby notified that it is our intention to commence the Drilling of a well to be known as

Westland Oil Development Corporation

(Company or Operator)

J. F. Wagner

(Lease)

Well No. 1

in "N"

(Unit)

The well is

located 970' feet from the South line and 360' feet from the

East

Line of Section 18

T-11S

R-25E

NMPM.

(GIVE LOCATION FROM SECTION LINE)

Wildcat

Pool,

Chaves

County

If State Land the Oil and Gas Lease is No.

If patented land the owner is J. F. Wagner

Address Southeast of Roswell, New Mexico

We propose to drill well with drilling equipment as follows: Rotary Tools

The status of plugging bond is Filed with New Mexico State agent

Howell Ernest, P. O. Box 486, Santa Fe, New Mexico.

Drilling Contractor M. G. Peters Drilling Company

East 2nd Street, Roswell, New Mexico.

We intend to complete this well in the San Andres

formation at an approximate depth of 925' feet.

CASING PROGRAM

We propose to use the following strings of Casing and to cement them as indicated:

Size of Hole	Size of Casing	Weight per Foot	New or Second Hand	Depth	Sacks Cement
9"	7"	20.0	New	Approx. 825'	Cir. to surface
6-3/4"	4 1/2"	9.50	New	Approx. 975'	Est. 40 sacks

If changes in the above plans become advisable we will notify you immediately.

ADDITIONAL INFORMATION (If recompletion give full details of proposed plan of work.)

Changed location from 970' from S line 560' from E line

Approved JAN 8 1960, 19.....  
Except as follows:

OIL CONSERVATION COMMISSION

Sincerely yours,

Westland Oil Development Corporation

(Company or Operator)

By

R. V. Kennedy

Position District Supt.

Send Communications regarding well to

Name Westland Oil Development Corp.

Address 315 Oil & Gas Bldg., Wichita Falls, Texas.

By M. L. Armstrong

**NEW MEXICO OIL CONSERVATION COMMISSION**  
**WELL LOCATION AND ACREAGE DEDICATION PLAT**

FORM C-128  
 Revised 5/1/57

**RECEIVED**  
 JAN 7 1960

SEE INSTRUCTIONS FOR COMPLETING THIS FORM ON THE REVERSE SIDE

**SECTION A**

Operator <b>Westland Oil Development Corporation</b>			Lease <b>J. F. Wagner</b>			Office No. <b>No. 1</b>		
Unit Letter <b>npn</b>	Section <b>18</b>	Township <b>11-South</b>	Range <b>25-East</b>	County <b>Chaves</b>				
Actual Footage Location of Well: <b>970'</b> feet from the <b>South</b> line and <b>360'</b> feet from the <b>East</b> line								
Ground Level Elev. <b>3628</b>		Producing Formation <b>San Andres</b>		Pool <b>Wildcat</b>			Dedicated Acreage: <b>38</b> Acres	

1. Is the Operator the only owner in the dedicated acreage outlined on the plat below? YES \_\_\_\_\_ NO \_\_\_\_\_. ("Owner" means the person who has the right to drill into and to produce from any pool and to appropriate the production either for himself or for himself and another. (65-3-29 (e) NMSA 1935 Comp.)
2. If the answer to question one is "no," have the interests of all the owners been consolidated by communitization agreement or otherwise? YES \_\_\_\_\_ NO \_\_\_\_\_. If answer is "yes," Type of Consolidation \_\_\_\_\_
3. If the answer to question two is "no," list all the owners and their respective interests below:

Owner <b>Cities Service Oil Co. (Below 1000')</b>	Land Description <b>SE/4 SE/4 Section 18, T-11S, R-25E</b>
--	---

**SECTION B**

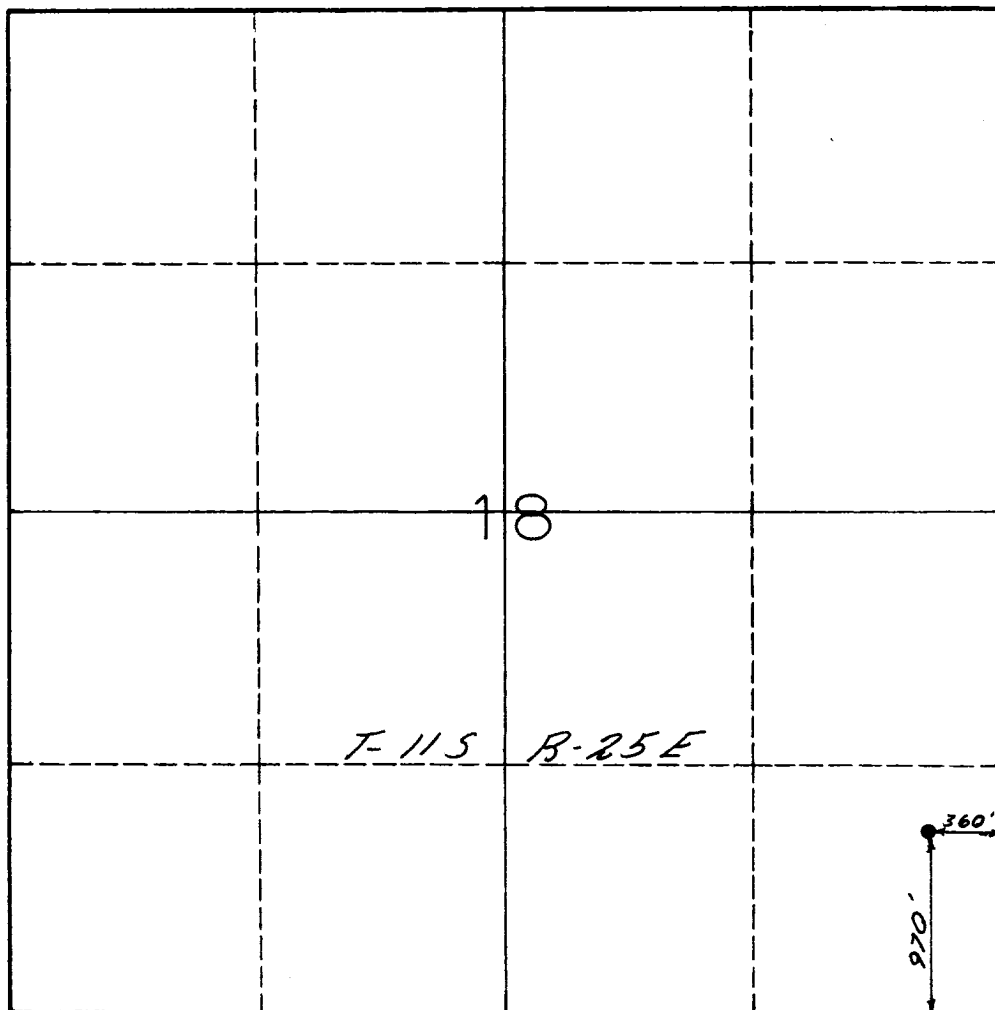

**CERTIFICATION**

I hereby certify that the information in SECTION A above is true and complete to the best of my knowledge and belief.

Name <b>R. P. Kennedy</b>
Position <b>District Supt.</b>
Company <b>Westland Oil Development Corp.</b>
Date <b>January 5, 1960.</b>

I hereby certify that the well location shown on the plat in SECTION B was plotted from field notes of actual surveys made by me or under my supervision, and that the same is true and correct to the best of my knowledge and belief.

Date Surveyed <b>Dec. 11, 1959</b>
Registered Professional Engineer and/or Land Surveyor <b>Mann Engineering Co.</b>
Certificate No. <b>1697</b>

0 330 660 990 1320 1650 1980 2310 2640 2000 1500 1000 500 0

# INSTRUCTIONS FOR COMPLETION OF FORM C-128

1. Operator shall furnish and certify to the information called for in Section A.
2. Operator shall outline the dedicated acreage for *both* oil and gas wells on the plat in Section B.
3. A registered professional engineer or land surveyor registered in the State of New Mexico or approved by the Commission shall show on the plat the location of the well and certify this information in the space provided.
4. All distances shown on the plat must be from the outer boundaries of the Section.
5. If additional space is needed for listing owners and their respective interests as required in question 3 of Section A, please use space below.

OIL CONSERVATION COMMISSION		
ARTESIA DISTRICT OFFICE		
No. Copies Received		
DISTRIBUTION		
	COPIES	
OPERATOR	1	
SANTA FE	1	
PRODUCTION OFFICE		
STATE LAND OFFICE		
U. S. G. S.	2	
TRANSPORTER		
FILE	1	✓
BUREAU OF MINES		