

NEW MEXICO OIL CONSERVATION COMMISSION

Well Location and Acreage Dedication Plat

Section A.

Date October 3, 1957

Operator Fren Oil Company Lease Honolulu - State - #N. M. E. 8907
Well No. 1 Unit Letter Q Section 36 Township 14S Range 25E NMPM
Located 1980 Feet From East Line, 660 Feet From South Line
County Chaves G. L. Elevation _____ Dedicated Acreage 40 Acres
Name of Producing Formation San Andres Pool Wildcat

1. Is the Operator the only owner* in the dedicated acreage outlined on the plat below?
Yes _____ No V.
2. If the answer to question one is "no," have the interests of all the owners been consolidated by communitization agreement or otherwise? Yes _____ No _____. If answer is "yes," Type of Consolidation _____
3. If the answer to question two is "no," list all the owners and their respective interests below:

<u>Owner</u>	<u>Land Description</u>
<u>Fren Oil Company</u>	<u>C. SW/4, SE/4, Section 36, T 14S, R 25E</u>
<u>Hills Building - 106 A Texas Street</u>	<u>Chaves County, New Mexico</u>
<u>El Paso, Texas</u>	

Section B

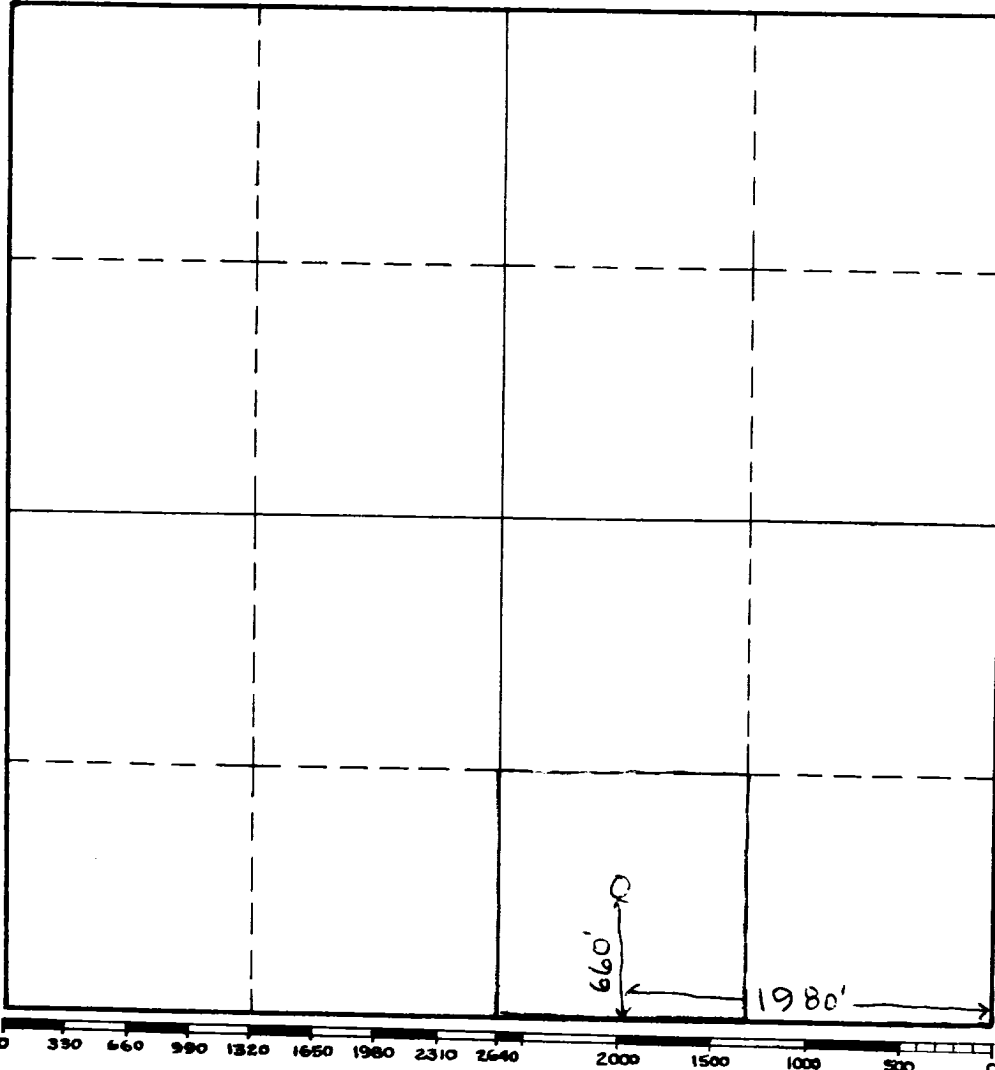

This is to certify that the information in Section A above is true and complete to the best of my knowledge and belief.

Fren Oil Company
Max Enzinger (Operator)
(Max Enzinger) - Partner
(Representative)
El Paso, Texas
Address _____

This is to certify that the well location shown on the plat in Section B was plotted from field notes of actual surveys made by me or under my supervision and that the same is true and correct to the best of my knowledge and belief.

Date Surveyed 10/2/57
Hawes Kusey
Registered Professional
Engineer and/or Land Surveyor.

Certificate No. 802

(See instructions for completing this form on the back of the form.)

INSTRUCTIONS FOR COMPLETION:

1. Operator shall furnish and certify to the information called for in Section A.
2. Operator shall outline the dedicated acreage for both oil and gas wells on the plat in Section B.
3. A registered professional engineer or land surveyor registered in the State of New Mexico or approved by the Commission shall show on the plat the location of the well and certify this information in the space provided.
4. All distances shown on the plat must be from the outer boundaries of Section.
5. If additional space is needed for listing owners and their respective interests as required in question 3, Section A, please use space below

The Honolulu Oil Company owns deep rights below 2000'

OIL CONSERVATION COMMISSION		
ARTESIA DISTRICT OFFICE		
No. Copies Received		
DISTRIBUTION		
	NO. FURNISHED	
Operator		
State		
Proration Office		
State Land Office		
U. S. G. S.		
Transporter		
File		

* "Owner" means the person who has the right to drill into and to produce from any pool and to appropriate the production either for himself or for himself and another. (65-3-29 (e) NMSA 1953 Comp.)