

NEW MEXICO OIL CONSERVATION COMMISSION

Santa Fe, New Mexico

NOTICE OF INTENTION TO DRILL OR RECOMPLETE

Notice must be given to the District Office of the Oil Conservation Commission and approval obtained before drilling or recompletion begins. If changes in the proposed plan are considered advisable, a copy of this notice showing such changes will be returned to the sender. Submit this notice in **QUINTUPPLICATE**. One copy will be returned following approval. See additional instructions in Rules and Regulations of the Commission. **If State Land submit 6 Copies**

P. O. Box 933 Harford, Texas
(Place)

February 21, 1959
(Date)

OIL CONSERVATION COMMISSION
SANTA FE, NEW MEXICO

Gentlemen:

You are hereby notified that it is our intention to commence the (Drilling) (Recompletion) of a well to be known as

J. W. Brown, ~~ESSEX OIL & GAS CO., INC.~~
(Company or Operator)

Chaves-State #MP# 62830-00
(Lease)

Well No. **2**

in **NW/4NW/4SE/4**
(Unit)

located **1650** feet from the **North** line and **990** feet from the

East line of Section **26**, T. **10S**, R. **26E**, NMPM.

(GIVE LOCATION FROM SECTION LINE) **Brown** Pool, **Chaves** County

If State Land the Oil and Gas Lease is No. **MP# 62830-00**

If patented land the owner is.....

Address.....

We propose to drill well with drilling equipment as follows:.....

Rotary

The status of plugging bond is **\$10,000 Blanket Bond on file**

Drilling Contractor **Steinberger Drilling Co.**

We intend to complete this well in the **Queen Sand**

formation at an approximate depth of **800** feet.

CASING PROGRAM

We propose to use the following strings of Casing and to cement them as indicated:

Size of Hole	Size of Casing	Weight per Foot	New or Second Hand	Depth	Sacks Cement
	4-1/2"	9-1/2#	New	Approx. 800'	50 Sacks Circ

If changes in the above plans become advisable we will notify you immediately.

ADDITIONAL INFORMATION (If recompletion give full details of proposed plan of work.)

Approved....., 19.....
Except as follows:

OIL CONSERVATION COMMISSION

By

M L Armstrong

Sincerely yours,

J. W. Brown

By *J W Brown*
(Company or Operator)

Position **Operator**

Send Communications regarding well to

Name **Box 933 Harford, Texas J.W. Brown**

Address **Box 933 Harford, Texas**

NEW MEXICO OIL CONSERVATION COMMISSION

Well Location and Acreage Dedication Plat

Section A.

Date Feb 21, 1959

Operator J.W. Brown, ~~XXXXXXXXXXXX~~ Lease Chaves-~~State~~ # "P" 62830-00
 Well No. Gulf 2 Unit Letter H Section 26 Township 10S Range 26E NMFM
 Located 1650 Feet From North Line, 990 Feet From East Line
 County Chaves G. L. Elevation 3726.1 Dedicated Acreage 10 Acres
 Name of Producing Formation Queen Sand Pool Brown

1. Is the Operator the only owner* in the dedicated acreage outlined on the plat below?
Yes X No .
2. If the answer to question one is "no," have the interests of all the owners been consolidated by communitization agreement or otherwise? Yes No . If answer is "yes," Type of Consolidation
3. If the answer to question two is "no," list all the owners and their respective interests below:

OwnerLand Description

Section B

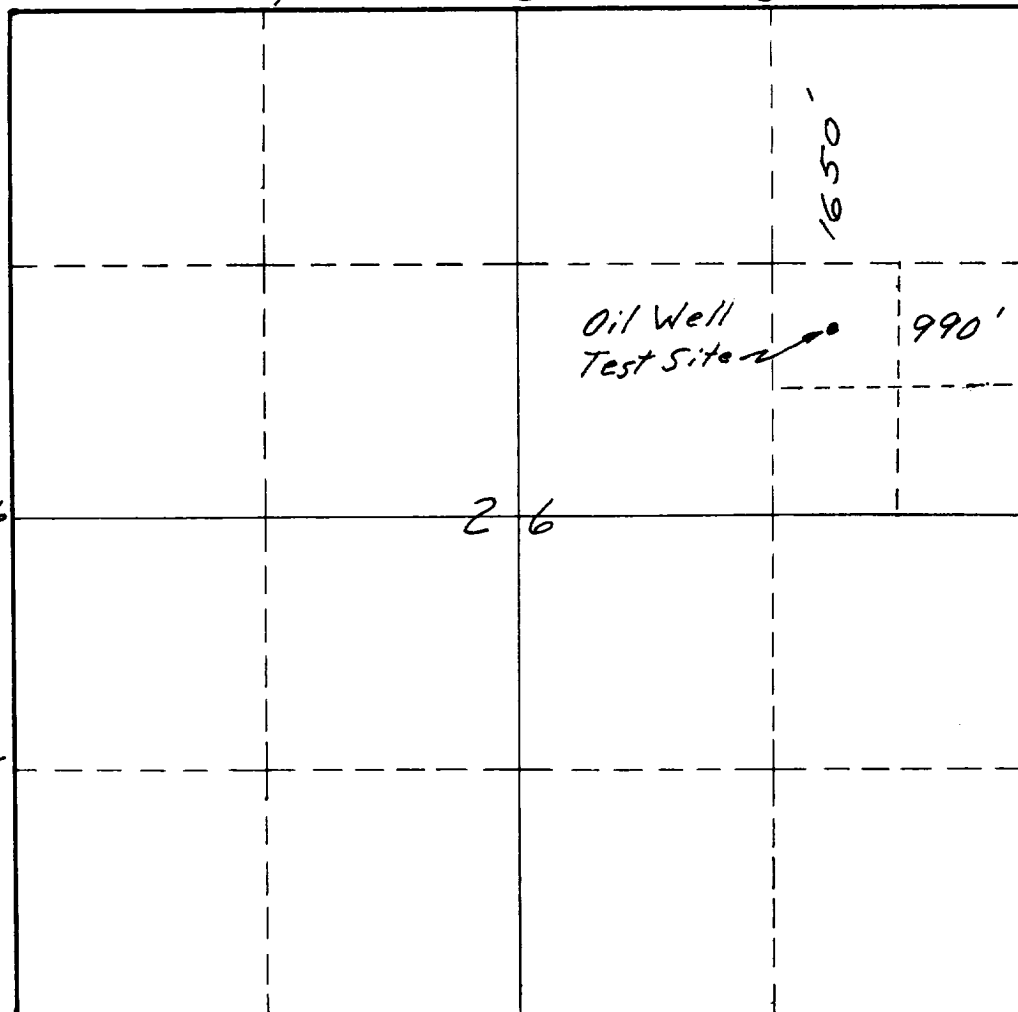

This is to certify that the information in Section A above is true and complete to the best of my knowledge and belief.

J.W. Brown
(Operator)

~~XXXXXXXXXXXX~~
(Representative)

Box 933 Harford, Tex.
Address

This is to certify that the well location shown on the plat in Section B was plotted from field notes of actual surveys made by me or under my supervision and that the same is true and correct to the best of my knowledge and belief.

Date Surveyed 2/21/59

Mary Ann G.
By: Raymond A. G.
Registered Professional
Engineer and/or Land Surveyor.

Certificate No. 1697

INSTRUCTIONS FOR COMPLETION:

1. Operator shall furnish and certify to the information called for in Section A.
2. Operator shall outline the dedicated acreage for both oil and gas wells on the plat in Section B.
3. A registered professional engineer or land surveyor registered in the State of New Mexico or approved by the Commission shall show on the plat the location of the well and certify this information in the space provided.
4. All distances shown on the plat must be from the outer boundaries of Section.
5. If additional space is needed for listing owners and their respective interests as required in question 3, Section A, please use space below

* "Owner" means the person who has the right to drill into and to produce from any pool and to appropriate the production either for himself or for himself and another. (65-3-29 (e) NMSA 1953 Comp.)