

NEW MEXICO OIL CONSERVATION COMMISSION
Santa Fe, New Mexico

Form C-101
Revised (12/1/55)

NOTICE OF INTENTION TO DRILL

Notice must be given to the District Office of the Oil Conservation Commission and approval obtained before drilling or recompletion begins. If changes in the proposed plan are considered advisable, a copy of this notice showing such changes will be returned to the sender. Submit this notice in QUINTUPPLICATE. One copy will be returned following approval. See additional instructions in Rules and Regulations of the Commission. If State Land submit 6 Copies Attach Form C- 128 in triplicate to first 3 copies of form C-101

Lovington, New Mexico

July 20, 1959

(Place)

(Date)

OIL CONSERVATION COMMISSION
SANTA FE, NEW MEXICO

Gentlemen:

You are hereby notified that it is our intention to commence the Drilling of a well to be known as
Roger L. Holmes

(Company or Operator)

State

Well No. 1

in A

The well is

(Lease)

(Unit)

located 330 feet from the North line and 330 feet from the East

Line of Section 36, T 9 South, R. 26 East, NMPM.

(GIVE LOCATION FROM SECTION LINE)

Wildcat

Pool,

Chaves

County

If State Land the Oil and Gas Lease is No. E-6248

If patented land the owner is

Address

We propose to drill well with drilling equipment as follows:

Rotary

The status of plugging bond is \$5,000,000.00 J.S. Ward and Son,
Artesia, New Mexico

Drilling Contractor Graystone Drilling Company

We intend to complete this well in the Queens

formation at an approximate depth of 950 feet.

CASING PROGRAM

We propose to use the following strings of Casing and to cement them as indicated:

Size of Hole	Size of Casing	Weight per Foot	New or Second Hand	Depth	Sacks Cement
9"	8 5/8"	34 24	New	25'	Set
5 7/8	4 1/2"	34 9 1/2	New	950'	Circulate

If changes in the above plans become advisable we will notify you immediately.

ADDITIONAL INFORMATION (If recompletion give full details of proposed plan of work.)

JUL 24 1959

Approved....., 19.....
Except as follows:

OIL CONSERVATION COMMISSION

By M.L. Armstrong

Sincerely yours,

Roger L. Holmes
(Company or Operator)

By

Position Independent

Send Communications regarding well to

Name

Address Roger L. Holmes

B. O. Box 1471

NEW MEXICO OIL CONSERVATION COMMISSION
Well Location and Acreage Dedication Plat

Form C-128
Revised 5/1/57

Section A.

Date July 20, 1959

Operator Roger L. Holmes Lease State Lease 10-6218
Well No. 1 Unit Letter A Section 36 Township 9 South Range 26 East NMPM
Located 330 Feet From North Line, 330 Feet From East Line
County Chaves G. L. Elevation 3842.1 Dedicated Acreage 40 Acres
Name of Producing Formation Alamosa Pool Wildcat

1. Is the Operator the only owner* in the dedicated acreage outlined on the plat below?
Yes _____ No x _____.
2. If the answer to question one is "no," have the interests of all the owners been consolidated by communitization agreement or otherwise? Yes x No _____. If answer is "yes," Type of Consolidation Farmout
3. If the answer to question two is "no," list all the owners and their respective interests below:

Owner

Land Description

Section B

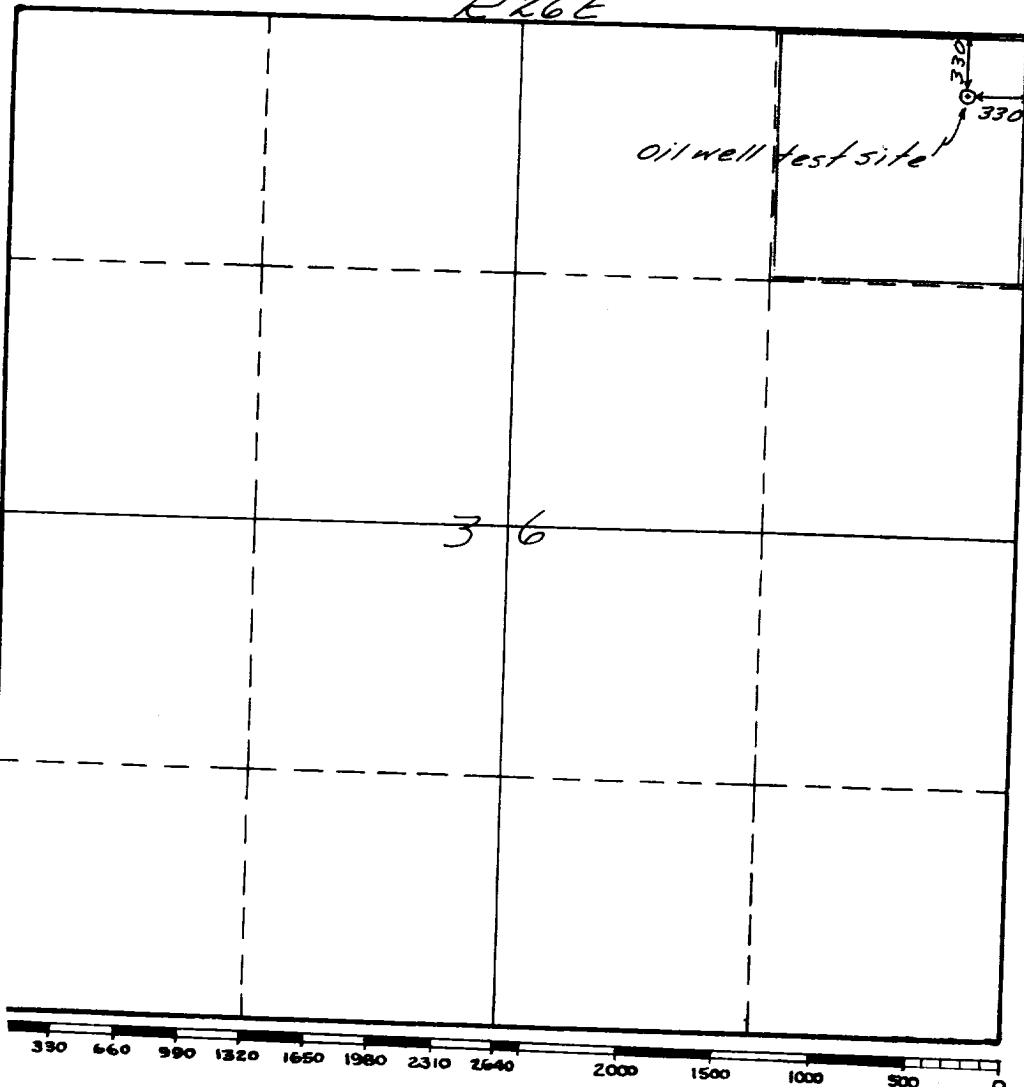

This is to certify that the information in Section A above is true and complete to the best of my knowledge and belief.

Roger L. Holmes
(Operator)

Independent
(Representative)

P.O. Box 1621

Lovington, New Mexico
Address

This is to certify that the well location shown on the plat in Section B was plotted from field notes of actual surveys made by me or under my supervision and that the same is true and correct to the best of my knowledge and belief.

Date Surveyed 20 July

Thomas J. Mann
Registered Professional
Engineer and/or Land Surveyor.

Certificate No. 277
the reverse side)

(See instructions for completing this form on

INSTRUCTIONS FOR COMPLETION :

1. Operator shall furnish and certify to the information called for in Section A.
2. Operator shall outline the dedicated acreage for both oil and gas wells on the plat in Section B.
3. A registered professional engineer or land surveyor registered in the State of New Mexico or approved by the Commission shall show on the plat the location of the well and certify this information in the space provided.
4. All distances shown on the plat must be from the outer boundaries of Section.
5. If additional space is needed for listing owners and their respective interests as required in question 3, Section A, please use space below

U. S. CONSERVATION COMMISSION	
ARTESIA DISTRICT OFFICE	
No. Copies Received	3
DISTRIBUTION	
ADMINISTRATIVE	1
TECHNICAL	1
FIELD	1
RECORDS	
TRAINING	
FILE	
BUREAU OF MINES	

* "Owner" means the person who has the right to drill into and to produce from any pool and to appropriate the production either for himself or for himself and another. (65-3-29 (e) NMSA 1953 Comp.)