

Company DeKalb Agricultural Association

Lease Joan-Duke Well No. 1

Sec. 14 T. 8 S., R. 26 E., N.M.P.M.

Location SW $\frac{1}{4}$ SE $\frac{1}{4}$ (1980' fr East Line and 660' fr South Line)

County Chaves, New Mexico

Chained Distances R26E

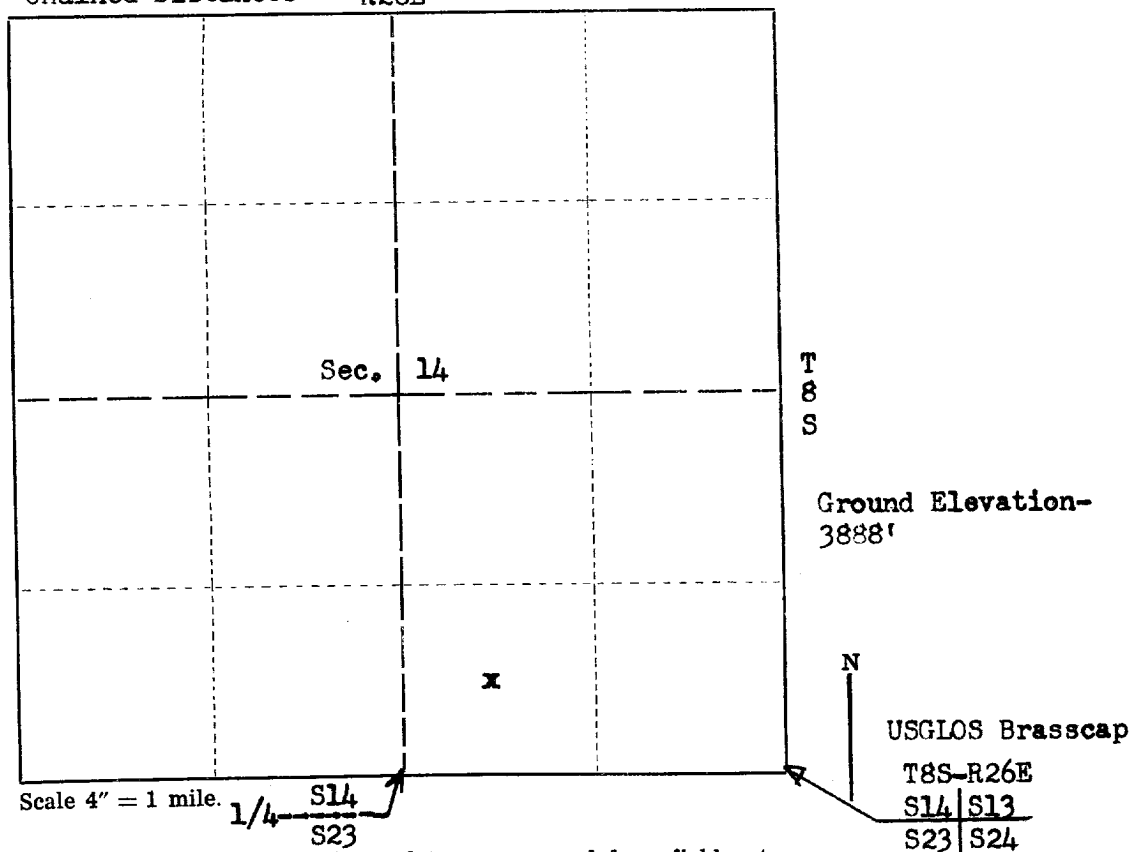

This is to certify that the above plat was prepared from field notes of actual surveys made by me or under my supervision and that the same are true and correct to the best of my knowledge and belief.

Seal:

Artesia, New Mexico

Surveyed October 30,, 1954

17532 Advocate Print

Company _____
 Lease _____
 Sec 1A _____
 Location _____
 County _____
 New Mexico

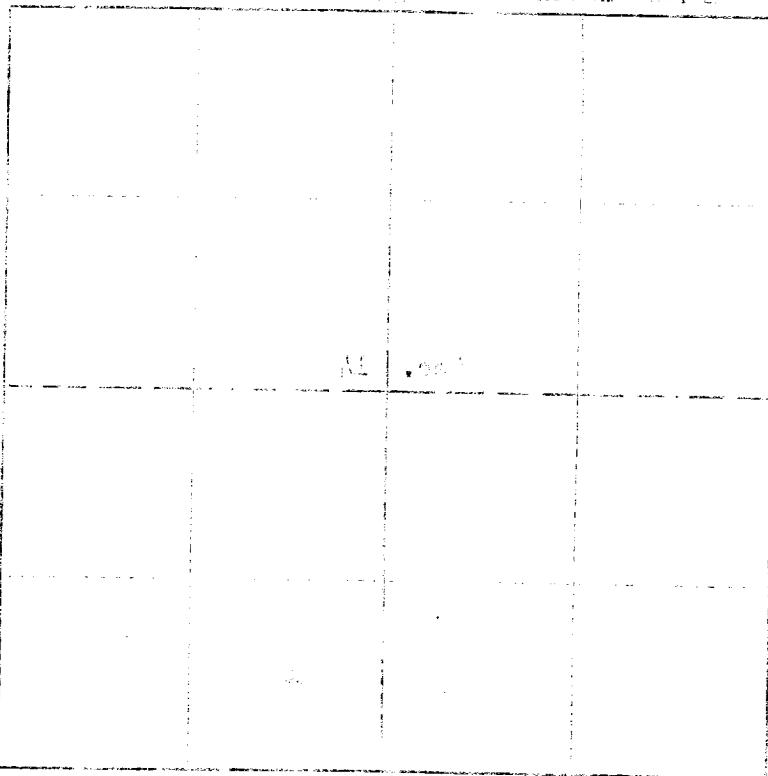

This is to certify that the above plat was prepared from field notes of actual surveys made by me or under my supervision and that the same are true and correct to the best of my knowledge and belief.

Registered Professional
 Surveyor and Land Surveyor

Seal

State of New Mexico

Surveyed _____
 1934

11332 Advocate Print