

SURVEYOR'S CERTIFICATE

Survey to locate oil well test site in "center" of the
SE $\frac{1}{4}$ SE $\frac{1}{4}$ SW $\frac{1}{4}$ of section 25, T11S, R26E, N.M.P.M.

For Kewanee Oil Co.

Box 124

Maljamar, New Mexico

STANLEY No.1-- 2310 from West line and 330 from South line

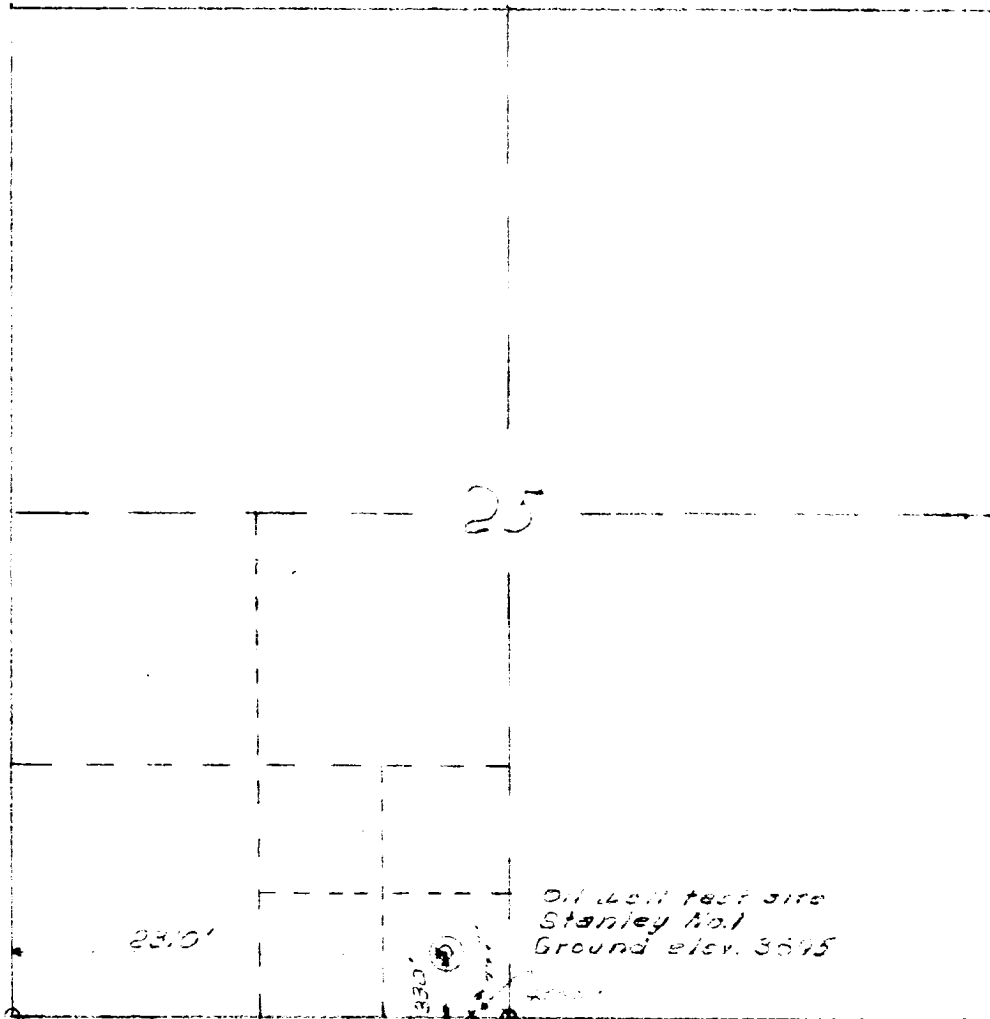

Found 115920 Brass cap
S1/4 sec 25-11-26

Found 115920 Brass cap
S1/4 sec 25-11-26

I, Thomas T. Mann, hereby certify the above plat to be true and correct to the best of my knowledge and belief.

Thomas T. Mann
Reg. Prof. Engineer and
Land Surveyor No. 277

January 4, 1956