

N. M. O. C. COPY  
(SUBMIT IN TRIPLICATE)

20-005-00193  
Budget Bureau No. 43-B308.4  
Approval expires 12-31-60.

Land Office **Las Cruces**

Lease No. **10-01794**

Unit **Government &  
Cities Service Petroleum  
Company**

**APPROVED**  
*James A. Knauf*  
JAMES A. KNAUF  
DISTRICT ENGINEER

UNITED STATES  
DEPARTMENT OF THE INTERIOR  
GEOLOGICAL SURVEY

*Cover all water zones with cement*

**SUNDRY NOTICES AND REPORTS ON WELLS**

**RECEIVED**

NOTICE OF INTENTION TO DRILL	<input checked="" type="checkbox"/>	SUBSEQUENT REPORT OF WATER SHUT-OFF	
NOTICE OF INTENTION TO CHANGE PLANS		SUBSEQUENT REPORT OF SHOOTING OR ACIDIZING	
NOTICE OF INTENTION TO TEST WATER SHUT-OFF		SUBSEQUENT REPORT OF ALTERING CASING	
NOTICE OF INTENTION TO RE-DRILL OR REPAIR WELL		SUBSEQUENT REPORT OF RE-DRILLING OR REPAIR	
NOTICE OF INTENTION TO SHOOT OR ACIDIZE		SUBSEQUENT REPORT OF ABANDONMENT	
NOTICE OF INTENTION TO PULL OR ALTER CASING		SUPPLEMENTARY WELL HISTORY	
NOTICE OF INTENTION TO ABANDON WELL			

(INDICATE ABOVE BY CHECK MARK NATURE OF REPORT, NOTICE, OR OTHER DATA)

WITNESS CEMENTING THE CASING.  
NOTIFY US IN SUFFICIENT TIME TO

**January 17**, 19 **62**

Well No. **1** is located **1300** ft. from **S** line and **660** ft. from **E** line of sec. **5**

**NE SE S**  
(1/4 Sec. and Sec. No.)

**14-S**  
(Twp.)

**27-E**  
(Range)

**NMPN**  
(Meridian)

**Undesignated**  
(Field)

**Chaves**  
(County or Subdivision)

**New Mexico**  
(State or Territory)

The elevation of the derrick floor above sea level is **3475** ft. **Est.**

**DETAILS OF WORK**

(State names of and expected depths to objective sands; show sizes, weights, and lengths of proposed casings; indicate mudding jobs, cementing points, and all other important proposed work)

It is proposed to drill this well to approximately 2600' in the Giorietta Formation.

**Size of Cas.**  
**6 5/8"**  
**5 1/2"**

**Weight**  
**240**  
**140**

**Length**  
**250'**  
**2600'**

**Condition**  
**New**  
**Used**

**Cement**  
**Circulate**  
**300 sacks**

**RECEIVED**

**JAN 22 1962**

U. S. GEOLOGICAL SURVEY  
ARIZONA DISTRICT

I understand that this plan of work must receive approval in writing by the Geological Survey before operations may be commenced.

Company **Cities Service Petroleum Company**

Address **P. O. Box 97**

**Halls, New Mexico**

By

Title **District Superintendent**

NEW MEXICO OIL CONSERVATION COMMISSION  
WELL LOCATION AND ACREAGE DEDICATION PLAT

FORM C-128  
Revised 5/1/57

SEE INSTRUCTIONS FOR COMPLETING THIS FORM ON THE REVERSE SIDE

SECTION A

Operator <b>Cities Service Petroleum Co.</b>			Lease <b>Government "WH"</b>		Well No. <b>1</b>
Unit Letter <b>I</b>	Section <b>5</b>	Township <b>14 South</b>	Range <b>27 East</b>	County <b>Chaves</b>	
Actual Footage Location of Well: <b>1980</b> feet from the <b>South</b> line and <b>660</b> feet from the <b>East</b> line					
Ground Level Elev. <b>3475' Est.</b>	Producing Formation <b>Glorieta</b>		Pool <b>Wildcat</b> <del>Undesignated</del>	Dedicated Acreage: <b>40</b> Acres	

1. Is the Operator the only owner in the dedicated acreage outlined on the plat below? YES ☒ NO ☐ ("Owner" means the person who has the right to drill into and to produce from any pool and to appropriate the production either for himself or for himself and another. (65-3-29 (a) NMSA 1955 Comp.)
2. If the answer to question one is "no," have the interests of all the owners been consolidated by communitization agreement or otherwise? YES ☐ NO ☐ If answer is "yes," Type of Consolidation \_\_\_\_\_
3. If the answer to question two is "no," list all the owners and their respective interests below:

Owner	Land Description
	<b>JAN 22 1962</b> <b>U. S. GEOLOGICAL SURVEY</b> <b>ARTESIA, NEW MEXICO</b>

SECTION B

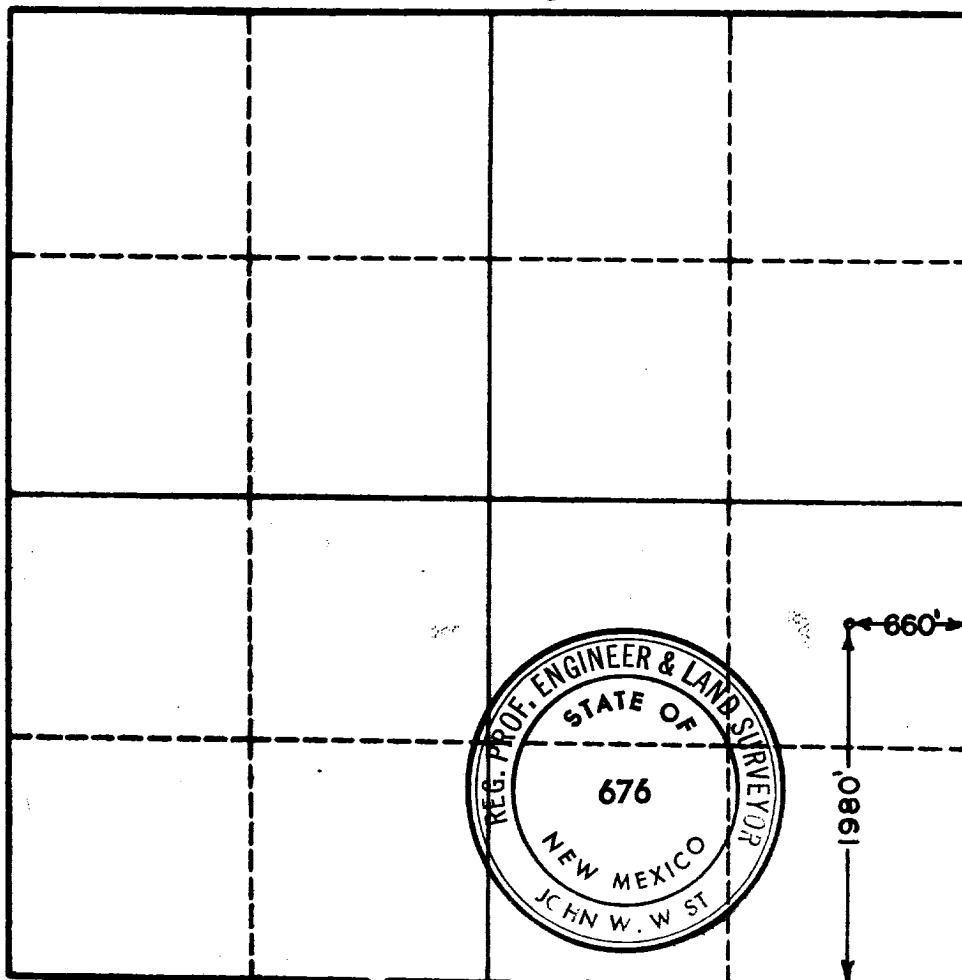

CERTIFICATION

I hereby certify that the information in SECTION A above is true and complete to the best of my knowledge and belief.

Name <i>[Signature]</i>
Position <b>Dist. Supt.</b>
Company <b>Cities Service Petroleum</b>
Date <b>1-19-62</b>

*Copy*  
I hereby certify that the well location shown on the plat in SECTION B was plotted from field notes of actual surveys made by me or under my supervision, and that the same is true and correct to the best of my knowledge and belief.

Date Surveyed <b>1-18-62</b>
Registered Professional Engineer and/or Land Surveyor, <b>JOHN W. WEST</b>
Certificate No. <i>[Signature]</i> <b>N. M. - P. E. &amp; L. S. NO. 676</b>

0 350 650 950 1250 1550 1850 2150 2450 2000 1500 1000 500 0