

NEW MEXICO OIL CONSERVATION COMMISSION
Well Location and Acreage Dedication Plat

JUN 9 1959

Section A.

Date June 9 - 1959

Operator M.G. Peters Drilling Co. Lease Everna Faircloth "B"
Well No. 1 Unit Letter P Section 32 Township 7S Range 27E NMPM
Located 990 Feet From East Line, 330 Feet From South Line
County Chaves G. L. Elevation 4017 Dedicated Acreage 40 Acres
Name of Producing Formation San Andres Pool Acre

1. Is the Operator the only owner* in the dedicated acreage outlined on the plat below?
Yes X No .
2. If the answer to question one is "no," have the interests of all the owners been consolidated by communitization agreement or otherwise? Yes No . If answer is "yes," Type of Consolidation
3. If the answer to question two is "no," list all the owners and their respective interests below:

Owner

Land Description

<u>Owner</u>	<u>Land Description</u>

Section B

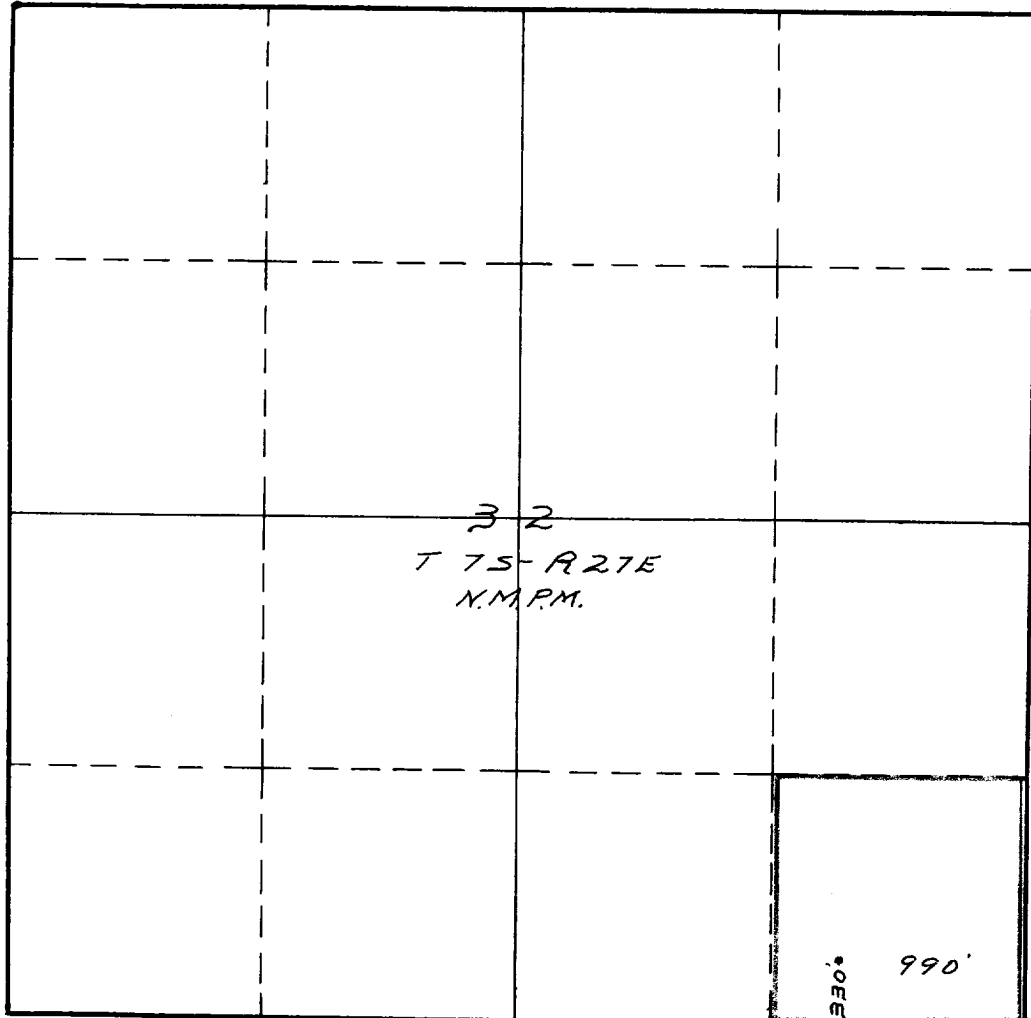

This is to certify that the information in Section A above is true and complete to the best of my knowledge and belief.

M. G. Peters Drilling Co.
(Operator)
M. G. Peters
(Representative)
M. G. Peters
Box 902 Roswell, N.M.
Address

This is to certify that the well location shown on the plat in Section B was plotted from field notes of actual surveys made by me or under my supervision and that the same is true and correct to the best of my knowledge and belief.

Date Surveyed 6/2/59
Mann Engineering Co.
By: Raymond T. Mann
Registered Professional
Engineer and/or Land Surveyor.

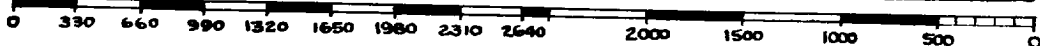

(See instructions for completing this form on the reverse side)

Certificate No. 1697

INSTRUCTIONS FOR COMPLETION:

1. Operator shall furnish and certify to the information called for in Section A.
2. Operator shall outline the dedicated acreage for both oil and gas wells on the plat in Section B.
3. A registered professional engineer or land surveyor registered in the State of New Mexico or approved by the Commission shall show on the plat the location of the well and certify this information in the space provided.
4. All distances shown on the plat must be from the outer boundaries of Section.
5. If additional space is needed for listing owners and their respective interests as required in question 3, Section A, please use space below

OIL CONSERVATION COMMISSION		
ARTESIA DISTRICT OFFICE		
No.	Cc	6
Date		
To		
Subject		
Remarks		
Approved by _____ District Manager		
Checked by _____ Clerk		
Transmitted by _____ Telephone Room		
Sent _____ Time of Day		
By _____ Transporter		
File		

* "Owner" means the person who has the right to drill into and to produce from any pool and to appropriate the production either for himself or for himself and another. (65-3-29 (e) NMSA 1953 Comp.)