

NEW MEXICO OIL CONSERVATION COMMISSION
Well Location and Acreage Dedication Plat

Section A.

Date **October 6, 1958**

Operator **War-Tex Exploration Co.** Lease **Alma Shields**
Well No. **1** Unit Letter _____ Section **33** Township **7 S** Range **27 E** NMPM
Located **330** Feet From **West** Line **330** Feet From **South** Line
County **Chaves** G. L. Elevation **4000** Dedicated Acreage _____ Acres
Name of Producing Formation **San Andres** Pool **Aemo**

1. Is the Operator the only owner* in the dedicated acreage outlined on the plat below?
Yes _____ No **X**.
2. If the answer to question one is "no," have the interests of all the owners been consolidated by communitization agreement or otherwise? Yes _____ No **X**. If answer is "yes," Type of Consolidation _____
3. If the answer to question two is "no," list all the owners and their respective interests below:

Owner	Land Description
War-Tex Exploration Company	SW/4 SW/4 Section 7 T7S R27E Depth 0-2100'
Southern Petroleum Inc.	" " " " " Below 2100'

Section B

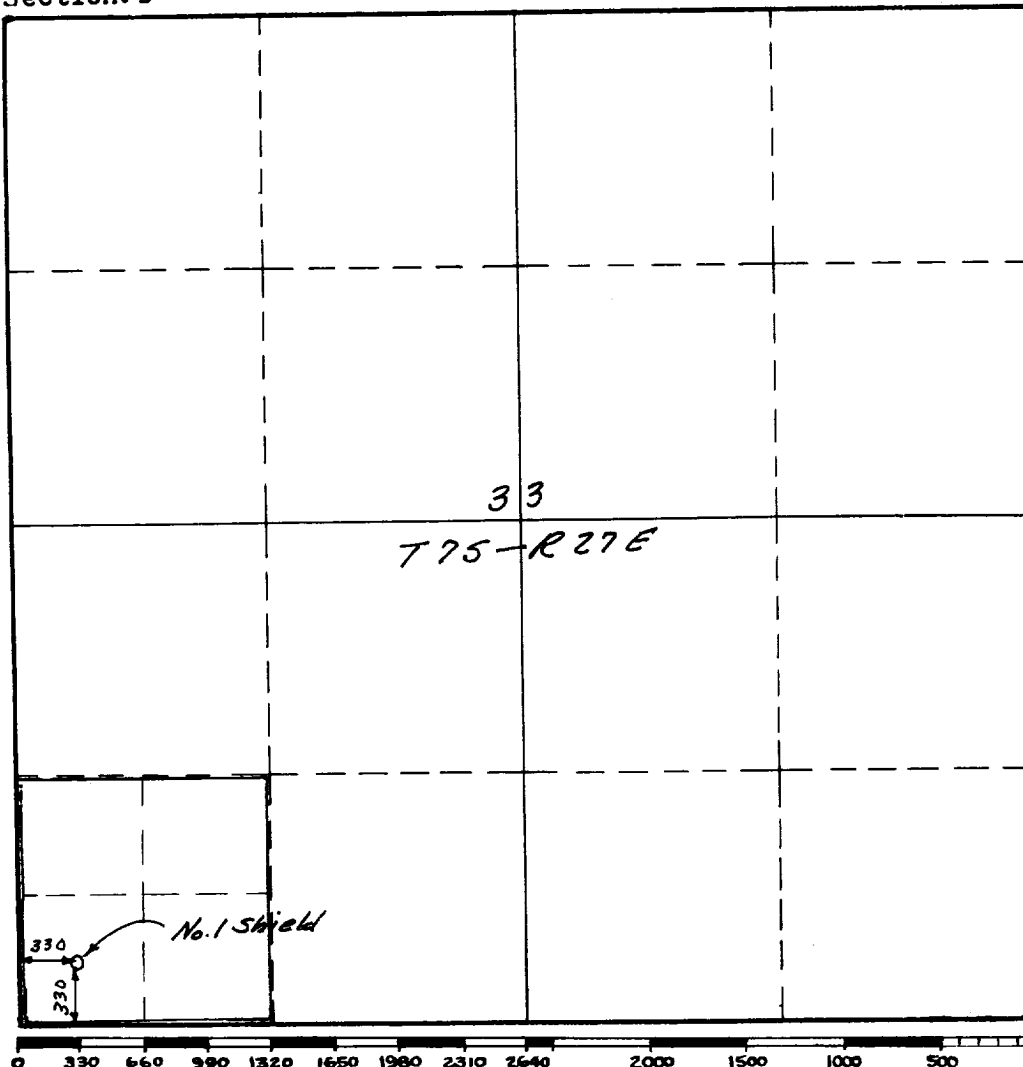

This is to certify that the information in Section A above is true and complete to the best of my knowledge and belief.

War-Tex Exploration Co.

(Operator)

N.D. Nichols *N.D. Nichols*

(Representative)

Box 507, Monahans, Texas

Address

This is to certify that the well location shown on the plat in Section B was plotted from field notes of actual surveys made by me or under my supervision and that the same is true and correct to the best of my knowledge and belief.

Date Surveyed **Oct. 1, 1958**

Manor Engineering Co.

By: **Raymond T. West**

Registered Professional Engineer and/or Land Surveyor.

Certificate No. **1697**

(See instructions for completing this form on the reverse side)

INSTRUCTIONS FOR COMPLETION:

1. Operator shall furnish and certify to the information called for in Section A.
2. Operator shall outline the dedicated acreage for both oil and gas wells on the plat in Section B.
3. A registered professional engineer or land surveyor registered in the State of New Mexico or approved by the Commission shall show on the plat the location of the well and certify this information in the space provided.
4. All distances shown on the plat must be from the outer boundaries of Section.
5. If additional space is needed for listing owners and their respective interests as required in question 3, Section A, please use space below

OIL CONSERVATION COMMISSION		
ARTIFICIAL LIFTING OFFICE		
No. Copies Submitted		✓
Operator		
Santa Fe		
Frontier		
State Land		
U. S. G. L.		
Transportation		✓
File		

* "Owner" means the person who has the right to drill into and to produce from any pool and to appropriate the production either for himself or for himself and another. (65-3-29 (e) NMSA 1953 Comp.)