

NEW MEXICO OIL CONSERVATION COMMISSION
Santa Fe, New Mexico

Form C-101
Revised (12/1/55)

30-005-00262

NOTICE OF INTENTION TO DRILL

FILE 000

Notice must be given to the District Office of the Oil Conservation Commission and approval obtained before drilling or recompletion begins. If changes in the proposed plan are considered advisable, a copy of this notice showing such changes will be returned to the sender. Submit this notice in QUINTUPLICATE. One copy will be returned following approval. See additional instructions on Rules and Regulations of the Commission. If State Land submit 6 Copies Attach Form C-128 in triplicate to first 3 copies of form C-101

Reswell, New Mexico

(Place)

March 28, 1960

(Date)

MAR 31 1960

O. C. C.

APPROVAL STAMP

OIL CONSERVATION COMMISSION
SANTA FE, NEW MEXICO

Gentlemen:

You are hereby notified that it is our intention to commence the Drilling of a well to be known as

C. T. Robertson

(Company or Operator)

Magnolia-State

(Lease)

Well No. 1

in

P

(Unit)

The well is

located 990 feet from the South line and 990 feet from the East line of Section 11, T. 11S, R. 27E, NMPM.

(GIVE LOCATION FROM SECTION LINE) Coyote Pool, Chaves County

If State Land the Oil and Gas Lease is No. E-3186

If patented land the owner is

Address

We propose to drill well with drilling equipment as follows: Rotary to 1075'.

The status of plugging bond is Statewide on file

Drilling Contractor Hall Drilling Company

We intend to complete this well in the Penrose formation at an approximate depth of 1000 - 1050 feet.

CASING PROGRAM

We propose to use the following strings of Casing and to cement them as indicated:

Size of Hole	Size of Casing	Weight per Foot	New or Second Hand	Depth	Sacks Cement
6 3/4	4 1/2	9.5	New	1075	325

If changes in the above plans become advisable we will notify you immediately.

ADDITIONAL INFORMATION (If recompletion give full details of proposed plan of work.)

Approved _____, 19____
Except as follows:

OIL CONSERVATION COMMISSION

By M. L. Armstrong

Sincerely yours,

C. T. Robertson

(Company or Operator)

By

Warren Roach

Position Agent (Warren Roach)

Send Communications regarding well to

Name Warren Roach

Address 703 V & J Tower -Midland, Texas

NEW MEXICO OIL CONSERVATION COMMISSION
Well Location and Acreage Dedication Plat

Section A.

Operator C. T. Robertson Lease Magnolia State AM 10 29
Well No. 1 Unit Letter P Section 11 Township 11 S Range 27E NMPM
Located 990 Feet From South Line, 990 Feet From East Line
County Chaves G. L. Elevation 3732' Dedicated Acreage 40 Acres
Name of Producing Formation Penrose Pool Penrose Undersag.

1. Is the Operator the only owner* in the dedicated acreage outlined on the plat below?
Yes X No .
2. If the answer to question one is "no," have the interests of all the owners been consolidated by communitization agreement or otherwise? Yes No . If answer is "yes," Type of Consolidation
3. If the answer to question two is "no," list all the owners and their respective interests below:

Owner

Land Description

Section B

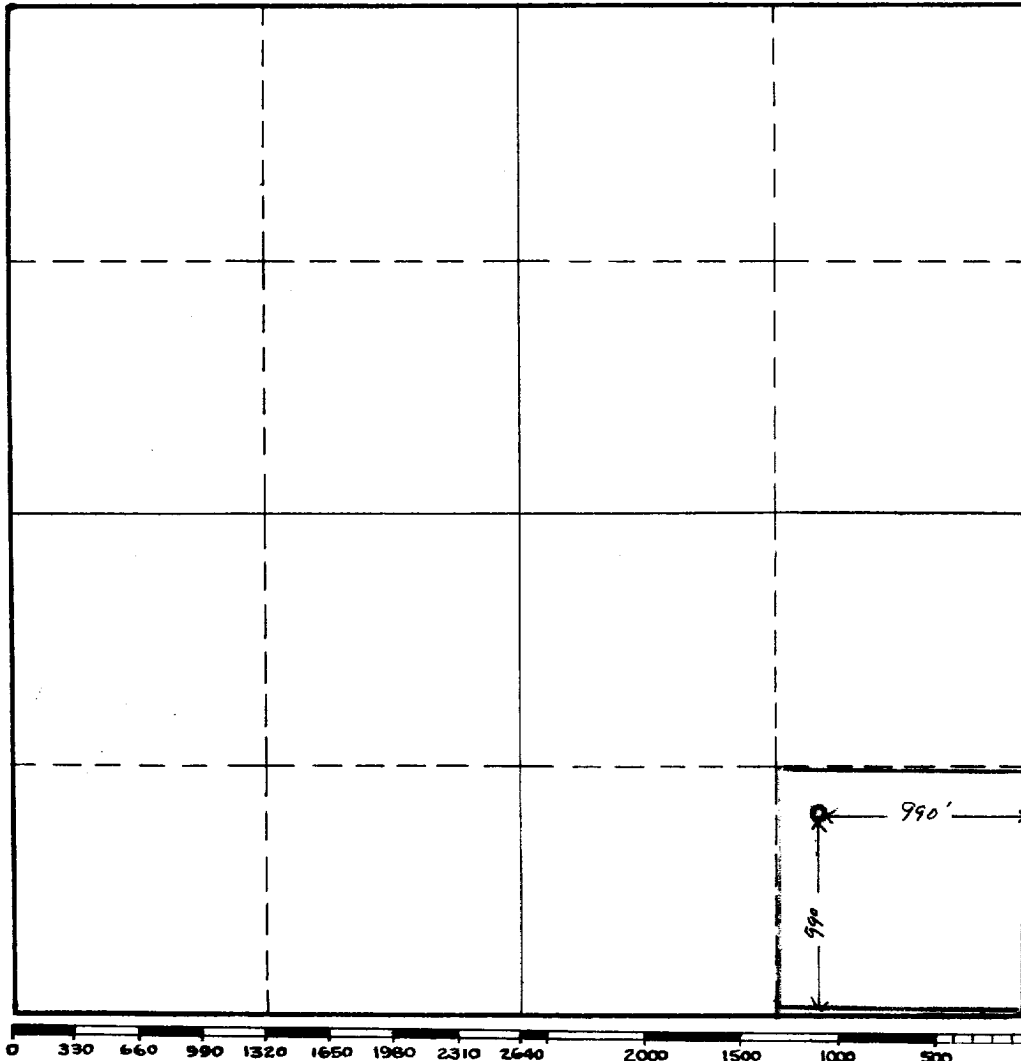

This is to certify that the information in Section A above is true and complete to the best of my knowledge and belief.

C. T. Robertson
(Operator)

Warren Roach
(Representative)
(Warren Roach)

703 V & J Tower-Midland,
Address Texas

This is to certify that the well location shown on the plat in Section B was plotted from field notes of actual surveys made by me or under my supervision and that the same is true and correct to the best of my knowledge and belief.

Date Surveyed March 23, 1960

Larry E. Curran
Registered Professional
Engineer and/or Land Surveyor.

Certificate No. 1312

(See instructions for completing this form on the reverse side)

INSTRUCTIONS FOR COMPLETION

1. Operator shall furnish and certify to the information called for in Section A.
2. Operator shall outline the dedicated acreage for both oil and gas wells on the plat in Section B.
3. A registered professional engineer or land surveyor registered in the State of New Mexico or approved by the Commission shall show on the plat the location of the well and certify this information in the space provided.
4. All distances shown on the plat must be from the outer boundaries of Section.
5. If additional space is needed for listing owners and their respective interests as required in question 3, Section A, please use space below

OIL CONSERVATION	
ALFRED D. ...	6
...	1
...	1
...	1
...	2
TRANSPORTATION	1
...	1
BUREAU OF MINES	✓

* "Owner" means the person who has the right to drill into and to produce from any pool and to appropriate the production either for himself or for himself and another. (65-3-29 (e) NMSA 1953 Comp.)