

NEW MEXICO OIL CONSERVATION COMMISSION
Santa Fe, New Mexico

Form G-101
Revised (12/1/55)

NOTICE OF INTENTION TO DRILL

SEP 14 1959

20-005-00315

Notice must be given to the District Office of the Oil Conservation Commission and approval obtained before drilling or recompletion begins. If changes in the proposed plan are considered advisable, a copy of this notice showing such changes will be returned to the sender. Submit this notice in QUINTUPLICATE. One copy will be returned following approval. See additional instructions in Rules and Regulations of the Commission. If State Land submit 6 Copies Attach Form G- 128 in triplicate to first 3 copies of form G-101

Hobbs, New Mexico
(Place)

September 14, 1959

OIL CONSERVATION COMMISSION
SANTA FE, NEW MEXICO

Gentlemen:

You are hereby notified that it is our intention to commence the Drilling of a well to be known as
G.K. Woods et al. Box 2527, Hobbs, New Mexico

(Company or Operator)

Levick - State

Well No. 1, in M (Unit) The well is

located 330 feet from the South line and 990 feet from the

East line of Section 23, T. 11 South, R. 27 East, NMPM.

(GIVE LOCATION FROM SECTION LINE) 11 East Pool, Chaves County

If State Land the Oil and Gas Lease is No. E-3741

If patented land the owner is

Address

We propose to drill well with drilling equipment as follows: Rotary

The status of plugging bond is \$10,000.00 Blanket Bond

J.S. Ard & Son, Artesia, New Mexico Daniels Insurance Co. Hobbs, N.M.

Drilling Contractor Graystone Drilling Company

We intend to complete this well in the 2625 feet
formation at an approximate depth of 1200 feet.

CASING PROGRAM

We propose to use the following strings of Casing and to cement them as indicated:

Size of Hole	Size of Casing	Weight per Foot	New or Second Hand	Depth	Sacks Cement
10"	8 5/8"	28	New	20'	Circ.
6 3/4"	4 1/2"	9.5	New	1120'	Circ.

If changes in the above plans become advisable we will notify you immediately.

ADDITIONAL INFORMATION (If recompletion give full details of proposed plan of work.)

SEP 14 1959

Approved _____, 19_____
Except as follows:

Sincerely yours,

G.K. Woods
(Company or Operator)

By _____

Position _____

Send Communications regarding well to

Name G.K. Woods

Address P.O. Box 2527, Hobbs, New Mexico

OIL CONSERVATION COMMISSION

By M.L. Armstrong

OIL CONSERVATION COMMISSION
ARTESIA DISTRICT OFFICE

No. C-10-E-1 6

ARTESIA DISTRICT OFFICE

No. Cont. B. 6

Revised 5/1/57

NEW MEXICO OIL CONSERVATION COMMISSION

SEPT 10 1959

Well Location and Acreage Dedication Plat

Section A.

Date September 8, 1959

Operator G.K. Woods et al. Lease Levick - State
 Well No. 1 Unit Letter M Section 23 Township 11-S. Range 27-E. NMPM
 Located 330 Feet From South Line, 990 Feet From West Line
 County Chaves G. L. Elevation 3762 Dedicated Acreage 40 Acres
 Name of Producing Formation Queens Pool Wildcat

1. Is the Operator the only owner* in the dedicated acreage outlined on the plat below?
 Yes _____ No X .
2. If the answer to question one is "no," have the interests of all the owners been consolidated by communitization agreement or otherwise? Yes X No _____. If answer is "yes," Type of Consolidation Farmout
3. If the answer to question two is "no," list all the owners and their respective interests below:

OwnerLand Description

Section B

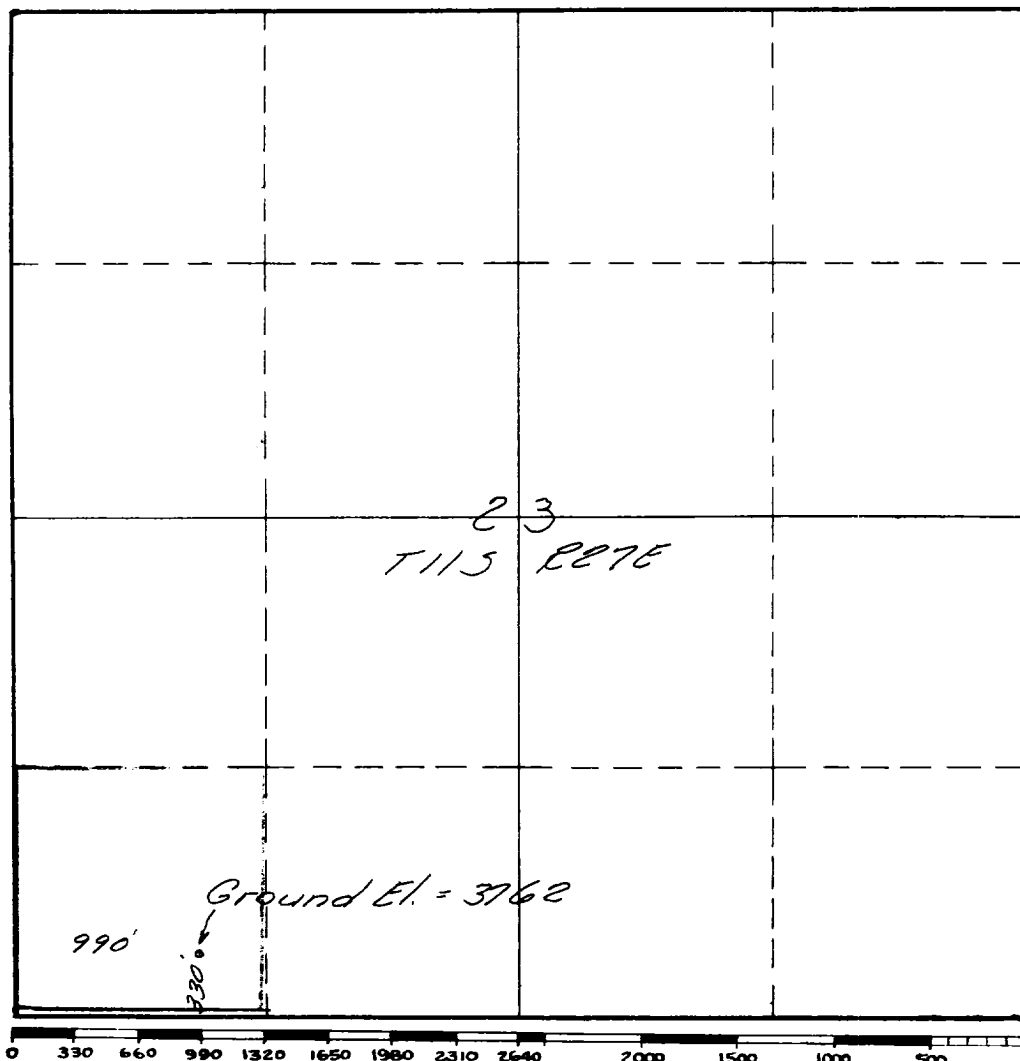

This is to certify that the information in Section A above is true and complete to the best of my knowledge and belief.

G.K. Woods et al
 (Operator)

Self G.K. Woods
 (Representative)

Box 2527 Hobbs, New Mexico
 Address

This is to certify that the well location shown on the plat in Section B was plotted from field notes of actual surveys made by me or under my supervision and that the same is true and correct to the best of my knowledge and belief.

Date Surveyed Sept. 9, 1959
Mann Engineering Co.
By: Raymond J. West
 Registered Professional
 Engineer and/or Land Surveyor.

Certificate No. 1697

(See instructions for completing this form on the reverse side)

INSTRUCTIONS FOR COMPLETION:

1. Operator shall furnish and certify to the information called for in Section A.
2. Operator shall outline the dedicated acreage for both oil and gas wells on the plat in Section B.
3. A registered professional engineer or land surveyor registered in the State of New Mexico or approved by the Commission shall show on the plat the location of the well and certify this information in the space provided.
4. All distances shown on the plat must be from the outer boundaries of Section.
5. If additional space is needed for listing owners and their respective interests as required in question 3, Section A, please use space below

OIL AND GAS WELL LOCATION	
SECTION B	
Well No.	1
Well No.	2
Well No.	3
Well No.	4
Well No.	5
Well No.	6
Well No.	7
Well No.	8
Well No.	9
Well No.	10
Well No.	11
Well No.	12
Well No.	13
Well No.	14
Well No.	15
Well No.	16
Well No.	17
Well No.	18
Well No.	19
Well No.	20

* "Owner" means the person who has the right to drill into and to produce from any pool and to appropriate the production either for himself or for himself and another. (65-3-29 (e) NMSA 1953 Comp.)