

NO. OF COPIES RECEIVED	
DISTRIBUTION	
SANTA FE	
FILE	
U.S.G.S.	
LAND OFFICE	
OPERATOR	

NEW MEXICO OIL CONSERVATION COMMISSION

SEP 24 1981

O. C. D.
ARTESIA, OFFICE

Form C-101
Revised 1-1-65

5A. Indicate Type of Lease STATE <input checked="" type="checkbox"/> FEE <input type="checkbox"/>
5. State Oil & Gas Lease No. Sta-NM-L 6860
7. Unit Agreement Name N/A
8. Farm or Lease Name State 33
9. Well No. 1-35
10. Field and Pool, or Wildcat Wildcat
12. County Chaves
19. Proposed Depth 5600'
19A. Formation Abo
20. Rotary or C.T. Rotary
21. Elevations (Show whether DF, RT, etc.) GR 3694'
21A. Kind & Status Plug. Bond Current Blanket
21B. Drilling Contractor MacChase
22. Approx. Date Work will start Sept. 15, 1981

APPLICATION FOR PERMIT TO DRILL, DEEPEN, OR PLUG BACK

1a. Type of Work b. Type of Well OIL WELL <input type="checkbox"/> GAS WELL <input checked="" type="checkbox"/> OTHER <input type="checkbox"/>	DRILL <input type="checkbox"/> RE ENTER <input checked="" type="checkbox"/> DEEPEN <input type="checkbox"/> PLUG BACK <input type="checkbox"/>
2. Name of Operator Viking Petroleum, Inc. ✓	
3. Address of Operator 2700 Center Building, 2761 E. Skelly Drive, Tulsa, Oklahoma 74105	
4. Location of Well UNIT LETTER J LOCATED 1980 FEET FROM THE South LINE AND 1980 FEET FROM THE East LINE OF SEC. 33 TWP. 11 S RGE. 27 E NMPM	
21. Elevations (Show whether DF, RT, etc.) GR 3694'	21A. Kind & Status Plug. Bond Current Blanket
21B. Drilling Contractor MacChase	

23.

PROPOSED CASING AND CEMENT PROGRAM

SIZE OF HOLE	SIZE OF CASING	WEIGHT PER FOOT	SETTING DEPTH	SACKS OF CEMENT	EST. TOP
7-5/8	4-1/2	10.5 #	5600'	500 sx	above top of pay

original operator and well number: Humble Oil and Refining Co. #1 State of NM "Y"
original TD: 7430' Spud 12-18-49 Plugged and Abandoned 3-6-50
original casing: 10-3/4" @ 480.08'
7-5/8" @ 4603.00'
recovered 485.04' of 7-5/8 casing

PROPOSED PROGRAM:

1. Re enter old hole
2. Clean out old hole to 5600'
3. Set 4-1/2" production casing
4. Perforate and stimulate as needed

BOP diagram attached.
Gas is not dedicated.

APPROVAL VALID FOR 180 DAYS
PERMIT EXPIRES 3-25-81
UNLESS DRILLING UNDERWAY

IN ABOVE SPACE DESCRIBE PROPOSED PROGRAM: IF PROPOSAL IS TO DEEPEN OR PLUG BACK, GIVE DATA ON PRESENT PRODUCTIVE ZONE AND PROPOSED NEW PRODUCTIVE ZONE. GIVE BLOWOUT PREVENTER PROGRAM, IF ANY.

I hereby certify that the information above is true and complete to the best of my knowledge and belief.

Signed Nancy Stoltz Title Agent Date 9-22-81
Nancy Stoltz Jack Grynberg and Associates
(This space for State Use)

APPROVED BY W.A. Gressett TITLE SUPERVISOR, DISTRICT II DATE SEP 25 1981
CONDITIONS OF APPROVAL, IF ANY:

Tested TD-1
x 72 Reel
no entry
9-25-81

**NEW MEXICO OIL CONSERVATION COMMISSION
WELL LOCATION AND ACREAGE DEDICATION PLAT**

Form C-102
Supersedes C-128
Effective 1-1-65

All distances must be from the outer boundaries of the Section.

Operator Viking Petroleum, Inc.			Lease State 33		Well No. 1-33
Unit Letter J	Section 33	Township 11 S	Range 27 E	County Chaves	
Actual Footage Location of Well: <div style="display: flex; justify-content: space-between;"> 1980' feet from the South line and 1980' feet from the East line </div>					
Ground Level Elev. 3694'	Producing Formation Abo	Pool Wildcat		Dedicated Acreage: 160 Acres	

1. Outline the acreage dedicated to the subject well by colored pencil or hachure marks on the plat below.
2. If more than one lease is dedicated to the well, outline each and identify the ownership thereof (both as to working interest and royalty).
3. If more than one lease of different ownership is dedicated to the well, have the interests of all owners been consolidated by communitization, unitization, force-pooling, etc?

☐ Yes ☐ No If answer is "yes," type of consolidation _____

If answer is "no," list the owners and tract descriptions which have actually been consolidated. (Use reverse side of this form if necessary.) _____

No allowable will be assigned to the well until all interests have been consolidated (by communitization, unitization, forced-pooling, or otherwise) or until a non-standard unit, eliminating such interests, has been approved by the Commission.

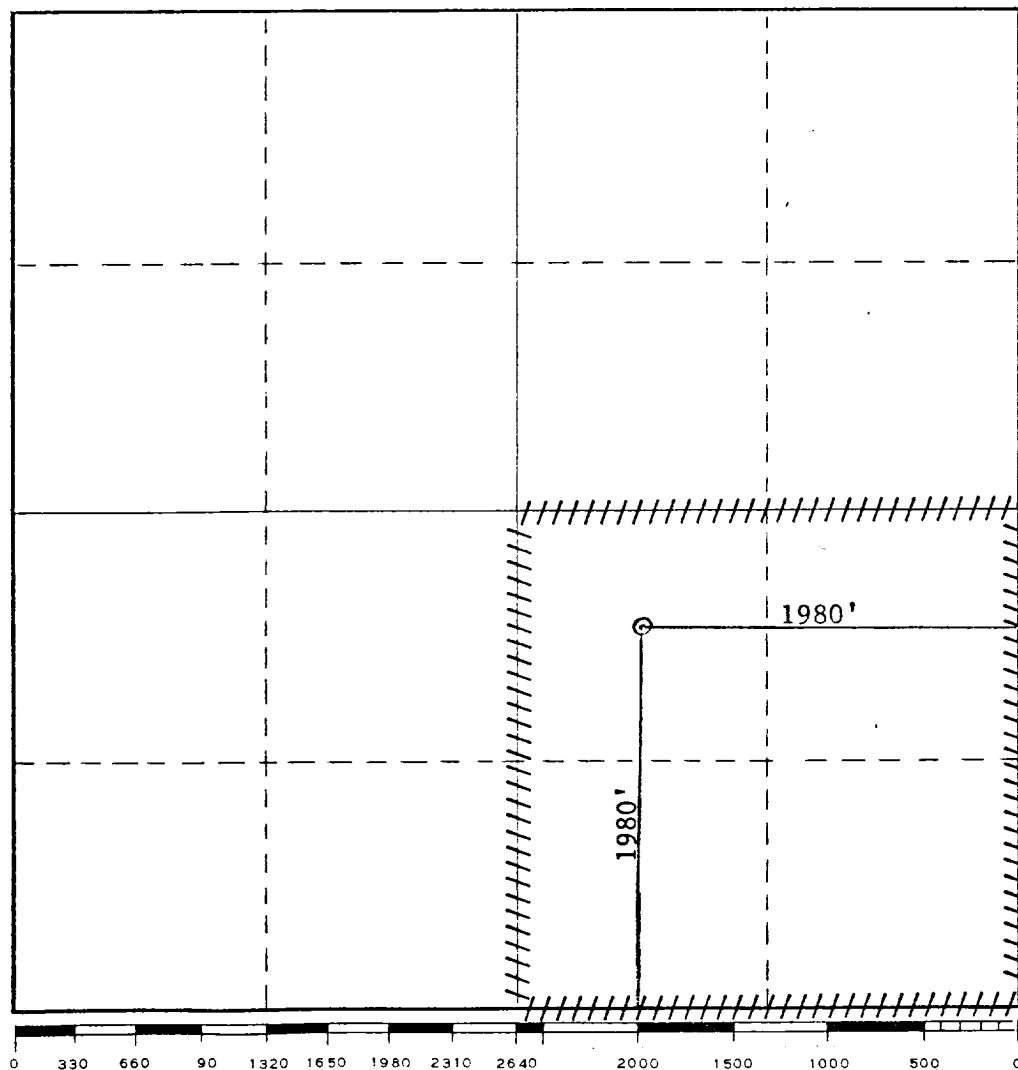

CERTIFICATION

I hereby certify that the information contained herein is true and complete to the best of my knowledge and belief.

Nancy Stoizle
Name **Nancy Stoizle**

Position **Jack Grynberg & Assoc.**

Company
Agent for Viking Petroleum, Inc

Date

I hereby certify that the well location shown on this plat was plotted from field notes of actual surveys made by me or under my supervision, and that the same is true and correct to the best of my knowledge and belief.

See attached original plat

Date Surveyed
prepared 11-25-49

Registered Professional Engineer
and/or Land Surveyor

Certificate No.

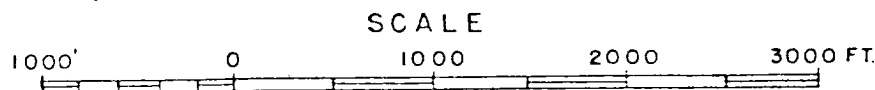
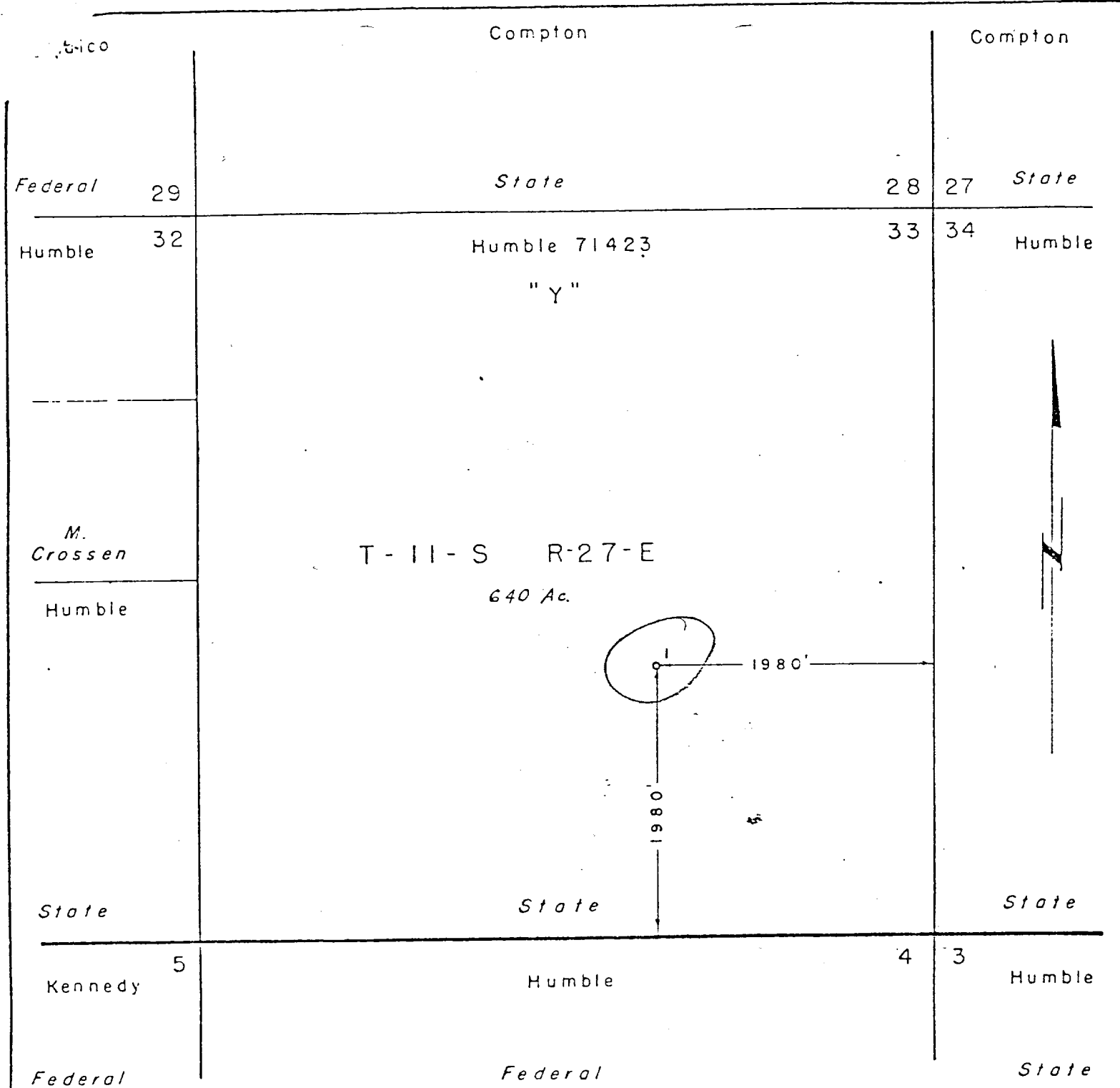

THE STATE OF Texas
COUNTY OF Midland

I hereby certify that I am a registered professional engineer and/or land surveyor in the State of New Mexico; that I am familiar with the conditions actually existing on this land and the adjoining land; that this plat accurately shows, according to the scale indicated thereon, the courses and distances of the proposed well location from public land survey corners and section lines.

Surveyed 22 day of Nov 1949

Harvey E. Neal
Registered Professional Engineer & Land Surveyor
in the State of New Mexico. (Seal)

NEW MEXICO STATE "Y" NO. 71423
SEC. 33 T-11-S R-27-E CHAVES CO. NM

HUMBLE OIL & REFINING COMPANY
CIVIL ENGINEERING DIVISION
MIDLAND, TEXAS

DRAWN D. L. MCKIBBIN
CHECKED [Signature]
APPR. _____

SCALE 1" = 1000'
DATE 11-25-49
REVISED _____

FILE NO.
WT-A 910

Viking Petroleum, Inc.
#1-33 State
1980' FSL & 1980' FEL
Section 33, T 11 S - R 27 E
Chaves County, New Mexico

BLOWOUT PREVENTER DIAGRAM

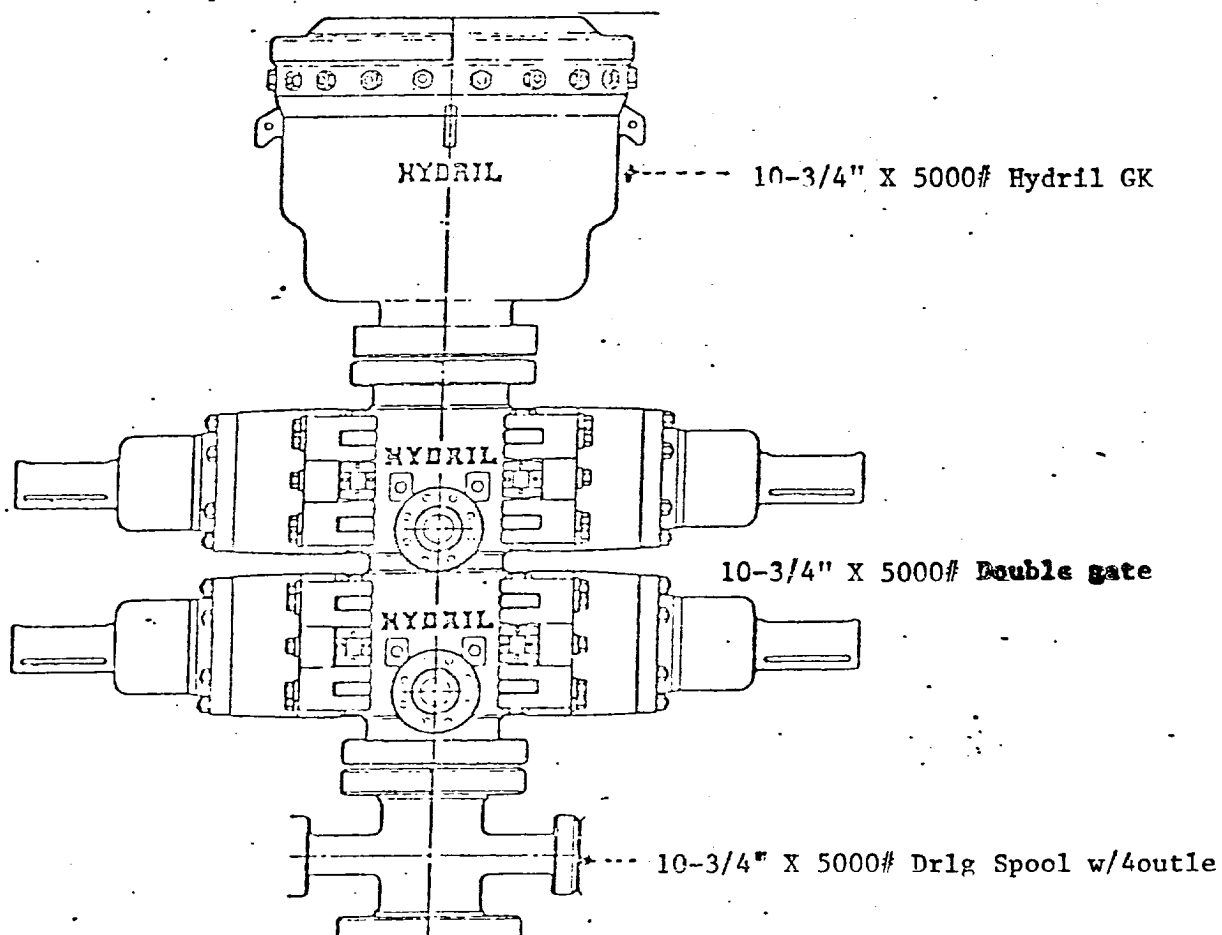

JACK GRYNBERG AND ASSOCIATES
PETROLEUM, GEOLOGICAL, GEOPHYSICAL AND MINING ENGINEERS

1050 17th STREET • SUITE 1950 • DENVER, COLORADO 80265 • PHONE 303 - 572-1455

TELEX: 45-4497 ENERGY DVR
TELECOPIER: 303-623-5224

September 22, 1981

RECEIVED

SEP 24 1981

Oil Conservation Division
Mr. W.A. Gressett, District Supervisor
Drawer DD
Artesia, New Mexico 88210

O. C. O.
ARTESIA OFFICE

RE: Application for Permit to Reenter (Form C-101)
and Dedication Plat (Form C-102)
Viking Petroleum, Inc.
#1-33 State
1980' FEL & 1980' FSL
Section 33, T11S-R27E
Chaves County, New Mexico

Dear Mr. Gressett:

Enclosed please find six (6) copies of the A.D.P. for the subject reentry well. Viking Petroleum, Inc. does have a current blanket plugging bond and a current blanket damage bond.

MacChase Drilling Company out of Artesia has a rig ready to move on the location. Your prompt review and approval is greatly appreciated.

Please notify me if you require further information.

Very truly yours,

JACK GRYNBERG AND ASSOCIATES
AGENT FOR VIKING PETROLEUM, INC.

Nancy Stolzle

Nancy Stolzle
Senior Landman

NS:gh
CC: State Land Board
Viking Petroleum, Inc.