

APPROVED NOV 6 1959
FORM 9050
(Feb. 1957)
DISTRICT ENGINEER

DCC - Artesia

Budget Bureau No. 42-E238.4.
Approval expires 12-31-60.

(SUBMIT IN TRIPLICATE)

Land Office **L. C.**

Lease No. **070511**

Unit

UNITED STATES
DEPARTMENT OF THE INTERIOR
GEOLOGICAL SURVEY

RECEIVED

SUNDRY NOTICES AND REPORTS ON WELLS

NOV 10 1959

30-005-00331

NOTICE OF INTENTION TO DRILL	<input checked="" type="checkbox"/>	SUBSEQUENT REPORT OF WATER SHUT-OFF	
NOTICE OF INTENTION TO CHANGE PLANS		SUBSEQUENT REPORT OF SHOOTING OR ACIDIZING	
NOTICE OF INTENTION TO TEST WATER SHUT-OFF		SUBSEQUENT REPORT OF ALTERING CASING	
NOTICE OF INTENTION TO RE-DRILL OR REPAIR WELL		SUBSEQUENT REPORT OF RE-DRILLING OR REPAIR	
NOTICE OF INTENTION TO SHOOT OR ACIDIZE		SUBSEQUENT REPORT OF ABANDONMENT	
NOTICE OF INTENTION TO PULL OR ALTER CASING		SUPPLEMENTARY WELL HISTORY	
NOTICE OF INTENTION TO ABANDON WELL			

(INDICATE ABOVE BY CHECK MARK NATURE OF REPORT, NOTICE, OR OTHER DATA)

November 2, 1959

Well No. **1** is located **1650** ft. from **[N]** line and **330** ft. from **[E]** line of sec. **5**
Humble-Federal
NW/4 Sec. 5 **12 South, 27 East** **NMPM**
(1/4 Sec. and Sec. No.) (Twp.) (Range) (Meridian)
Wildcat **Chaves** **New Mexico.**
(Field) (County or Subdivision) (State or Territory)

The elevation of the derrick floor above sea level is **2682** ft.

DETAILS OF WORK

(State names of and expected depths to objective sands; show sizes, weights, and lengths of proposed casings; indicate mudding jobs, cementing points, and all other important proposed work)

100 feet 8 5/8" cemented and circulated with 40 sacks.
Drill to 1000 feet or 100 feet into Queen sand.
Core Queen sand.

RECEIVED

NOV 6 - 1959

GEOLOGICAL SURVEY
ROSSELL, NEW MEXICO

I understand that this plan of work must receive approval in writing by the Geological Survey before operations may be commenced.

Company **G-M-K Oil Company**
Address **Midland Savings & Loan Bldg.**
Midland, Texas

By **Norman L. Stevens, Jr.**
Title **Agent**

CONFIDENTIAL

1. *Chlorophyll a* (Chl *a*)
 2. *Chlorophyll b* (Chl *b*)
 3. *Chlorophyll c* (Chl *c*)
 4. *Chlorophyll d* (Chl *d*)
 5. *Chlorophyll e* (Chl *e*)
 6. *Chlorophyll f* (Chl *f*)
 7. *Chlorophyll g* (Chl *g*)
 8. *Chlorophyll h* (Chl *h*)
 9. *Chlorophyll i* (Chl *i*)
 10. *Chlorophyll j* (Chl *j*)
 11. *Chlorophyll k* (Chl *k*)
 12. *Chlorophyll l* (Chl *l*)
 13. *Chlorophyll m* (Chl *m*)
 14. *Chlorophyll n* (Chl *n*)
 15. *Chlorophyll o* (Chl *o*)
 16. *Chlorophyll p* (Chl *p*)
 17. *Chlorophyll q* (Chl *q*)
 18. *Chlorophyll r* (Chl *r*)
 19. *Chlorophyll s* (Chl *s*)
 20. *Chlorophyll t* (Chl *t*)
 21. *Chlorophyll u* (Chl *u*)
 22. *Chlorophyll v* (Chl *v*)
 23. *Chlorophyll w* (Chl *w*)
 24. *Chlorophyll x* (Chl *x*)
 25. *Chlorophyll y* (Chl *y*)
 26. *Chlorophyll z* (Chl *z*)
 27. *Chlorophyll aa* (Chl *aa*)
 28. *Chlorophyll ab* (Chl *ab*)
 29. *Chlorophyll ac* (Chl *ac*)
 30. *Chlorophyll ad* (Chl *ad*)
 31. *Chlorophyll ae* (Chl *ae*)
 32. *Chlorophyll af* (Chl *af*)
 33. *Chlorophyll ag* (Chl *ag*)
 34. *Chlorophyll ah* (Chl *ah*)
 35. *Chlorophyll ai* (Chl *ai*)
 36. *Chlorophyll aj* (Chl *aj*)
 37. *Chlorophyll ak* (Chl *ak*)
 38. *Chlorophyll al* (Chl *al*)
 39. *Chlorophyll am* (Chl *am*)
 40. *Chlorophyll an* (Chl *an*)
 41. *Chlorophyll ao* (Chl *ao*)
 42. *Chlorophyll ap* (Chl *ap*)
 43. *Chlorophyll aq* (Chl *aq*)
 44. *Chlorophyll ar* (Chl *ar*)
 45. *Chlorophyll as* (Chl *as*)
 46. *Chlorophyll at* (Chl *at*)
 47. *Chlorophyll au* (Chl *au*)
 48. *Chlorophyll av* (Chl *av*)
 49. *Chlorophyll aw* (Chl *aw*)
 50. *Chlorophyll ax* (Chl *ax*)
 51. *Chlorophyll ay* (Chl *ay*)
 52. *Chlorophyll az* (Chl *az*)
 53. *Chlorophyll aza* (Chl *aza*)
 54. *Chlorophyll abz* (Chl *abz*)
 55. *Chlorophyll acz* (Chl *acz*)
 56. *Chlorophyll adz* (Chl *adz*)
 57. *Chlorophyll aez* (Chl *aez*)
 58. *Chlorophyll afz* (Chl *afz*)
 59. *Chlorophyll agz* (Chl *agz*)
 60. *Chlorophyll ahz* (Chl *ahz*)
 61. *Chlorophyll aiz* (Chl *aiz*)
 62. *Chlorophyll ajz* (Chl *ajz*)
 63. *Chlorophyll akz* (Chl *akz*)
 64. *Chlorophyll alz* (Chl *alz*)
 65. *Chlorophyll amz* (Chl *amz*)
 66. *Chlorophyll anz* (Chl *anz*)
 67. *Chlorophyll aoz* (Chl *aoz*)
 68. *Chlorophyll apz* (Chl *apz*)
 69. *Chlorophyll aqz* (Chl *aqz*)
 70. *Chlorophyll arz* (Chl *arz*)
 71. *Chlorophyll asz* (Chl *asz*)
 72. *Chlorophyll atz* (Chl *atz*)
 73. *Chlorophyll auz* (Chl *auz*)
 74. *Chlorophyll avz* (Chl *avz*)
 75. *Chlorophyll awz* (Chl *awz*)
 76. *Chlorophyll axz* (Chl *axz*)
 77. *Chlorophyll ayz* (Chl *ayz*)
 78. *Chlorophyll azz* (Chl *azz*)
 79. *Chlorophyll azaa* (Chl *aza*
 80. *Chlorophyll abz* (Chl *abz*)
 81. *Chlorophyll acz* (Chl *acz*)
 82. *Chlorophyll adz* (Chl *adz*)
 83. *Chlorophyll aez* (Chl *aez*)
 84. *Chlorophyll afz* (Chl *afz*)
 85. *Chlorophyll agz* (Chl *agz*)
 86. *Chlorophyll ahz* (Chl *ahz*)
 87. *Chlorophyll aiz* (Chl *aiz*)
 88. *Chlorophyll ajz* (Chl *ajz*)
 89. *Chlorophyll akz* (Chl *akz*)
 90. *Chlorophyll alz* (Chl *alz*)
 91. *Chlorophyll amz* (Chl *amz*)
 92. *Chlorophyll anz* (Chl *anz*)
 93. *Chlorophyll aoz* (Chl *aoz*)
 94. *Chlorophyll apz* (Chl *apz*)
 95. *Chlorophyll aqz* (Chl *aqz*)
 96. *Chlorophyll arz* (Chl *arz*)
 97. *Chlorophyll asz* (Chl *asz*)
 98. *Chlorophyll atz* (Chl *atz*)
 99. *Chlorophyll auz* (Chl *auz*)
 100. *Chlorophyll avz* (Chl *avz*)
 101. *Chlorophyll awz* (Chl *awz*)
 102. *Chlorophyll axz* (Chl *axz*)
 103. *Chlorophyll ayz* (Chl *ayz*)
 104. *Chlorophyll azz* (Chl *azz*)
 105. *Chlorophyll azaa* (Chl *aza*
 106. *Chlorophyll abz* (Chl *abz*)
 107. *Chlorophyll acz* (Chl *acz*)
 108. *Chlorophyll adz* (Chl *adz*)
 109. *Chlorophyll aez* (Chl *aez*)
 110. *Chlorophyll afz* (Chl *afz*)
 111. *Chlorophyll agz* (Chl *agz*)
 112. *Chlorophyll ahz* (Chl *ahz*)
 113. *Chlorophyll aiz* (Chl *aiz*)
 114. *Chlorophyll ajz* (Chl *ajz*)
 115. *Chlorophyll akz* (Chl *akz*)
 116. *Chlorophyll alz* (Chl *alz*)
 117. *Chlorophyll amz* (Chl *amz*)
 118. *Chlorophyll anz* (Chl *anz*)
 119. *Chlorophyll aoz* (Chl *aoz*)
 120. *Chlorophyll apz* (Chl *apz*)
 121. *Chlorophyll aqz* (Chl *aqz*)
 122. *Chlorophyll arz* (Chl *arz*)
 123. *Chlorophyll asz* (Chl *asz*)
 124. *Chlorophyll atz* (Chl *atz*)
 125. *Chlorophyll auz* (Chl *auz*)
 126. *Chlorophyll avz* (Chl *avz*)
 127. *Chlorophyll awz* (Chl *awz*)
 128. *Chlorophyll axz* (Chl *axz*)
 129. *Chlorophyll ayz* (Chl *ayz*)
 130. *Chlorophyll azz* (Chl *azz*)
 131. *Chlorophyll azaa* (Chl *aza*
 132. *Chlorophyll abz* (Chl *abz*)
 133. *Chlor*

NEW MEXICO OIL CONSERVATION COMMISSION
WELL LOCATION AND ACREAGE DEDICATION PLAT

FORM C-128
Revised 5/1/57

SEE INSTRUCTIONS FOR COMPLETING THIS FORM ON THE REVERSE SIDE

SECTION A

Operator G-M-K Oil Company		Lease Humble-Federal		Well No. 1
Unit Letter E	Section 5	Township 12 South	Range 27 East	County Chaves
Actual Footage Location of Well: 1650 feet from the North line and 330 feet from the West line				
Ground Level Elev. 3682	Producing Formation Pearse		Pool Wildcat	Dedicated Acreage: 40 Acres

1. Is the Operator the only owner in the dedicated acreage outlined on the plat below? YES ☒ NO ____ . ("Owner" means the person who has the right to drill into and to produce from any pool and to appropriate the production either for himself or for himself and another. (65-3-29 (e) NMSA 1935 Comp.)
2. If the answer to question one is "no," have the interests of all the owners been consolidated by communitization agreement or otherwise? YES ____ NO ____ . If answer is "yes," Type of Consolidation ____
3. If the answer to question two is "no," list all the owners and their respective interests below:

Owner	Land Description

RECEIVED
NOV 3 - 1959

SECTION B

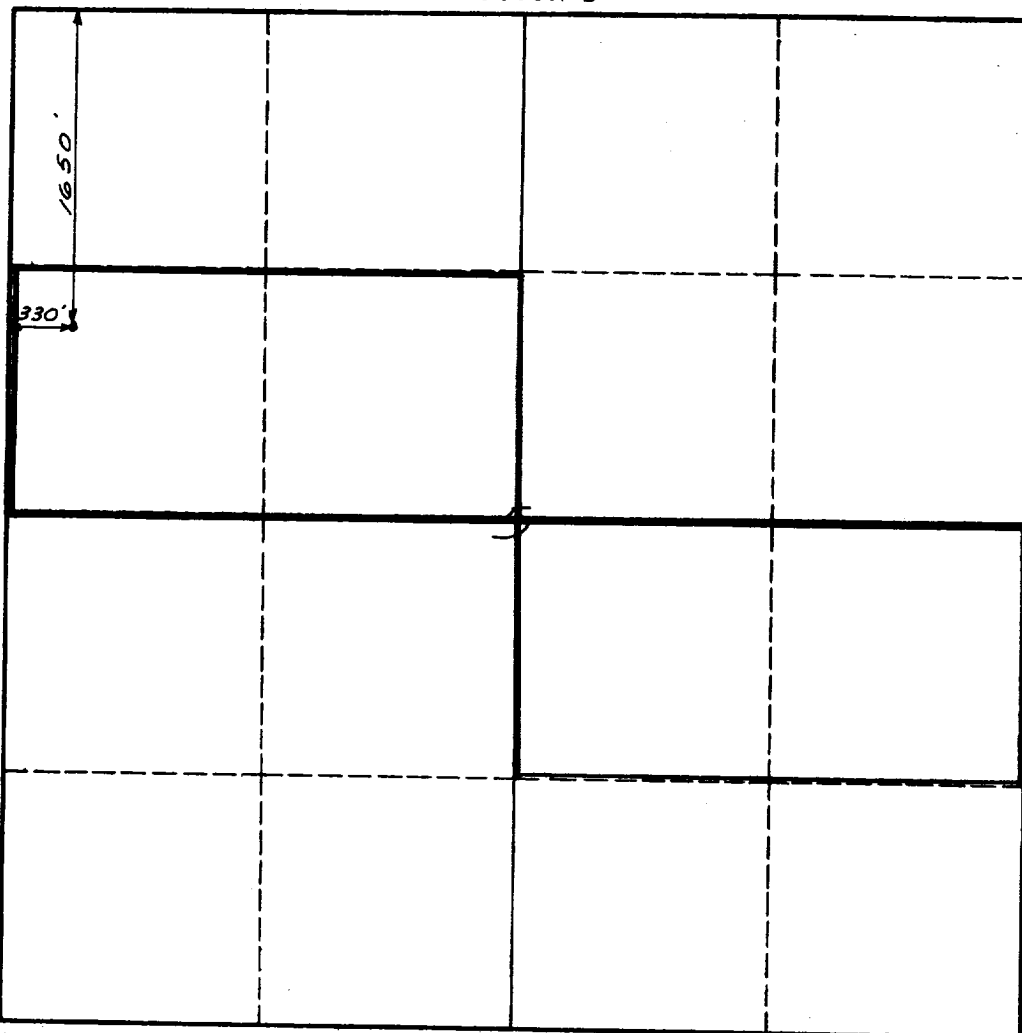

U. S. GEOLOGICAL SURVEY
NEW MEXICO
RECONSTRUCTION

I hereby certify that the information in SECTION A above is true and complete to the best of my knowledge and belief.

Name **(Norman L. Stevens, Jr.)**
Agent

Position
G-M-K Oil Company

Company
November 5, 1959

Date

I hereby certify that the well location shown on the plat in SECTION B was plotted from field notes of actual surveys made by me or under my supervision, and that the same is true and correct to the best of my knowledge and belief.

October 30, 1959
Date Surveyed

Norman E. Hall
Registered Professional Engineer
and/or Land Surveyor

3241
Certificate No.

0 330 660 990 1320 1650 1980 2310 2640 2000 1500 1000 500 0

INSTRUCTIONS FOR COMPLETION OF FORM C-128

1. Operator shall furnish and certify to the information called for in Section A.
2. Operator shall outline the dedicated acreage for *both* oil and gas wells on the plat in Section B.
3. A registered professional engineer or land surveyor registered in the State of New Mexico or approved by the Commission shall show on the plat the location of the well and certify this information in the space provided.
4. All distances shown on the plat must be from the outer boundaries of the Section.
5. If additional space is needed for listing owners and their respective interests as required in question 3 of Section A, please use space below.