

NEW MEXICO  
OIL CONSERVATION COMMISSION

Form C-128

Well Location and/or Gas Proration Plat

Date Feb. 8, 1956

Operator L. C. Harris Lease Honolulu-State

Well No. 1 Section 29 Township 12 S Range 27 E NMPM

Located 660 Feet From North Line, 660 Feet From West Line,

Chaves County, New Mexico. G. L. Elevation 3611.1

Name of Producing Formation San Andreas Pool \_\_\_\_\_ Dedicated Acreage \_\_\_\_\_

(Note: All distances must be from outer boundaries of Section)

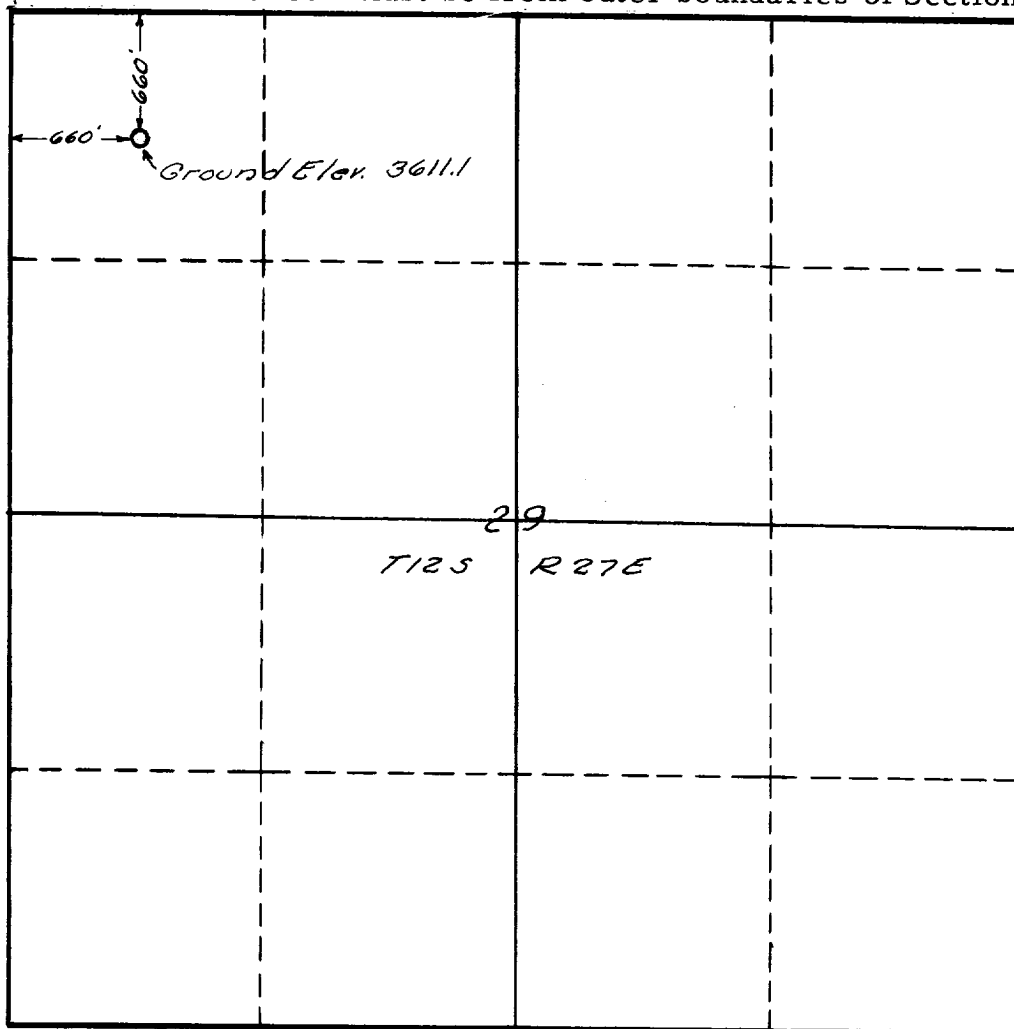

SCALE: 1"=1000'

1. Is this Well a Dual Comp. ? Yes \_\_\_ No X.
2. If the answer to Question 1 is yes, are there any other dually completed wells within the dedicated acreage? Yes \_\_\_ No \_\_\_.

This is to certify that the above plat was prepared from field notes of actual surveys made by me or under my supervision and that the same are true and correct to the best of my knowledge and belief.

Name L. C. Harris  
Position \_\_\_\_\_  
Representing \_\_\_\_\_  
Address Box 6657, Roswell, NM

Date Surveyed February 8, 1956  
Marion Engineering Co. By: Raymond T. West  
Registered Professional Engineer and/or  
Land Surveyor C.S. No. 1697