

(SUBMIT IN TRIPLICATE)

Land Office **New Mexico**

Lease No. **NM 047005**

UNITED STATES
DEPARTMENT OF THE INTERIOR
GEOLOGICAL SURVEY

NOBBS OFFICE OCC

1959 OCT 7 AM 10:04 30-005-00401

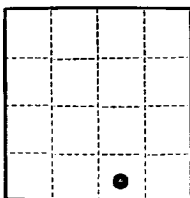

SUNDRY NOTICES AND REPORTS ON WELLS

NOTICE OF INTENTION TO DRILL.....	<input checked="" type="checkbox"/>	SUBSEQUENT REPORT OF WATER SHUT-OFF.....	
NOTICE OF INTENTION TO CHANGE PLANS.....		SUBSEQUENT REPORT OF SHOOTING OR ACIDIZING.....	
NOTICE OF INTENTION TO TEST WATER SHUT-OFF.....		SUBSEQUENT REPORT OF ALTERING CASING.....	
NOTICE OF INTENTION TO RE-DRILL OR REPAIR WELL.....		SUBSEQUENT REPORT OF RE-DRILLING OR REPAIR.....	
NOTICE OF INTENTION TO SHOOT OR ACIDIZE.....		SUBSEQUENT REPORT OF ABANDONMENT.....	
NOTICE OF INTENTION TO PULL OR ALTER CASING.....		SUPPLEMENTARY WELL HISTORY.....	
NOTICE OF INTENTION TO ABANDON WELL.....			

(INDICATE ABOVE BY CHECK MARK NATURE OF REPORT, NOTICE, OR OTHER DATA)

October 2, 19 59

Magnolia-Federal
Well No. **#1-24** is located **660** ft. from **XX** line and **1980** ft. from **E** line of sec. **24**

SW SE Sec. 24 **7-S** **29-E**
(1/4 Sec. and Sec. No.) (Twp.) (Range) (Meridian)

Wildcat **Chaves** **New Mexico**
(Field) (County or Subdivision) (State or Territory)

The elevation of the **Ground** ~~surface~~ above sea level is **4098.8** ft.

DETAILS OF WORK

(State names of and expected depths to objective sands; show sizes, weights, and lengths of proposed casings; indicate mudding jobs, cementing points, and all other important proposed work)

Plan to drill a well to an estimated total depth of 8,000' with Rotary Tools to test the Devonian formation. All potential zones, if warranted, will be drillstem tested. Approximately 2400' of 9 5/8" OD casing will be set and cemented with sufficient cement to circulate to the surface. If an oil string is warranted, 5 1/2" OD casing will be run and cemented with sufficient cement to protect all potential zones. Plans are to mud-up at 5800'.

I understand that this plan of work must receive approval in writing by the Geological Survey before operations may be commenced.

Company **INTEX OIL COMPANY**

Address **P. O. BOX 122**

MIDLAND, TEXAS

By *J. Stewart Martin*
J. Stewart Martin
Title **Engineer**

NEW MEXICO OIL CONSERVATION COMMISSION
Well Location and Acreage Dedication Plat

Section A.

Date October 2, 1959

Operator INTEY OIL COMPANY Lease MAGNOLIA-FEDERAL
Well No. 1-24 Unit Letter 0 Section 24 Township 7-S Range 29-E NMFM
Located 660 Feet From SOUTH Line, 1980 Feet From EAST Line
County CHAVEZ, NEW MEXICO G. L. Elevation 4098.8 Dedicated Acreage _____ Acres
Name of Producing Formation _____ Pool _____

1. Is the Operator the only owner* in the dedicated acreage outlined on the plat below?
Yes _____ No _____.
2. If the answer to question one is "no," have the interests of all the owners been consolidated by communitization agreement or otherwise? Yes _____ No _____. If answer is "yes," Type of Consolidation _____
3. If the answer to question two is "no," list all the owners and their respective interests below:

Owner

Land Description

Section B

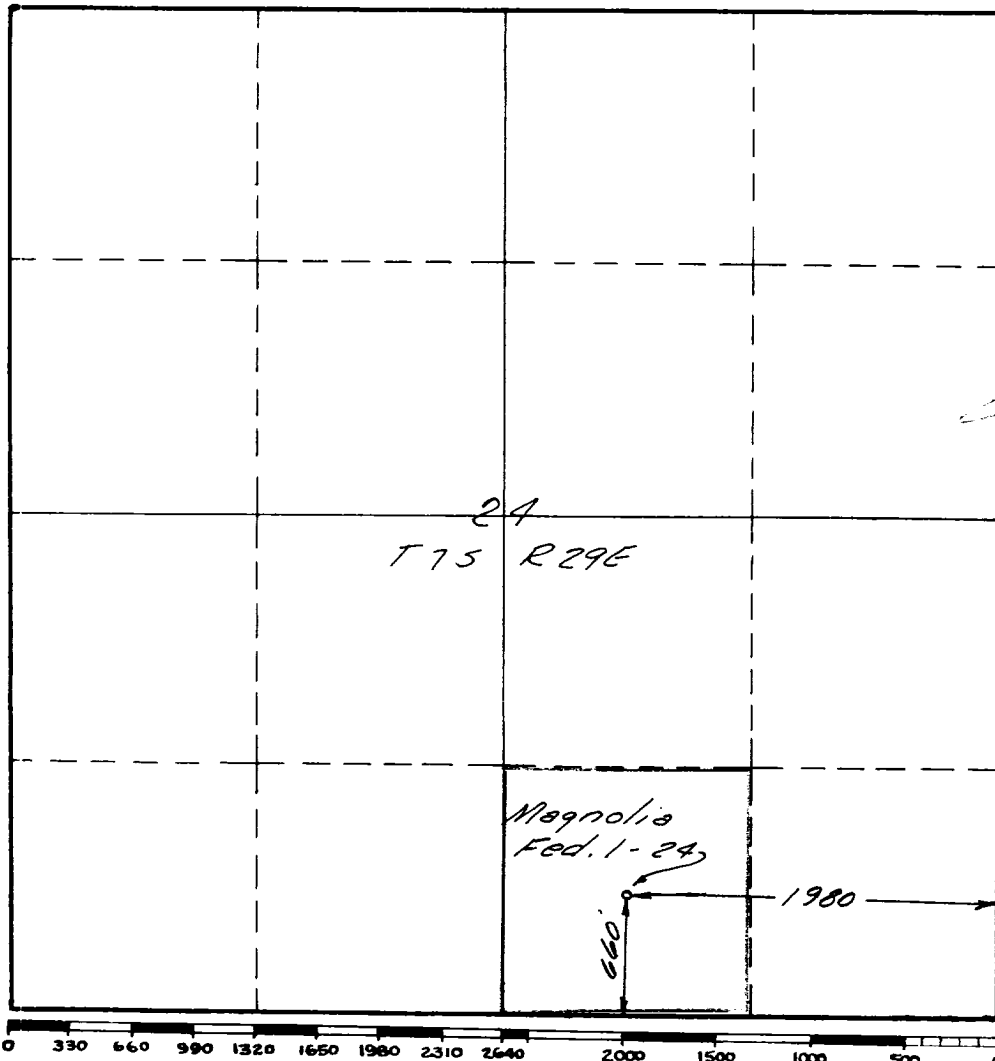

This is to certify that the information in Section A above is true and complete to the best of my knowledge and belief.

INTEY OIL COMPANY
(Operator)
J. STEWART MARTIN
(Representative)

P. O. BOX 122, MIDLAND, TEX.
Address

This is to certify that the well location shown on the plat in Section B was plotted from field notes of actual surveys made by me or under my supervision and that the same is true and correct to the best of my knowledge and belief.

Date Surveyed Sept. 26, 1959
Mann Engineering Co.
By: Raynes J. Mann
Registered Professional
Engineer and/or Land Surveyor.

Certificate No. 1697

INSTRUCTIONS FOR COMPLETION:

1. Operator shall furnish and certify to the information called for in Section A.
2. Operator shall outline the dedicated acreage for both oil and gas wells on the plat in Section B.
3. A registered professional engineer or land surveyor registered in the State of New Mexico or approved by the Commission shall show on the plat the location of the well and certify this information in the space provided.
4. All distances shown on the plat must be from the outer boundaries of Section.
5. If additional space is needed for listing owners and their respective interests as required in question 3, Section A, please use space below

* "Owner" means the person who has the right to drill into and to produce from any pool and to appropriate the production either for himself or for himself and another. (65-3-29 (e) NMSA 1953 Comp.)