

NO. OF COPIES RECEIVED	
DISTRIBUTION	
SANTA FE	1
FILE	1 ✓
U.S.G.S.	2
LAND OFFICE	
OPERATOR	1

NEW MEXICO OIL CONSERVATION COMMISSION

RECEIVED

NOV 03 1981

O. C. D.  
ARTESIA, OFFICE

Form C-101  
Revised 1-1-65

5A. Indicate Type of Lease STATE <input type="checkbox"/> FEE <input checked="" type="checkbox"/>	
5. State Oil & Gas Lease No.	
7. Unit Agreement Name	
8. Farm or Lease Name KOL	
9. Well No. 1	
10. Field and Pool, or Wildcat Wildcat-San Andres	
12. County Chaves	
19. Proposed Depth 3000	19A. Formation San Andres
20. Rotary or C.T. Workover Unit	
21. Elevations (Show whether DF, RT, etc.) 3880 Gr	21A. Kind & Status Plug. Bond State wide
21B. Drilling Contractor General Petroleum	
22. Approx. Date Work will start	

APPLICATION FOR PERMIT TO DRILL, DEEPEN, OR PLUG BACK

1a. Type of Work DRILL <input checked="" type="checkbox"/> <i>Re Entry</i> DEEPEN <input type="checkbox"/> PLUG BACK <input type="checkbox"/>	
b. Type of Well OIL WELL <input checked="" type="checkbox"/> GAS WELL <input type="checkbox"/> OTHER <input type="checkbox"/> SINGLE ZONE <input checked="" type="checkbox"/> MULTIPLE ZONE <input type="checkbox"/>	
2. Name of Operator TOM L. INGRAM ✓	
3. Address of Operator P. O. Box 1757, Roswell, New Mexico 88201	
4. Location of Well UNIT LETTER <u>G</u> LOCATED <u>2305</u> FEET FROM THE <u>North</u> LINE AND <u>1651</u> FEET FROM THE <u>East</u> LINE OF SEC. <u>7</u> TWP. <u>10-S</u> RGE. <u>29-E</u> NMPM	
21. Elevations (Show whether DF, RT, etc.) 3880 Gr	
21A. Kind & Status Plug. Bond State wide	
21B. Drilling Contractor General Petroleum	
22. Approx. Date Work will start	

PROPOSED CASING AND CEMENT PROGRAM

SIZE OF HOLE	SIZE OF CASING	WEIGHT PER FOOT	SETTING DEPTH	SACKS OF CEMENT	EST. TOP
12 1/4	9 5/8	36	2315	500	Circ*
8 2/4	7 5/8	23	3000	100	

Will drill out plugs to 3000', run casing, perforate, stimulate and complete.

\*Originally drilled by Zapata Petroleum Corp. and re-entered by J. P. White and plugged by both. *ID 8642 RA 3-6-62*

BOP will be used.

*Posted ID-1  
+ 11L Book  
Re-Entry  
11-6-81*

APPROVAL VALID FOR 180 DAYS  
PERMIT EXPIRES 5-5-82  
UNLESS DRILLING UNDERWAY

IN ABOVE SPACE DESCRIBE PROPOSED PROGRAM: IF PROPOSAL IS TO DEEPEN OR PLUG BACK, GIVE DATA ON PRESENT PRODUCTIVE ZONE AND PROPOSED NEW PRODUCTIVE ZONE. GIVE BLOWOUT PREVENTER PROGRAM, IF ANY.

I hereby certify that the information above is true and complete to the best of my knowledge and belief.

Signed *Tom L. Ingram* Title Operator Date 11-1-81

(This space for State Use)

APPROVED BY *M. Williams* TITLE *State Engineer* DATE *11-1-81*

CONDITIONS OF APPROVAL, IF ANY:

NEW MEXICO OIL CONSERVATION COMMISSION  
WELL LOCATION AND ACREAGE DEDICATION PLAT

Form C-102  
Supersedes C-128  
Effective 1-1-65

All distances must be from the outer boundaries of the Section.

Operator <b>TOM L. INGRAM</b>			Lease <b>KOL</b>		Well No. <b>1</b>
Unit Letter <b>G</b>	Section <b>7</b>	Township <b>10-S</b>	Range <b>29-E</b>	County <b>Chaves</b>	
Actual Footage Location of Well: <b>1651</b> feet from the <b>East</b> line and <b>2305</b> feet from the <b>North</b> line					
Ground Level Elev: <b>3880</b>	Producing Formation <b>San Andres</b>		Pool <b>Wildcat</b>	Dedicated Acreage: <b>40</b> Acres	

1. Outline the acreage dedicated to the subject well by colored pencil or hatchure marks on the plat below.
2. If more than one lease is dedicated to the well, outline each and identify the ownership thereof (both as to working interest and royalty).
3. If more than one lease of different ownership is dedicated to the well, have the interests of all owners been consolidated by communitization, unitization, force-pooling, etc?

☐ Yes ☐ No If answer is "yes," type of consolidation \_\_\_\_\_

If answer is "no," list the owners and tract descriptions which have actually been consolidated. (Use reverse side of this form if necessary.) \_\_\_\_\_

No allowable will be assigned to the well until all interests have been consolidated (by communitization, unitization, forced-pooling, or otherwise) or until a non-standard unit, eliminating such interests, has been approved by the Commission.

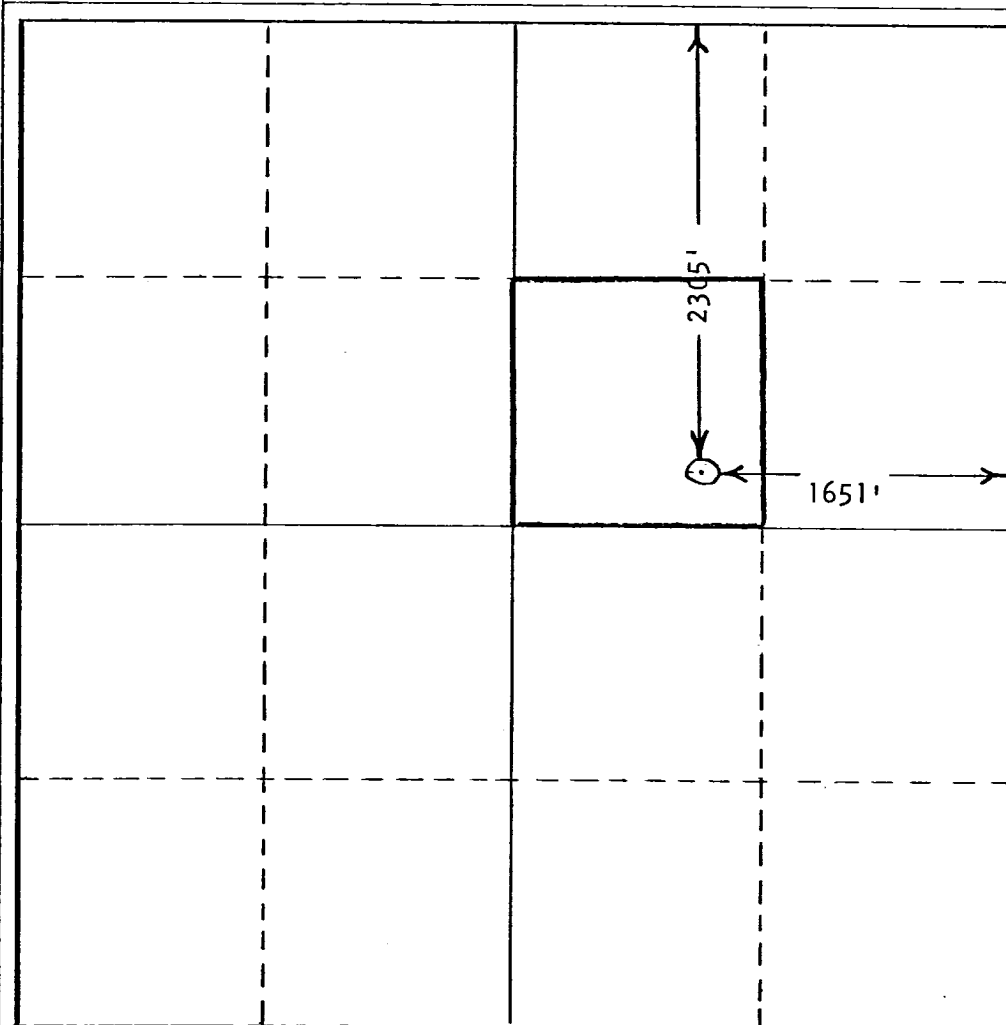

CERTIFICATION

I hereby certify that the information contained herein is true and complete to the best of my knowledge and belief.

*Tom L. Ingram*

Name  
**TOM L. INGRAM**  
Position  
**Operator**  
Company  
**Tom L. Ingram**  
Date  
**11-1-81**

I hereby certify that the well location shown on this plat was plotted from field notes of actual surveys made by me or under my supervision, and that the same is true and correct to the best of my knowledge and belief.

Original Filed

Date Surveyed  
**by Zapata Petroleum Corp.**  
Registered Professional Engineer  
and/or Land Surveyor

Certificate No.

