

RECEIVED

SEP 20 1977

State ☐ Fed ☒

**O. C. C.**  
APPLICATION FOR PERMIT TO DRILL, DEEPEN, OR PLUG BACK

1a. Type of Work Re-DRILL <input checked="" type="checkbox"/> DEEPEN <input type="checkbox"/> PLUG BACK <input type="checkbox"/>		7. Unit Agreement Name	
b. Type of Well OIL WELL <input type="checkbox"/> GAS WELL <input checked="" type="checkbox"/> OTHER <i>Re Entry</i> SINGLE ZONE <input checked="" type="checkbox"/> MULTIPLE ZONE <input type="checkbox"/>		8. Farm or Lease Name Moriah	
2. Name of Operator Tom L. Ingram		9. Well No. 1	
3. Address of Operator P. O. Box 1757, Roswell, N.M. 88201		10. Field and Pool, or Wildcat Wildcat <i>Lease</i>	
4. Location of Well UNIT LETTER <u>J</u> LOCATED <u>1980</u> FEET FROM THE <u>South</u> LINE AND <u>1980</u> FEET FROM THE <u>East</u> LINE OF SEC. <u>7</u> TWP. <u>10-S</u> RGE. <u>29-E</u> NMPM		12. County Chaves	
19. Proposed Depth 8300		19A. Formation Pennsylvanian	
20. Rotary or C.T.		21. Elevations (Show whether DF, RT, etc.) 3879 DF	
21A. Kind & Status Plug. Bond Statewide		21B. Drilling Contractor DA & S	
22. Approx. Date Work will start Upon approval			

PROPOSED CASING AND CEMENT PROGRAM

SIZE OF HOLE	SIZE OF CASING	WEIGHT PER FOOT	SETTING DEPTH	SACKS OF CEMENT	EST. TOP
*	16"	*	45'	30	Circulated
*	10 3/4"	*	2165'	1328	Circulated
*	5 1/2"	*	8320'	800	

Drill plugs run 5 1/2" casing with bowl to old casing, drill remainder of plugs, log, perforate, and complete.

Blowout preventor will be used.

\* Originally drilled by DeKalb Agricultural Association. (No. 1 J.P. White) in 1950.

RECEIVED

TD 8725

SEP 22 1977

O. C. C.  
ARTEBIA, OFFICE

*Gas is not dedicated*

APPROVAL VALID  
FOR 90 DAYS UNLESS  
DRILLING COMMENCED,

EXPIRES 12-23-77

IN ABOVE SPACE DESCRIBE PROPOSED PROGRAM: IF PROPOSAL IS TO DEEPEN OR PLUG BACK, GIVE DATA ON PRESENT PRODUCTIVE ZONE AND PROPOSED NEW PRODUCTIVE ZONE. GIVE BLOWOUT PREVENTER PROGRAM, IF ANY.

I hereby certify that the information above is true and complete to the best of my knowledge and belief.

Signed Tom L. Ingram Title Operator Date 9-19-77  
(This space for State Use)

APPROVED BY W. A. Gussert TITLE SUPERVISOR, DISTRICT II DATE SEP 23 1977

CONDITIONS OF APPROVAL, IF ANY:

# WELL LOCATION / WELLBORE LOCATION

AN INTERESTED PARTY TO THIS WELL BORE LOCATION IS THE

Operator <b>Tom L. Ingram</b>		Lease <b>Moriah</b>		Well No. <b>1</b>
Unit Letter <b>J</b>	Section <b>7</b>	Township <b>10-S</b>	Range <b>29-E</b>	County <b>Chaves</b>
Actual Footage Location of Well: <b>1980</b> feet from the <b>South</b> line and <b>1980</b> feet from the <b>East</b> line				
Ground Level Elev: <b>3872</b>	Producing Formation <b>Pennsylvanian</b>	Pool <b>Wildcat</b>	Dedicated Acreage: <b>320</b> Acres	

1. Outline the acreage dedicated to the subject well by colored pencil or hachure marks on the plat below.
2. If more than one lease is dedicated to the well, outline each and identify the ownership thereof (both as to working interest and royalty).
3. If more than one lease of different ownership is dedicated to the well, have the interests of all owners been consolidated by communitization, unitization, force-pooling, etc?

☐ Yes ☒ No If answer is "yes," type of consolidation Communitization being prepared

If answer is "no," list the owners and tract descriptions which have actually been consolidated. (Use reverse side of this form if necessary.) \_\_\_\_\_

No allowable will be assigned to the well until all interests have been consolidated (by communitization, unitization, forced-pooling, or otherwise) or until a non-standard unit, eliminating such interests, has been approved by the Commission.

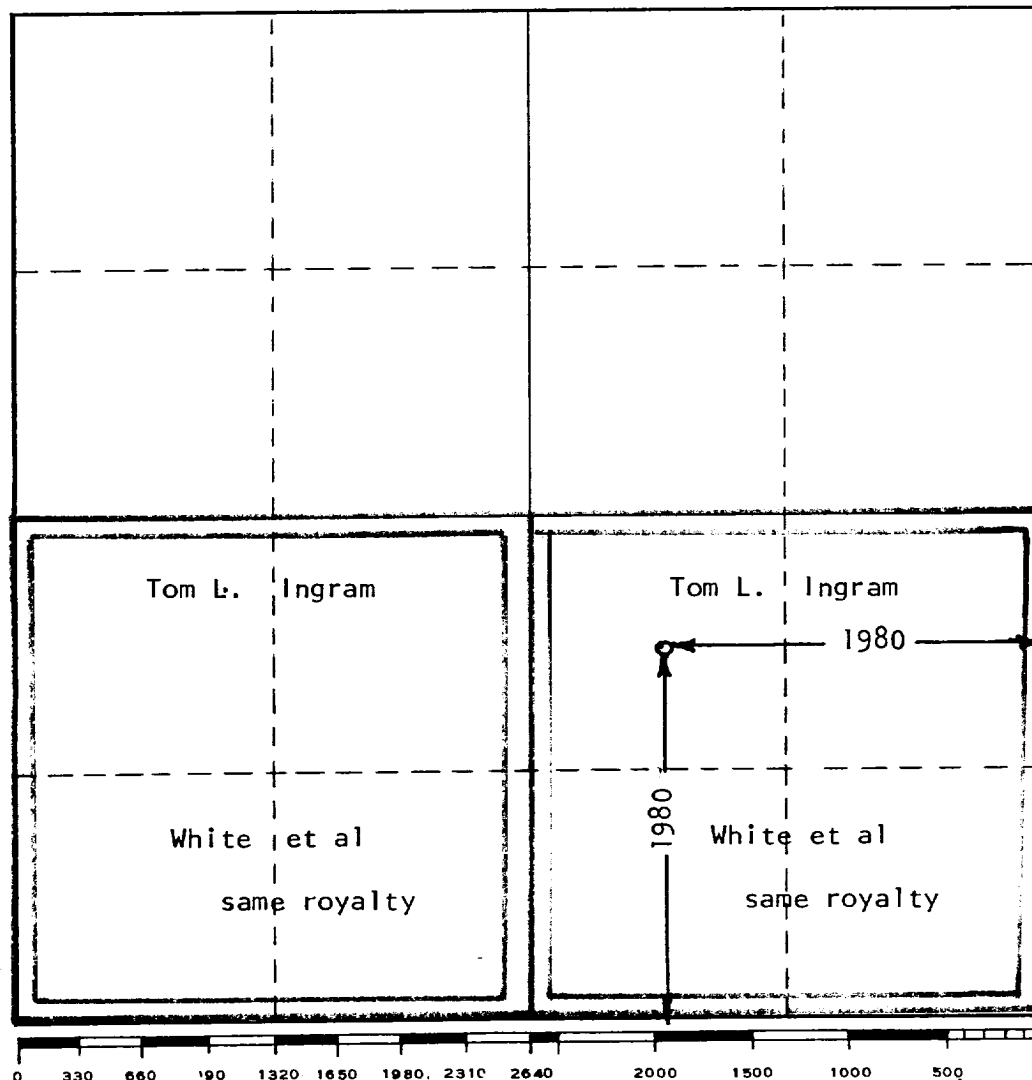

## CERTIFICATION

I hereby certify that the information contained herein is true and complete to the best of my knowledge and belief.

*Tom L. Ingram*  
Name

Tom L. Ingram

Position

Operator

Company

Tom L. Ingram

Date

9-19-77

I hereby certify that the well location shown on this plat was plotted from field notes of actual surveys made by me or under my supervision, and that the same is true and correct to the best of my knowledge and belief.

Original filed by

Date Surveyed

DeKalb Agricultural Assn.

Registered Professional Engineer and/or Land Surveyor

in 1950

Certificate No.

**TOM L. INGRAM**

100 SOUTH KENTUCKY AVENUE  
ROSWELL, NEW MEXICO 88201

**RECEIVED**

**SEP 22 1977**

**O. C. C.**  
**ARTESIA, OFFICE**

September 21, 1977

Mr. W. A. Gressett  
Supervisor, District II  
Oil Conservation Commission  
P. O. Drawer DD  
Artesia, New Mexico 88210

Re: #1 Moriah  
Chaves County, New Mexico

Dear Mr. Gressett:

With reference to the captioned, your letter of September 20th and your telephone conversation with Mr. Ingram this morning, we are returning our Forms C-101 and C-102.

The gas is not dedicated and since we are unable to locate an original survey plat, we will have John West of Hobbs survey this location. *Plat w. 11 be forwarded to you.*

Thank you.

Very truly yours,

TOM L. INGRAM

*Joan Hayes*  
(Mrs.) Joan Hayes

/jh  
Enclos.