

NEW MEXICO OIL CONSERVATION COMMISSION  
Santa Fe, New Mexico

Form G-101  
Revised (12/1/55)

NOTICE OF INTENTION TO DRILL

30-005-10173

Notice must be given to the District Office of the Oil Conservation Commission and approval obtained before drilling or recompletion begins. If changes in the proposed plan are considered advisable, a copy of this notice showing such changes will be returned to the sender. Submit this notice in **QUINTUPPLICATE**. One copy will be returned following approval. See additional instructions in Rules and Regulations of the Commission. If State Land submit 6 Copies Attach Form G- 128 in triplicate to first 3 copies of form G-101

Roswell, New Mexico  
(Place)

September 26, 1963  
(Date)

RECEIVED

OIL CONSERVATION COMMISSION  
SANTA FE, NEW MEXICO

JAN 9 1964

Gentlemen:

You are hereby notified that it is our intention to commence the Drilling of a well to be known as

J. W. Brown

(Company or Operator)

O. C. C.

ARTESIA, OFFICE

State ~~E-92~~

Well No. 11

G

(Unit)

The well is

located 2310

feet from the

North

line and 2310

feet from the

East

Line of Section 26, T 10S, R 26E, NMPM.

(GIVE LOCATION FROM SECTION LINE)

Brown

Pool,

Chaves

County

If State Land the Oil and Gas Lease is No. E-92

If patented land the owner is

Address

We propose to drill well with drilling equipment as follows: Rotary

The status of plugging bond is \$10,000 on file

Drilling Contractor West Texas Drilling Co.  
Odessa, Texas

We intend to complete this well in the Penrose Sand  
formation at an approximate depth of 800 feet.

CASING PROGRAM

We propose to use the following strings of Casing and to cement them as indicated:

Size of Hole	Size of Casing	Weight per Foot	New or Second Hand	Depth	Sacks Cement
4"	2-1/2"	9#	New	Approx. 800'	50 sx. & Circulate

If changes in the above plans become advisable we will notify you immediately.

ADDITIONAL INFORMATION (If recompletion give full details of proposed plan of work.)

RECEIVED

SEP 30 1963

O. C. C.  
ARTESIA, OFFICE

Sincerely yours,

By J. W. Brown

Position Owner-Operator

Send Communications regarding well to

Name J. W. Brown - Nickson Hotel

Address Roswell, New Mexico

Approved \_\_\_\_\_, 19\_\_\_\_\_  
Except as follows:

OIL CONSERVATION COMMISSION

By

RECEIVED

# NEW MEXICO OIL CONSERVATION COMMISSION

## WELL LOCATION AND ACREAGE DEDICATION PLAT

JAN 1963 128  
Rev. 1-1-57O. C. C.  
ARTESIA, OFFICE

SEE INSTRUCTIONS FOR COMPLETING THIS FORM ON THE REVERSE SIDE

## SECTION A

Operator

J. W. BROWN

Lease

STATE ~~NEW~~ MEXICO

Well No.

11

Unit Letter

G

Section

26

Township

10 SOUTH

Range

26 EAST

County

CHAVES

Actual Footage Location of Well:

2310

feet from the

NORTH

line and

2310

feet from the

EAST

line

Ground Level Elev.

8729.65

Producing Formation

Penrose

Pool

Brown pool

Dedicated Acreage:

10

Acres

1. Is the Operator the only owner in the dedicated acreage outlined on the plat below? YES \_\_\_\_\_ NO \_\_\_\_\_. ("Owner" means the person who has the right to drill into and to produce from any pool and to appropriate the production either for himself or for himself and another. (65-3-29 (e) NMSA 1935 Comp.)
2. If the answer to question one is "no," have the interests of all the owners been consolidated by communitization agreement or otherwise? YES \_\_\_\_\_ NO \_\_\_\_\_. If answer is "yes," Type of Consolidation \_\_\_\_\_
3. If the answer to question two is "no," list all the owners and their respective interests below:

RECEIVED

Owner

Land Description

OCT 3 1963

## SECTION B

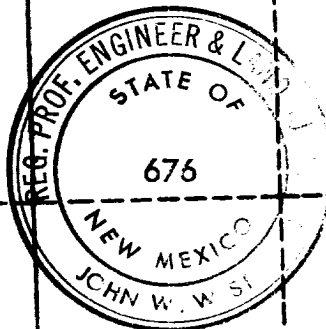
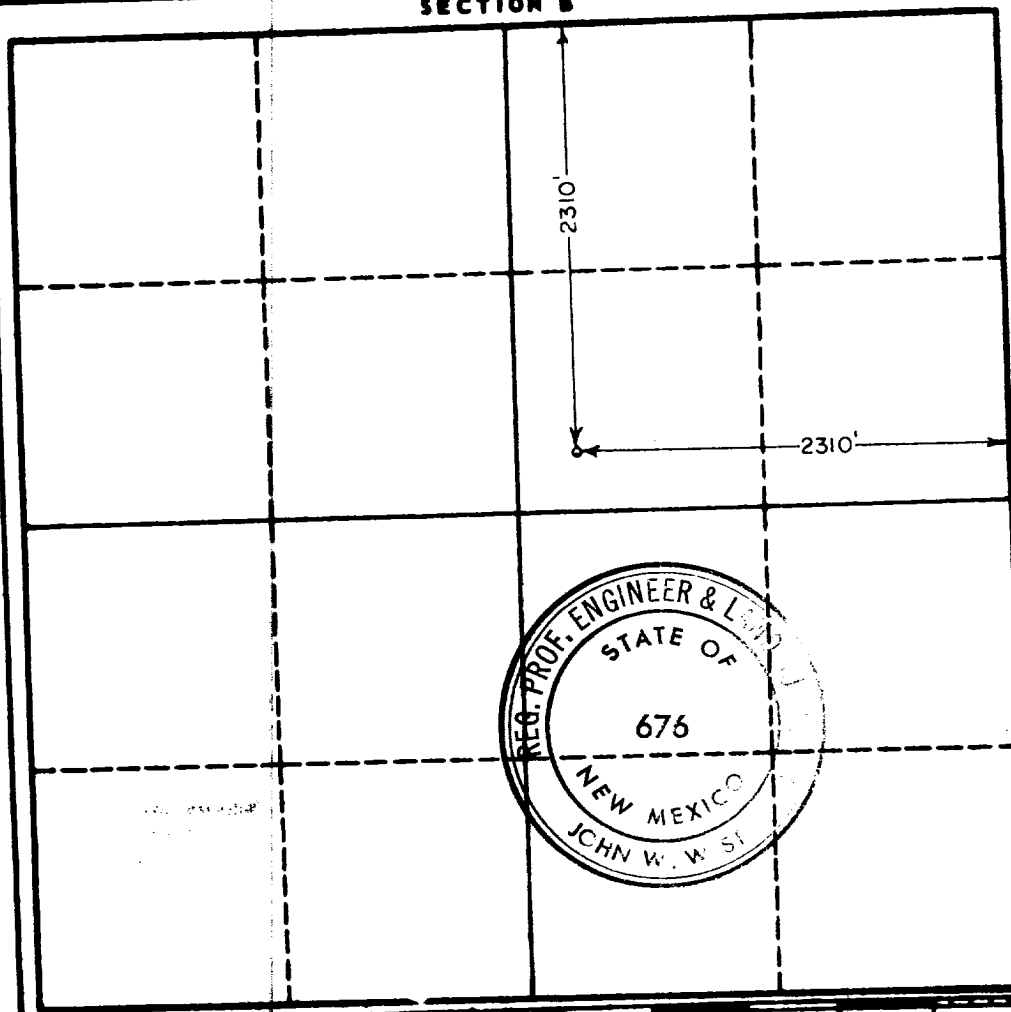
O. C. C.  
ARTESIA, OFFICE

I hereby certify that the information in SECTION A above is true and complete to the best of my knowledge and belief.

Name

Position

Company

Date

Oct 1 - 1963

I hereby certify that the well location shown on the plat in SECTION B was plotted from field notes of actual surveys made by me or under my supervision, and that the same is true and correct to the best of my knowledge and belief.

Date Surveyed

9-10-63

Registered Professional Engineer and/or Land Surveyor, JOHN W. WEST

Certificate No.

N. M. - P. E. &amp; L. S. NO. 676

0 300 600 900 1200 1500 1800 2100 2400 2700 3000 3300 3600 3900 4200 4500 4800 5100 5400 5700 6000

## OIL CONSERVATION COMMISSION

## ARTESIA DISTRICT OFFICE

No Copies Received

6

## DISTRIBUTION

	NO FURNISHED	
OPERATOR	1	
SANTA FE	1	
PRORATION OFFICE		
STATE LAND OFFICE	1	
U. S. G. S.	2	
TRANSPORTER		
FILE	1 -	
BUREAU OF MINES		