

NEW MEXICO OIL CONSERVATION COMMISSION
Santa Fe, New Mexico

RECEIVED
Form C-101
Revised (12/1/55)
FEB 9 1960
30-005-01224
O. C. C.
ARTESIA, OFFICE

NOTICE OF INTENTION TO DRILL

Notice must be given to the District Office of the Oil Conservation Commission and approval obtained before drilling or recompletion begins. If changes in the proposed plan are considered advisable, a copy of this notice showing such changes will be returned to the sender. Submit this notice in QUINTUPLICATE. One copy will be returned following approval. See additional instructions in Rules and Regulations of the Commission. If State Land submit 6 Copies Attach Form C-128 in triplicate to first 3 copies of form C-101

Roswell, New Mexico
(Place)

February 9, 1960
(Date)

OIL CONSERVATION COMMISSION
SANTA FE, NEW MEXICO

Gentlemen:

You are hereby notified that it is our intention to commence the Drilling of a well to be known as

J. W. BROWN
(Company or Operator)

State E-92
(Lease)

Well No. 11

K

The well is

located 1980 feet from the West line and 2630 feet from the

South

line of Section 26, T. 10S, R. 23E, NMPM.

(GIVE LOCATION FROM SECTION LINE)

Brown

Pool,

Chaves

County

If State Land the Oil and Gas Lease is No. E-92

If patented land the owner is

Address

We propose to drill well with drilling equipment as follows:

Rotary Rig

The status of plugging bond is \$10,000 Blanket Bond

Drilling Contractor M. G. Peters Drilling Company,
Roswell, New Mexico

We intend to complete this well in the Queen
formation at an approximate depth of 300 feet.

CASING PROGRAM

We propose to use the following strings of Casing and to cement them as indicated:

Size of Hole	Size of Casing	Weight per Foot	New or Second Hand	Depth	Sacks Cement
6"	4-1/2"	9-1/2#	New	Approx. 300'	50

If changes in the above plans become advisable we will notify you immediately.

ADDITIONAL INFORMATION (If recompletion give full details of proposed plan of work.)

Well will be assigned until approved by hearing

FEB 23 1960

Approved _____, 19____
Except as follows:

OIL CONSERVATION COMMISSION

By

M. L. Armstrong

Sincerely yours,

J. W. Brown

(Company or Operator)

By

Owner

Position

Send Communications regarding well to

J. W. Brown

Name

Address Hickson Hotel, Roswell, N. Mex.

RECEIVED

NEW MEXICO OIL CONSERVATION COMMISSION
WELL LOCATION AND ACREAGE DEDICATION PLAT

FORM C-128
Revised 5/1/57

FEB 9 1960

SEE INSTRUCTIONS FOR COMPLETING THIS FORM ON THE REVERSE SIDE ☐ C. C.

SECTION A

ARTESIA, OFFICE

Operator J. W. Brown			Lease State "E" - 92		Well No. 11
Unit Letter K	Section 26	Township 10 South	Range 26 East	County Chaves	
Actual Footage Location of Well: 1,980' feet from the West line and 2,630' feet from the South line					
Ground Level Elev.	Producing Formation Queen		Pool Brown		Dedicated Acreage: 40 Acres

1. Is the Operator the only owner in the dedicated acreage outlined on the plat below? YES ☒ NO ☐ . ("Owner" means the person who has the right to drill into and to produce from any pool and to appropriate the production either for himself or for himself and another. (65-3-29 (e) NMSA 1935 Comp.)
2. If the answer to question one is "no," have the interests of all the owners been consolidated by communitization agreement or otherwise? YES ☐ NO ☐ . If answer is "yes," Type of Consolidation _____
3. If the answer to question two is "no," list all the owners and their respective interests below:

Owner	Land Description

SECTION B

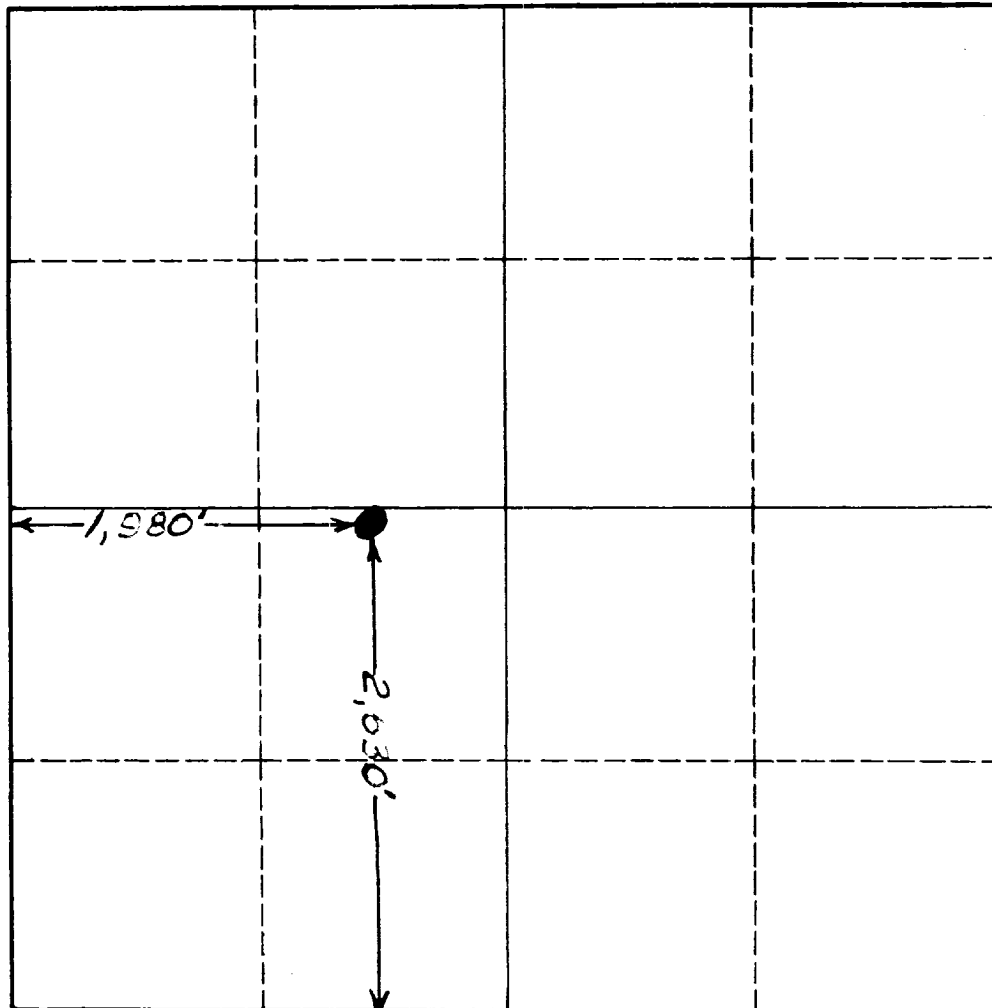

CERTIFICATION

I hereby certify that the information in SECTION A above is true and complete to the best of my knowledge and belief.

Name <i>J. W. Brown</i>
Position Owner
Company J. W. Brown
Date February 7, 1960

I hereby certify that the well location shown on the plat in SECTION B was plotted from field notes of actual surveys made by me or under my supervision, and that the same is true and correct to the best of my knowledge and belief.

Date Surveyed February 7, 1960
Registered Professional Engineer and/or Land Surveyor <i>Wayne R. Bright</i>
Certificate No. 3069

0 330 660 990 1320 1650 1980 2310 2640 2000 1500 1000 500 0

INSTRUCTIONS FOR COMPLETION OF FORM C-128

1. Operator shall furnish and certify to the information called for in Section A.
2. Operator shall outline the dedicated acreage for *both* oil and gas wells on the plat in Section B.
3. A registered professional engineer or land surveyor registered in the State of New Mexico or approved by the Commission shall show on the plat the location of the well and certify this information in the space provided.
4. All distances shown on the plat must be from the outer boundaries of the Section.
5. If additional space is needed for listing owners and their respective interests as required in question 3 of Section A, please use space below.

OIL COMPLETION COMMISSION		
ALBUQUERQUE DISTRICT OFFICE		
The Copies Furnished: 6		
DISTRIBUTION		
	NO. FURNISHED	
OPERATOR	1	
SANTA FE	1	
PRORATION OFFICE		
STATE LAND OFFICE	1	
U. S. G. S.	2	
TRANSPORTER		
FILE	1	✓
BUREAU OF MINES		