

(SUBMIT IN TRIPLICATE)

UNITED STATES
DEPARTMENT OF THE INTERIOR
GEOLOGICAL SURVEY

Budget Bureau No. 42-R358.4.
Form Approved.

Land Office Santa Fe
Lease No. LC 068129
Unit P

30-085-10026
RECEIVED
FEB 27 1963

SUNDRY NOTICES AND REPORTS ON WELLS

| | | | |
|--|-------------------------------------|--|--|
| NOTICE OF INTENTION TO DRILL | <input checked="" type="checkbox"/> | SUBSEQUENT REPORT OF WATER SHUT-OFF | |
| NOTICE OF INTENTION TO CHANGE PLANS | | SUBSEQUENT REPORT OF SHOOTING OR ACIDIZING | |
| NOTICE OF INTENTION TO TEST WATER SHUT-OFF | | SUBSEQUENT REPORT OF ALTERING CASING | |
| NOTICE OF INTENTION TO RE-DRILL OR REPAIR WELL | | SUBSEQUENT REPORT OF RE-DRILLING OR REPAIR | |
| NOTICE OF INTENTION TO SHOOT OR ACIDIZE | | SUBSEQUENT REPORT OF ABANDONMENT | |
| NOTICE OF INTENTION TO PULL OR ALTER CASING | | SUPPLEMENTARY WELL HISTORY | |
| NOTICE OF INTENTION TO ABANDON WELL | | | |

(INDICATE ABOVE BY CHECK MARK NATURE OF REPORT, NOTICE, OR OTHER DATA)

February 27, 1963

Well No. 21 is located 775 ft. from SW line and 330 ft. from E line of sec. _____
SE 21 6 South 26 East N.Y.P.M.
(1/4 Sec. and Sec. No.) (Twp.) (Range) (Meridian)
Wildcat Chaves New Mexico
(Field) (County or Subdivision) (State or Territory)

The elevation of the derrick floor above sea level is 3604.80 ft.

DETAILS OF WORK

(State names of and expected depths to objective sands; show sizes, weights, and lengths of proposed casings; indicate mudding jobs, cementing points, and all other important proposed work)

It is intended to drill a 125 Ft. 9 inch Hole, Set 125 Ft. 7 inch 23# casing
circumference. Drilling approximately 1400 Ft. 6 1/2 inch Hole to test San Andres
Formation. If ~~commercial~~ production is found, will set approximately 1400 Ft. of
4 1/2 inch 11 1/2 # casing, w/50 SAS cement.

R

FEB 27 1963

U. S. GEOLOGICAL SURVEY
ROSWELL, NEW MEXICO

I understand that this plan of work must receive approval in writing by the Geological Survey before operations may be commenced.

Company H.E. Barnes & Co.

Address Box 1057

Roswell, New Mexico

By H.E. Barnes

Title Owner

| | |
|---------------------------|-----|
| NUMBER OF COPIES RECEIVED | |
| DISTRIBUTION | |
| SANTA FE | |
| FILE | |
| U.S.G.S. | |
| LAND OFFICE | |
| TRANSPORTER | OIL |
| | GAS |
| PRODUCTION OFFICE | |
| OPERATOR | |

NEW MEXICO OIL CONSERVATION COMMISSION
WELL LOCATION AND ACREAGE DEDICATION PLAT
 SEE INSTRUCTIONS FOR COMPLETING THIS FORM ON THE REVERSE SIDE

FORM C-128
 Revised 5/1/57

SECTION A

| | | | | | |
|--|--|----------------------------|---------------------------|-------------------------|---------------------------------|
| Operator H. E. Barnes | | | Lease LC 068129 | | Well No. 2 |
| Unit Letter P | Section 21 | Township 6-South | Range 26-East | County Chaves | |
| Actual Footage Location of Well: 755 feet from the South line and 330 feet from the East line | | | | | |
| Ground Level Elev. 3604.80 | Producing Formation San Andres | | Pool Wildcat | | Dedicated Acreage: Acres |

1. Is the Operator the only owner in the dedicated acreage outlined on the plat below? YES ☒ NO ____ . ("Owner" means the person who has the right to drill into and to produce from any pool and to appropriate the production either for himself or for himself and another. (65-3-29 (e) NMSA 1935 Comp.)
2. If the answer to question one is "no," have the interests of all the owners been consolidated by communitization agreement or otherwise? YES ____ NO ____ . If answer is "yes," Type of Consolidation ____
3. If the answer to question two is "no," list all the owners and their respective interests below:

| Owner | Land Description |
|-------|------------------|
| | |
| | |

SECTION B

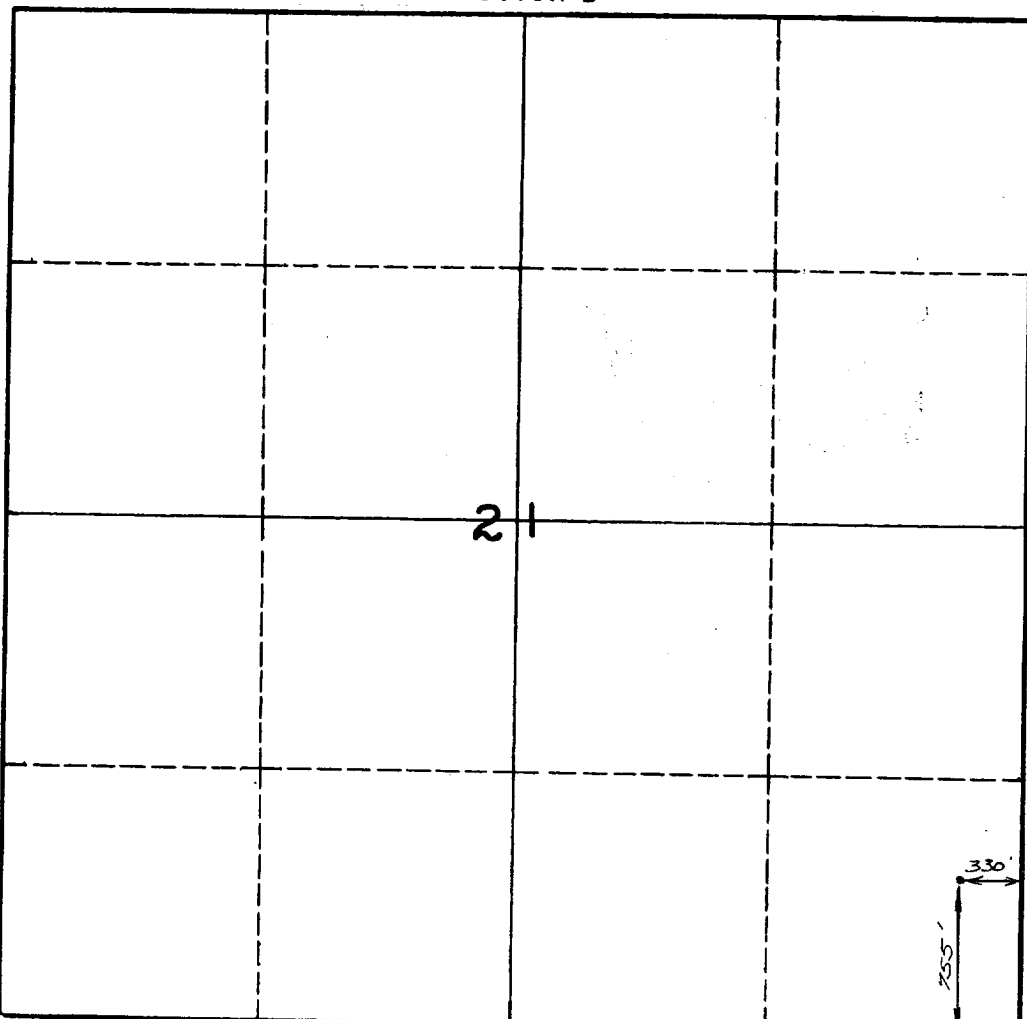

CERTIFICATION

I hereby certify that the information in SECTION A above is true and complete to the best of my knowledge and belief.

| |
|------------------------------------|
| Name H. E. Barnes |
| Position Owner |
| Company H. E. Barnes Oil |
| Date Feb. 27, 1963 |

I hereby certify that the well location shown on the plat in SECTION B was plotted from field notes of actual surveys made by me or under my supervision, and that the same is true and correct to the best of my knowledge and belief.

| |
|--|
| Date Surveyed 2-21-63 |
| Registered Professional Engineer and/or Land Surveyor Vernon E. Hall |
| Certificate No. 3241 |

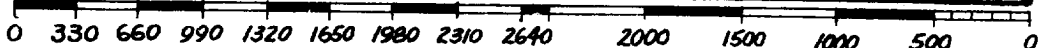

INSTRUCTIONS FOR COMPLETION OF FORM C-128

1. Operator shall furnish and certify to the information called for in Section A.
2. Operator shall outline the dedicated acreage for *both* oil and gas wells on the plat in Section B.
3. A registered professional engineer or land surveyor registered in the State of New Mexico or approved by the Commission shall show on the plat the location of the well and certify this information in the space provided.
4. All distances shown on the plat must be from the outer boundaries of the Section.
5. If additional space is needed for listing owners and their respective interests as required in question 3 of Section A, please use space below.