

NUMBER OF COPIES RECEIVED		6
DISTRIBUTION		
SANTA FE	FILE	1
U.S.G.S.	LAND OFFICE	2
TRANSPORTER	OIL	
	GAS	
PRODUCTION OFFICE	OPERATOR	2

NEW MEXICO OIL CONSERVATION COMMISSION
Santa Fe, New Mexico

Form C-101
Revised (12/1/55)

NOTICE OF INTENTION TO DRILL

Notice must be given to the District Office of the Oil Conservation Commission and approval obtained before drilling or recompletion begins. If changes in the proposed plan are considered advisable, a copy of this notice showing such changes will be returned to the sender. Submit this notice in QUINTUPPLICATE. One copy will be returned following approval. See additional instructions in Rules and Regulations of the Commission. If State Land submit 6 Copies Attach Form C- 128 in triplicate to first 3 copies of form C-101

Roswell, New Mexico

December 5, 1963

(Place)

(Date)

OIL CONSERVATION COMMISSION
SANTA FE, NEW MEXICO

30-005-10029

Gentlemen:

You are hereby notified that it is our intention to commence the Drilling of a well to be known as
Dr. Sam G. Dunn **1312 Main St., Lubbock, Texas**

(Company, or Operator)

Pendergrass

(Lease)

Well No. **2**, in **E** (Unit) The well is

located **1666.5** feet from the **North** line and **990** feet from the

West

line of Section **4**, T. **7 S**, R. **26 E**, NMPM.

(GIVE LOCATION FROM SECTION LINE)

Und.

Pool, **Chaves**

County

If State Land the Oil and Gas Lease is No.

If patented land the owner is **Cecil Pendergrass**

Address **Box 17, Cuchillo, New Mexico**

We propose to drill well with drilling equipment as follows: **Rotary**

The status of plugging bond is **10,000 Blanket**

Drilling Contractor **H. E. Barnes**
Roswell, New Mexico

RECEIVED

DEC 5 1963

We intend to complete this well in the **San Andres** formation at an approximate depth of **1100** feet.

CASING PROGRAM

We propose to use the following strings of Casing and to cement them as indicated:

Size of Hole	Size of Casing	Weight per Foot	New or Second Hand	Depth	Sacks Cement
11"	8 5/8	32 1/2	Used	100	Circulate
6 3/4	4 1/2	9 1/2	New	1100	50 Sacks

If changes in the above plans become advisable we will notify you immediately.

ADDITIONAL INFORMATION (If recompletion give full details of proposed plan of work.)

Approved **DEC 6 1963**, 19.....
Except as follows:

Sincerely yours,

Dr. Sam G. Dunn

By **H. E. Barnes** (Company or Operator)

Position **Representative**

Send Communications regarding well to

Dr. Sam G. Dunn

Name **1312 Main, Lubbock, Texas**
Address

OIL CONSERVATION COMMISSION

By **M. L. Armstrong**

NEW MEXICO OIL CONSERVATION COMMISSION
WELL LOCATION AND ACREAGE DEDICATION PLAT

FORM C-128
Revised 5/1/57

SEE INSTRUCTIONS FOR COMPLETING THIS FORM ON THE REVERSE SIDE

SECTION A

Operator DR. SAM G. DUNN		Lease PENDERGRASS		Well No. 2
Unit Letter E	Section 4	Township 7 SOUTH	Range 26 EAST	County CHAVES
Actual Postage Location of Well: 1666.5 feet from the NORTH line and 990 feet from the WEST line				
Ground Level Elev. 3603.90	Producing Formation San Andres		Pool Und.	Dedicated Acreage: 40 Acres

1. Is the Operator the only owner in the dedicated acreage outlined on the plat below? YES **XX** NO ____ . ("Owner" means the person who has the right to drill into and to produce from any pool and to appropriate the production either for himself or for himself and another. (65-3-29 (e) NMSA 1935 Comp.)
2. If the answer to question one is "no," have the interests of all the owners been consolidated by communitization agreement or otherwise? YES ____ NO ____ . If answer is "yes," Type of Consolidation _____
3. If the answer to question two is "no," list all the owners and their respective interests below:

Owner	Land Description
	DEC 6 1963
	O C C

SECTION B

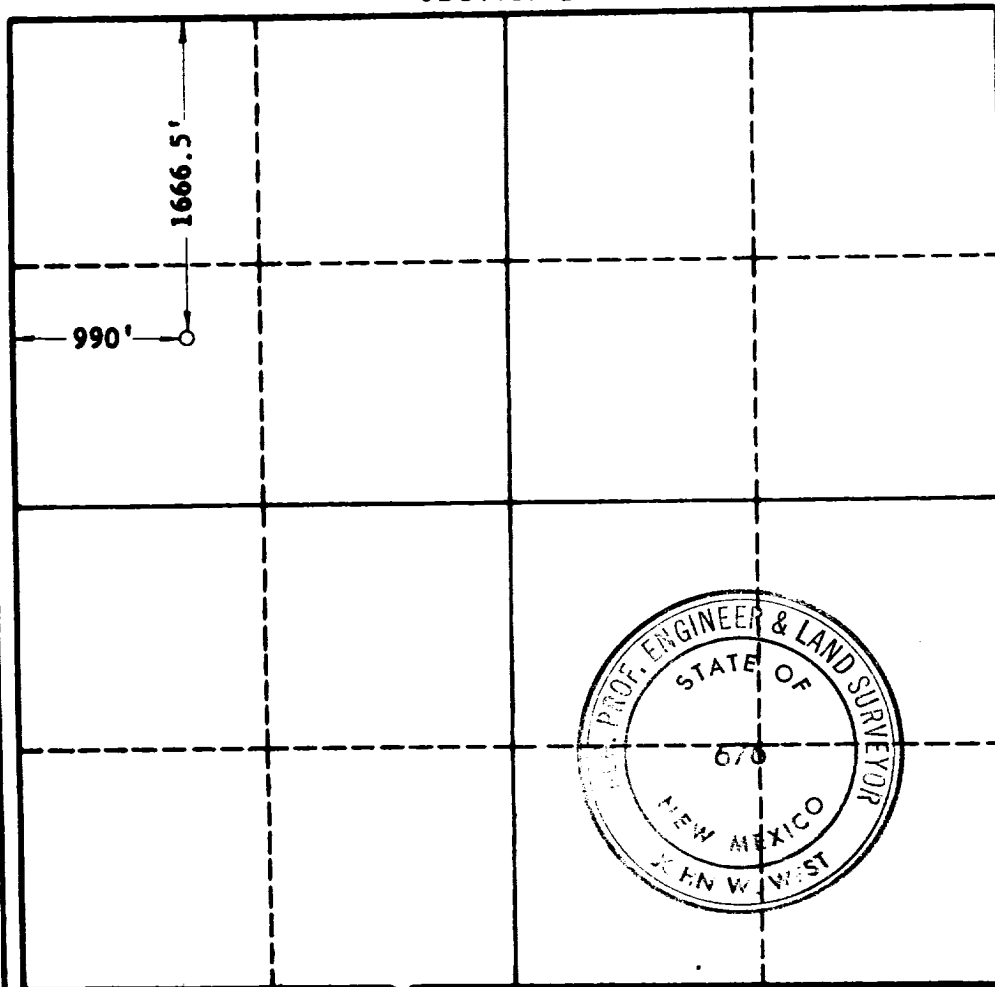

ARTESIA, OFFICE
CERTIFICATION

I hereby certify that the information in SECTION A above is true and complete to the best of my knowledge and belief.

Name J. C. Barnes
Position Representative
Company Dr. Sam G. Dunn
Date 12-5-63

I hereby certify that the well location shown on the plat in SECTION B was plotted from field notes of actual surveys made by me or under my supervision, and that the same is true and correct to the best of my knowledge and belief.

Date Surveyed 11-27-63
Registered Professional Engineer and/or Land Surveyor, JOHN W. WEST
Certificate No. 676
N. M. - P. E. & L. S. NO. 676

0 330 660 990 1320 1650 1980 2310 2640 2000 1600 1200 800 400 0