

**UNITED STATES
DEPARTMENT OF THE INTERIOR
GEOLOGICAL SURVEY**

SUBMIT IN DUPLICATE*
(Other instructions on reverse side)

Budget Bureau

30-005-10055-5X
5. LEASE DESIGNATION AND SERIAL NO.

L.C. 067811-A
6. IF INDIAN, ALLOTTEE OR TRIBE NAME

7. UNIT AGREEMENT NAME

8. FARM OR LEASE NAME

Dale-Federal
9. WELL NO.

Two
10. FIELD AND POOL, OR WILDCAT

Undesignated
11. SEC., T., R., M., OR BLK. AND SURVEY OR AREA

Sec 26, T 7-S, R26E, N1PM
12. COUNTY OR PARISH

Chaves
13. STATE
New Mexico

APPLICATION FOR PERMIT TO DRILL, DEEPEN, OR PLUG BACK

1a. TYPE OF WORK
DRILL DEEPEN PLUG BACK

b. TYPE OF WELL
OIL WELL GAS WELL OTHER

2. NAME OF OPERATOR
Dr. Sam G. Dunn

3. ADDRESS OF OPERATOR
1312 Main St., Lubbock, Texas.

4. LOCATION OF WELL (Report location clearly and in accordance with any State requirements.*)
At surface
1650 ft. from East Line and 2310 ft. from South Line, NW 1/4 SE 1/4

At proposed prod. zone
Same

14. DISTANCE IN MILES AND DIRECTION FROM NEAREST TOWN OR POST OFFICE*
30 miles northeast of Roswell, New Mexico

15. DISTANCE FROM PROPOSED* LOCATION TO NEAREST PROPERTY OR LEASE LINE, FT. (Also to nearest drlg. unit line, if any)

16. NO. OF ACRES IN LEASE
1600 ft.

17. NO. OF ACRES ASSIGNED TO THIS WELL
40

18. DISTANCE FROM PROPOSED LOCATION* TO NEAREST WELL, DRILLING, COMPLETED, OR APPLIED FOR, ON THIS LEASE, FT.

19. PROPOSED DEPTH
1600 ft.

20. ROTARY OR CABLE TOOLS
Cable

21. ELEVATIONS (Show whether DF, RT, GR, etc.)
3781.6 Ground Level Elev.

22. APPROX. DATE WORK WILL START*

PROPOSED CASING AND CEMENTING PROGRAM			QUANTITY OF CEMENT
SIZE OF HOLE	SIZE OF CASING	WEIGHT PER FOOT	SETTING DEPTH
11"	8 5/8	32#	100 ft.
8"	4 1/2	9 1/2#	1600 ft.

Circulate
Cement 75 sacks

It is intended to drill 100 ft 11" hole, run 8 5/8 casing, circulate cement.
It is intended to drill approx 1600 ft hole or to a sufficient depth to test the San Andres formation, if production is found will run new 4 1/2" casing 9 1/2 lb and circulate cement with 75A.

RECEIVED
APR 9 1964
D. C. C.
ARTESIA, OFFICE

RECEIVED
APR 7 1964
U. S. GEOLOGICAL SURVEY
ROSWELL, NEW MEXICO

IN ABOVE SPACE DESCRIBE PROPOSED PROGRAM: If proposal is to deepen or plug back, give data on present productive zone and proposed new productive zone. If proposal is to drill or deepen directionally, give pertinent data on subsurface locations and measured and true vertical depths. Give preventer program, if any.

SIGNED R. J. Jadin TITLE Production Supt. DATE April 6,

(This space for Federal or State office use) APPROVAL DATE _____ DATE _____

PERMIT NO. _____ TITLE _____ DATE _____

APPROVED BY _____ CONDITIONS OF APPROVAL, IF ANY: _____

Instructions

This form is designed for submitting proposals to perform certain well operations, as indicated, on all types of lands and leases for appropriate action by either a Federal or a State agency, or both, pursuant to applicable Federal and/or State laws and regulations. Any necessary special instructions concerning the use of this form and the number of copies to be submitted, particularly with regard to local, area, or regional procedures and practices, either are shown below or will be issued by, or may be obtained from, the local Federal and/or State office.

Item 1: If the proposal is to redrill to the same reservoir at a different subsurface location or to a new reservoir, use this form with appropriate notations. Consult local applicable State or Federal regulations concerning subsequent work proposals or reports on the well.

Item 4: If there are no applicable State requirements, locations on Federal or Indian land should be described in accordance with Federal requirements. Consult local State or Federal office for specific instructions.

Item 14: Needed only when location of well cannot readily be found by road from the land or lease description. A plat, or plats, separate or on this reverse side, showing the roads to, and the surveyed location of, the well, and any other required information, should be furnished when required by Federal or State agency offices.

Items 15 and 18: If well is to be, or has been directionally drilled, give distances for subsurface location of hole in any present or objective production zone.

Item 22: Consult applicable Federal or State regulations, or appropriate officials, concerning approval of the proposal before operations are started.

NUMBER OF COPIES RECEIVED	
DISTRIBUTION	
STATE	
FILE	
U.S.G.S.	
LAND OFFICE	
TRANSPORTER	OIL
	GAS
PRORATION OFFICE	
OPERATOR	

NEW MEXICO OIL CONSERVATION COMMISSION
WELL LOCATION AND ACREAGE DEDICATION PLAT
 SEE INSTRUCTIONS FOR COMPLETING THIS FORM ON THE REVERSE SIDE

FORM C-128
 Revised 5/1/57

SECTION A				
Operator	Dr. Sam G. Dunn	Lease	Dale Federal	Well No. 2
Unit Letter	D	Section	26	Township
J		7-3	Range	26-E
			County	Chaves
Actual Footage Location of Well:				
1650	feet from the	East	line and	2310
				feet from the
				South
Ground Level Elev.	3781.6'	Producing Formation	San Andres	Pool
				Undesignated WC
			Dedicated Acreage:	40 Acres

1. Is the Operator the only owner in the dedicated acreage outlined on the plat below? YES NO ____ . ("Owner" means the person who has the right to drill into and to produce from any pool and to appropriate the production either for himself or for himself and another. (65-3-29 (e) NMSA 1935 Comp.)
2. If the answer to question one is "no," have the interests of all the owners been consolidated by communitization agreement or otherwise? YES ____ NO ____ . If answer is "yes," Type of Consolidation ____
3. If the answer to question two is "no," list all the owners and their respective interests below:

Owner	Land Description

RECEIVED
APR 9 1964
D. C. B.
ARTESIA, OFFICE

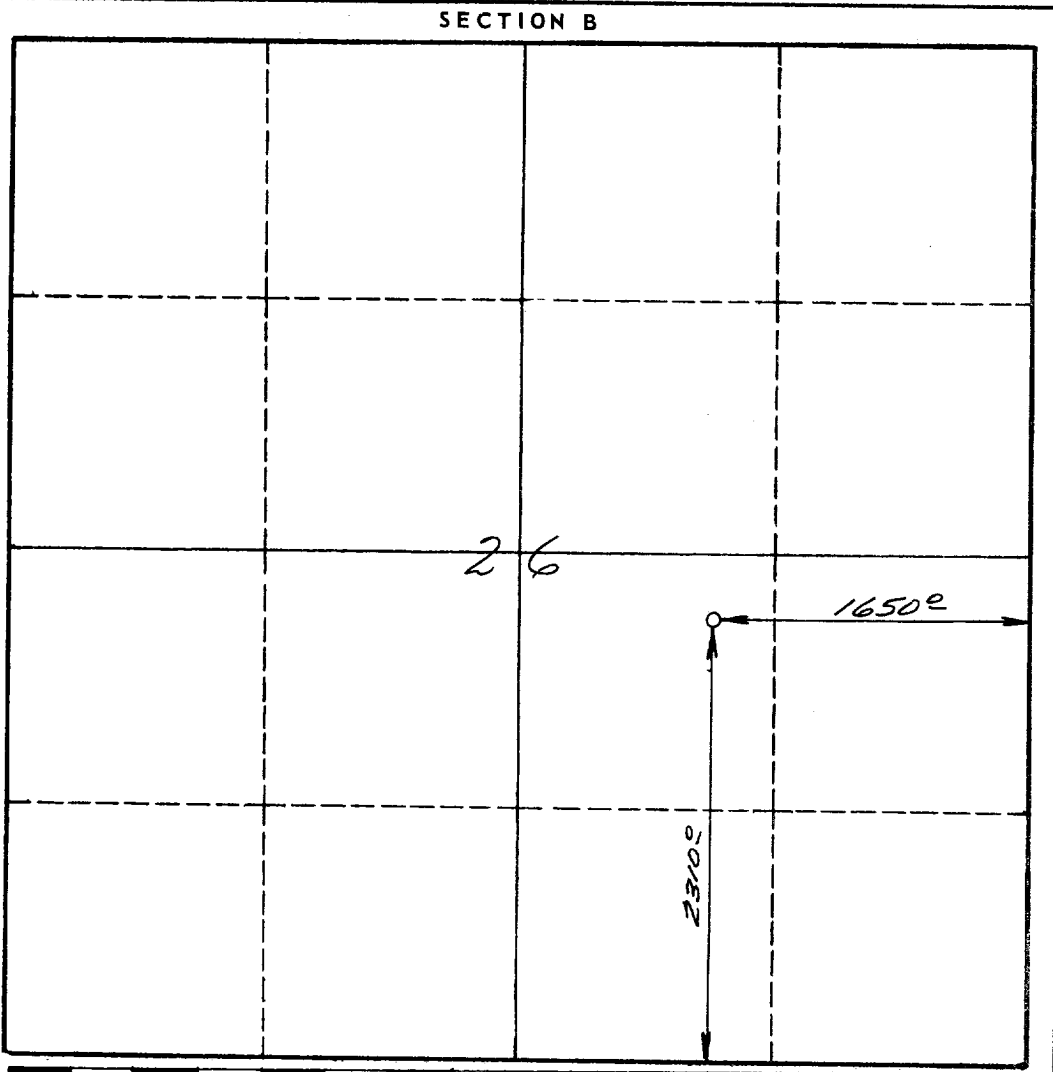

CERTIFICATION

I hereby certify that the information in SECTION A above is true and complete to the best of my knowledge and belief.

Name	<i>L.R. McFadin</i>
Position	Production Supt.
Company	Dr. Sam G. Dunn
Date	April 6, 1964

I hereby certify that the well location shown on the plat in SECTION B was plotted from field notes of actual surveys made by me or under my supervision, and that the same is true and correct to the best of my knowledge and belief.

Date Surveyed	October 31, 1963
Registered Professional Engineer and/or Land Surveyor	<i>Victor E. Hall</i>
Certificate No.	3241

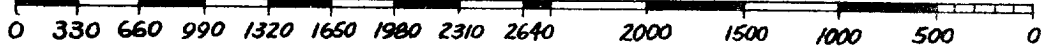

INSTRUCTIONS FOR COMPLETION OF FORM C-128

1. Operator shall furnish and certify to the information called for in Section A.
2. Operator shall outline the dedicated acreage for *both* oil and gas wells on the plat in Section B.
3. A registered professional engineer or land surveyor registered in the State of New Mexico or approved by the Commission shall show on the plat the location of the well and certify this information in the space provided.
4. All distances shown on the plat must be from the outer boundaries of the Section.
5. If additional space is needed for listing owners and their respective interests as required in question 3 of Section A, please use space below.