

V

NUMBER OF COPIES RECEIVED	
DISTRIBUTION	
SANTA FE	1
FILE	2
U.S.G.S.	
LAND OFFICE	
TRANSPORTER	
OIL	
GAS	
PRODUCTION OFFICE	
OPERATOR	1

NEW MEXICO OIL CONSERVATION COMMISSION
Santa Fe, New Mexico

Form O-101
Revised (12/1/55)

NOTICE OF INTENTION TO DRILL

Notice must be given to the District Office of the Oil Conservation Commission and approval obtained before drilling or recompletion begins. If changes in the proposed plan are considered advisable, a copy of this notice showing such changes will be returned to the sender. Submit this notice in QUINTUPPLICATE. One copy will be returned following approval. See additional instructions in Rules and Regulations of the Commission. If State Land submit 6 Copies Attach Form O-128 in triplicate to first 3 copies of form O-101

PORT WORTH, TEXAS
(Place)

MAY 7, 1964
(Date)

RECEIVED

OIL CONSERVATION COMMISSION
SANTA FE, NEW MEXICO

30-005-10078 MAY 7 1964

Gentlemen:

You are hereby notified that it is our intention to commence the Drilling of a well to be known as

BILL HICKS

LEE HICKS

(Company, or Operator)

C. C. C.
ARTESIA, OFFICE

FRED J. PENNINGTON
(Lease)

Well No. ONE

M
(Unit)

The well is

located 330 feet from the WEST line and 330 feet from the

SOUTH

line of Section 12, T. 7S, R. 27E, NMPM.

(GIVE LOCATION FROM SECTION LINE)

WILDCAT

CHAVES

County

If State Land the Oil and Gas Lease is No.

If patented land the owner is FRED J. PENNINGTON

Address 4708 SOUTH 31ST ST. TULSA, OKLAHOMA

We propose to drill well with drilling equipment as follows: ROTARY TOOLS

The status of plugging bond is ON FILE

Drilling Contractor WESTERN DRILLING CO.

IRVING, TEXAS

We intend to complete this well in the MILNE AND BONE OF THE SAN ANDRES formation at an approximate depth of 2800 2300 2300 feet.

CASING PROGRAM

We propose to use the following strings of Casing and to cement them as indicated:

Size of Hole	Size of Casing	Weight per Foot	New or Second Hand	Depth	Sacks Cement
11"	8 5/8	32	USED	150	50
7 7/8	4 1/2	9 1/2	NEW	T. D.	100

If changes in the above plans become advisable we will notify you immediately.

ADDITIONAL INFORMATION (If recompletion give full details of proposed plan of work.)

MAY 12 1964

Approved _____, 19____
Except as follows:

OIL CONSERVATION COMMISSION

By _____

Sincerely yours,

WILLIAM H. HICKS AND LEE HICKS
(Company or Operator)

By _____

Position _____
Send Communications regarding well to

Name BILL HICKS 1409 S. N. B. RDG.

Address PORT WORTH, TEXAS 76102

NUMBER OF COPIES RECEIVED	
DISTRIBUTION	
SANTA FE	
FILE	
U.S.G.S	
LAND OFFICE	
TRANSPORTER	OIL GAS
PRODUCTION OFFICE	
OPERATOR	

NEW MEXICO OIL CONSERVATION COMMISSION
WELL LOCATION AND ACREAGE DEDICATION PLAT
 SEE INSTRUCTIONS FOR COMPLETING THIS FORM ON THE REVERSE SIDE

FORM C-128
 Revised 5/1/57

SECTION A

Operator Bill Hicks + Lee Hicks		Lease Pennington-Pee		Well No. 1
Unit Letter M	Section 12	Township 7 South	Range 27 East	County Chaves
Actual Footage Location of Well: 330 feet from the South line and 300 feet from the West line				
Ground Level Elev.	Producing Formation	Pool Wildcat	Dedicated Acreage: 40 Acres	

1. Is the Operator the only owner in the dedicated acreage outlined on the plat below? YES _____ NO _____. ("Owner" means the person who has the right to drill into and to produce from any pool and to appropriate the production either for himself or for himself and another. (65-3-29 (e) NMSA 1935 Comp.)
2. If the answer to question one is "no," have the interests of all the owners been consolidated by communitization agreement or otherwise? YES _____ NO _____. If answer is "yes," Type of Consolidation _____
3. If the answer to question two is "no," list all the owners and their respective interests below:

Owner	Land Description

SECTION B

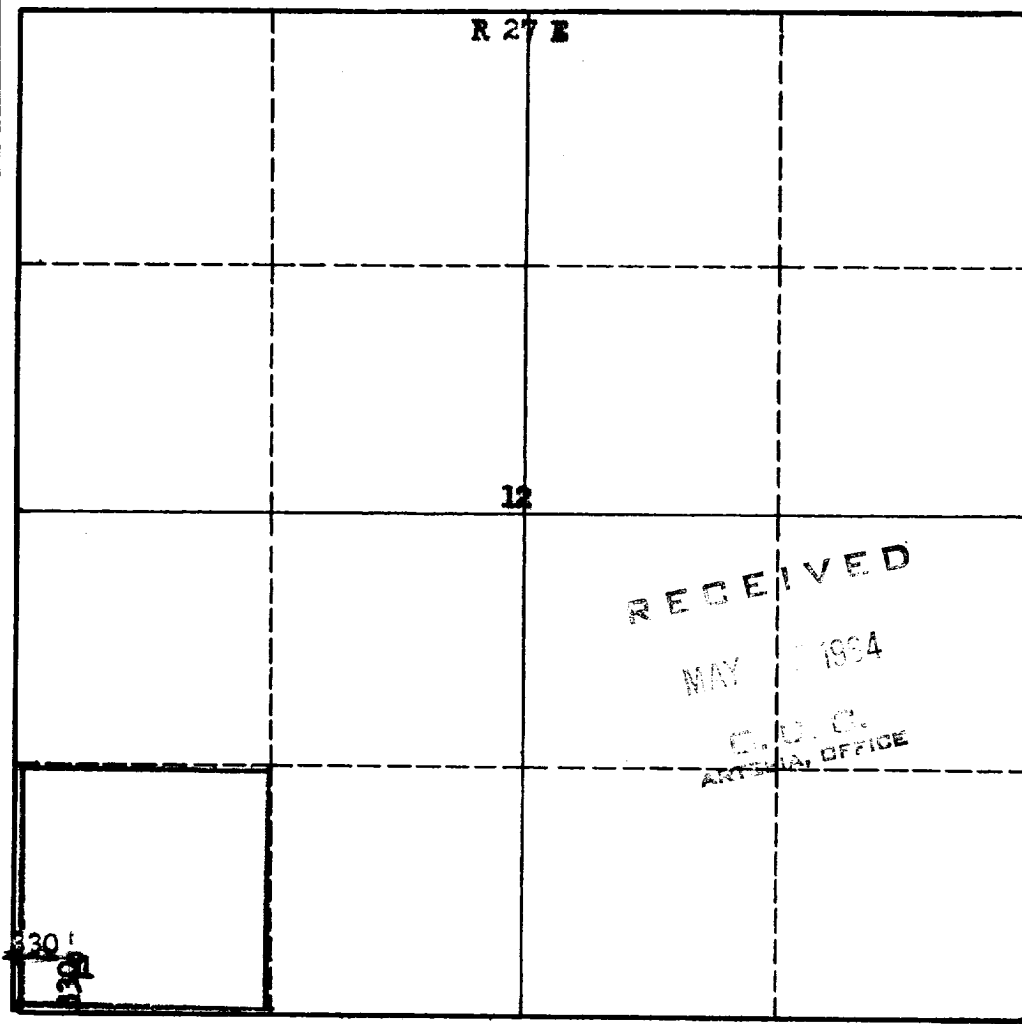

CERTIFICATION

I hereby certify that the information in SECTION A above is true and complete to the best of my knowledge and belief.

Name	Bill Hicks
Position	
Company	SAME
Date	5-7-64

I hereby certify that the well location shown on the plat in SECTION B was plotted from field notes of actual surveys made by me or under my supervision, and that the same is true and correct to the best of my knowledge and belief.

Date Surveyed	May 5, 1964
Registered Professional Engineer and/or Land Surveyor	James H. Brown
Certificate No.	N.M.L.S. No. 542

T
7
8

INSTRUCTIONS FOR COMPLETION OF FORM C-128

1. Operator shall furnish and certify to the information called for in Section A.
2. Operator shall outline the dedicated acreage for *both* oil and gas wells on the plat in Section B.
3. A registered professional engineer or land surveyor registered in the State of New Mexico or approved by the Commission shall show on the plat the location of the well and certify this information in the space provided.
4. All distances shown on the plat must be from the outer boundaries of the Section.
5. If additional space is needed for listing owners and their respective interests as required in question 3 of Section A, please use space below.