

30-005-10108<sup>2</sup>

NO. OF COPIES RECEIVED	7
DISTRIBUTION	
SANTA FE	1
FILE	1
U.S.G.S.	2
LAND OFFICE	
OPERATOR	3

## NEW MEXICO OIL CONSERVATION COMMISSION

Form C-101  
Revised 1-1-65

5A. Indicate Type of Lease	
STATE <input type="checkbox"/>	FEE <input checked="" type="checkbox"/>

5. State Oil & Gas Lease No.
-

## APPLICATION FOR PERMIT TO DRILL, DEEPEN, OR PLUG BACK

1a. Type of Work				7. Unit Agreement Name	
b. Type of Well DRILL <input checked="" type="checkbox"/> DEEPEN <input type="checkbox"/> PLUG BACK <input type="checkbox"/> OIL WELL <input checked="" type="checkbox"/> GAS WELL <input type="checkbox"/> OTHER <input type="checkbox"/> SINGLE ZONE <input checked="" type="checkbox"/> MULTIPLE ZONE <input type="checkbox"/>				8. Farm or Lease Name	
2. Name of Operator				9. Well No.	
Shell Oil Company				Bogle	
3. Address of Operator				10. Field and Pool, or Wildcat	
Box 1858 Roswell, New Mexico				Bathoven Area <i>we</i>	
4. Location of Well				12. County	
UNIT LETTER <u>D</u> LOCATED <u>330</u> FEET FROM THE <u>north</u> LINE				Chaves	
AND <u>990</u> FEET FROM THE <u>west</u> LINE OF SEC. <u>34</u> TWP. <u>11 S</u> RGE. <u>25 E</u> NMPM					
19. Proposed Depth		19A. Formation		20. Rotary or C.T.	
1180'		Slaughter		rotary	
21. Elevations (Show whether DF, RT, etc.)		21A. Kind & Status Plug. Bond		21B. Drilling Contractor	
est. 3500' df		blanket		to be determined	
				22. Approx. Date Work will start	
				March 8, 1965	

## 23. PROPOSED CASING AND CEMENT PROGRAM

SIZE OF HOLE	SIZE OF CASING	WEIGHT PER FOOT	SETTING DEPTH	SACKS OF CEMENT	EST. TOP
17-1/2"	13-3/8"	48#	30'	30	
12-1/4"	9-5/8"	36#	730'	100 sx / KenPak to circulate	
8-3/4"	* 7"	23 & 26#	980'	100 sx / KenPak to circulate	
6-1/4"	4-1/2"	9.5 & 11.6#	1180'	100 sx	circulate

\* As per verbal approval from Mr. Jim Wright, State Engineer and Mr. Armstrong, NMOCC, we plan to set 9-5/8" above the aquifer, drill an 8-3/4" hole thru aquifer, drill 6-1/4" hole to T.D. If evaluation of Slaughter warrants, we will then run the 7" and 4 1/2" as shown above.

RECEIVED

FEB 24 1965

O. C. C.  
SANTA FE OFFICE

IN ABOVE SPACE DESCRIBE PROPOSED PROGRAM: IF PROPOSAL IS TO DEEPEN OR PLUG BACK, GIVE DATA ON PRESENT PRODUCTIVE ZONE AND PROPOSED NEW PRODUCTIVE ZONE. GIVE BLOWOUT PREVENTER PROGRAM, IF ANY.

I hereby certify that the information above is true and complete to the best of my knowledge and belief.

Original Signed By: V.L. King Title: Acting District Exploitation Engineer Date: Feb. 23, 1965  
Signed: V. L. KING

(This space for State Use)

APPROVED BY: [Signature] TITLE: [Signature] DATE: MAR 2 1965  
CONDITIONS OF APPROVAL, IF ANY:

NUMBER OF COPIES RECEIVED	
DISTRIBUTION	
SANTA FE	
FILE	
U.S.G.S	
LAND OFFICE	
TRANSPORTER	OIL
	GAS
PROBATION OFFICE	
OPERATOR	

**NEW MEXICO OIL CONSERVATION COMMISSION**  
**WELL LOCATION AND ACREAGE DEDICATION PLAT**  
 SEE INSTRUCTIONS FOR COMPLETING THIS FORM ON THE REVERSE SIDE

FORM C-128  
Revised 5/1/57

**SECTION A**

Operator <b>Shell Oil Company</b>		Lease <b>Bogle</b>		Well No. <b>1</b>
Unit Letter <b>D</b>	Section <b>34</b>	Township <b>11S</b>	Range <b>25E</b>	County <b>Chaves</b>
Actual Footage Location of Well: <b>330</b> feet from the <b>north</b> line and <b>990</b> feet from the <b>west</b> line				
Ground Level Elev. <b>NA 3502.4</b>	Producing Formation <b>Slaughter</b> ✓	Pool <b>Beethoven Area</b> ✓	Dedicated Acreage: <b>40</b> Acres	

1. Is the Operator the only owner in the dedicated acreage outlined on the plat below? YES ☒ NO \_\_\_\_ . ("Owner" means the person who has the right to drill into and to produce from any pool and to appropriate the production either for himself or for himself and another. (65-3-29 (e) NMSA 1935 Comp.)
2. If the answer to question one is "no," have the interests of all the owners been consolidated by communitization agreement or otherwise? YES \_\_\_\_ NO \_\_\_\_ . If answer is "yes," Type of Consolidation \_\_\_\_\_
3. If the answer to question two is "no," list all the owners and their respective interests below:

Owner	Land Description
	<b>FEB 2 - 1965</b>
	<b>O. C. C.</b>
	<b>ARTERIA OFFICE</b>

**SECTION B**

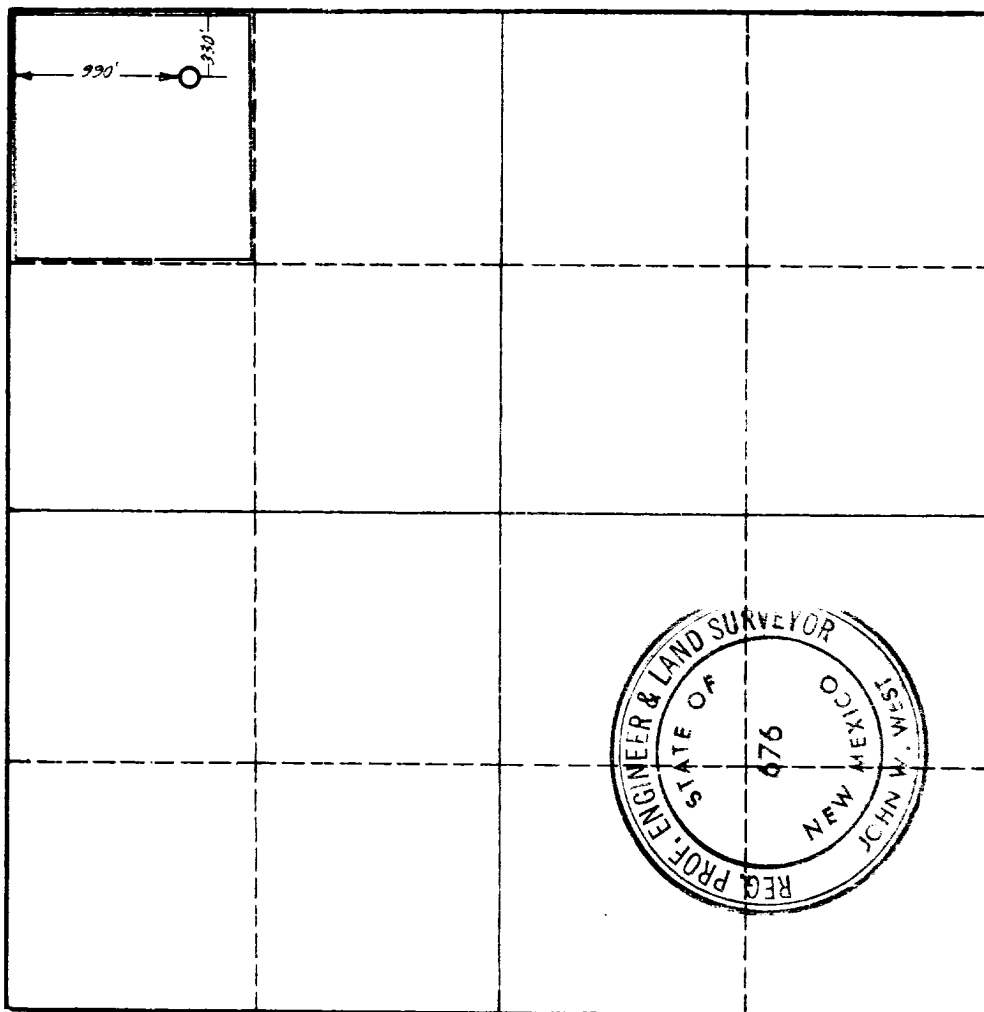

**CERTIFICATION**

I hereby certify that the information in SECTION A above is true and complete to the best of my knowledge and belief.

Name <b>V. L. King</b>	Original Signed By: <b>V. L. KING</b>
Position <b>Acting District Exploitation Engineer</b>	
Company <b>Shell Oil Company</b>	
Date <b>December 21, 1964</b>	

I hereby certify that the well location shown on the plat in SECTION B was plotted from field notes of actual surveys made by me or under my supervision, and that the same is true and correct to the best of my knowledge and belief.

Date Surveyed <b>12-24-64</b>
Registered Professional Engineer and/or Land Surveyor <i>[Signature]</i>
Certificate No. <b>676</b>

0 330 660 990 1320 1650 1980 2310 2640 2000 1500 1000 500 0

## **INSTRUCTIONS FOR COMPLETION OF FORM C-128**

1. Operator shall furnish and certify to the information called for in Section A.
2. Operator shall outline the dedicated acreage for *both* oil and gas wells on the plat in Section B.
3. A registered professional engineer or land surveyor registered in the State of New Mexico or approved by the Commission shall show on the plat the location of the well and certify this information in the space provided.
4. All distances shown on the plat must be from the outer boundaries of the Section.
5. If additional space is needed for listing owners and their respective interests as required in question 3 of Section A, please use space below.