

NUMBER OF COPIES RECEIVED	
DISTRIBUTION	
SANTA FE	7
FILE	1
U.S.G.S.	2
LAND OFFICE	
TRANSPORTER	
OIL GAS	
PRORATION OFFICE	
OPERATOR	3

**NEW MEXICO OIL CONSERVATION COMMISSION**  
Santa Fe, New Mexico

Form C-101  
Revised (12/1/55)

## NOTICE OF INTENTION TO DRILL

Notice must be given to the District Office of the Oil Conservation Commission and approval obtained before drilling or recompletion begins. If changes in the proposed plan are considered advisable, a copy of this notice showing such changes will be returned to the sender. Submit this notice in QUINTUPLICATE. One copy will be returned following approval. See additional instructions in Rules and Regulations of the Commission. If State Land submit 6 Copies Attach Form C- 128 in triplicate to first 3 copies of form C-101

Roswell, New Mexico  
(Place)

April 2, 1964  
(Date)

30-005-10113

OIL CONSERVATION COMMISSION  
SANTA FE, NEW MEXICO

Gentlemen:

You are hereby notified that it is our intention to commence the Drilling of a well to be known as

Shell Oil Company, P. O. Box 1858, Roswell, New Mexico  
(Company, or Operator)

Cannon  
(Lease)

, Well No. 8-A, in N The well is

located 1315 feet from the south line and 1375 feet from the west line of Section 27, T. 10-S, R. 25-E, NMPM.

(GIVE LOCATION FROM SECTION LINE) S. Bitter Lakes-S.A. Pool, Chaves County

If State Land the Oil and Gas Lease is No. ....

If patented land the owner is Mary Ann Cannon

Address Roswell, New Mexico

We propose to drill well with drilling equipment as follows: Rotary tools

The status of plugging bond is blanket

Drilling Contractor to be determined

We intend to complete this well in the San Andres formation at an approximate depth of 955 feet.

D	C	B	A
E	F	G	H
L	K	J	I
M	X	N	O
		P	

T  
10  
S

1315' FSL & 1375' FWL, Sec. 27

### CASING PROGRAM

We propose to use the following strings of Casing and to cement them as indicated:

Size of Hole	Size of Casing	Weight per Foot	New or Second Hand	Depth	Sacks Cement
12 1/4"	10 3/4"	32.75#	New	30'	60
9 5/8"	7"	36#	New	680'	300
6 1/4"	4 1/2"	9.5 & 11.6#	New	820'	100

If changes in the above plans become advisable we will notify you immediately.

ADDITIONAL INFORMATION (If recompletion give full details of proposed plan of work.) N.M.O.C.C. Order No. R-2658

Approved APR 6 1964, 19.....  
Except as follows:

Sincerely yours,

Shell Oil Company  
Original Signature of Operator)  
By R. A. LOWERY R. A. Lowery

Position District Exploitation Engineer  
Send Communications regarding well to

Name Shell Oil Company  
Address P. O. Box 1858, Roswell, New Mexico

OIL CONSERVATION COMMISSION

By M. L. Armstrong

NUMBER OF COPIES RECEIVED	
DISTRIBUTION	
SANTA FE	
FILE	
U.S.G.S	
LAND OFFICE	
TRANSPORTER	OIL GAS
PRODUCTION OFFICE	
OPERATOR	

**NEW MEXICO OIL CONSERVATION COMMISSION**  
**WELL LOCATION AND ACREAGE DEDICATION PLAT**  
 SEE INSTRUCTIONS FOR COMPLETING THIS FORM ON THE REVERSE SIDE

FORM C-128  
 Revised 5/1/57

**SECTION A**

Operator		Lease		Well No.	
Unit Letter	Section	Township	Range	County	
Actual Footage Location of Well:					
175 feet from the		line and	1375 feet from the	line	
Ground Level Elev.	Producing Formation	Pool		Dedicated Acreage:	
				Acres	

1. Is the Operator the only owner in the dedicated acreage outlined on the plat below? YES ☒ NO ☐ . ("Owner" means the person who has the right to drill into and to produce from any pool and to appropriate the production either for himself or for himself and another. (65-3-29 (e) NMSA 1935 Comp.)
2. If the answer to question one is "no," have the interests of all the owners been consolidated by communitization agreement or otherwise? YES ☐ NO ☐ . If answer is "yes," Type of Consolidation \_\_\_\_\_
3. If the answer to question two is "no," list all the owners and their respective interests below:

Owner	Land Description

**RECEIVED**

APR 6 1964

**O. C. C.**  
**ARTESIA OFFICE**  
**CERTIFICATION**

**SECTION B**

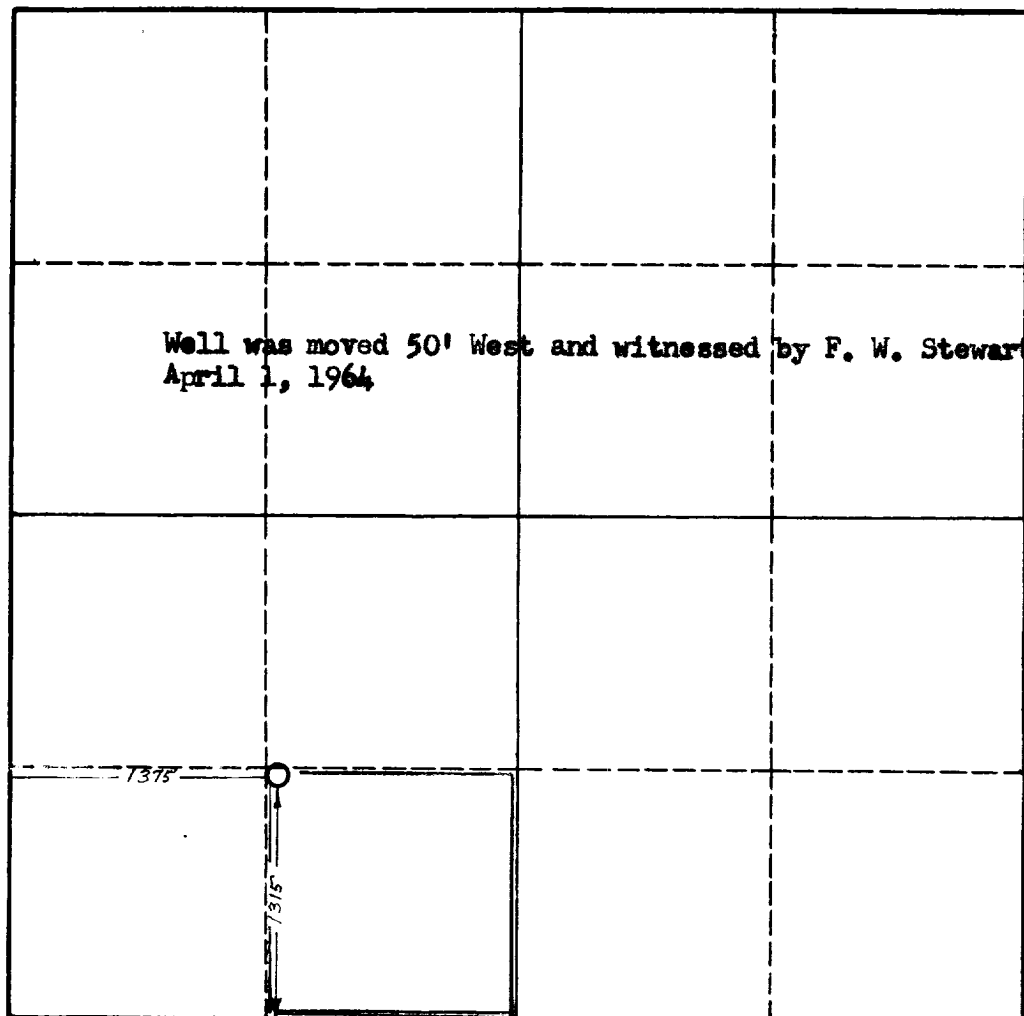

I hereby certify that the information in SECTION A above is true and complete to the best of my knowledge and belief.

Original Signed By  
 R. A. LOWERY

Name
Position
Company
Date

I hereby certify that the well location shown on the plat in SECTION B was plotted from field notes of actual surveys made by me or under my supervision, and that the same is true and correct to the best of my knowledge and belief.

Date Surveyed
Registered Professional Engineer and/or Land Surveyor
Certificate No.

0 330 660 990 1320 1650 1980 2310 2640 2000 1500 1000 500 0

## **INSTRUCTIONS FOR COMPLETION OF FORM C-128**

1. Operator shall furnish and certify to the information called for in Section A.
2. Operator shall outline the dedicated acreage for *both* oil and gas wells on the plat in Section B.
3. A registered professional engineer or land surveyor registered in the State of New Mexico or approved by the Commission shall show on the plat the location of the well and certify this information in the space provided.
4. All distances shown on the plat must be from the outer boundaries of the Section.
5. If additional space is needed for listing owners and their respective interests as required in question 3 of Section A, please use space below.