

Copy
to J.J.

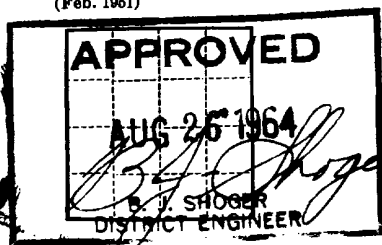

(SUBMIT IN TRIPLICATE)

UNITED STATES
DEPARTMENT OF THE INTERIOR
GEOLOGICAL SURVEY

Land Office **Roswell**
Lease No. **20-0134139**
Unit **RECEIVED**

30-005-10156
AUG 28 1964

SUNDRY NOTICES AND REPORTS ON WELLS **D. C. C.**

ARTESIA, OFFICE

NOTICE OF INTENTION TO DRILL.....	<input checked="" type="checkbox"/>	SUBSEQUENT REPORT OF WATER SHUT-OFF.....	
NOTICE OF INTENTION TO CHANGE PLANS.....		SUBSEQUENT REPORT OF SHOOTING OR ACIDIZING.....	
NOTICE OF INTENTION TO TEST WATER SHUT-OFF.....		SUBSEQUENT REPORT OF ALTERING CASING.....	
NOTICE OF INTENTION TO RE-DRILL OR REPAIR WELL.....		SUBSEQUENT REPORT OF RE-DRILLING OR REPAIR.....	
NOTICE OF INTENTION TO SHOOT OR ACIDIZE.....		SUBSEQUENT REPORT OF ABANDONMENT.....	
NOTICE OF INTENTION TO PULL OR ALTER CASING.....		SUPPLEMENTARY WELL HISTORY.....	
NOTICE OF INTENTION TO ABANDON WELL.....			

(INDICATE ABOVE BY CHECK MARK NATURE OF REPORT, NOTICE, OR OTHER DATA)

August 25, 1964

J.J. Travis - Huber Federal
Well No. **1** is located **1651** ft. from **N** line and **330** ft. from **E** line of sec. **24**

SE/4 NE/4 (1/4 Sec. and Sec. No.) **6-S** (Twp.) **25-E** (Range) (Meridian)
Wildcat (Field) **Chaves** (County or Subdivision) **New Mexico** (State or Territory)

The elevation of the derrick floor above sea level is **3049.7** ft. **ST.**

DETAILS OF WORK

(State names of and expected depths to objective sands; show sizes, weights, and lengths of proposed casings; indicate mudding jobs, cementing points, and all other important proposed work)

Proposed casing program: - cable tools. Will set approx 175 feet of 10 1/4" surface casing with cement circulated to top. Test to be drilled to Slaughter zone of San Andres. Estimated total depth to be 1150 feet. If completion made, will run 4 1/2" casing and cement.

RECEIVED
AUG 26 1964
U. S. GEOLOGICAL SURVEY
ROS WELL, NEW MEXICO

I understand that this plan of work must receive approval in writing by the Geological Survey before operations may be commenced.

Company **J. J. Travis**
Address **Box 873**
Midland, Texas

By **1702/64**
Title **Operator**

NEW MEXICO OIL CONSERVATION COMMISSION
WELL LOCATION AND ACREAGE DEDICATION PLAT

FORM C-128
Revised 5/1/57

SEE INSTRUCTIONS FOR COMPLETING THIS FORM ON THE REVERSE SIDE

SECTION A

Operator J. J. TRAVIS			Lease HUBER FEDERAL			Well No. 40		
Unit Letter H	Section 24	Township 6 SOUTH	Range 25 EAST	County CHAVES				
Actual Footage Location of Well: 1651 feet from the NORTH line and 330 feet from the EAST line								
Ground Level Elev. 3849.7	Producing Formation		Pool W C		Dedicated Acreage: 40 Acres			

1. Is the Operator the only owner in the dedicated acreage outlined on the plat below? YES ☒ NO ☐ ("Owner" means the person who has the right to drill into and to produce from any pool and to appropriate the production either for himself or for himself and another. (65-3-29 (e) NMSA 1935 Comp.)
2. If the answer to question one is "no," have the interests of all the owners been consolidated by communitization agreement or otherwise? YES ☐ NO ☐ . If answer is "yes," Type of Consolidation _____
3. If the answer to question two is "no," list all the owners and their respective interests below:

Owner	Land Description

SECTION B

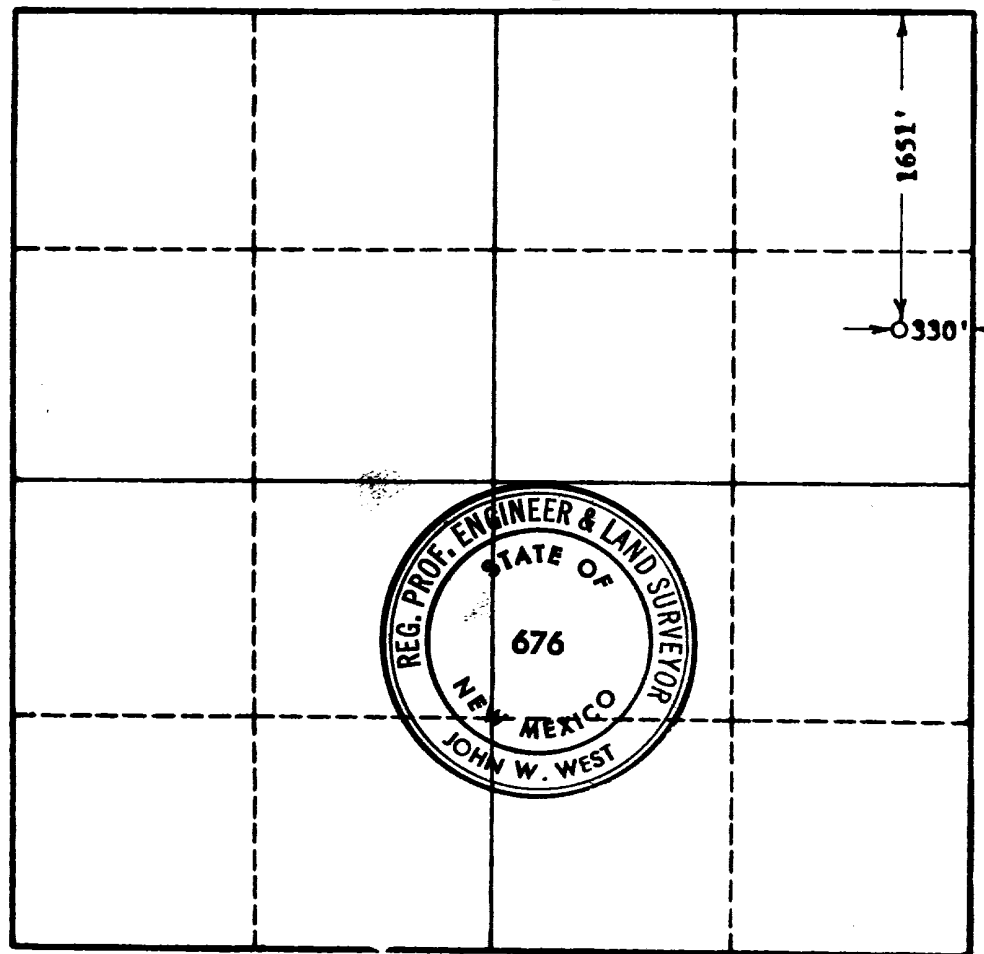

0 330 660 990 1320 1650 1980 2310 2640 2970 3300

U. S. GEOLOGICAL SURVEY
ROSWELL, NEW MEXICO

I hereby certify that the information in SECTION A above is true and complete to the best of my knowledge and belief.

Name J. J. Travis
Position Subsident
Company Huber Federal
Date 8-25-64

I hereby certify that the well location shown on the plat in SECTION B was plotted from field notes of actual surveys made by me or under my supervision, and that the same is true and correct to the best of my knowledge and belief.

Date Surveyed JULY 24, 1964
Registered Professional Engineer and/or Land Surveyor, JOHN W. WEST
Certificate No. N. M. - P. E. & L. S. NO. 676

RECEIVED

AUG 28 1964

O. C. C.
ARTESIA, OFFICEDESIGNATION OF OPERATOR

RECEIVED

AUG 26 1964

U. S. GEOLOGICAL SURVEY
ROSWell, NEW MEXICO

The undersigned is, on the records of the Bureau of Land Management, holder of Lease NM-0134139 and hereby designates J. J. Travis, Petroleum Life Building, Midland, Texas, as its Operator and local agent, with full authority to act in its behalf in complying with the terms of the Lease and regulations applicable thereto and on whom the supervisor or his representative may serve written or oral instructions in securing compliance with the Operating Regulations with respect to the Southeast Quarter Northeast Quarter (SE/4 NE/4) of Section Twenty-four (24), Township Six (6) South, Range Twenty-five (25) East, Chaves County, New Mexico.

It is understood that this Designation of Operator does not relieve the Lessee of responsibility of compliance with the terms of the Lease and the Operating Regulations. It is also understood that this Designation of Operator does not constitute an assignment of any interest in the Lease.

In case of default on the part of the designated Operator, Lessee will make full and prompt compliance with all regulations, Lease terms, or orders of the Secretary of the Interior or his representative.

The Lessee agrees to notify the supervisor of any change in the designated Operator.

Dated this 5th day of August, 1964.

ATTEST:

J. M. HUBER CORPORATION

M. A. Young
Assistant Secretary
M. A. YOUNG

By: *Chas. J. McPherson*
Asst. Vice President
Chas. J. McPherson
2401 East Second Avenue
Denver, Colorado 80206