

NUMBER OF COPIES RECEIVED	
DISTRIBUTION	
SANTA FE	1
FILE	2
U.S.G.S.	
LAND OFFICE	
TRANSPORTER	
OIL	
GAS	
PRORATION OFFICE	
OPERATOR	1

NEW MEXICO OIL CONSERVATION COMMISSION
Santa Fe, New Mexico

Form C-101
Revised 12/1/55

NOTICE OF INTENTION TO DRILL

Notice must be given to the District Office of the Oil Conservation Commission and approval obtained before drilling or recompletion begins. If changes in the proposed plan are considered advisable, a copy of this notice showing such changes will be returned to the sender. Submit this notice in QUINTUPPLICATE. One copy will be returned following approval. See additional instructions in Rules and Regulations of the Commission. If State Land submit 6 Copies. Attach Form C-128 in triplicate to first 3 copies of Form C-101.

Midland, Texas

February 28, 1964

(Place)
OIL CONSERVATION COMMISSION
SANTA FE, NEW MEXICO

(Date)

30-085-10166

Gentlemen:

You are hereby notified that it is our intention to commence the Drilling of a well to be known as
Dan E. Whatley

(Company or Operator)

Intex-State

(Lease)

Well No. 1, in D The well is located 660 feet from the North line and 660 feet from the West line of Section 28, T -9-S, R -27-E, NMPM.

(GIVE LOCATION FROM SECTION LINE) Wildcat Pool, Chaves County

D	C	B	A
E	F	G	H
L	K	J	I
M	N	O	P

If State Land the Oil and Gas Lease is No. E-9406

If patented land the owner is _____

Address _____

We propose to drill well with drilling equipment as follows: **Cable tools to TD**

The status of plugging back is **approved.**

Drilling Contractor **Apache Drilling Co.**
P.O. Box 195
Artesia, New Mexico

We intend to complete this well in the **San Andres** formation at an approximate depth of **2000** feet.

CASING PROGRAM

We propose to use the following strings of Casing and to cement them as indicated:

Size of Hole	Size of Casing	Weight per Foot	New or Second Hand	Depth	Sacks Cement
10"	8-5/8"	24#	Used	Approx. 160'	25 sx
8"	5-1/2"	14#	new	Approx. 2000'	50 sx

If changes in the above plans become advisable we will notify you immediately.

ADDITIONAL INFORMATION (If recompletion give full details of proposed plan of work.)

Operator and Driller conferred with Mr. Armstrong as to casing program.

Approved MAR 3 1964, 19____
Except as follows: _____

Sincerely yours,

Dan E. Whatley

(Company or Operator)

By _____

Position **Agent**

Send Communications regarding well to

Name **C/o V. Pickett**

901 Midland Savings Bldg.

Address **Midland, Texas**

OIL CONSERVATION COMMISSION

By M. Armstrong

NUMBER OF COPIES RECEIVED 3	
DISTRIBUTION	
SANTA FE	
FILE	1
U.S.G.S.	
LAND OFFICE	1
TRANSPORTER	
OIL	
GAS	
PRORATION OFFICE	
OPERATOR	

NEW MEXICO OIL CONSERVATION COMMISSION
WELL LOCATION AND ACREAGE DEDICATION PLAT
 SEE INSTRUCTIONS FOR COMPLETING THIS FORM ON THE REVERSE SIDE

FORM C-128
 Revised 5/1/57

SECTION A

Operator Dan E. Whatley		Lease Dan E. Whatley Intex-State		Well No. 1
Unit Letter D	Section 28	Township 9 SOUTH	Range 27 EAST	County CHAVES
Actual Footage Location of Well: 660 feet from the WEST line and 660 feet from the NORTH line				
Ground Level Elev. 3828	Producing Formation San Andres	Pool Wildcat	Dedicated Acreage: 40 Acres	

1. Is the Operator the only owner in the dedicated acreage outlined on the plat below? YES **XX** NO ____ . ("Owner" means the person who has the right to drill into and to produce from any pool and to appropriate the production either for himself or for himself and another. (65-3-29 (e) NMSA 1935 Comp.)
2. If the answer to question one is "no," have the interests of all the owners been consolidated by communitization agreement or otherwise? YES ____ NO ____ . If answer is "yes," Type of Consolidation ____
3. If the answer to question two is "no," list all the owners and their respective interests below:

Owner	Land Description

RECEIVED
MAR 1 1964
D. E. C.
CHAVES OFFICE
CERTIFICATION

SECTION B

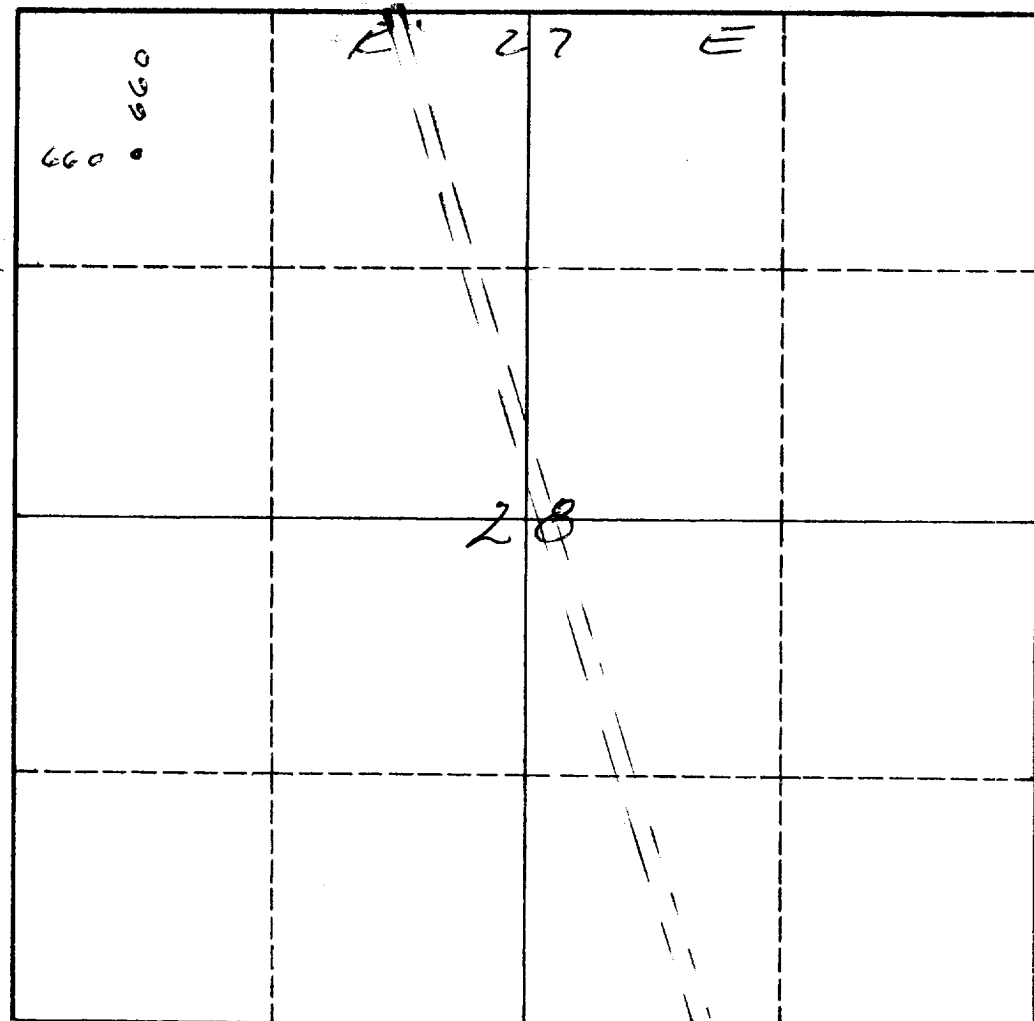

I hereby certify that the information in SECTION A above is true and complete to the best of my knowledge and belief.

Name D. E. Whatley
Position Agent
Company Dan E. Whatley
Date February 28, 1964

I hereby certify that the well location shown on the plat in SECTION B was plotted from field notes of actual surveys made by me or under my supervision, and that the same is true and correct to the best of my knowledge and belief.

Date Surveyed FEBRUARY 21, 1964
Registered Professional Engineer and/or Land Surveyor Verdon E. Hall
Certificate No. 3241

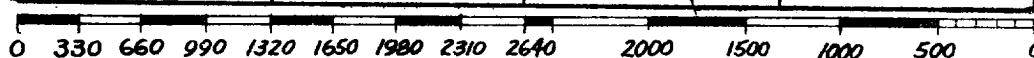

INSTRUCTIONS FOR COMPLETION OF FORM C-128

1. Operator shall furnish and certify to the information called for in Section A.
2. Operator shall outline the dedicated acreage for *both* oil and gas wells on the plat in Section B.
3. A registered professional engineer or land surveyor registered in the State of New Mexico or approved by the Commission shall show on the plat the location of the well and certify this information in the space provided.
4. All distances shown on the plat must be from the outer boundaries of the Section.
5. If additional space is needed for listing owners and their respective interests as required in question 3 of Section A, please use space below.