

(SUBMIT IN TRIPLICATE)

Land Office **New Mexico**

**LC 068132**

Lease No. \_\_\_\_\_

Unit \_\_\_\_\_

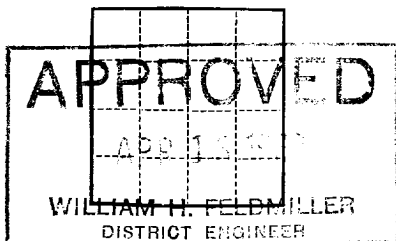

UNITED STATES  
DEPARTMENT OF THE INTERIOR  
GEOLOGICAL SURVEY

**SUNDRY NOTICES AND REPORTS ON WELLS**

NOTICE OF INTENTION TO DRILL	<input checked="" type="checkbox"/>	SUBSEQUENT REPORT OF WATER SHUT-OFF	
NOTICE OF INTENTION TO CHANGE PLANS		SUBSEQUENT REPORT OF SHOOTING OR ACIDIZING	
NOTICE OF INTENTION TO TEST WATER SHUT-OFF		SUBSEQUENT REPORT OF ALTERING CASING	
NOTICE OF INTENTION TO RE-DRILL OR REPAIR WELL		SUBSEQUENT REPORT OF RE-DRILLING OR REPAIR	
NOTICE OF INTENTION TO SHOOT OR ACIDIZE		SUBSEQUENT REPORT OF ABANDONMENT	
NOTICE OF INTENTION TO PULL OR ALTER CASING		SUPPLEMENTARY WELL HISTORY	
NOTICE OF INTENTION TO ABANDON WELL			

(INDICATE ABOVE BY CHECK MARK NATURE OF REPORT, NOTICE, OR OTHER DATA)

April 18, 1963

Well No. **2 X** is located <sup>2345</sup>~~2340~~ ft. from <sup>N</sup>~~S~~ line and <sup>2345</sup>~~2340~~ ft. from <sup>XX</sup>~~W~~ line of sec. **35**  
**NE/4 SW/4, Sec. 35** **SS** **26E** **NMP**  
 (1/4 Sec. and Sec. No.) (Twp.) (Range) (Meridian)  
**Wild** **Chaves** **New Mexico**  
 (Field) (County or Subdivision) (State or Territory)

The elevation of the derrick floor above sea level is \_\_\_\_\_ ft.

**DETAILS OF WORK**

(State names of and expected depths to objective sands; show sizes, weights, and lengths of proposed casings; indicate mudding jobs, cementing points, and all other important proposed work)

Plan to drill with rotary tools to test the San Andres formation at approximately 1400 feet. Will run 7" casing to approximately 100' and cement with a volume sufficient to circulate to surface. Will core San Andres Pay Zone. If commercial pay is encountered will run 4-1/2" production string and cement with approximately 50 sacks of cement.

RECEIVED  
APR 19 1963

I understand that this plan of work must receive approval in writing by the Geological Survey before operations may be commenced.

Company \_\_\_\_\_  
 Address **Nickson Hotel**  
**Roswell, New Mexico**  
 By **J. W. Brown**  
 Title **Owner**

NUMBER OF COPIES RECEIVED	
DISTRIBUTION	
SANTA FE	
FILE	
U.S.G.	
LAND OFFICE	
TRANSPORTER	OIL GAS
PRODUCTION OFFICE	
OPERATOR	

# NEW MEXICO OIL CONSERVATION COMMISSION

FORM C-128  
Revised 5/1/57

## WELL LOCATION AND ACREAGE DEDICATION PLAT

SEE INSTRUCTIONS FOR COMPLETING THIS FORM ON THE REVERSE SIDE

### SECTION A

Operator		Lease		Well No.	
Unit Letter	Section 35	Township 6-S	Range 26-E	County CHAVES	
Actual Footage Location of Well: 2310' feet from the SOUTH line and 2310' feet from the WEST line					
Ground Level Elev. 3789.7'	Producing Formation		Pool		Dedicated Acreage: Acres

1. Is the Operator the only owner in the dedicated acreage outlined on the plat below? YES \_\_\_\_\_ NO \_\_\_\_\_. ("Owner" means the person who has the right to drill into and to produce from any pool and to appropriate the production either for himself or for himself and another. (65-3-29 (e) NMSA 1935 Comp.)
2. If the answer to question one is "no," have the interests of all the owners been consolidated by communitization agreement or otherwise? YES \_\_\_\_\_ NO \_\_\_\_\_. If answer is "yes," Type of Consolidation \_\_\_\_\_
3. If the answer to question two is "no," list all the owners and their respective interests below:

Owner	Land Description

### SECTION B

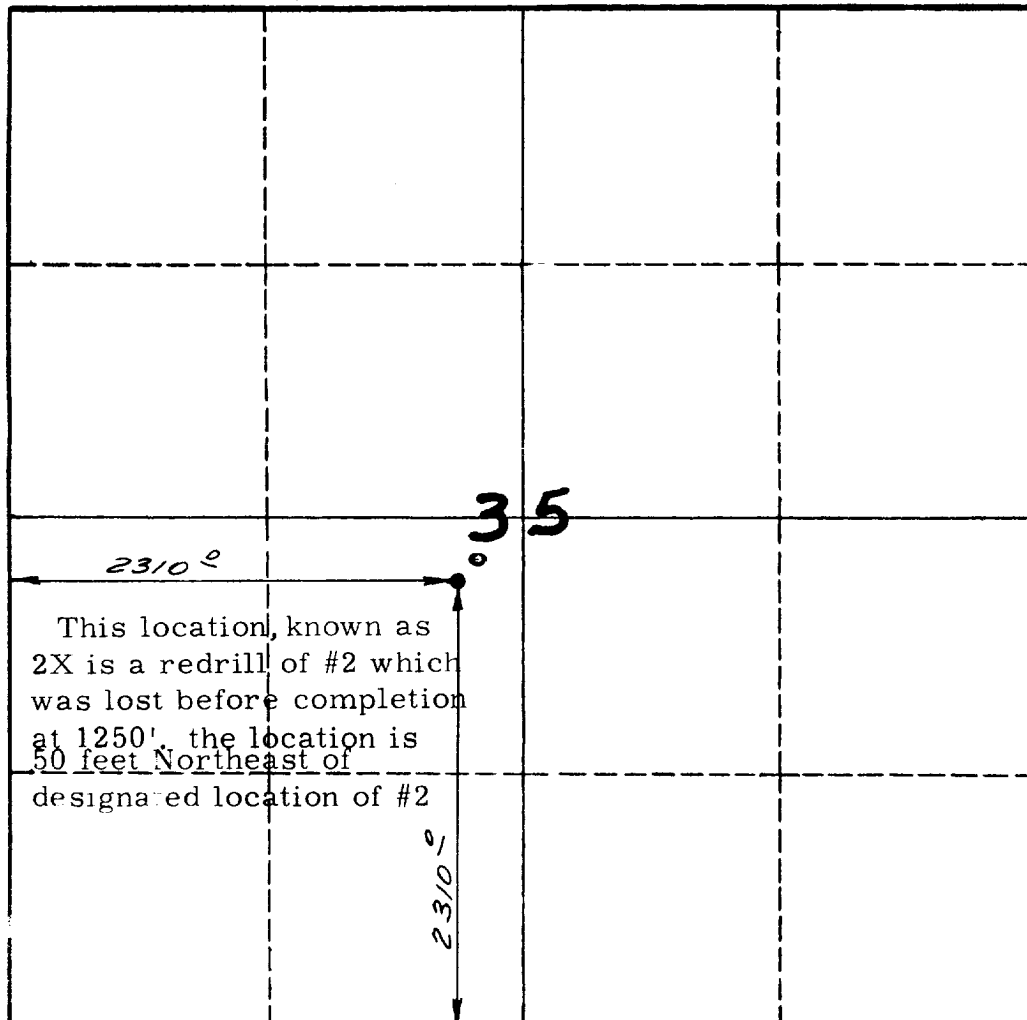

### CERTIFICATION

I hereby certify that the information in SECTION A above is true and complete to the best of my knowledge and belief.

Name
Position
Company
Date

I hereby certify that the well location shown on the plat in SECTION B was plotted from field notes of actual surveys made by me or under my supervision, and that the same is true and correct to the best of my knowledge and belief.

Date Surveyed
March 25, 1963
Registered Professional Engineer and/or Land Surveyor
<i>[Signature]</i>
Certificate No. 3241

0 330 660 990 1320 1650 1980 2310 2640 2000 1500 1000 500 0