

NEW MEXICO OIL CONSERVATION COMMISSION

Well Location and Acreage Dedication Plat

Section A.

Date April 1, 1963

Operator WILLIAM M. HILL CO., INC. Lease W. M. Hill
Well No. 1 Unit Letter H Section 1 Township 1N Range 24E NMPM
Located 660' Feet From 1/4 Line, 660' Feet From 1/4 Line
County Curry G. L. Elevation 5285' Dedicated Acreage 1/4 Acres
Name of Producing Formation Permian Pool Permian

1. Is the Operator the only owner* in the dedicated acreage outlined on the plat below?
Yes X No .
2. If the answer to question one is "no," have the interests of all the owners been consolidated by communitization agreement or otherwise? Yes No . If answer is "yes," Type of Consolidation
3. If the answer to question two is "no," list all the owners and their respective interests below:

Owner

Land Description

RECEIVED

APR 1 1963

O. C. C.
ARTESIA, OFFICE

Section B.

S89°54'47"E-52855'

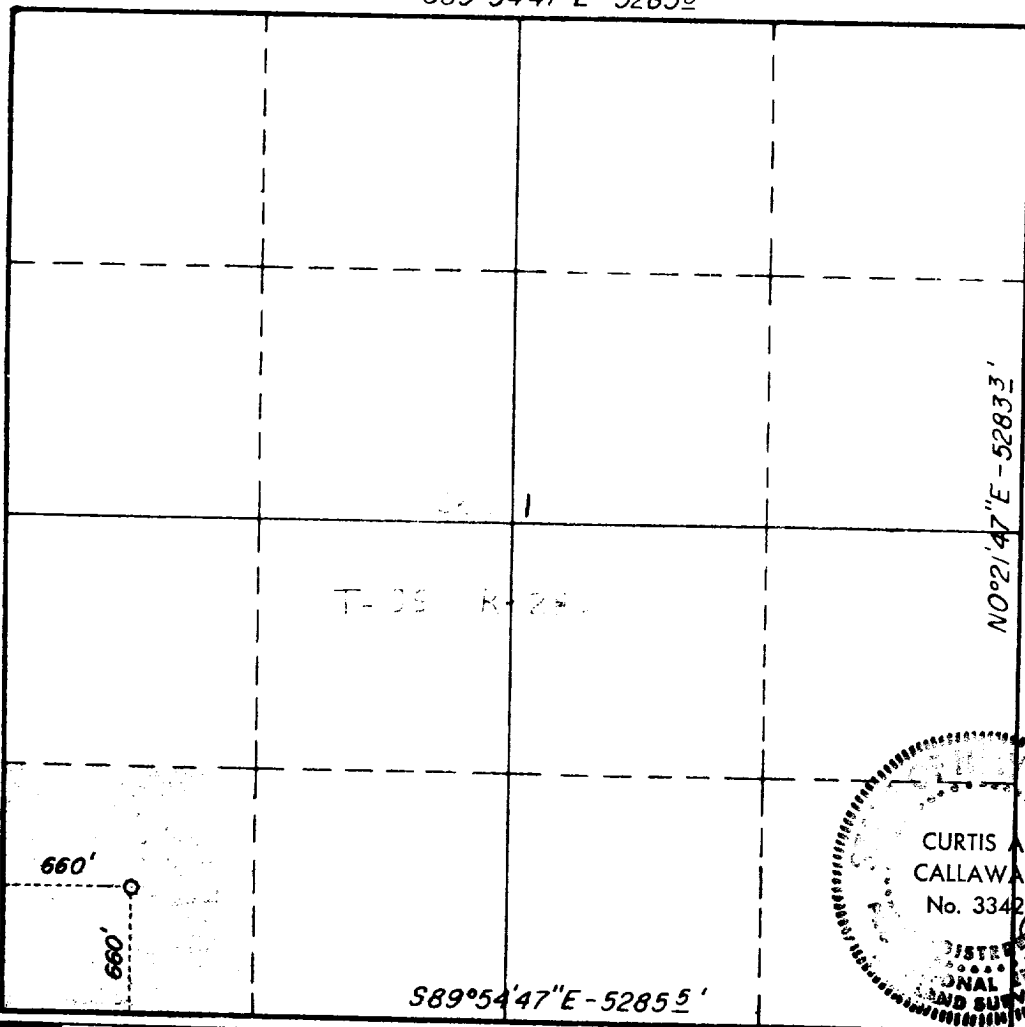

This is to certify that the information in Section A above is true and complete to the best of my knowledge and belief.

WILLIAM M. HILL CO., INC.

(Operator)

W. M. Hill
(Representative)

Address

This is to certify that the well location shown on the plat in Section B was plotted from field notes of actual surveys made by me or under my supervision and that the same is true and correct to the best of my knowledge and belief.

Date Surveyed April 1, 1963

Curtis A. Callaway
Registered Professional Engineer and/or Land Surveyor.

Certificate No. 3342

OIL CONSERVATION COMMISSION	
ALABAMA DISTRICT OFFICE	
REPORT MADE BY	<u>5</u>
DATE	
CHESTER	<u>1</u>
MOBILE	<u>1</u>
BIRMINGHAM OFFICE	
MEMPHIS OFFICE	
TOTAL	<u>2</u>
APPROVED	<u>1</u>
SPECIAL AGENT IN CHARGE	