

UNITED STATES
DEPARTMENT OF THE INTERIOR
GEOLOGICAL SURVEYCOPY 1 J.
to
SUBMIT IN DUPLICATE
(Other instructions on
reverse side)Form approved.
Budget Bureau No. 42-R1425.30-005-10228
5. LEASE DESIGNATION AND SERIAL NO.
LC 068127

6. IF INDIAN, ALLOTTEE OR TRIBE NAME

7. UNIT AGREEMENT NAME

8. FARM OR LEASE NAME
Elliott Fed.9. WELL NO.
310. FIELD AND POOL, OR WILDCAT
Linda San Andres11. SEC., T., R., M., OR BLK.
AND SURVEY OR AREA
Sec. 33, T6S, R26E

12. COUNTY OR PARISH 13. STATE

APPLICATION FOR PERMIT TO DRILL, DEEPEN, OR PLUG BACK

1a. TYPE OF WORK

DRILL ☒DEEPEN ☐PLUG BACK ☐

b. TYPE OF WELL

OIL
WELL ☒GAS
WELL ☐

OTHER

SINGLE
ZONE ☒MULTIPLE
ZONE ☐2. NAME OF OPERATOR
Dr. Sam G. Dunn3. ADDRESS OF OPERATOR
1312 Main, Lubbock, Texas

4. LOCATION OF WELL (Report location clearly and in accordance with any State requirements.)*

At surface 1650 ft. from South line and 1650 ft. from
East line of Section 33, T-6S, R.26E, NMPM
At proposed prod. zone
San Andres

14. DISTANCE IN MILES AND DIRECTION FROM NEAREST TOWN OR POST OFFICE*

15. DISTANCE FROM PROPOSED*

LOCATION TO NEAREST
PROPERTY OR LEASE LINE, FT.
(Also to nearest drlg. line, if any)16. NO. OF ACRES IN LEASE
2017. NO. OF ACRES ASSIGNED
TO THIS WELL
2018. DISTANCE FROM PROPOSED LOCATION*
TO NEAREST WELL, DRILLING, COMPLETED,
OR APPLIED FOR, ON THIS LEASE, FT.19. PROPOSED DEPTH
120020. ROTARY OR CABLE TOOLS
cable for surface & rotary
to TD

21. ELEVATIONS (Show whether DF, RT, GR, etc.)

22. APPROX. DATE WORK WILL START*
Within 2 weeks

23.

PROPOSED CASING AND CEMENTING PROGRAM

SIZE OF HOLE	SIZE OF CASING	WEIGHT PER FOOT	SETTING DEPTH	QUANTITY OF CEMENT*
11"	8-5/8"	22	105	50 sacks.
6-3/4"	4-1/2"	9.5	TD	50 sacks Circulate

We propose to drill approximately 110 ft. of 11" hole with cable tools
and set approximately 105 ft. of 8-5/8" pipe and circulate cement.
We propose to drill to total depth with rotary tools. The pay
zone will be cased and logged. 4-1/2" pipe will be set through and
cemented with 50 sacks and perforated.

Circulated

RECEIVED

JAN 25 1965

G. E. C.
ARTESIA OFFICE

IN ABOVE SPACE DESCRIBE PROPOSED PROGRAM: If proposal is to deepen or plug back, give data on present productive zone and proposed new productive zone. If proposal is to drill or deepen directionally, give pertinent data on subsurface locations and measured and true vertical depths. Give blowout preventer program, if any.

24.

SIGNED

Pat. Thompson

TITLE

Agent

DATE

May 3, 1964

(This space for Federal or State office use)

PERMIT NO.

APPROVAL DATE

APPROVED BY

TITLE

CONDITIONS OF APPROVAL, IF ANY:

M200 - ARTESIA
M200 - H200S
BLM - SANTA FE

*See Instructions On Reverse Side

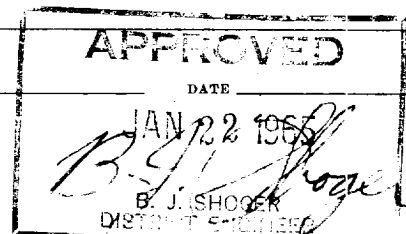

Instructions

General: This form is designed for submitting proposals to perform certain well operations, as indicated, on all types of lands and leases for appropriate action by either a Federal or a State agency, or both, pursuant to applicable Federal and/or State laws and regulations. Any necessary special instructions concerning the use of this form and the number of copies to be submitted, particularly with regard to local, area, or regional procedures and practices, either are shown below or will be issued by, or may be obtained from, the local Federal and/or State office.

Item 1: If the proposal is to redrill to the same reservoir at a different subsurface location or to a new reservoir, use this form with appropriate notations. Consult applicable State or Federal regulations concerning subsequent work proposals or reports on the well.

Item 4: If there are no applicable State requirements, locations on Federal or Indian land should be described in accordance with Federal requirements. Consult local State or Federal office for specific instructions.

Item 14: Needed only when location of well cannot readily be found by road from the land or lease description. A plat, or plats, separate or on this reverse side, showing the roads to, and the surveyed location of, the well, and any other required information, should be furnished when required by Federal or State agency offices.

Items 15 and 18: If well is to be, or has been directionally drilled, give distances for subsurface location of hole in any present or objective production zone.

Item 22: Consult applicable Federal or State regulations, or appropriate officials, concerning approval of the proposal before operations are started.

NO. OF COPIES RECEIVED	
DISTRIBUTION	
SANTA FE	
FILE	
U.S.G.S.	
LAND OFFICE	
TRANSPORTER	OIL GAS
PRODUCTION OFFICE	
OPERATOR	

NEW MEXICO OIL CONSERVATION COMMISSION
WELL LOCATION AND ACREAGE DEDICATION PLAT
 SEE INSTRUCTIONS FOR COMPLETING THIS FORM ON THE REVERSE SIDE

FORM C-128
 Revised 5/1/57

SECTION A

Operator Dr. Sam G. Dunn			Lease Elliott Federal		Well No. 3
Unit Letter J	Section 33	Township T-6-S	Range R-26-E	County Chaves	

Actual Footage Location of Well:
1650 feet from the **South** line and **1650** feet from the **East** line

Ground Level Elev.	Producing Formation San Andres ✓	Pool Linda San Andres ✓	Dedicated Acreage: 20 Acres
--------------------	--------------------------------------------	-----------------------------------	---------------------------------------

1. Is the Operator the only owner in the dedicated acreage outlined on the plat below? YES ☒ NO ____ . ("Owner" means the person who has the right to drill into and to produce from any pool and to appropriate the production either for himself or for himself and another. (65-3-29 (e) NMSA 1935 Comp.)
2. If the answer to question one is "no," have the interests of all the owners been consolidated by communitization agreement or otherwise? YES ____ NO ____ . If answer is "yes," Type of Consolidation **RECEIVED**
3. If the answer to question two is "no," list all the owners and their respective interests below:

Owner	Land Description JAN 25 1965
-------	----------------------------------------

SECTION B

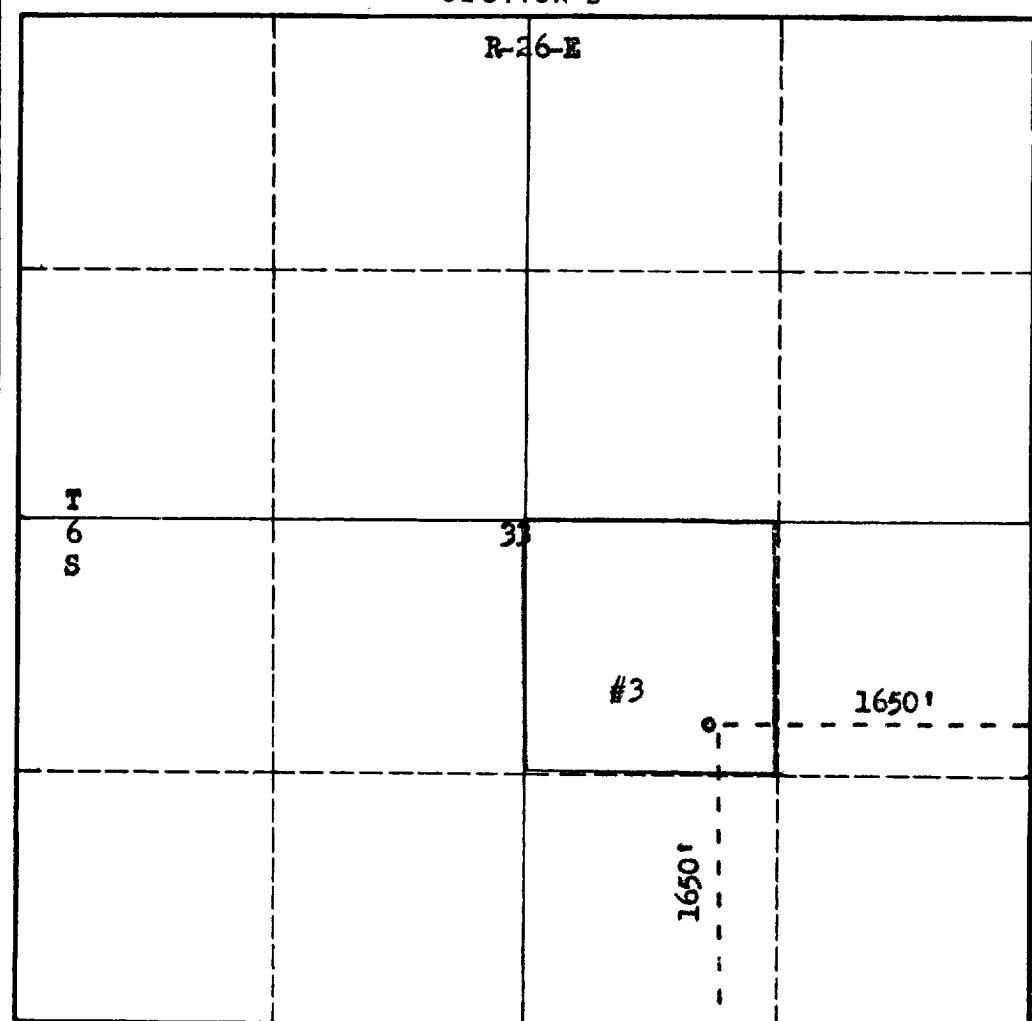

O. C. C.
ARTESIA, OFFICE
CERTIFICATION

I hereby certify that the information in SECTION A above is true and complete to the best of my knowledge and belief.

Name Pat Thompson
Position Agent
Company Dr. Sam G. Dunn
Date May 3, 1964

I hereby certify that the well location shown on the plat in SECTION B was plotted from field notes of actual surveys made by me or under my supervision, and that the same is true and correct to the best of my knowledge and belief.

Date Surveyed April 13, 1964
Registered Professional Engineer and/or Land Surveyor

James H. Brown
 Certificate No. **542**

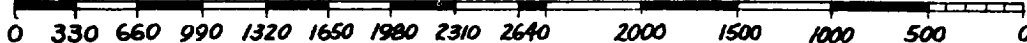

INSTRUCTIONS FOR COMPLETION OF FORM C-128

1. Operator shall furnish and certify to the information called for in Section A.
2. Operator shall outline the dedicated acreage for *both* oil and gas wells on the plat in Section B.
3. A registered professional engineer or land surveyor registered in the State of New Mexico or approved by the Commission shall show on the plat the location of the well and certify this information in the space provided.
4. All distances shown on the plat must be from the outer boundaries of the Section.
5. If additional space is needed for listing owners and their respective interests as required in question 3 of Section A, please use space below.