

NUMBER OF COPIES RECEIVED	
DISTRIBUTION	
SANTA FE	1
FILE	2
U.S.G.S.	
LAND OFFICE	
TRANSPORTER	
OIL GAS	
PRODUCTION OFFICE	
OPERATOR	2

NE MEXICO OIL CONSERVATION COMMISSION
Santa Fe, New Mexico

Form C-101
Revised (12/1/55)

NOTICE OF INTENTION TO DRILL

Notice must be given to the District Office of the Oil Conservation Commission and approval obtained before drilling or recompletion begins. If changes in the proposed plan are considered advisable, a copy of this notice showing such changes will be returned to the sender. Submit this notice in QUINTUPPLICATE. One copy will be returned following approval. See additional instructions in Rules and Regulations of the Commission. If State Land submit 6 Copies Attach Form C- 128 in triplicate to first 3 copies of form C-101

Reswell, New Mexico

December 5, 1963

(Place)

(Date)

OIL CONSERVATION COMMISSION
SANTA FE, NEW MEXICO

Gentlemen:

30-005-10230

You are hereby notified that it is our intention to commence the Drilling of a well to be known as

Dr. Sam G. Dunn

1312 Main St., Lubbock, Texas

(Company or Operator)

Pendergrass (Lease)

Well No. 3

A

The well is

located 330 feet from the North line and 330 feet from the East line of Section 5, T 7 S, R 26 E, NMPM.

(GIVE LOCATION FROM SECTION LINE)

Und.

Pool,

Chaves

County

If State Land the Oil and Gas Lease is No.

If patented land the owner is Cecil Pendergrass

Address Box 17, Cuchillo, New Mexico

We propose to drill well with drilling equipment as follows: Rotary

The status of plugging bond is 10,000 Blanket

Drilling Contractor H. E. Barnes

Reswell, New Mexico

We intend to complete this well in the San Andres

formation at an approximate depth of 1100

ARTESIAL OFFICE

CASING PROGRAM

We propose to use the following strings of Casing and to cement them as indicated:

Size of Hole	Size of Casing	Weight per Foot	New or Second Hand	Depth	Sacks Cement
11"	8 5/8	32 1/2	Used	100	Circulate
6 3/4"	4 1/2	9 1/2	New	1100	50 Sacks

If changes in the above plans become advisable we will notify you immediately.

ADDITIONAL INFORMATION (If recompletion give full details of proposed plan of work.)

DEC 6 1963

Approved: _____, 19_____
Except as follows:

Sincerely yours,

Dr. Sam G. Dunn

(Company or Operator)

By: H. E. Barnes

Position Representative

Send Communications regarding well to

Name Dr. Sam G. Dunn

Address 1312 Main, Lubbock, Texas.

OIL CONSERVATION COMMISSION

By: M. L. Armstrong

NEW MEXICO OIL CONSERVATION COMMISSION
WELL LOCATION AND ACREAGE DEDICATION PLAT

FORM C-120
Revised 5/1/57

SEE INSTRUCTIONS FOR COMPLETING THIS FORM ON THE REVERSE SIDE

SECTION A

Operator DR. SAM G. DUNN		Lease PENDERGRASS		Well No. 3
Unit Letter A	Section 5	Township 7 SOUTH	Range 26 EAST	County CHAVES
Actual Footage Location of Well: 330 feet from the NORTH line and 330 feet from the EAST line				
Ground Level Elev. 3602.25	Producing Formation SAN ANTONIO		Pool Und.	Dedicated Acreage: 40 Acres

1. Is the Operator the only owner in the dedicated acreage outlined on the plat below? YES **XX** NO ____ . ("Owner" means the person who has the right to drill into and to produce from any pool and to appropriate the production either for himself or for himself and another. (65-3-29 (a) NMSA 1955 Comp.)
2. If the answer to question one is "no," have the interests of all the owners been consolidated by communization agreement or otherwise? YES ____ NO ____ . If answer is "yes," Type of Consolidation _____
3. If the answer to question two is "no," list all the owners and their respective interests below:

RECEIVED

Owner	Land Description
	DEC 6 1963
	N. C. C.
	ARTESIA, OFFICE

SECTION B

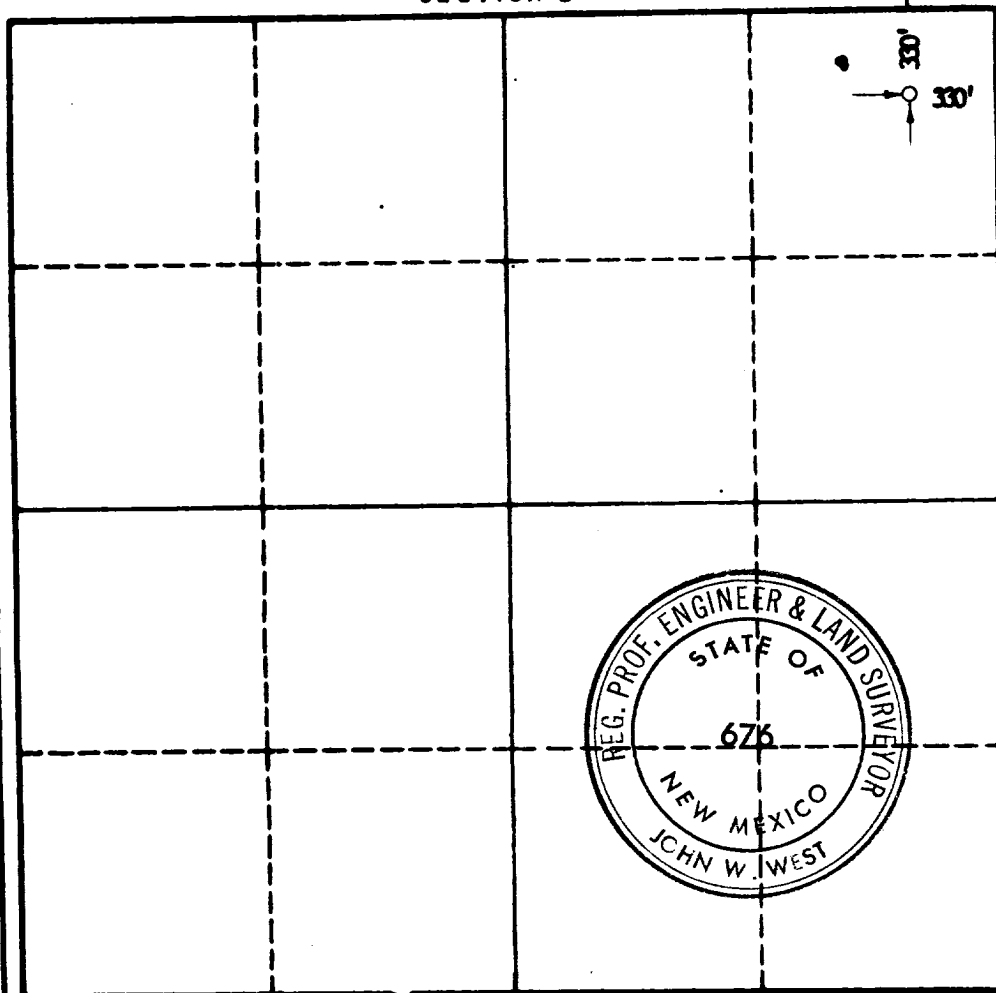

CERTIFICATION

I hereby certify that the information in SECTION A above is true and complete to the best of my knowledge and belief.

Name **J. E. Barnes**
Position **Representative**
Company **Dr. Sam G. Dunn**
Date **12-5-63**

I hereby certify that the well location shown on the plat in SECTION B was plotted from field notes of actual surveys made by me or under my supervision, and that the same is true and correct to the best of my knowledge and belief.

Date Surveyed **11-27-63**
Registered Professional Engineer and/or Land Surveyor, **JOHN W. WEST**
Signature **John W. West**
Certificate No. **N. M. - P. E. & L. S. NO. 676**