

|                                    |           |
|------------------------------------|-----------|
| NUMBER OF COPIES RECEIVED <u>6</u> |           |
| DISTRIBUTION                       |           |
| SANTA FE                           | <u>1</u>  |
| FILE                               | <u>15</u> |
| U.S.G.S.                           | <u>2</u>  |
| LAND OFFICE                        |           |
| TRANSPORTER                        |           |
| OIL GAS                            |           |
| PRORATION OFFICE                   |           |
| OPERATOR                           | <u>1</u>  |

NEW MEXICO OIL CONSERVATION COMMISSION  
Santa Fe, New Mexico

Form C-101  
Revised 12/1/55

NOTICE OF INTENTION TO DRILL

30-085-10418

Notice must be given to the District Office of the Oil Conservation Commission and approval obtained before drilling or recompletion begins. If changes in the proposed plan are considered advisable, a copy of this notice showing such changes will be returned to the sender. Submit this notice in QUINTUPLICATE. One copy will be returned following approval. See additional instructions in Rules and Regulations of the Commission. If State Land submit 6 Copies. Attach Form C-128 in triplicate to first 3 copies of Form C-101.

RECEIVED

Hobbs, New Mexico (Place) October 20, 1965 (Date)

OIL CONSERVATION COMMISSION  
SANTA FE, NEW MEXICO

OCT 21 1965

APPROVAL VALID  
FOR 90 DAYS UNLESS  
DRILLING COMMENCED

Gentlemen:

O. C. C.  
ARTESIA OFFICE

You are hereby notified that it is our intention to commence the Drilling of a well to be known as

EXPIRES 1-17-66

Charles P. Miller

(Company or Operator)

State Sm  
S. M. State (E-9405) (Lease), Well No. 2, in A (Unit) The well is

located 860' feet from the North line and 660 feet from the East line of Section 29, T 4 S, R 27 E, NMPM.

(GIVE LOCATION FROM SECTION LINE) Undesignated Pool, Chaves County

|   |   |   |   |
|---|---|---|---|
| D | C | B | A |
| E | F | G | H |
| L | K | J | I |
| M | N | O | P |

If State Land the Oil and Gas Lease is No. E-9405

If patented land the owner is \_\_\_\_\_

Address \_\_\_\_\_

We propose to drill well with drilling equipment as follows: Set surface casing with Cable Tools then complete with Rotary Tools.

The status of plugging bond is Blanket Bond in good standing

Drilling Contractor Contract not yet let

We intend to complete this well in the Morrow Sand of Pennsylvanian formation at an approximate depth of 6500 feet.

CASING PROGRAM

We propose to use the following strings of Casing and to cement them as indicated:

| Size of Hole   | Size of Casing | Weight per Foot | New or Second Hand | Depth        | Sacks Cement                                       |
|----------------|----------------|-----------------|--------------------|--------------|--|
| <u>12-1/4"</u> | <u>8-5/8"</u>  | <u>32#</u>      | <u>S.H.</u>        | <u>1200'</u> | <u>150</u>   |
| <u>7-5/8"</u>  | <u>5-1/2"</u>  | <u>15.5#</u>    | <u>S.H.</u>        | <u>6500'</u> | <u>Will meet require-</u><br><u>ment of O.C.C.</u> |

If changes in the above plans become advisable we will notify you immediately.

ADDITIONAL INFORMATION (If recompletion give full details of proposed plan of work.) This hole was spudded to depth of 30 feet by 9:00 P.M. Oct. 18, 1965. Work was witnessed by Mr. Willoughby.

NOTE: Verbal approval for the above outlined program was obtained over telephone from Mr. Mese Armstrong, of the Artesia Office @ 3:30 P.M. October 18, 1965. The same program was outlined, via telephone, to Mr Ray Graham 10/18/65

Approved OCT 21 1965, 19  
Except as follows:

Sincerely yours,

Charles P. Miller  
(Company or Operator)

By Charles P. Miller

Position Owner

Send Communications regarding well to

Name Charles P. Miller

Address P. O. Box 417, Hobbs, New Mexico

OIL CONSERVATION COMMISSION

By MLC  
Oil and Gas Inspector

**N MEXICO OIL CONSERVATION COMMISSION  
WELL LOCATION AND ACREAGE DEDICATION PLAT**

Form C-102  
Supersedes C-128  
Effective 1-1-65

All distances must be from the outer boundaries of the Section.

|  |                      |                            |   |                             |                      |
|--|----------------------|----------------------------|---|-----------------------------|----------------------|
| Operator<br><b>CHARLES P. MILLER</b>   |                      |                            | Lease<br><b>S-M STATE</b> <i>State Sm</i> |                             | Well No.<br><b>2</b> |
| Unit Letter<br><b>A</b>  | Section<br><b>29</b> | Township<br><b>4 SOUTH</b> | Range<br><b>27 EAST</b>                   | County<br><b>CHAVES</b>     |                      |
| Actual Footage Location of Well:<br><b>860</b> feet from the <b>NORTH</b> line and <b>660</b> feet from the <b>EAST</b> line |                      |                            |   |                             |                      |
| Ground Level Elev.   | Producing Formation  |                            | Pool<br><i>Under Newmill Penn. (Gas)</i>  | Dedicated Acreage:<br>Acres |                      |

1. Outline the acreage dedicated to the subject well by colored pencil or hachure marks on the plat below.
2. If more than one lease is dedicated to the well, outline each and identify the ownership thereof (both as to working interest and royalty).
3. If more than one lease of different ownership is dedicated to the well, have the interests of all owners been consolidated by communitization, unitization, force-pooling, etc?

☐ Yes ☐ No If answer is "yes," type of consolidation \_\_\_\_\_

**OCT 21 1965**

If answer is "no," list the owners and tract descriptions which have actually been consolidated. (Use reverse side of this form if necessary.) \_\_\_\_\_

**O. C. C.**

No allowable will be assigned to the well until all interests have been consolidated (by communitization, unitization, forced-pooling, or otherwise) or until a non-standard unit, eliminating such interests, has been approved by the Commission.

**NOTE: GROUND ELEVATION IS 12.5 FEET HIGHER THAN MILLER STATE NO. 1 LOCATED IN UNIT C SEC. 20, TWP. 4 SOUTH, RANGE 27 EAST.**

**CERTIFICATION**

I hereby certify that the information contained herein is true and complete to the best of my knowledge and belief.

Name: *Charles P. Miller*  
 Position: *Owner*  
 Company: *Charles P. Miller*  
 Date: *Oct 20 1965*

I hereby certify that the well location shown on this plat was plotted from field notes of actual surveys made by me or under my supervision, and that the same is true and correct to the best of my knowledge and belief.

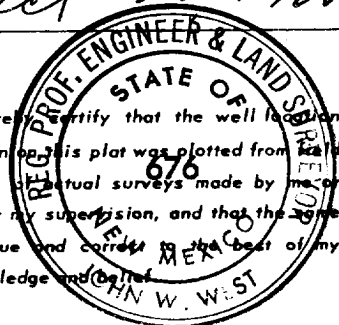

Date Surveyed  
**OCT. 18, 1965**

Registered Professional Engineer and/or Land Surveyor

*John W. West*  
 Certificate No. **676**

