

NEW MEXICO OIL CONSERVATION COMMISSION
WELL LOCATION AND ACREAGE DEDICATION PLAT
SEE INSTRUCTIONS FOR COMPLETING THIS FORM ON THE REVERSE SIDE

FORM C-128
Revised 5/1/57

SECTION A

Operator <u>Dunn</u> ✓		Lease <u>Dale Federal</u>		Well No. <u>8</u>
Section <u>26</u>	Township <u>T-7-S</u>	Range <u>R-26-E</u>	County <u>Chaves</u>	

Actual Footage Location of Well:

<u>1650</u> feet from the <u>North</u> line and <u>2310</u> feet from the <u>West</u> line	Ground Level Elev. <u>3786</u>	Producing Formation <u>San Andres</u>	Pool <u>Leslie Springs SA</u>	Dedicated Acreage: <u>2040</u> Acres
--	-----------------------------------	--	----------------------------------	---

1. Is the Operator the only owner in the dedicated acreage outlined on the plat below? YES _____ NO _____. ("Owner" means the person who has the right to drill into and to produce from any pool and to appropriate the production either for himself or for himself and another. (65-3-29 (e), NMSA 1935 Comp.)
2. If the answer to question one is "no," have the interests of all the owners been consolidated by communitization agreement or otherwise? YES _____ NO _____. If answer is "yes," Type of Consolidation _____
- If the answer to question two is "no," list all the owners and their respective interests below:

Owner	Land Description
	<u>MAY 27 1966</u>
	<u>O. C. C.</u>
	<u>ARTERIAL OFFICE</u>

SECTION B

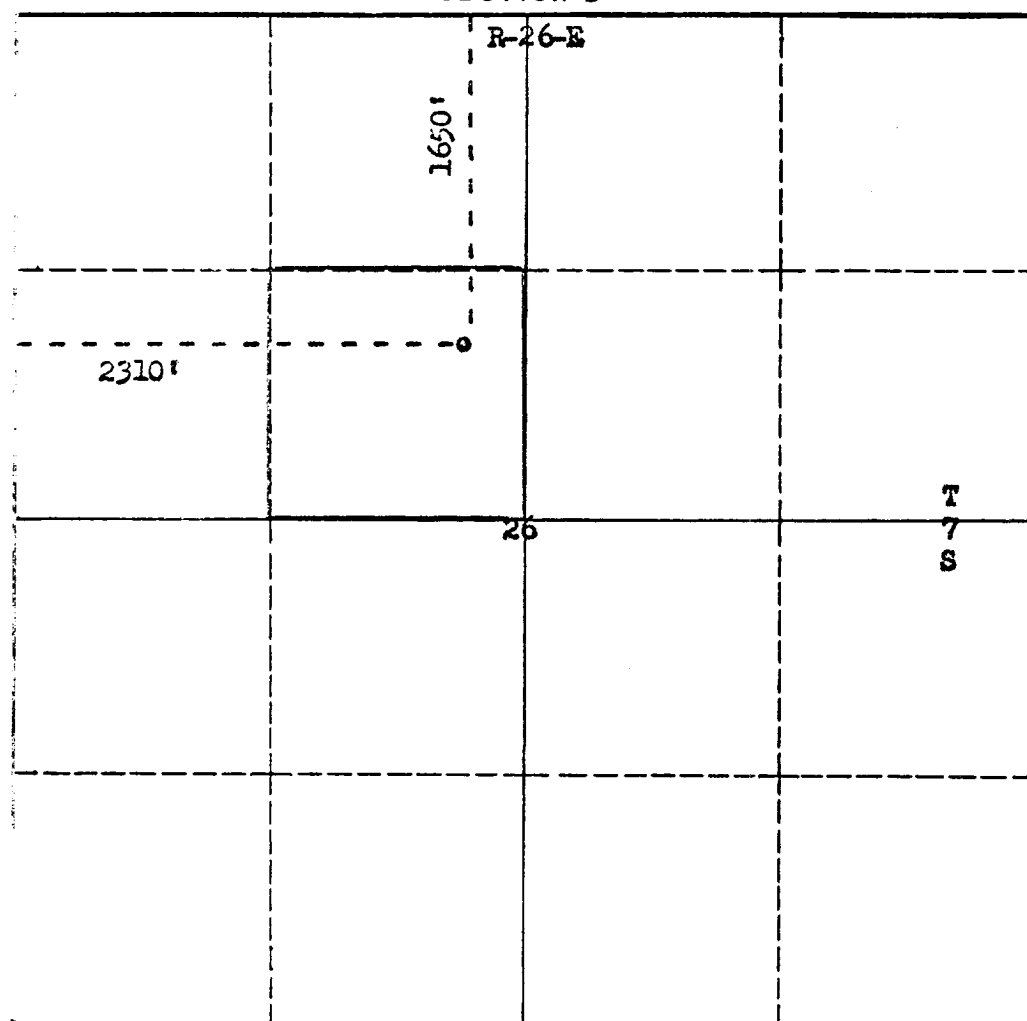

CERTIFICATION

I hereby certify that the information in SECTION A above is true and complete to the best of my knowledge and belief.

Name

Position

Company

Date

I hereby certify that the well location shown on the plat in SECTION B was plotted from field notes of actual surveys made by me or under my supervision, and that the same is true and correct to the best of my knowledge and belief.

Date Surveyed

May 5, 1964

Registered Professional Engineer
and/or Land Surveyor

Certificate No.

542

OR CONSERVATION COMMISSION

ARTESIA DISTRICT OFFICE

No. Copies Received 5

DISTRIBUTION

	COPIES FURNISHED
CHIEF OF BUREAU	2
SANTA FE	1
CHIEF OF DISTRICT	
CHIEF OF DIVISION	
CHIEF OF SECTION	1
CHIEF OF UNIT	1-