

UNITED STATES
DEPARTMENT OF THE INTERIOR
GEOLOGICAL SURVEY30-005-10426
5. LEASE DESIGNATION SERIAL NO.
X NM-022504

APPLICATION FOR PERMIT TO DRILL, DEEPEN, OR PLUG BACK

1a. TYPE OF WORK

DRILL ☒DEEPEN ☐PLUG BACK ☐

b. TYPE OF WELL

OIL
WELL ☒GAS
WELL ☐

OTHER

SINGLE
ZONE ☐MULTIPLE
ZONE ☐

2. NAME OF OPERATOR

Dr. Sam G. Dunn

3. ADDRESS OF OPERATOR

1312 Main, Lubbock, Texas

4. LOCATION OF WELL (Report location clearly and in accordance with any State requirements.)*

At surface 1000 FWL and 1050' FNL Sec. 28, T-7-S, R-26-E

At proposed prod. zone 2310'

Slaughter San Andres

14. DISTANCE IN MILES AND DIRECTION FROM NEAREST TOWN OR POST OFFICE*

12. COUNTY OR PARISH

Chaves

13. STATE

M.

15. DISTANCE FROM PROPOSED*

LOCATION TO NEAREST
PROPERTY OR LEASE LINE, FT.
(Also to nearest drlg. line, if any)

16. NO. OF ACRES IN LEASE

17. NO. OF ACRES ASSIGNED
TO THIS WELL

40

18. DISTANCE FROM PROPOSED LOCATION*
TO NEAREST WELL, DRILLING, COMPLETED,
OR APPLIED FOR, ON THIS LEASE, FT.

19. PROPOSED DEPTH

1400 ft.

20. ROTARY OR CABLE TOOLS

Rotary

21. ELEVATIONS (Show whether DF, RT, GR, etc.)

3704-GR 3711 ft.

22. APPROX. DATE WORK WILL START*

August 27, 1964

23.

PROPOSED CASING AND CEMENTING PROGRAM

SIZE OF HOLE	SIZE OF CASING	WEIGHT PER FOOT	SETTING DEPTH	QUANTITY OF CEMENT
11"	8-5/8"	28#	550-100	Enough to circulate
6-3/4"	4-1/2"	9.5#	1400	" " "

We propose to drill with rotary tools an 11" hole to 550' and use used 28# 8-5/8" casing and cement to circulate. We will wait 24 hrs. and drill an 8" hole to TD, and run 4-1/2" new pipe, cementing to circulate. 42/4 ✓ NEW

App. Op. Agree ✓
Op. N-w bond ✓

RECEIVED

AUG 28 1964

O. C. C.
ARTESIA, OFFICE

IN ABOVE SPACE DESCRIBE PROPOSED PROGRAM: If proposal is to deepen or plug back, give data on present productive zone and proposed new productive zone. If proposal is to drill or deepen directionally, give pertinent data on subsurface locations and measured and true vertical depths. Give blowout preventer program, if any.

24.

SIGNED

Ruth Thompson

TITLE

Agent

DATE

August 24,

(This space for Federal or State office use)

PERMIT NO.

APPROVAL DATE

APPROVED BY

TITLE

CONDITIONS OF APPROVAL, IF ANY:

*See Instructions On Reverse Side

B. J. SHOGER
DISTRICT ENGINEER

NUMBER OF COPIES RECEIVED	
DISTRIBUTION	
SANTA FE	
FILE	
U.S.G.S.	
LAND OFFICE	
TRANSPORTER	OIL GAS
PROBATION OFFICE	
OPERATOR	

NEW MEXICO OIL CONSERVATION COMMISSION
WELL LOCATION AND ACREAGE DEDICATION PLAT
 SEE INSTRUCTIONS FOR COMPLETING THIS FORM ON THE REVERSE SIDE

FORM C-120
 Revised 5/1/57

SECTION A

Operator <i>San G. Pump</i>		Lease <i>San G. Pump</i>		Well No. <i>5-25</i>	
Unit Letter <i>U</i>	Section <i>23</i>	Township <i>7 South</i>	Range <i>26 East</i>	County <i>Chuska</i>	
Actual Footage Location of Well: <i>2310</i> feet from the <i>North</i> line and <i>2310</i> feet from the <i>West</i> line					
Ground Level Elev. <i>3711</i>	Producing Formation? <i>Slaughterhouse Creek</i>	Pool <i>Undesignated</i>	Dedicated Acreage: <i>40</i> Acres		

1. Is the Operator the only owner in the dedicated acreage outlined on the plat below? YES ☒ NO ☐ ("Owner" means the person who has the right to drill into and to produce from any pool and to appropriate the production either for himself or for himself and another. (65-3-29 (e) NMSA 1935 Comp.)
2. If the answer to question one is "no," have the interests of all the owners been consolidated by communization agreement or otherwise? YES ☐ NO ☐ . If answer is "yes," Type of Consolidation **RECEIVED**
3. If the answer to question two is "no," list all the owners and their respective interests below:

Owner	Land Description	AUG 28 1964
		O. C. C.
		ARTESIA, OFFICE

SECTION B

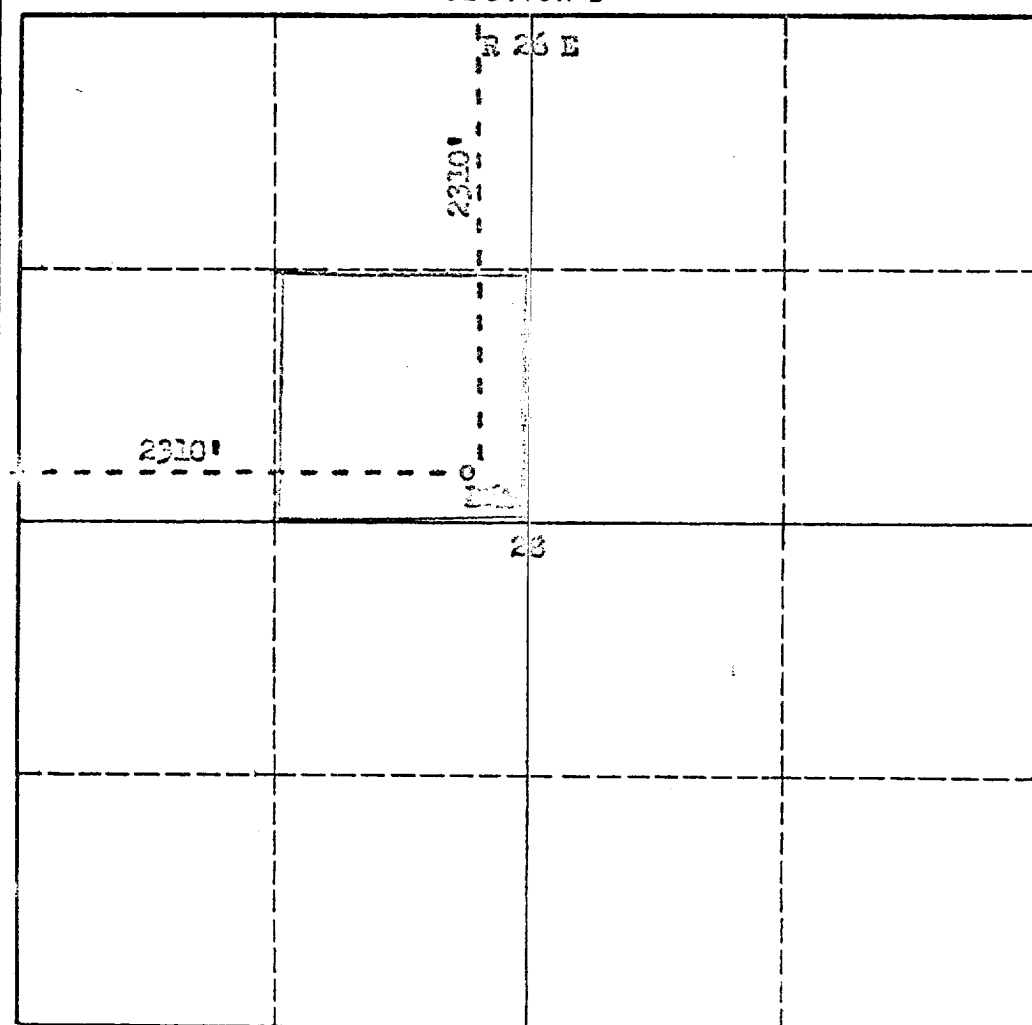

CERTIFICATION

I hereby certify that the information in SECTION A above is true and complete to the best of my knowledge and belief.

Name <i>John Thompson</i>
Position <i>Agent</i>
Company <i>San G. Pump</i>
Date <i>8-24-64</i>

I hereby certify that the well location shown on the plat in SECTION B was plotted from field notes of actual surveys made by me or under my supervision, and that the same is true and correct to the best of my knowledge and belief.

Date Surveyed <i>8-24-64</i>
Registered Professional Engineer and/or Land Surveyor <i>James H. Smith</i>
Certificate No. <i>11111</i>

0 330 660 990 1320 1650 1980 2310 2640 2000 1500 1000 500 0

T
7
S