

NEW MEXICO
OIL CONSERVATION COMMISSION
TENTH & DALLAS STREETS
ARTESIA, NEW MEXICO

April, 1966

No. A 46

SUPPLEMENT TO THE OIL PRORATION SCHEDULE

DATE 4/22/66

PURPOSE: ALLOWABLE ASSIGNMENT (NEW WELL)

Effective 4/8/66 an allowable of 20 barrels of oil
per day or a total of 460 barrels for the month is
hereby assigned to the Dr. Sam G. Dunn, Standard State
#3-B, 5-8-27, Acme San Andres Pool.

This well on same unit with Standard State #2.

MLA/jw

Dr. Sam G. Dunn

McWood

OIL CONSERVATION COMMISSION

M. L. Armstrong
SUPERVISOR, DISTRICT NO. 2

EXTRA COPY

NO. OF COPIES RECEIVED	2
DISTRIBUTION	
SANTA FE	1
FILE	1
U.S.G.S.	2
LAND OFFICE	1
OPERATOR	3

NEW MEXICO OIL CONSERVATION COMMISSION

30-005-10429

Form C-101
Revised 1-1-65

5A. Indicate Type of Lease STATE <input checked="" type="checkbox"/> FEE <input type="checkbox"/>
5. State Oil & Gas Lease No. E 3614

APPLICATION FOR PERMIT TO DRILL, DEEPEN, OR PLUG BACK

1a. Type of Work DRILL <input checked="" type="checkbox"/> DEEPEN <input type="checkbox"/> PLUG BACK <input type="checkbox"/>		7. Unit Agreement Name
b. Type of Well OIL WELL <input checked="" type="checkbox"/> GAS WELL <input type="checkbox"/> OTHER <input type="checkbox"/> SINGLE ZONE <input type="checkbox"/> MULTIPLE ZONE <input type="checkbox"/>		8. Farm or Lease Name Standard State
2. Name of Operator Dr. Sam G. Dunn		9. Well No. 3
3. Address of Operator P.O. Box 192 Aptonia, N.M.		10. Field and Pool, or Wildcat Aemo San Andres
4. Location of Well UNIT LETTER B LOCATED 990 FEET FROM THE North LINE 1650 AND 1650 FEET FROM THE East LINE OF SEC. 5 TWP. 8 S RGE. 27E. NMPM		12. County Chaves
19. Proposed Depth 2000		19A. Formation Aemo San Andres
20. Rotary or C.T. Rotary		
21. Elevations (Show whether DF, RT, etc.)	21A. Kind & Status Plug. Bond Blanket	21B. Drilling Contractor H. E. Barnes
22. Approx. Date Work will start 12-21-1965		

PROPOSED CASING AND CEMENT PROGRAM

SIZE OF HOLE	SIZE OF CASING	WEIGHT PER FOOT	SETTING DEPTH	SACKS OF CEMENT	EST. TOP
11"	8 5/8"	26 1/2	150'	150	
8"	4 1/2"	9 1/2	2000'	200	

Cement Circulated hind 150' of 8 5/8" Casing then drill to 2000' Through Aemo San Andres section, circulated cement with 200 sacks then log and perforate through 4 1/2" and complete with acid.

APPROVAL VALID
FOR 90 DAYS UNLESS
DRILLING COMMENCED
EXPIRES 3-21-66

RECEIVED

DEC 22 1965

IN ABOVE SPACE DESCRIBE PROPOSED PROGRAM: IF PROPOSAL IS TO DEEPEN OR PLUG BACK, GIVE DATA ON PRESENT PRODUCTIVE ZONE AND PROPOSED NEW PRODUCTIVE ZONE, GIVE BLOWOUT PREVENTER PROGRAM, IF ANY.

I hereby certify that the information above is true and complete to the best of my knowledge and belief.

Signed Johna Nell Pater Title Agent. Date 12-20-1965

(This space for State Use)

APPROVED BY M. L. Armstrong TITLE OIL AND GAS INSPECTOR DATE DEC 22 1965
CONDITIONS OF APPROVAL, IF ANY:

NEW MEXICO OIL CONSERVATION COMMISSION
WELL LOCATION AND ACREAGE DEDICATION PLAT

Form C-102
Supersedes C-128
Effective 1-1-65

All distances must be from the outer boundaries of the Section.

Operator Dr. Sam G. Dunn		Lease Standard - State		Well No. 3
Unit Letter B	Section 5	Township T-8-S	Range R-27-E	County Chaves
Actual Footage Location of Well: 990 feet from the North line and 1650 feet from the East line				
Ground Level Elev:	Producing Formation	Pool Acme SA	Dedicated Acreage: Acres	

1. Outline the acreage dedicated to the subject well by colored pencil or hachure marks on the plat below.
2. If more than one lease is dedicated to the well, outline each and identify the ownership thereof (both as to working interest and royalty).
3. If more than one lease of different ownership is dedicated to the well, have the interests of all owners been consolidated by communitization, unitization, force-pooling, etc?

RECEIVED

☐ Yes ☐ No If answer is "yes," type of consolidation _____

DEC 22 1965
O. C. C.
ARTERIA OFFICE

If answer is "no," list the owners and tract descriptions which have actually been consolidated. (Use reverse side of this form if necessary.) _____

No allowable will be assigned to the well until all interests have been consolidated (by communitization, unitization, forced-pooling, or otherwise) or until a non-standard unit, eliminating such interests, has been approved by the Commission.

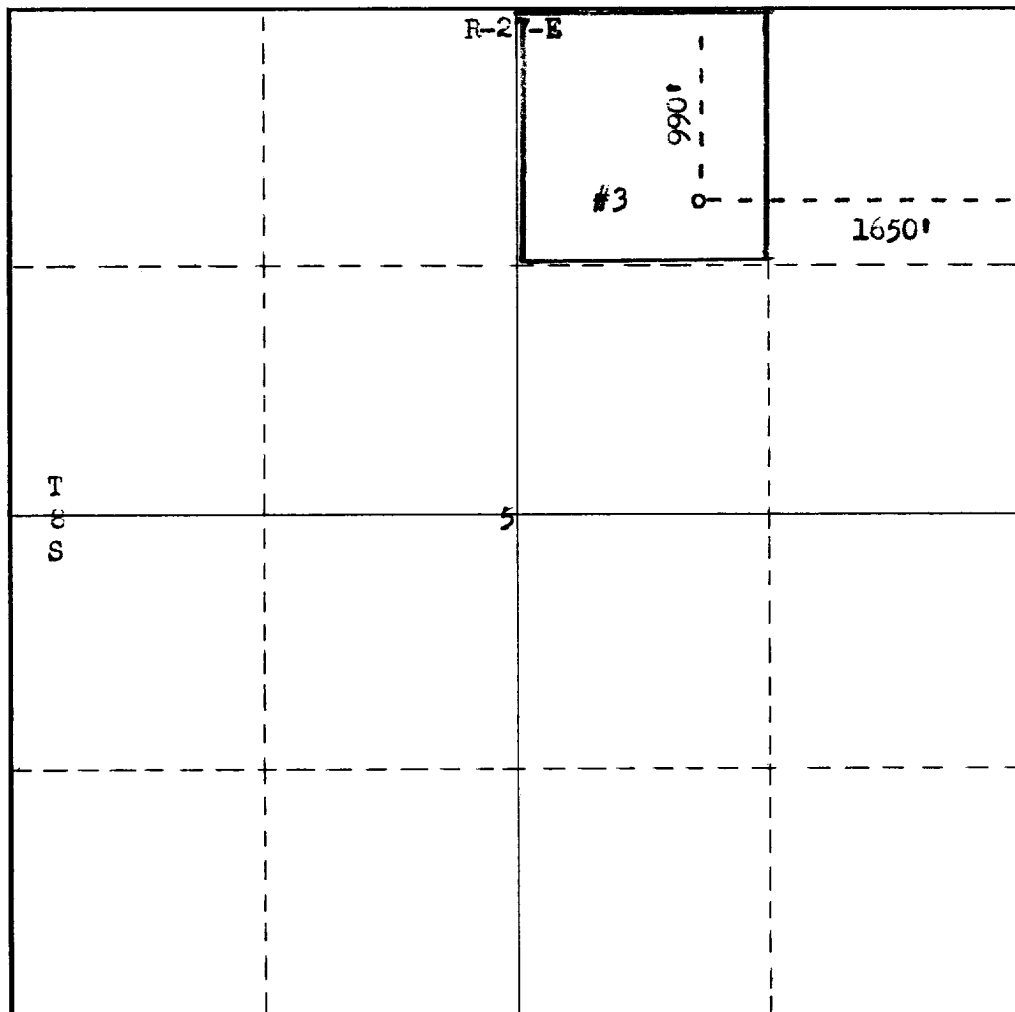

CERTIFICATION

I hereby certify that the information contained herein is true and complete to the best of my knowledge and belief.

Name

Position

Company

Date

I hereby certify that the well location shown on this plat was plotted from field notes of actual surveys made by me or under my supervision, and that the same is true and correct to the best of my knowledge and belief.

Date Surveyed

December 8, 1965

Registered Professional Engineer
and/or Land Surveyor

James H. Luan

Certificate No.

542

0 330 660 990 1320 1650 1980 2310 2640 2000 1500 1000 500 0