

NO. OF COPIES RECEIVED	6
DISTRIBUTION	
SANTA FE	1
FILE	1-
U.S.G.S.	2
LAND OFFICE	
OPERATOR	2

NEW MEXICO OIL CONSERVATION COMMISSION

Form C-101
Revised 1-1-65

5A. Indicate Type of Lease	
STATE <input type="checkbox"/>	FEE <input checked="" type="checkbox"/>
5. State Oil & Gas Lease No.	

APPLICATION FOR PERMIT TO DRILL, DEEPEN, OR PLUG BACK

1a. Type of Work		7. Unit Agreement Name	
b. Type of Well DRILL <input checked="" type="checkbox"/> DEEPEN <input type="checkbox"/> PLUG BACK <input type="checkbox"/> OIL WELL <input checked="" type="checkbox"/> GAS WELL <input type="checkbox"/> OTHER <input type="checkbox"/> SINGLE ZONE <input checked="" type="checkbox"/> MULTIPLE ZONE <input type="checkbox"/>		8. Farm or Lease Name G. F. Bammon, et al	
2. Name of Operator SOUTHERN MINERALS CORPORATION		9. Well No. 1	
3. Address of Operator P.O. Box 716, Corpus Christi, Texas 78403		10. Field and Pool, or Wildcat Wildcat	
4. Location of Well UNIT LETTER P LOCATED 660 FEET FROM THE South LINE AND 660 FEET FROM THE East LINE OF SEC. 15 TWP. 6-3 RGE. 27-E NMPM		12. County Chaves	
19. Proposed Depth 7500		19A. Formation Siluro Devonian	
20. Rotary or C.T. Rotary		21. Elevations (Show whether DF, RT, etc.) 4040.0 Ground	
21A. Kind & Status Plug, Bond Bond on File		21B. Drilling Contractor Upon approval	

PROPOSED CASING AND CEMENT PROGRAM

SIZE OF HOLE	SIZE OF CASING	WEIGHT PER FOOT	SETTING DEPTH	SACKS OF CEMENT	EST. TOP
15"	11-3/4" OD	42#	200'	150	Back to Surface
11"	8-5/8" OD	24#	1200'	350	Back to Surface
7-7/8"	4-1/2" OD	10.50#	7500'	250	6500 Feet

APPROVAL VALID
FOR 90 DAYS UNLESS
DRILLING COMMENCED
EXPIRES 8-23-66

RECEIVED

MAY 26 1966

NEW MEXICO
LAND OFFICE

IN ABOVE SPACE DESCRIBE PROPOSED PROGRAM: IF PROPOSAL IS TO DEEPEN OR PLUG BACK, GIVE DATA ON PRESENT PRODUCTIVE ZONE AND PROPOSED NEW PRODUCTIVE ZONE. GIVE BLOWOUT PREVENTER PROGRAM, IF ANY.

I hereby certify that the information above is true and complete to the best of my knowledge and belief.

Signed _____ Title **Vice President** Date **May 24, 1966**

(This space for State Use)

APPROVED BY ML Armstrong TITLE SEC. DEPT. OF LAND DATE **MAY 26 1966**

CONDITIONS OF APPROVAL, IF ANY:

N MEXICO OIL CONSERVATION COMMISS
WELL LOCATION AND ACREAGE DEDICATION PLAT

Form C-102
Supersedes C-128
Effective 1-1-65

All distances must be from the outer boundaries of the Section.

Operator SOUTHERN MINERALS CORPORATION		Lease G. F. Bannon, et al		Well No. 1
Unit Letter P	Section 15	Township 6-S	Range 27-E	County Chaves
Actual Footage Location of Well: 660 feet from the South line and 660 feet from the East line				
Ground Level Elev. 4040.0	Producing Formation Siluro Devonian	Pool Wildcat	Dedicated Acreage: 40 Acres	

1. Outline the acreage dedicated to the subject well by colored pencil or hachure marks on the plat below.
2. If more than one lease is dedicated to the well, outline each and identify the ownership thereof (both as to working interest and royalty).
3. If more than one lease of different ownership is dedicated to the well, have the interests **RECEIVED** been consolidated by communitization, unitization, force-pooling, etc?

☐ Yes ☐ No If answer is "yes," type of consolidation MA 10 2 1966

If answer is "no," list the owners and tract descriptions which have actually been consolidated. (Use reverse side of this form if necessary.) _____

No allowable will be assigned to the well until all interests have been consolidated (by communitization, unitization, forced-pooling, or otherwise) or until a non-standard unit, eliminating such interests, has been approved by the Commission.

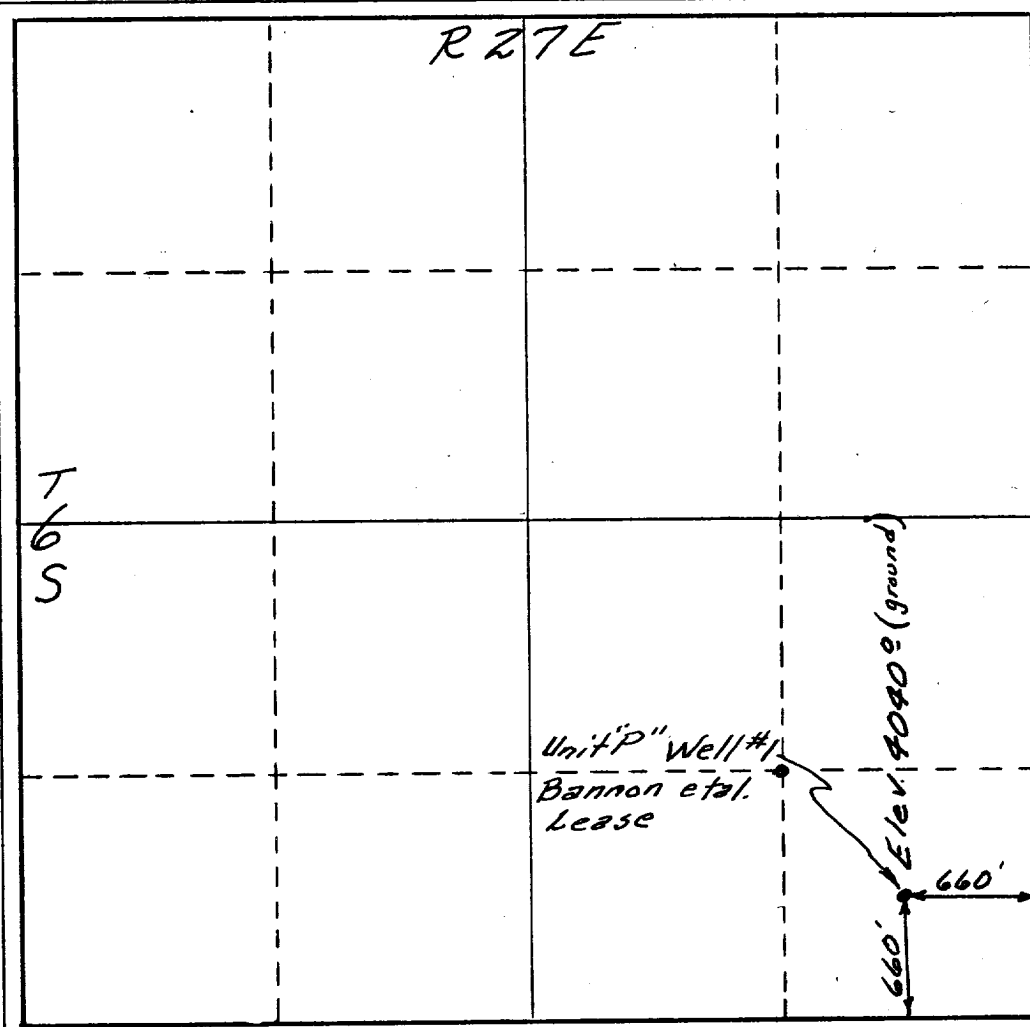

CERTIFICATION

I hereby certify that the information contained herein is true and complete to the best of my knowledge and belief.

Name
J. H. Winters
Position
Vice President

Company
SOUTHERN MINERALS CORPORATION

Date
May 24, 1966

I hereby certify that the well location shown on this plat was plotted from field notes of actual surveys made by me or under my supervision, and that the same is true and correct to the best of my knowledge and belief.

May 19, 1966
Date Surveyed
Charles J. O'Meara Jr
Registered Professional Engineer
and/or Land Surveyor

LS # 3954 N.M.
Certificate No.