

NEW MEXICO OIL CONSERVATION COMMISSION
WELL LOCATION AND ACREAGE DEDICATION PLAT

Form C-102
Supersedes C-128
Effective 1-1-65

All distances must be from the outer boundaries of the Section.

Operator Shenandoah Oil Company			Lease Federal		Well No. 1
Unit Letter A	Section 9	Township 14S	Range 28E	County Chaves	
Actual Footage Location of Well: 660 feet from the North line and 660 feet from the East line					
Ground Level Elev. 3586	Producing Formation San Andres		Pool Wildcat		Dedicated Acreage: 80 Acres

1. Outline the acreage dedicated to the subject well by colored pencil or hachure marks on the plat below.

2. If more than one lease is dedicated to the well, outline each and identify the ownership thereof (both as to working interest and royalty).

3. If more than one lease of different ownership is dedicated to the well, have the interests of all owners been consolidated by communitization, unitization, force-pooling, etc?

RECEIVED

DEC 27 1966

☐ Yes ☐ No If answer is "yes," type of consolidation **One Lease Only**

If answer is "no," list the owners and tract descriptions which have actually been consolidated. (Use reverse side of this form if necessary.)

No allowable will be assigned to the well until all interests have been consolidated (by communitization, unitization, forced-pooling, or otherwise) or until a non-standard unit, eliminating such interests, has been approved by the Commission.

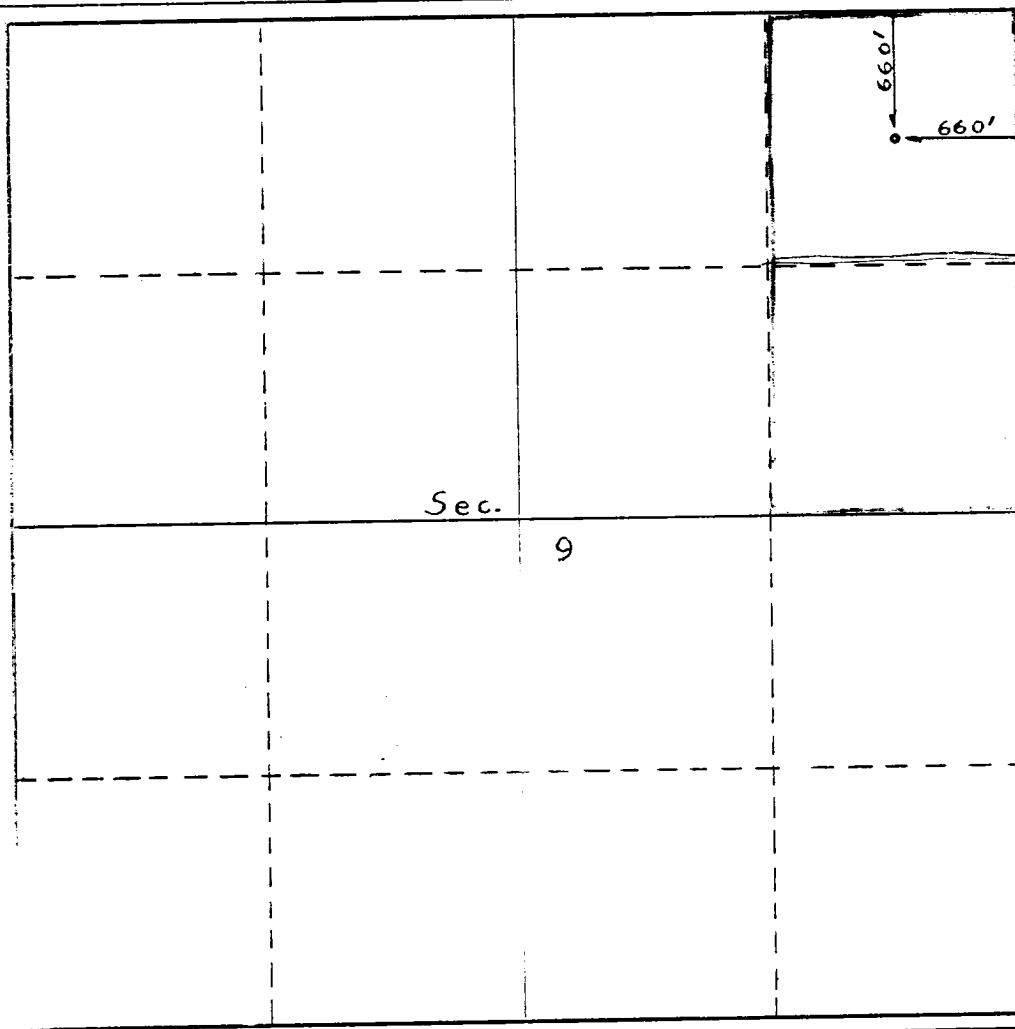

CERTIFICATION

I hereby certify that the information contained herein is true and complete to the best of my knowledge and belief.

Harold E. Burke
Harold E. Burke

Name

Production Superintendent
Position

Shenandoah Oil Corp.
Company

December 20, 1966
Date

I hereby certify that the well location shown on this plat was plotted from field notes of actual surveys made by me or under my supervision, and that the same is true and correct to the best of my knowledge and belief.

Surveyed
December 13, 1966

Registered Professional Engineer
and/or Land Surveyor

Fred B. Kerr Jr.

Fred B. Kerr Jr.
Certificate No.
3950

330 660 990 1320 1650 1980 2310 2640 2000 1500 1000 500 0