

NO. OF COPIES RECEIVED	6
DISTRIBUTION	
SANTA FE	1
FILE	1
U.S.G.S.	2
LAND OFFICE	1
OPERATOR	1

NEW MEXICO OIL CONSERVATION COMMISSION

30-005-60010
Form C-101
Revised 1-1-65

5A. Indicate Type of Lease	STATE <input checked="" type="checkbox"/>	FEE <input type="checkbox"/>
5. State Oil & Gas Lease No.	K-2803	

APPLICATION FOR PERMIT TO DRILL, DEEPEN, OR PLUG BACK

1a. Type of Work		7. Unit Agreement Name	
b. Type of Well		8. Farm or Lease Name	
DRILL <input checked="" type="checkbox"/> DEEPEN <input type="checkbox"/> PLUG BACK <input type="checkbox"/>		Citgo State	
OIL WELL <input checked="" type="checkbox"/> GAS WELL <input type="checkbox"/> OTHER <input type="checkbox"/>		9. Well No.	
2. Name of Operator		10. Field and Pool, or Wildcat	
H. N. Sweeney		Undesignated Twin	
3. Address of Operator		12. County	
P. O. Box 1582, Roswell, N. M.		Harris	
4. Location of Well		19. Proposed Depth	
UNIT LETTER <u>P</u> LOCATED <u>660</u> FEET FROM THE <u>South</u> LINE		2750'	
AND <u>660</u> FEET FROM THE <u>East</u> LINE OF SEC. <u>36</u> TWP. <u>8 S.</u> RGE. <u>28 E.</u> NMPM		19A. Formation	
		San Andres	
21. Elevations (Show whether DF, RT, etc.)		20. Rotary or C.T.	
3983' GR		Rotary	
21A. Kind & Status Plug. Bond		22. Approx. Date Work Will start	
Blanket		2/14/67	
21B. Drilling Contractor			
Eldorado Drilling, Inc.			

23.

PROPOSED CASING AND CEMENT PROGRAM

SIZE OF HOLE	SIZE OF CASING	WEIGHT PER FOOT	SETTING DEPTH	SACKS OF CEMENT	EST. TOP
11"	8-5/8"	28#	960'	160	base Yates sd.
7-7/8"	5-1/2"	14#	2750'	100	top por. 2650

Plan to drill with air below surface casing. If oil in commercial quantities is encountered, plan to set production string on top of pay with packer shoe and to complete in open hole.

RECEIVED

APPROVAL VALID
FOR 90 DAYS UNLESS
DRILLING COMMENCED,
EXPIRES 5-16-67

FEB 14 1967

O. C. G.
ARTERIAL OFFICE

IN ABOVE SPACE DESCRIBE PROPOSED PROGRAM: IF PROPOSAL IS TO DEEPEN OR PLUG BACK, GIVE DATA ON PRESENT PRODUCTIVE ZONE AND PROPOSED NEW PRODUCTIVE ZONE. GIVE BLOWOUT PREVENTER PROGRAM, IF ANY.

I hereby certify that the information above is true and complete to the best of my knowledge and belief.

Signed H. N. Sweeney Title H. N. Sweeney, Operator Date 2/13/67

(This space for State Use)

APPROVED BY W. A. Gussert TITLE ADJUTANT GENERAL DATE FEB 13 1967

CONDITIONS OF APPROVAL, IF ANY:

Sufficient cement must be used behind the surface casing to protect all shallow water zones

MEXICO OIL CONSERVATION COMMISSION
WELL LOCATION AND ACREAGE DEDICATION PLAT

Form C-102
Supersedes C-128
Effective 1-1-65

All distances must be from the outer boundaries of the Section.

Operator <i>H. N. Sweeney</i>		Lease <i>Oil, O-State</i>		Well No. <i>1</i>	
Unit Letter <i>P</i>	Section <i>36</i>	Township <i>8 South</i>	Range <i>28 East</i>	County <i>Chaves</i>	
Actual Footage Location of Well: <i>660</i> feet from the <i>South</i> line and <i>660</i> feet from the <i>West</i> line					
Ground Level Elev. <i>3500</i>	Producing Formation <i>SA</i>	Pool <i>Undesignated Twin Lakes</i>		Dedicated Acreage: <i>40</i> Acres	

1. Outline the acreage dedicated to the subject well by colored pencil or hachure marks on the plat below.
2. If more than one lease is dedicated to the well, outline each and identify the ownership thereof (both as to working interest and royalty).
3. If more than one lease of different ownership is dedicated to the well, have the interests of all owners been consolidated by communitization, unitization, force-pooling, etc?

☐ Yes ☐ No If answer is "yes," type of consolidation _____

If answer is "no," list the owners and tract descriptions which have actually been consolidated. (Use reverse side of this form if necessary.) _____

No allowable will be assigned to the well until all interests have been consolidated (by communitization, unitization, forced-pooling, or otherwise) or until a non-standard unit, eliminating such interests, has been approved by the Commission.

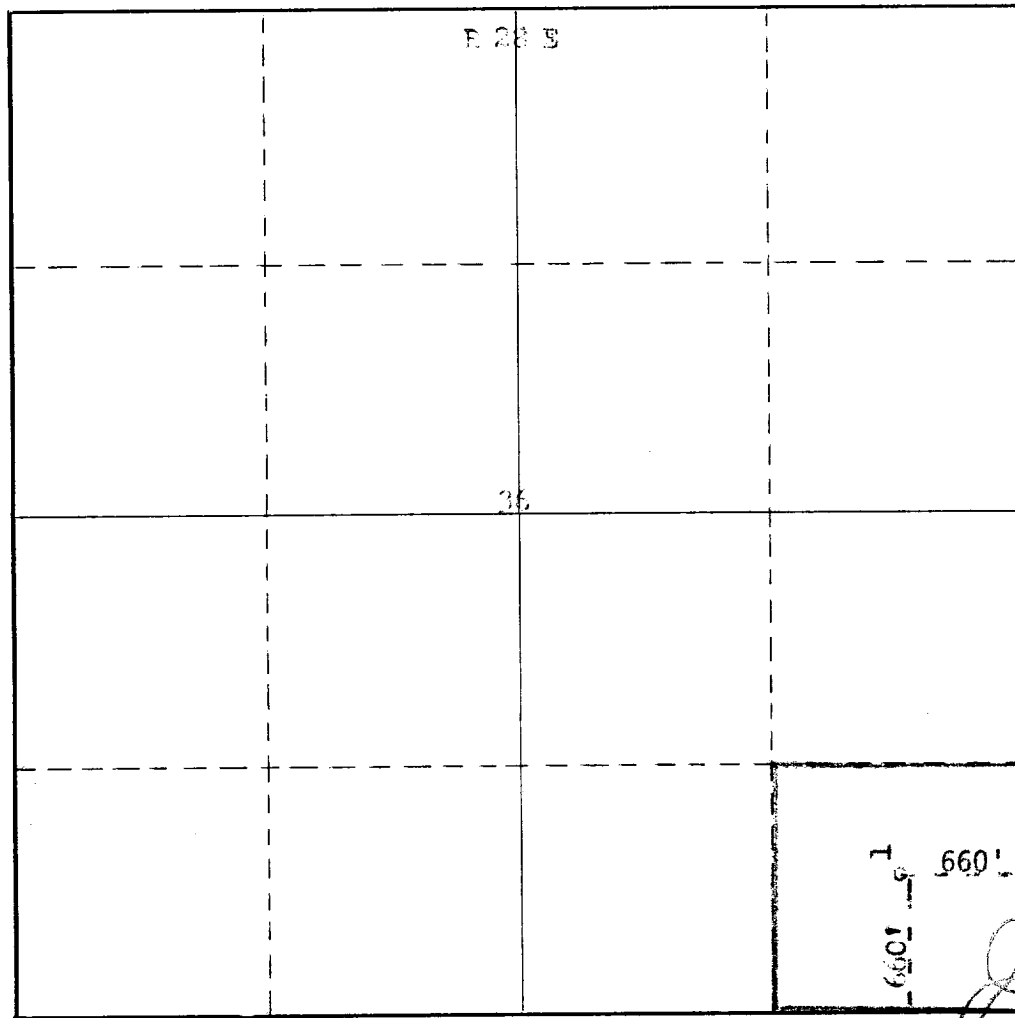

CERTIFICATION

I hereby certify that the information contained herein is true and complete to the best of my knowledge and belief.

H. N. Sweeney
Name

Operator

Position

H. N. Sweeney
Company

Date

Feb. 13, 1967

Date

I hereby certify that the well location shown on this plat was plotted from field notes of actual surveys made by me or under my supervision, and that the same is true and correct to the best of my knowledge and belief.

Date Surveyed

Feb. 13, 1967
Registered Professional Engineer and/or Land Surveyor

James H. Brown
Certificate No.

E.M.L.S. No. 542