

NO. OF COPIES RECEIVED	6
DISTRIBUTION	
SANTA FE	1
FILE	1
U.S.G.S.	2
LAND OFFICE	1
OPERATOR	1

RECEIVED
NEW MEXICO OIL CONSERVATION COMMISSION

OCT 31 1977

O. C. C.
ARTEBIA, OFFICE

30-005-60010
Form C-101
Revised 1-1-65

5A. Indicate Type of Lease	
STATE <input checked="" type="checkbox"/>	FEE <input type="checkbox"/>
5. State Oil & Gas Lease No.	
K-2803	

APPLICATION FOR PERMIT TO DRILL, DEEPEN, OR PLUG BACK

1a. Type of Work		7. Unit Agreement Name	
b. Type of Well		8. Farm or Lease Name	
OIL WELL <input checked="" type="checkbox"/>	GAS WELL <input type="checkbox"/>	Citgo - State	
OTHER <input type="checkbox"/>		9. Well No.	
2. Name of Operator		3	
Stevens Oil Company		10. Field and Pool, or Wildcat	
3. Address of Operator		Twin Lakes San Andres	
P.O. Box 1797, Santa Fe, New Mexico 87501		12. County	
4. Location of Well		Chaves	
UNIT LETTER <u>P</u> LOCATED <u>660</u> FEET FROM THE <u>South</u> LINE			
AND <u>660</u> FEET FROM THE <u>East</u> LINE OF SEC. <u>36</u> TWP. <u>8S</u> RGE. <u>28E</u> NMPM			
19. Proposed Depth		19A. Formation	
2660		San Andres	
20. Rotary or C.T.		Rotary	
21. Elevations (Show whether DE, RT, etc.)		22. Approx. Date Work will start	
3983 G. L.		11-1-77	
21A. Kind & Status Plug. Bond		21B. Drilling Contractor	
Blanket		Stevens Oil Company	

23.

PROPOSED CASING AND CEMENT PROGRAM

SIZE OF HOLE	SIZE OF CASING	WEIGHT PER FOOT	SETTING DEPTH	SACKS OF CEMENT	EST. TOP
11"	8-5/8	28#	955'	200	297'
7-7/8"	4-1/2	9.5#	2660'	200	2020'

Originally P & A by H. N. Sweeney on 3/11/67 at T. D. 2730' and Donald G. Stevens on January 7, 1974, as the Citgo - State No. 1. Proposed to re-enter, run 2-3/8" tubing to 2610' with retainer, wash perfs with 500 gallons mud acid and test for completion.

APPROVAL VALID
FOR 90 DAYS UNLESS
DRILLING COMMENCED,
EXPIRES 2-1-78

IN ABOVE SPACE DESCRIBE PROPOSED PROGRAM: IF PROPOSAL IS TO DEEPEN OR PLUG BACK, GIVE DATA ON PRESENT PRODUCTIVE ZONE AND PROPOSED NEW PRODUCTIVE ZONE. GIVE BLOWOUT PREVENTER PROGRAM, IF ANY.

I hereby certify that the information above is true and complete to the best of my knowledge and belief.

Signed Donald G. Stevens Title Owner Date 10-28-77

(This space for State Use)

APPROVED BY W. A. Gressett TITLE SUPERVISOR, DISTRICT II DATE NOV 1 1977

CONDITIONS OF APPROVAL, IF ANY:

run 4 1/2" to 1600' tie back into old 4 1/2" casing

NEW MEXICO OIL CONSERVATION COMMISSION
WELL LOCATION AND ACREAGE DEDICATION PLAT

Form C-102
Supersedes C-128
Effective 1-1-65

All distances must be from the outer boundaries of the Section.

Operator Stevens Oil Company		Lease Citgo-State		Well No. 3
Unit Letter P	Section 36	Township 8 South	Range 28 East	County Chaves
Actual Footage Location of Well: 660 feet from the South line and 660 feet from the East line				
Ground Level Elev. 3983	Producing Formation San Andres	Pool Twin Lakes - San Andres	Dedicated Acreage: 40 Acres	

1. Outline the acreage dedicated to the subject well by colored pencil or hachure marks on the plat below.
2. If more than one lease is dedicated to the well, outline each and identify the ownership thereof (both as to working interest and royalty).
3. If more than one lease of different ownership is dedicated to the well, have the interests of all owners been consolidated by communitization, unitization, force-pooling, etc?

☐ Yes ☐ No If answer is "yes:" type of consolidation _____

If answer is "no," list the owners and tract descriptions which have actually been consolidated. (Use reverse side of this form if necessary.) _____

No allowable will be assigned to the well until all interests have been consolidated (by communitization, unitization, forced-pooling, or otherwise) or until a non-standard unit, eliminating such interests, has been approved by the Commission.

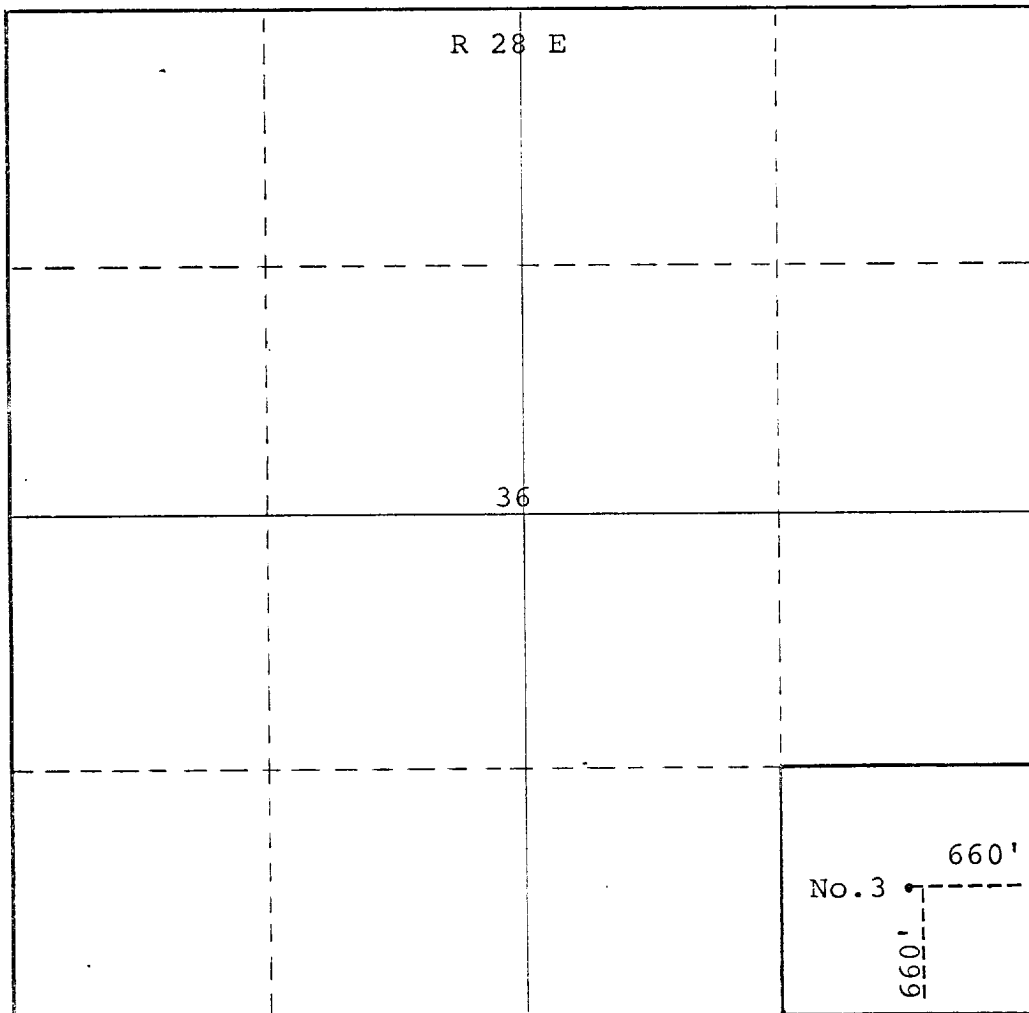

CERTIFICATION

I hereby certify that the information contained herein is true and complete to the best of my knowledge and belief.

Name

Owner

Position

Stevens Oil Company

Company

10-28-77

Date

I hereby certify that the well location shown on this plat was plotted from field notes of actual surveys made by me or under my supervision, and that the same is true and correct to the best of my knowledge and belief.

Date Surveyed

February 7, 1967

Registered Professional Engineer
and/or Land Surveyor

James H. Brown

Certificate No.

N.M.L.S. No. 542