

UNITED STATES  
DEPARTMENT OF THE INTERIOR  
GEOLOGICAL SURVEY

30-005-60022

5. LEASE DESIGNATION AND SERIAL NO.

NM-10593

6. IF INDIAN, ALLOTTEE OR TRIBE NAME

7. UNIT AGREEMENT NAME

8. FARM OR LEASE NAME

Chisum Federal

9. WELL NO.

10. FIELD AND POOL, OR WILDCAT

Chisum SA

11. SEC., T., R., M., OR BLK.  
AND SURVEY OR AREA

Section 24-11S-27E

12. COUNTY OR PARISH

13. STATE

## APPLICATION FOR PERMIT TO DRILL, DEEPEN, OR PLUG BACK

1a. TYPE OF WORK

RE-DRILL ☐DEEPEN ☐PLUG BACK ☐

b. TYPE OF WELL

OIL  
WELL ☒GAS  
WELL ☐

OTHER Re-Drill

SINGLE  
ZONE ☐MULTIPLE  
ZONE ☐

2. NAME OF OPERATOR

Fi-Ro Corporation

3. ADDRESS OF OPERATOR

P.O. Box 315 Natchez, Ms. 39120

4. LOCATION OF WELL (Report location clearly and in accordance with any State requirements.)

At surface

330 ft FNL &amp; 2310 ft FNL Section 24 T-11S-R-27E

14. DISTANCE IN MILES AND DIRECTION FROM NEAREST TOWN OR POST OFFICE\*

Approx. 24 Miles east of Roswell NM

15. DISTANCE FROM PROPOSED

LOCATION TO NEAREST  
PROPERTY OR LEASE LINE, FT.  
(Also to nearest drlg. unit line, if any)

330

16. NO. OF ACRES IN LEASE

1040

17. NO. OF ACRES ASSIGNED  
TO THIS WELL

40

18. DISTANCE FROM PROPOSED LOCATION\*

TO NEAREST WELL, DRILLING, COMPLETED,  
OR APPLIED FOR, ON THIS LEASE, FT.

0

19. PROPOSED DEPTH

2070

20. ROTARY OR CABLE TOOLS

Cable tools

21. ELEVATIONS (Show whether DF, RT, GR, etc.)

3747 Gr

23.

Existing

RECORDED CASING AND CEMENTING

RECORD

SIZE OF HOLE	SIZE OF CASING	WEIGHT PER FOOT	SETTING DEPTH	QUANTITY OF CEMENT
	8 1/8	24	460	100 sks reg W/2% CACI
	5 1/2	15.50	2460	125 sks

Formerly Franklin Astors Fair Inc, RA 1967

On receipt of permit we plan to begin re-entry operations on this well

We plan to clean out to 2070 ff and swab or pump test the Slaughter zone of the San Anders formation

5 1/2" Control valve will be used until well Head is installed. will use existing pad + Road, No Construction Material will be used, will Reopen pit 8'x20'x6'deep - scotch 'A'

Water will be purchased From Nearest commercial source  
Plan to Drill out well to 2070 + attempt to Complete in old perforation From 2014 to 2046, will Re-Perforate if Necessary.

IN ABOVE SPACE DESCRIBE PROPOSED PROGRAM: If proposal is to deepen or plug back, give data on present productive zone and proposed new productive zone. If proposal is to drill or deepen directionally, give pertinent data on subsurface locations and measured and true vertical depths. Give blowout preventer program, if any.

24.

SIGNED

*Emory M. Webb*

TITLE President

DATE April 12 1979

(This space for Federal or State office use)

PERMIT NO.

APPROVAL DATE

APR 19 1979

APPROVED BY

*Joe M. Lara*

TITLE

ACTING DISTRICT ENGINEER

DATE

APR 19 1979

CONDITIONS OF APPROVAL, IF ANY:

*Post to Re-entry  
APR 1 27 79*

Form C-102  
Supersedes C-128  
Effective 1-1-65

Operator <i>Fi Ro Corporation</i>		Lease <i>Chisum Federal</i>		Well No. <i>1</i>
Unit Letter <i>C</i>	Section <i>24</i>	Township <i>11 S</i>	Range <i>27 E</i>	County <i>Chaves</i>
Actual Footage Location of Well: <i>2310</i> feet from the <i>West</i> line and <i>330</i> feet from the <i>North</i> line				
Ground Level Elev. <i>3747</i>	Producing Formation <i>SAN ANDERS</i>		Pool	Dedicated Acreage: <i>40</i> Acres

- No allowable will be assigned to the well until all interests have been consolidated (by communitization, unitization, forced-pooling, or otherwise) or until a non-standard unit, eliminating such interests, has been approved by the Commission.

2310	330	R27E	
		24	
T11S			

Certificate No.

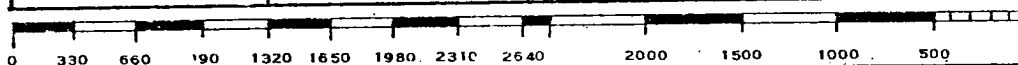

# Fi-Ro Corporation

Machine & Welding Works

P. O. BOX 315

NATCHEZ, MISSISSIPPI 39120

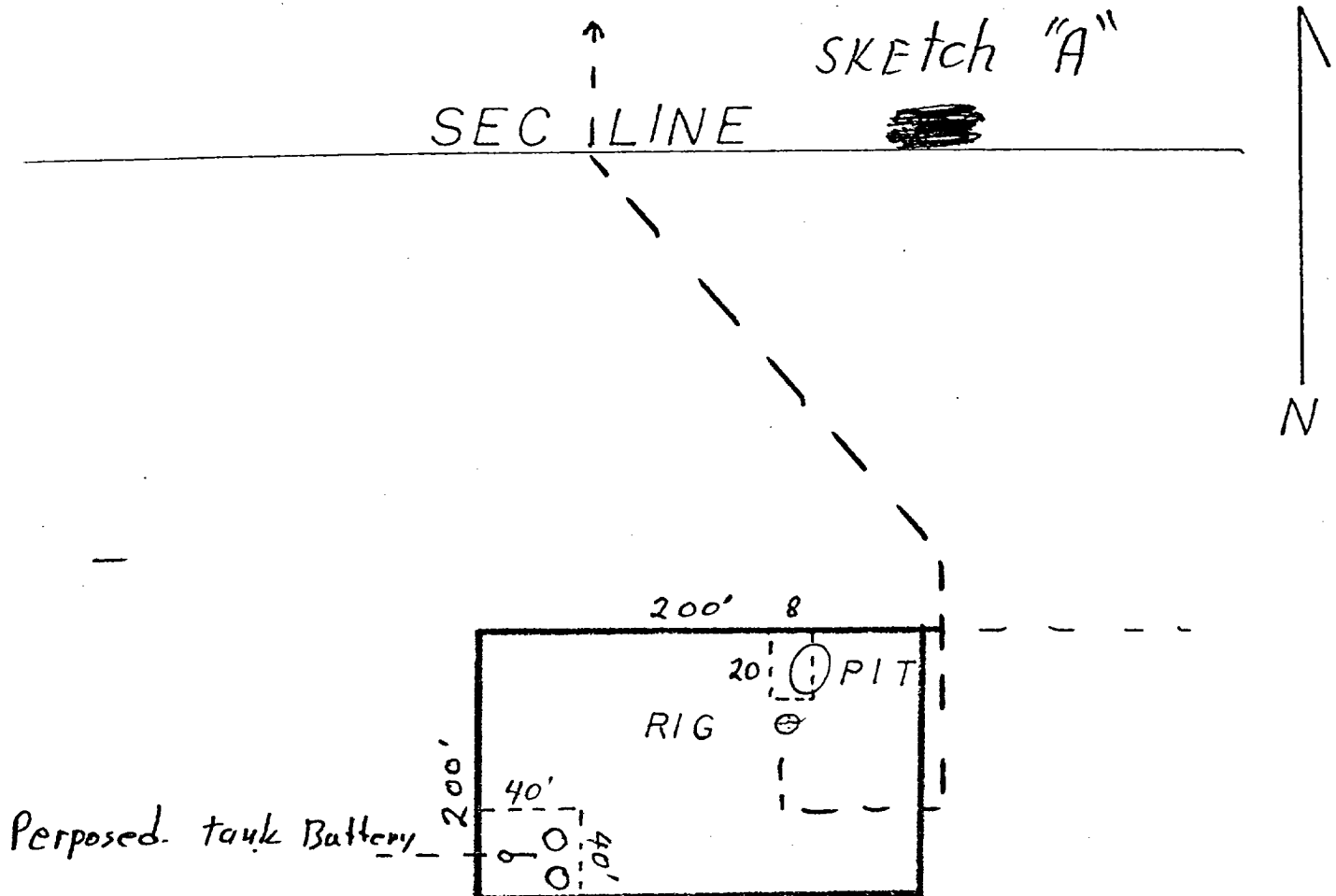

5 1/2 control valve will be used until well head is installed on casing.

NO Ground will be used that was NOT used in the original Drilling by F.A.F INC.

# Fi-Ro Corporation

Machine & Welding Works

P. O. BOX 315

NATCHEZ, MISSISSIPPI 39120

April 12/79

Fi-ro Corporation - Chisum-Federal No.1  
entrance to well site will be the old road used by Franklin,  
aston & Fair Inc. when originally drilled.  
The rig will be on the west of the well and pit on the north  
which will not distrub any ground not used in the original  
drilling. The approx. road is marked in red.

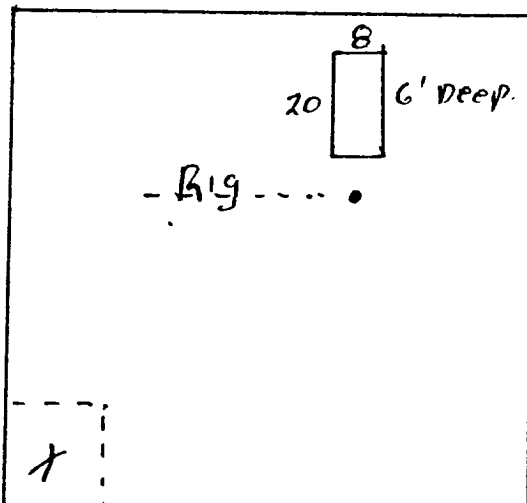
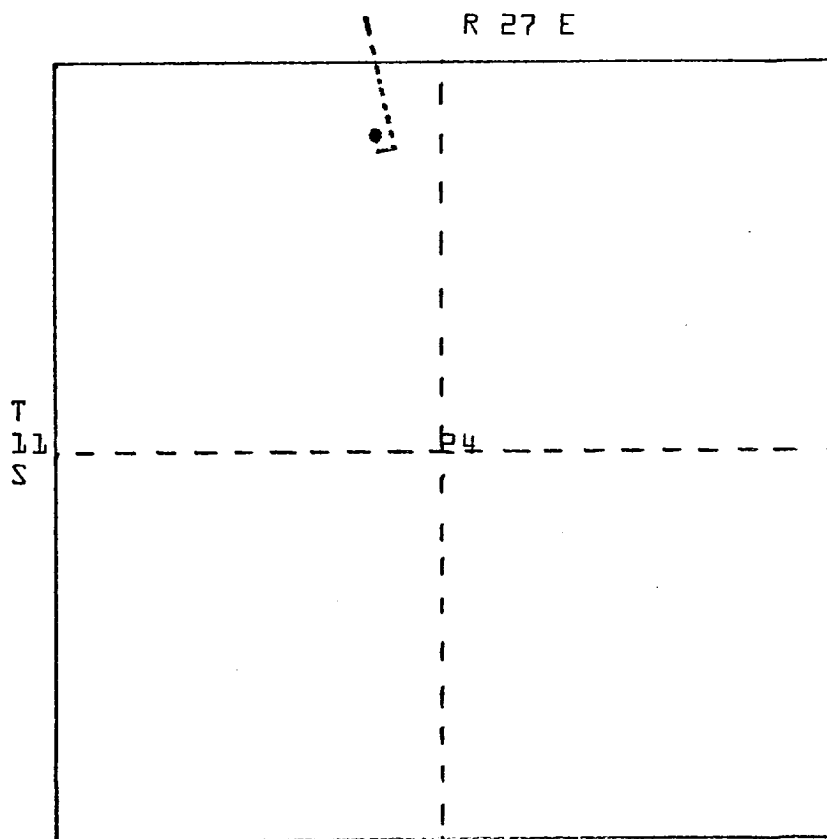

## Fi-Ro Corporation

Machine & Welding Works

P. O. BOX 315

NATCHEZ, MISSISSIPPI 39120

March 26, 1979

Slash G Cattle Company  
P O Box 877  
Roswell, N M 88201

Elmer and Jane Garnsey

Re: Chaves Co, New Mexico  
T 11 S R 27 E  
Sec. 24, 23, 25, 26, ~~27~~  
and ~~28~~

*11 S R 27 E*  
*Sec. 24, 23, 25, 26, 27*

As per our telephone conversation regarding location and road cost, it is my understanding that you wish us to use all existing roads and to make the smallest amount of new road possible. The route will be agreed upon by both yourselves and Tommy McDonald.

The price for each location is \$500.00 and \$300.00 per mile of new road used. We also assure you that the locations and roads will be kept clean of trash and pits will be fenced to keep cattle out.

If this meets with your approval, please sign and return 1 copy to Fi-Ro Corporation, Natchez, Miss.

Slash G Cattle Company

*Elmer E. Garnsey*  
Elmer Garnsey

Fi-Ro Corporation

*Tommy McDonald*  
Tommy McDonald, Pres.