

NO. OF COPIES RECEIVED	6
DISTRIBUTION	
SANTA FE	
FILE	
U.S.G.S.	
LAND OFFICE	
OPERATOR	

NEW MEXICO OIL CONSERVATION COMMISSION

30-005-60039

Form C-101
Revised 1-4-65

5A. Indicate Type of Lease STATE <input checked="" type="checkbox"/> FEE <input type="checkbox"/>
5. State Oil & Gas Lease No. OG 4681
7. Unit Agreement Name
8. Farm or Lease Name Citgo A State
9. Well No. 5
10. Field and Pool, or Wildcat Twin Lakes S. A.
12. County Chaves
19. Proposed Depth 2610'
19A. Formation San Andres
20. Rotary or C.T. Rotary
21. Elevations (Show whether DF, RT, etc.) 3951 GR
21A. Kind & Status Plug. Bond Blanket
21B. Drilling Contractor Eldorado Drilling Co.
22. Approx. Date Work will start January 25, 1968

APPLICATION FOR PERMIT TO DRILL, DEEPEN, OR PLUG BACK	
1a. Type of Work b. Type of Well OIL WELL <input checked="" type="checkbox"/> GAS WELL <input type="checkbox"/> OTHER <input type="checkbox"/> DRILL <input checked="" type="checkbox"/> DEEPEN <input type="checkbox"/> PLUG BACK <input type="checkbox"/> SINGLE ZONE <input type="checkbox"/> MULTIPLE ZONE <input type="checkbox"/>	2. Name of Operator Twinlakes Oil Company
3. Address of Operator P. O. Box 1582, Roswell, New Mexico 88201	4. Location of Well UNIT LETTER C LOCATED 990 FEET FROM THE North LINE AND 1650 FEET FROM THE West LINE OF SEC. 36 TWP. 8S RGE. 28E NMPM
23. PROPOSED CASING AND CEMENT PROGRAM	

SIZE OF HOLE	SIZE OF CASING	WEIGHT PER FOOT	SETTING DEPTH	SACKS OF CEMENT	EST. TOP
11"	8-5/8"	23#	325'	125 sx.	Surface
6-3/4"	4-1/2"	9.6#	2600'	50 sx.	2000'

Will drill with mud to total depth. Will run casing, log and perforate producing interval if any.

APPROVAL VALID
FOR 90 DAYS UNLESS
DRILLING COMMENCED,

EXPIRES 4-24-68

RECEIVED

JAN 26 1968

D. C. C.
ARTESIA, OFFICE

IN ABOVE SPACE DESCRIBE PROPOSED PROGRAM: IF PROPOSAL IS TO DEEPEN OR PLUG BACK, GIVE DATA ON PRESENT PRODUCTIVE ZONE AND PROPOSED NEW PRODUCTIVE ZONE. GIVE BLOWOUT PREVENTER PROGRAM, IF ANY.

I hereby certify that the information above is true and complete to the best of my knowledge and belief.

Signed H. M. Foreman Title Vice President Date January 24, 1968

(This space for State Use)

APPROVED BY W. A. Gressett TITLE OIL AND GAS DATE JAN 26 1968

CONDITIONS OF APPROVAL, IF ANY:

NEW MEXICO OIL CONSERVATION COMMISSION
WELL LOCATION AND ACREAGE DEDICATION PLAT

Form C-102
Supersedes C-128
Effective 1-1-65

All distances must be from the outer boundaries of the Section.

Operator TWINLAKES OIL COMPANY			Lease CITGO STATE 1A		Well No. 5
Tract Letter C	Section 36	Township 8 SOUTH	Range 28 EAST	County CHAVES	
Actual Footage Location of Well: 990 feet from the NORTH line and 1650 feet from the WEST line					
Ground Level Elev. 3951 GR	Producing Formation SAN ANDRES		Pool TWIN LAKES	Dedicated Acreage 40 Acres	

1. Outline the acreage dedicated to the subject well by colored pencil or hatchure marks on the plat below.
2. If more than one lease is dedicated to the well, outline each and identify the ownership thereof (both as to working interest and royalty).
3. If more than one lease of different ownership is dedicated to the well, have the interests of all owners been consolidated by communitization, unitization, force-pooling, etc? **RECEIVED**

☐ Yes ☐ No If answer is "yes," type of consolidation _____

JAN 26 1968

If answer is "no," list the owners and tract descriptions which have actually been consolidated. (Use reverse side of this form if necessary.) _____

No allowable will be assigned to the well until all interests have been consolidated (by communitization, unitization, forced-pooling, or otherwise) or until a non-standard unit, eliminating such interests, has been approved by the Commission.

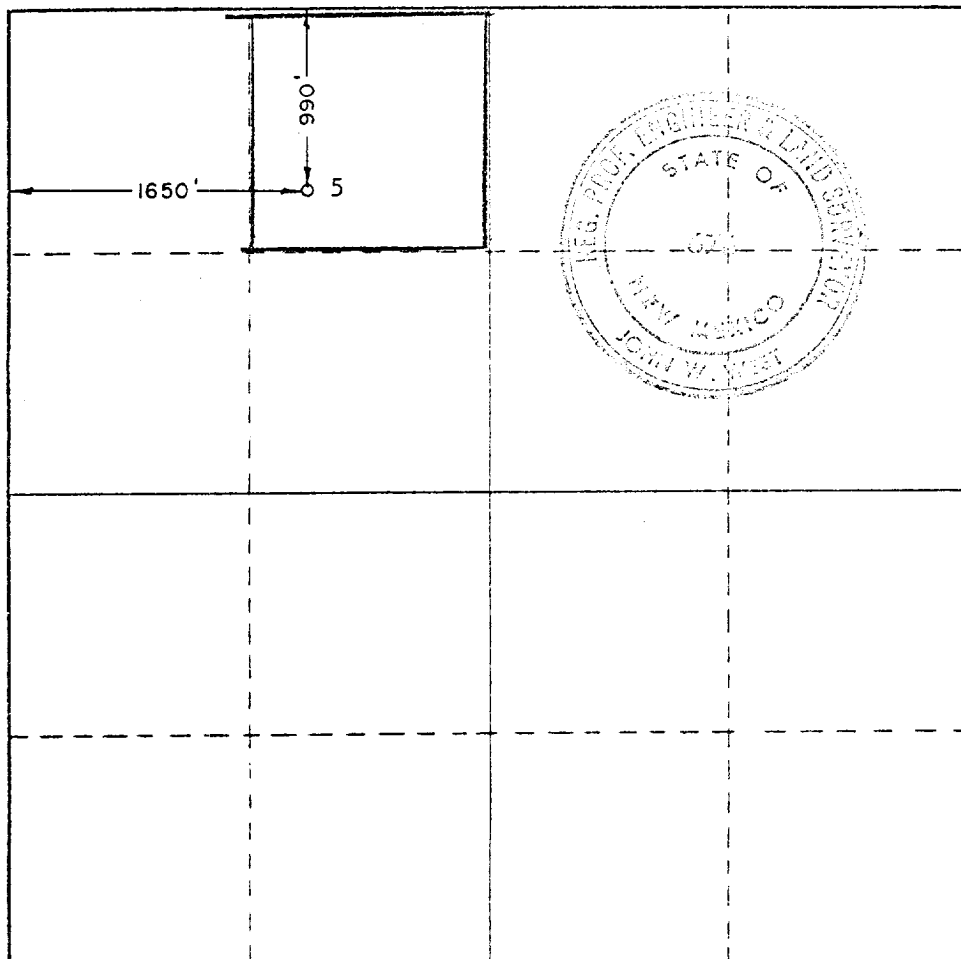

CERTIFICATION

I hereby certify that the information contained herein is true and complete to the best of my knowledge and belief.

H. N. Sweeney
Name
H. N. Sweeney
Position
Vice President
Company
Twinlakes Oil Company
Date
January 24, 1968

I hereby certify that the well location shown on this plat was plotted from field notes of actual surveys made by me or under my supervision, and that the same is true and correct to the best of my knowledge and belief.

Date Surveyed
JANUARY 19, 1968
Registered Professional Engineer
and/or Land Surveyor

John W. West
Signature
676