

RECEIVED

JAN 13 1971

NEW MEXICO OIL CONSERVATION COMMISSION
WELL LOCATION AND ACREAGE DEDICATION PLATForm C-102
Supersedes C-128
Effective 1-1-65

All distances must be from the outer boundaries of the Section.

Operator ARTESIA, OFFICE MERCURY PRODUCTION COMPANY			Lease Mercury State		Well No. 1
Unit Letter E	Section 27	Township 10S	Range 26E	County Chaves	
Actual Footage Location of Well: 1980 feet from the North line and 660 feet from the West line					
Ground Level Elev. 3666	Producing Formation Cisco		Pool Wildcat		Dedicated Acreage: 320 Acres

1. Outline the acreage dedicated to the subject well by colored pencil or hachure marks on the plat below.
2. If more than one lease is dedicated to the well, outline each and identify the ownership thereof (both as to working interest and royalty). **Descriptions on back of form.**
3. If more than one lease of different ownership is dedicated to the well, have the interests of all owners been consolidated by communitization, unitization, force-pooling, etc?

☐ Yes ☒ No If answer is "yes," type of consolidation _____

If answer is "no," list the owners and tract descriptions which have actually been consolidated. (Use reverse side of this form if necessary.) **All working interest common, royalty and ORRI will be communitized**

No allowable will be assigned to the well until all interests have been consolidated (by communitization, unitization, forced-pooling, or otherwise) or until a non-standard unit, eliminating such interests, has been approved by the Commission.

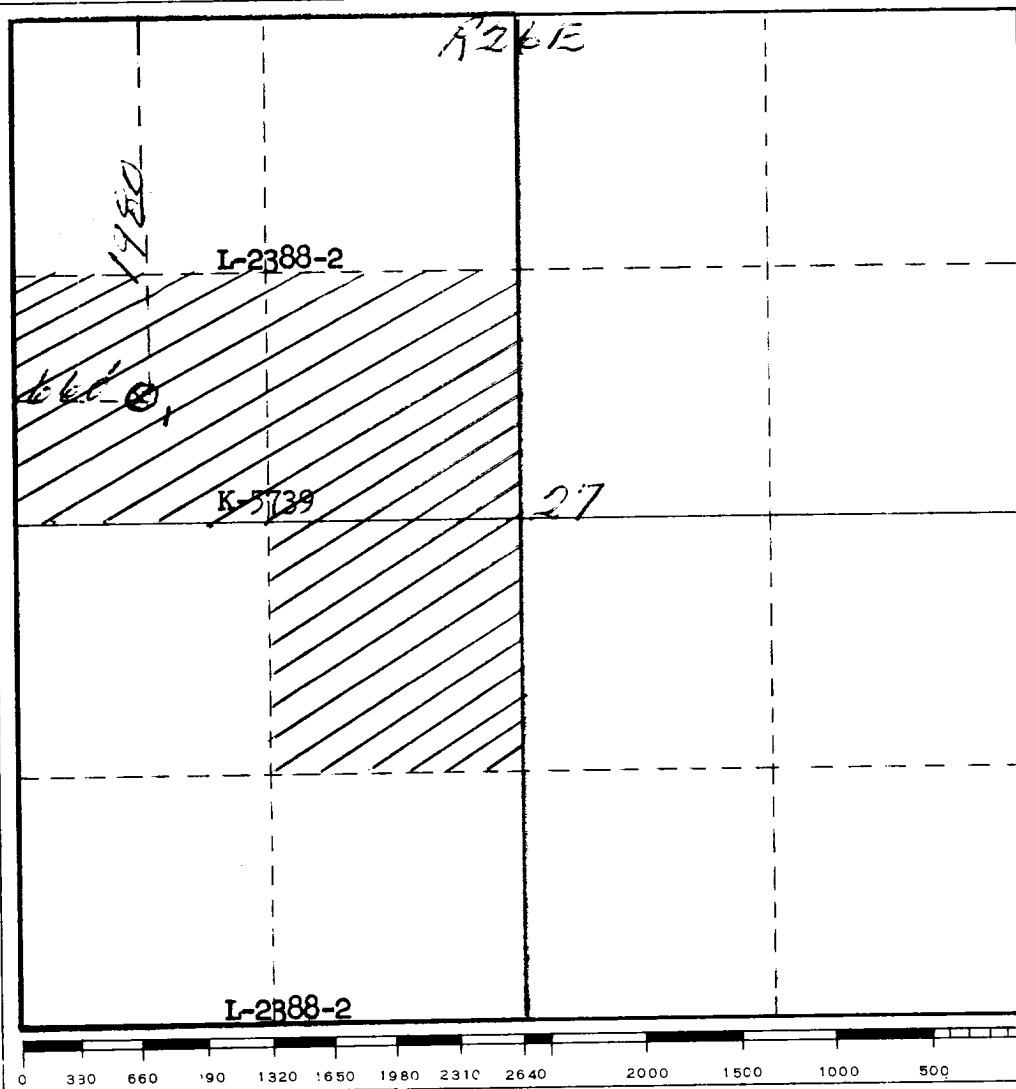

CERTIFICATION

I hereby certify that the information contained herein is true and complete to the best of my knowledge and belief.

Name **Frank Darden**
Position **President**

Company **Mercury Production Co.**

Date **January 8, 1971**

I hereby certify that the well location shown on this plat was plotted from field notes of actual surveys made by me or under my supervision and that the same is true and correct to the best of my knowledge and belief.

Date Surveyed **5-10-71**
Registered Professional Engineer
and/or Land Surveyor

Certificate No. **542**

Lease Ownership
Lease No.

Working Interest

Royalty

O.R.R.

L-2388-2

Mercury Production Co.

State

G. Dee Williamson

K-5739

Mercury Production Co.

State

M. A. Smith
Geo. Q. McGown
G. Dee Williamson