

# RECEIVED

NEW MEXICO OIL CONSERVATION COMMISSION

FEB 9 1970

30-005-60113

Form 1-65  
Revised 1-65

1	2	3	4	5	6	7	8	9	10
11	12	13	14	15	16	17	18	19	20
21	22	23	24	25	26	27	28	29	30
31	32	33	34	35	36	37	38	39	40
41	42	43	44	45	46	47	48	49	50

## APPLICATION FOR PERMIT TO DRILL, DEEPEN, OR PLUG BACK

Type of Well DRILL <input checked="" type="checkbox"/> DEEPEN <input type="checkbox"/> PLUG BACK <input type="checkbox"/> GAS WELL <input type="checkbox"/> OTHER <input type="checkbox"/> SINGLE ZONE <input checked="" type="checkbox"/> MULTIPLE ZONE <input type="checkbox"/>		5A. Indicate Type of Lease STATE <input checked="" type="checkbox"/> FEE <input type="checkbox"/> 5. State Oil & Gas Lease No. K-175
Name of Operator Hans Oil Company		7. Unit Agreement Name 8. Farm or Lease Name Bell Stat.
Address Box 1515, Roswell, New Mexico 88201		9. Well No. 1
Location Section <u>P</u> Located <u>660</u> FEET FROM THE <u>South</u> LINE <u>0</u> FEET FROM THE <u>East</u> LINE OF SEC. <u>2</u> TWP. <u>14-S</u> RGE. <u>28-E</u> NMPM		10. Field and Pool, or Wildcat Wildcat
11. County Chaves		
19. Proposed Depth 2000'		19A. Formation San Andres
20. Rotary or C.T. Cable Tool		
21. Elevations (Show whether DF, RT, etc.) 3615' DF	21A. Kind & Status Plug. Bond State Wide	21B. Drilling Contractor 22. Approx. Date Work will start Feb. 10, 1970

### PROPOSED CASING AND CEMENT PROGRAM

SIZE OF HOLE	SIZE OF CASING	WEIGHT PER FOOT	SETTING DEPTH	SACKS OF CEMENT	EST. TOP
5"	12-3/4"	42#	250'		Circulate
8"	5-1/2"	14#	2000'	100	1365'

It is proposed that the captioned well be drilled with cable tools to a total depth of 2,000 feet in the San Andres Formation and that if commercial oil or gas production is encountered that the proposed casing be followed and that the well be perforated and stimulated as proposed.

APPROVAL VALID  
FOR 90 DAYS UNLESS  
DRILLING COMMENCED,

EXPIRES .....

DESCRIBE PROPOSED PROGRAM: IF PROPOSAL IS TO DEEPEN OR PLUG BACK, GIVE DATA ON PRESENT PRODUCTIVE ZONE AND PROPOSED NEW PRODUCTION PREVENTER PROGRAM, IF ANY.

The information above is true and complete to the best of my knowledge and belief.

Hans P. Schwan Title Exec. Vice President Date Feb. 6, 1970  
(This space for State Use)

APPROVED BY W. A. Gressett TITLE OIL AND GAS INSPECTOR DATE FEB 9 1970  
REMARKS OF APPROVAL, IF ANY:

**NEW MEXICO OIL CONSERVATION COMMISSION  
WELL LOCATION AND ACREAGE DEDICATION PLAT**

Form O-1  
Supersedes O-1-68  
Effective 1-1-65

All distances must be from the outer boundaries of the Section.

Owner <b>Hanson Oil Company</b>			Lease <b>Hell-State</b>		Well No. <b>1</b>
Section <b>2</b>	Township <b>14 South</b>	Range <b>28 East</b>	County <b>Chaves</b>		
Actual Footage Location of Well:					
<b>660</b> feet from the <b>South</b> line and <b>660</b> feet from the <b>East</b> line					
Ground Level Elev <b>3413</b>	Producing Formation <b>San Andres</b>	Pool <b>Wildcat</b>	Dedicated Acreage: <b>40</b> Acres		

1. Outline the acreage dedicated to the subject well by colored pencil or hachure marks on the plat below.
2. If more than one lease is dedicated to the well, outline each and identify the ownership thereof (both as to working interest and royalty).
3. If more than one lease of different ownership is dedicated to the well, have the interests of all owners been consolidated by communitization, unitization, force-pooling, etc?

☐ Yes    ☐ No    If answer is "yes," type of consolidation \_\_\_\_\_

If answer is "no," list the owners and tract descriptions which have actually been consolidated. (Use reverse side of this form if necessary.) \_\_\_\_\_

No allowable will be assigned to the well until all interests have been consolidated (by communitization, unitization, force-pooling, or otherwise) or until a non-standard unit, eliminating such interests, has been approved by the Commission.

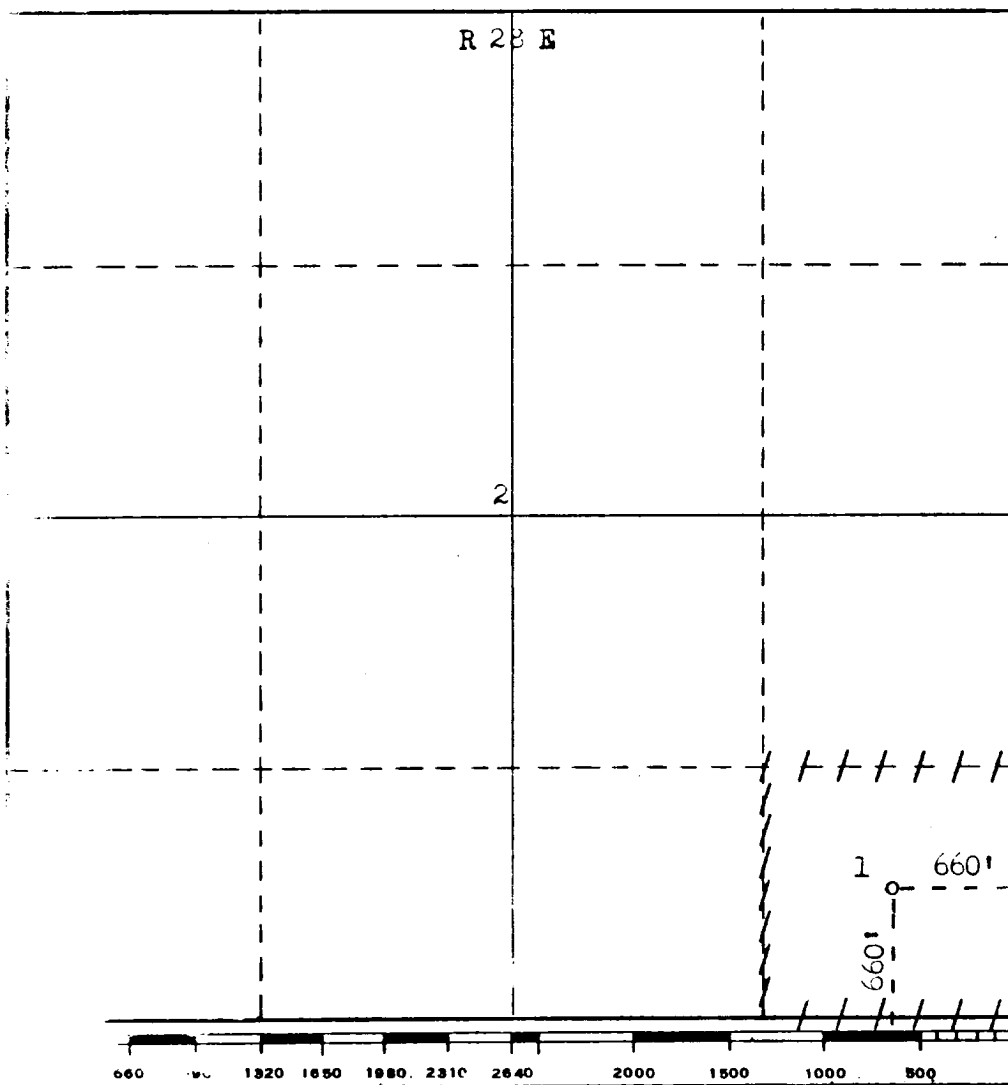

**CERTIFICATION**

I hereby certify that the information contained herein is true and complete to the best of my knowledge and belief.

Name  
**Harry J. Schuman**  
Position

**Exec. Vice President**

Company  
**Hanson Oil Company**

Date  
**February 6, 1970**

I hereby certify that the well location shown on this plat was plotted from field notes of actual surveys made by me or under my supervision, and that the same is true and correct to the best of my knowledge and belief.

Date Surveyed  
**February 5, 1970**

Registered Professional Engineer  
and/or Land Surveyor

Certificate No.

**N.M.L.S. No. 542**