

NO. OF COPIES RECEIVED	6
DISTRIBUTION	
SANTA FE	1
FILE	1
U.S.G.S.	2
LAND OFFICE	1
OPERATOR	1

# RECEIVE NEW MEXICO OIL CONSERVATION COMMISSION

JUL 15 1970

O. C. C.

ARTESIA, OFFICE

30-005-60131

Form C-101  
Revised 1-1-65

5A. Indicate Type of Lease
STATE <input checked="" type="checkbox"/> FEE <input type="checkbox"/>
5. State Oil & Gas Lease No.
K-936-1

## APPLICATION FOR PERMIT TO DRILL, DEEPEN, OR PLUG BACK

1a. Type of Work		7. Unit Agreement Name	
DRILL <input checked="" type="checkbox"/> DEEPEN <input type="checkbox"/> PLUG BACK <input type="checkbox"/>			
b. Type of Well		8. Farm or Lease Name	
OIL WELL <input checked="" type="checkbox"/> GAS WELL <input type="checkbox"/> OTHER <input type="checkbox"/> SINGLE ZONE <input type="checkbox"/> MULTIPLE ZONE <input type="checkbox"/>		State AJK	
2. Name of Operator		9. Well No.	
Elk Oil Company		2	
3. Address of Operator		10. Field and Pool, or Wildcat	
Box 310 Roswell, New Mexico 88201		Wildcat	
4. Location of Well		12. County	
UNIT LETTER <u>H</u> LOCATED <u>1980</u> FEET FROM THE <u>north</u> LINE AND <u>660</u> FEET FROM THE <u>east</u> LINE OF SEC. <u>16</u> TWP. <u>9S</u> RGE. <u>28E</u> NMPM		Chaves	
21. Elevations (Show whether DF, RT, etc.)		19. Proposed Depth	19A. Formation
3878 Ground		1500	Queen
21A. Kind & Status Plug. Bond	21B. Drilling Contractor	20. Rotary or C.T.	
Blanket	B2J	CT	
		22. Approx. Date Work will start	
		July 15, 1970	

23.

### PROPOSED CASING AND CEMENT PROGRAM

SIZE OF HOLE	SIZE OF CASING	WEIGHT PER FOOT	SETTING DEPTH	SACKS OF CEMENT	EST. TOP
10 3/4	8 5/8	32	350	100	c/r
8	5 1/2	14	1500	100	750

APPROVAL VALID  
FOR 90 DAYS UNLESS  
DRILLING COMMENCED,  
EXPIRES 10-15-70

IN ABOVE SPACE DESCRIBE PROPOSED PROGRAM: IF PROPOSAL IS TO DEEPEN OR PLUG BACK, GIVE DATA ON PRESENT PRODUCTIVE ZONE AND PROPOSED NEW PRODUCTIVE ZONE. GIVE BLOWOUT PREVENTER PROGRAM, IF ANY.

I hereby certify that the information above is true and complete to the best of my knowledge and belief.

Signed Joseph J. Kelly Title Vice President Date 7/7/70  
(This space for State Use)

APPROVED BY W. A. Grasse TITLE OIL AND GAS INSPECTOR DATE JUL 15 1970

CONDITIONS OF APPROVAL, IF ANY:

**NEW MEXICO OIL CONSERVATION COMMISSION  
WELL LOCATION AND ACREAGE DEDICATION PLAT**

Form C-102  
Supersedes C-128  
Effective 1-1-65

All distances must be from the outer boundaries of the Section.

Operator <b>ELK OIL COMPANY</b>			Lease <i>State A J K</i>		Well No. <b>2</b>
Unit Letter <b>H</b>	Section <b>16</b>	Township <b>9 SOUTH</b>	Range <b>28 EAST</b>	County <b>CHAVES</b>	
Actual Footage Location of Well: <b>1980</b> feet from the <b>NORTH</b> line and <b>660</b> feet from the <b>EAST</b> line					
Ground Level Elev. <i>3878.1</i>	Producing Formation <b>QUEEN</b>		Pool <b>WILDCAT</b>	Dedicated Acreage: <b>40</b> Acres	

1. Outline the acreage dedicated to the subject well by colored pencil or hachure marks on the plat below.
2. If more than one lease is dedicated to the well, outline each and identify the ownership thereof (both as to working interest and royalty).
3. If more than one lease of different ownership is dedicated to the well, have the interests of all owners been consolidated by communitization, unitization, force-pooling, etc?

☐ Yes ☐ No If answer is "yes," type of consolidation \_\_\_\_\_

If answer is "no," list the owners and tract descriptions which have actually been consolidated. (Use reverse side of this form if necessary.) \_\_\_\_\_

No allowable will be assigned to the well until all interests have been consolidated (by communitization, forced-pooling, or otherwise) or until a non-standard unit, eliminating such interests, has been approved by the Commission.

**RECEIVED**

**JUL 15 1970**

**D.C.E.**  
**ARTESIA, NEW MEXICO**

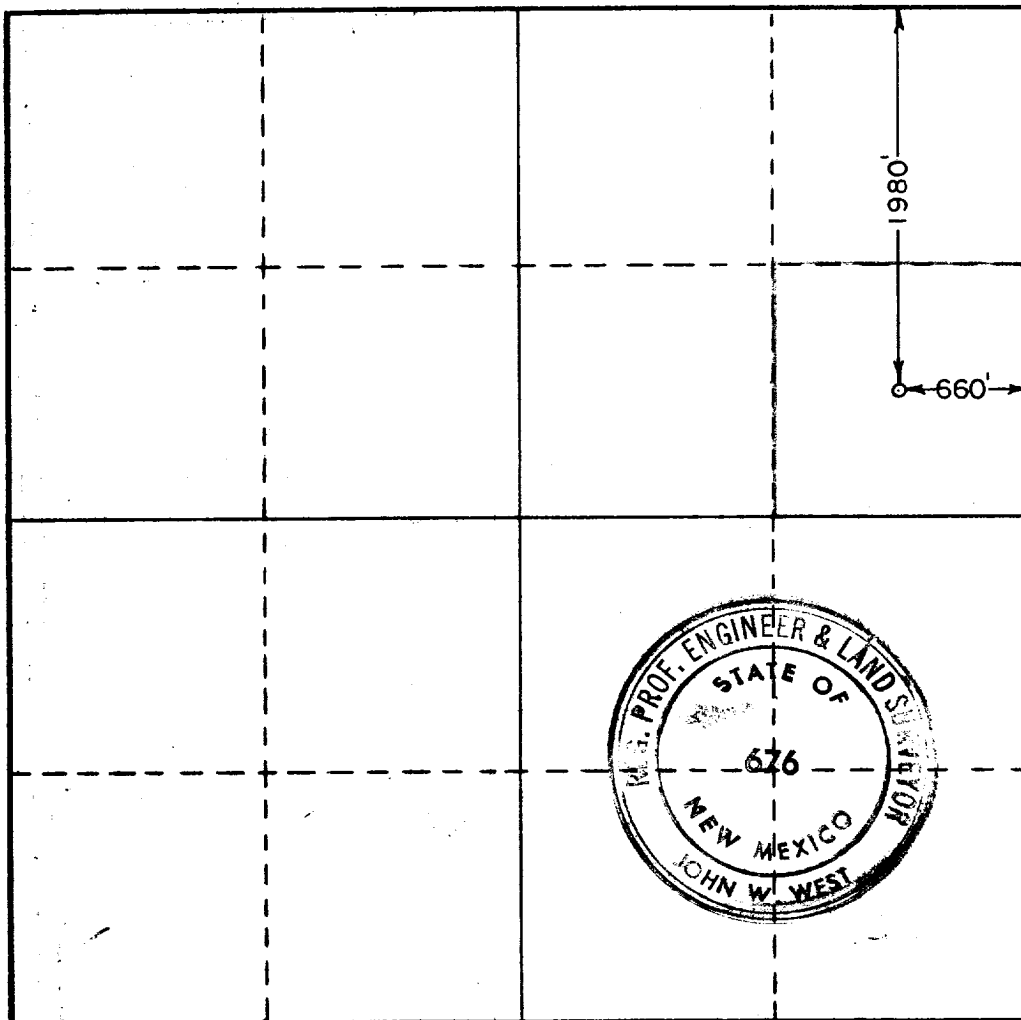

**CERTIFICATION**

I hereby certify that the information contained herein is true and complete to the best of my knowledge and belief.

*Joseph J. Kelly*  
Name

**JOSEPH J. KELLY**

Position

**VICE-PRESIDENT**

Company

**ELK OIL CO.**

Date

**JULY 13, 1970**

I hereby certify that the well location shown on this plat was plotted from field notes of actual surveys made by me or under my supervision, and that the same is true and correct to the best of my knowledge and belief.

Date Surveyed

**JUNE 25, 1970**

Registered Professional Engineer and/or Land Surveyor

*John W. West*  
Certificate No.

**676**

0 330 660 990 1320 1650 1980 2310 2640 2970 3300 3630 3960 4290 4620 4950 5280 5610 5940 6270 6600