

NEW MEXICO OIL CONSERVATION COMMISSION
WELL LOCATION AND ACREAGE DEDICATION PLAT

Form C-102
Supersedes C-128
Effective 1-4-65

All distances must be from the outer boundaries of the Section.

| | | | | |
|---|-------------------------------------|---|--|-------------------------|
| Operator SHENANDOAH OIL CORPORATION | | Lease Lead & Stevens Inc. "A" Federal | | Well No. 1 |
| Unit Letter K | Section 28 | Township 6 SOUTH | Range 27 EAST | County CHAVES |
| Actual Footage Location of Well: SOUTH 1980 feet from the WEST line and 1980 feet from the WEST line | | | | |
| Ground Level Elev. 3927.8 | Producing Formation Clare | Pool Haystack Csc. Undesignated | Dedicated Acreage: 320 Acres | |

1. Outline the acreage dedicated to the subject well by colored pencil or hatchure marks on the plat below.
2. If more than one lease is dedicated to the well, outline each and identify the ownership thereof (both as to working interest and royalty).
3. If more than one lease of different ownership is dedicated to the well, have the interests of all owners been consolidated by communitization, unitization, force-pooling, etc?

☐ Yes ☐ No If answer is "yes," type of consolidation "All one lease"

If answer is "no," list the owners and tract descriptions which have actually been consolidated. (Use reverse side of this form if necessary.)

No allowable will be assigned to the well until all interests have been consolidated (by communitization, unitization, forced-pooling, or otherwise) or until a non-standard unit, eliminating such interests, has been approved by the Commission.

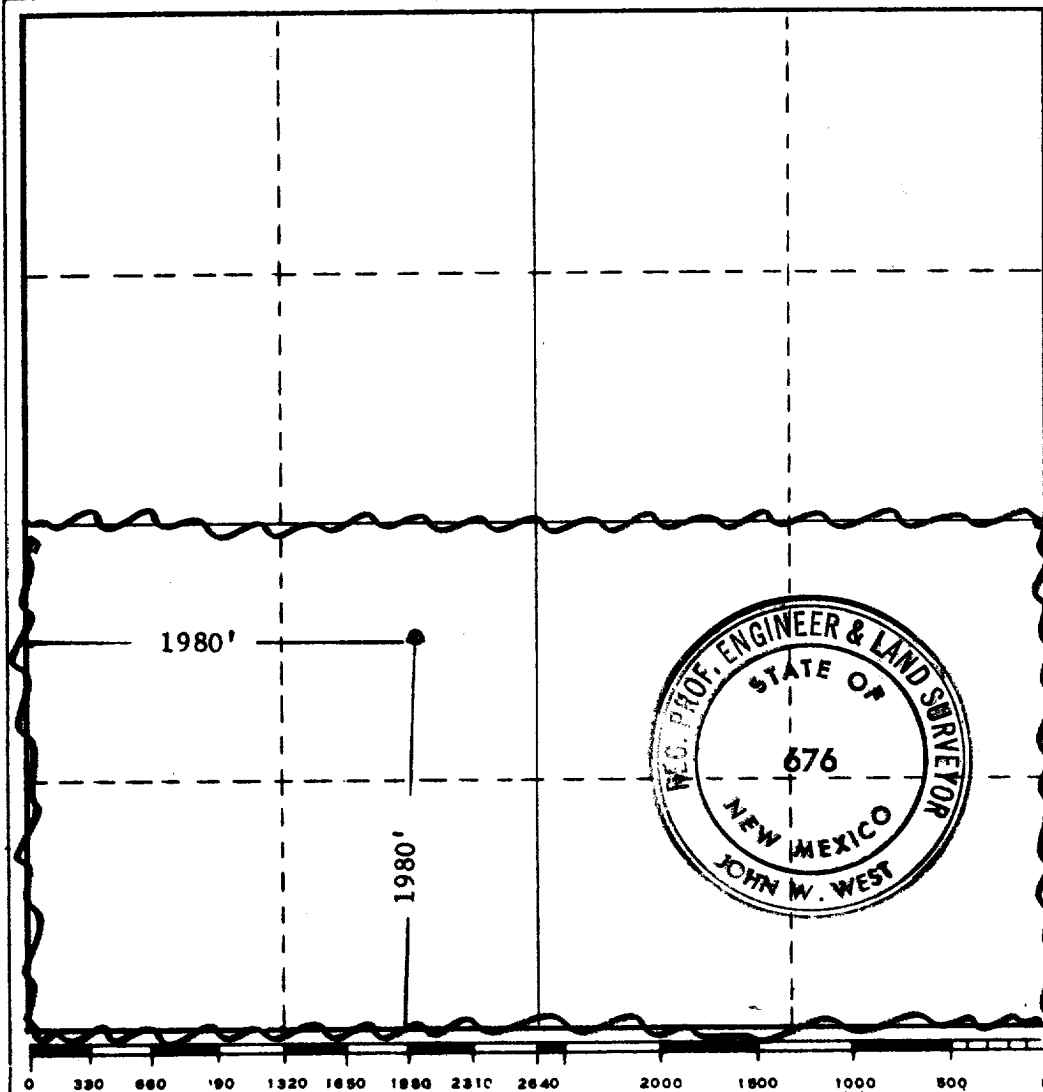

CERTIFICATION

I hereby certify that the information contained herein is true and complete to the best of my knowledge and belief.

R. L. Nabbefeld
Name
R. L. Nabbefeld
Position
Manager, Primary Operations
Company
Shenandoah Oil Corporation
Date
February 25, 1971

I hereby certify that the well location shown on this plat was plotted from field notes of ~~actual~~ surveys made by me or under my supervision, and that the same is true and correct to the best of my knowledge and belief. **MAR 1 1971**

U. S. GEOLOGICAL SURVEY
ARTESIA, NEW MEXICO

Date Surveyed
2-19-1971
Registered Professional Engineer and/or Land Surveyor

John W. West
Certificate No. **676**