

| | |
|------------------------|---|
| NO. OF COPIES RECEIVED | 6 |
| DISTRIBUTION | |
| SANTA FE | 1 |
| FILE | 1 |
| U.S.G.S. | 2 |
| LAND OFFICE | 1 |
| OPERATOR | 1 |

RECEIVED

NEW MEXICO OIL CONSERVATION COMMISSION
JUN 17 1971

O. C. C.
ARTESIA, OFFICE

30-005-60181

Form C-101
Revised 1-1-65

| |
|--|
| 5A. Indicate Type of Lease |
| STATE <input checked="" type="checkbox"/> FEE <input type="checkbox"/> |
| 5. State Oil & Gas Lease No. |
| L-5480 |

APPLICATION FOR PERMIT TO DRILL, DEEPEN, OR PLUG BACK

| | | | |
|--|-------------------------------|--------------------------------|----------------------------------|
| 1a. Type of Work | | 7. Unit Agreement Name | |
| b. Type of Well DRILL <input checked="" type="checkbox"/> DEEPEN <input type="checkbox"/> PLUG BACK <input type="checkbox"/> OIL WELL <input checked="" type="checkbox"/> GAS WELL <input type="checkbox"/> OTHER <input type="checkbox"/> SINGLE ZONE <input type="checkbox"/> MULTIPLE ZONE <input type="checkbox"/> | | 8. Farm or Lease Name | |
| 2. Name of Operator | | 9. Well No. | |
| ELK OIL COMPANY | | 3 | |
| 3. Address of Operator | | 10. Field and Pool, or Wildcat | |
| Box 310, Roswell, New Mexico | | Wildcat | |
| 4. Location of Well UNIT LETTER <u>F</u> LOCATED <u>1980</u> FEET FROM THE <u>North</u> LINE AND <u>1980</u> FEET FROM THE <u>West</u> LINE OF SEC. <u>16</u> TWP. <u>9S</u> RGE. <u>28E</u> NMPM | | 12. County | |
| | | Chaves | |
| 19. Proposed Depth | | 19A. Formation | 20. Rotary or C.T. |
| 1500 | | Queen | C.T. |
| 21. Elevations (Show whether DF, RT, etc.) | 21A. Kind & Status Plug. Bond | 21B. Drilling Contractor | 22. Approx. Date Work will start |
| 3865.5 Ground | Blanket | B & J | June 22, 1971 |

23.

PROPOSED CASING AND CEMENT PROGRAM

| SIZE OF HOLE | SIZE OF CASING | WEIGHT PER FOOT | SETTING DEPTH | SACKS OF CEMENT | EST. TOP |
|--------------|----------------|-----------------|---------------|-----------------|----------|
| 10 | 8-5/8 | 32 | 350 | 100 | Cir |
| 8 | 5-1/2 | 14 | 1500 | 100 | 750 |

APPROVAL VALID
FOR 90 DAYS UNLESS
DRILLING COMMENCED,
EXPIRES 9-17-71

IN ABOVE SPACE DESCRIBE PROPOSED PROGRAM: IF PROPOSAL IS TO DEEPEN OR PLUG BACK, GIVE DATA ON PRESENT PRODUCTIVE ZONE AND PROPOSED NEW PRODUCTIVE ZONE, GIVE BLOWOUT PREVENTER PROGRAM, IF ANY.

I hereby certify that the information above is true and complete to the best of my knowledge and belief.

Signed [Signature] Title Vice President Date June 16, 1971
(This space for State Use)

APPROVED BY _____ TITLE OIL AND GAS INSPECTOR DATE JUN 18 1971
CONDITIONS OF APPROVAL, IF ANY:

**NEW MEXICO OIL CONSERVATION COMMISSION
WELL LOCATION AND ACREAGE DEDICATION PLAT**

Form C-102
Supersedes C-128
Effective 1-1-65

All distances must be from the outer boundaries of the Section.

| | | | | | |
|--|-------------------------------------|----------------------------|-----------------------------|-------------------------|--------------------------------------|
| Operator ELK OIL CO. | | | Lease STATE "AJK" | | Well No. 3 |
| Unit Letter F | Section 16 | Township 9 SOUTH | Range 28 EAST | County CHAVES | |
| Actual Footage Location of Well: 1980 feet from the NORTH line and 1980 feet from the WEST line | | | | | |
| Ground Level Elev. 3865.5 | Producing Formation QUEEN | | Pool WILDCAT | | Dedicated Acreage 40 Acres |

1. Outline the acreage dedicated to the subject well by colored pencil or hatchure marks on the plat below.
2. If more than one lease is dedicated to the well, outline each and identify the ownership thereof (both as to working interest and royalty).
3. If more than one lease of different ownership is dedicated to the well, have the interests of all owners been consolidated by communitization, unitization, force-pooling, etc?

RECEIVED

☐ Yes ☐ No If answer is "yes," type of consolidation _____

JUN 17 1971

If answer is "no," list the owners and tract descriptions which have actually been consolidated. (Use reverse side of this form if necessary.) _____

No allowable will be assigned to the well until all interests have been consolidated (by communitization, forced-pooling, or otherwise) or until a non-standard unit, eliminating such interests, has been approved by the Commission.

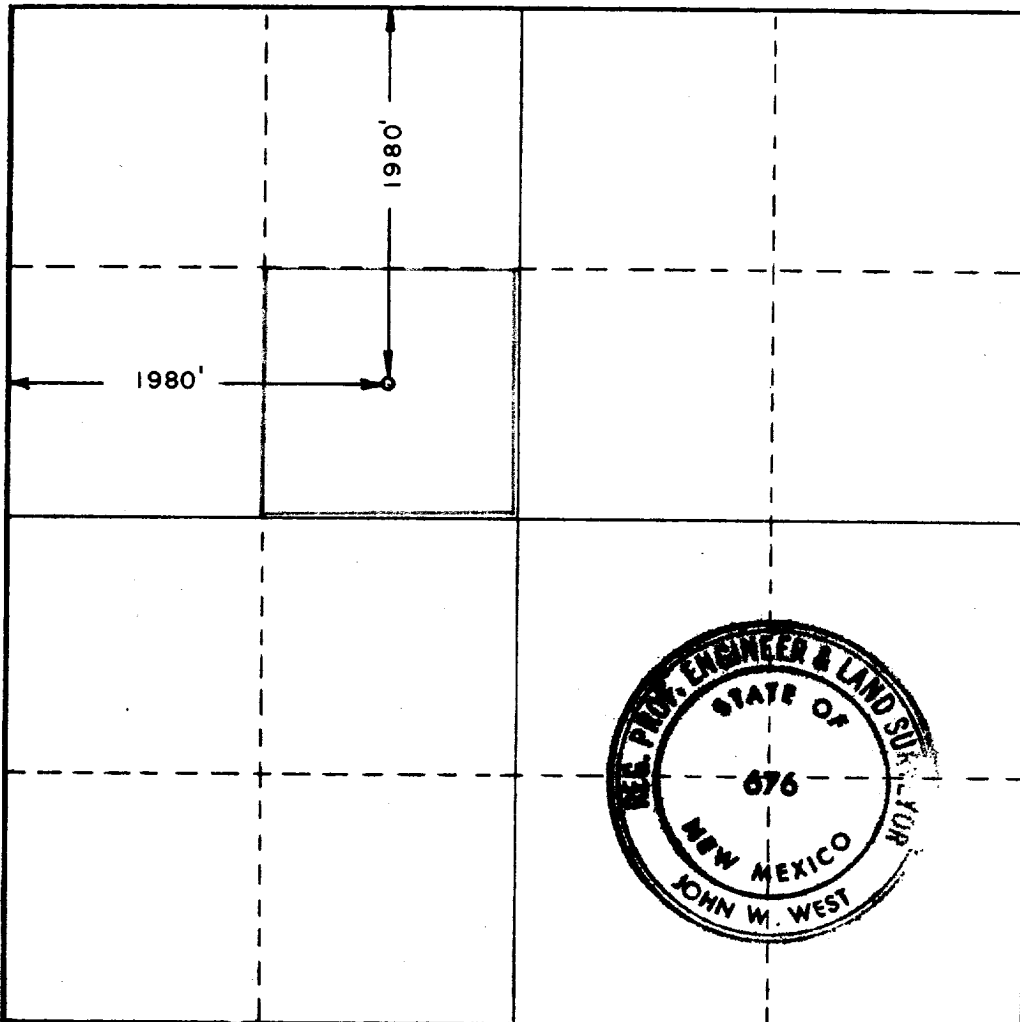

CERTIFICATION

I hereby certify that the information contained herein is true and complete to the best of my knowledge and belief.
Joseph J. Kelly

Vice President

Elk Oil Company

June 14, 1971

Date _____
Joseph J. Kelly

I hereby certify that the well location shown on this plat was plotted from field notes of actual surveys made by me or under my supervision, and that the same is true and correct to the best of my knowledge and belief.

Date Surveyed
JUNE 4, 1971

Registered Professional Engineer and/or Land Surveyor

John W. West
Certificate No. **676**

0 330 660 990 1320 1650 1980 2310 2640 2970 3300 3630 3960 4290 4620 4950 5280 5610 5940 6270 6600