

UNITED STATES
DEPARTMENT OF THE INTERIOR
GEOLOGICAL SURVEY

30-005-60208

5. LEASE DESIGNATION AND SERIAL NO.

NM 12406

6. IF INDIAN, ALLOTTEE OR TRIBE NAME

7. UNIT AGREEMENT NAME

NORTH KING CAMP UNIT

8. FARM OR LEASE NAME

9. WELL NO.

6

10. FIELD AND POOL, OR WILDCAT

WILDCAT

11. SEC., T., R., M., OR BLK.
AND SURVEY OR AREA

Sec. 17-T13S-R29E

12. COUNTY OR PARISH

13. STATE

CHAVES

N. M.

1a. TYPE OF WORK

DRILL ☒REDEEPENED ☒ PLUG BACK ☐

b. TYPE OF WELL

OIL
WELL ☒GAS
WELL ☐

OTHER

SINGLE
ZONE ☐MULTIPLE
ZONE ☐

2. NAME OF OPERATOR

JACK L. McCLELLAN

3. ADDRESS OF OPERATOR

P. O. Box 848, Roswell, NEW MEXICO 88201

4. LOCATION OF WELL (Report location clearly and in accordance with any State requirements.)*

At surface

1980' FN & EL

At proposed prod. zone

14. DISTANCE IN MILES AND DIRECTION FROM NEAREST TOWN OR POST OFFICE*

15 MILES EAST OF HAGERMAN

15. DISTANCE FROM PROPOSED*

LOCATION TO NEAREST
PROPERTY OR LEASE LINE, FT.
(Also to nearest drlg. unit line, if any)

1980'

16. NO. OF ACRES IN LEASE

160

17. NO. OF ACRES ASSIGNED
TO THIS WELL

40

18. DISTANCE FROM PROPOSED LOCATION*
TO NEAREST WELL, DRILLING, COMPLETED,
OR APPLIED FOR, ON THIS LEASE, FT.

19. PROPOSED DEPTH

1600'

20. ROTARY OR CABLE TOOLS

CABLE TOOLS

21. ELEVATIONS (Show whether DF, RT, GR, etc.)

3677' G.L.

22. APPROX. DATE WORK WILL START*

FEBRUARY 22, 1972

23.

PROPOSED CASING AND CEMENTING PROGRAM

SIZE OF HOLE	SIZE OF CASING	WEIGHT PER FOOT	SETTING DEPTH	QUANTITY OF CEMENT
12 1/4"	8-5/8"	20 LB.	240'	150 SX CIRCULATED
8"	5-1/2"	11.5 LB.	1600'	150 SX

PROPOSE TO DRILL TO APPROXIMATELY 1600' TO TEST THE QUEEN AND PENROSE SANDS.

IF PRODUCTIVE, WILL RUN PIPE AND ATTEMPT COMPLETION.

CORTEZ DRILLING AND OPERATING COMPANY, INC., Post Office Box 848,
ROSWELL, NEW MEXICO, WILL BE THE CONTRACTOR.

IN ABOVE SPACE DESCRIBE PROPOSED PROGRAM: If proposal is to deepen or plug back, give data on present productive zone and proposed new productive zone. If proposal is to drill or deepen directionally, give pertinent data on subsurface locations and measured and true vertical depths. Give blowout preventer program, if any.

24.

SIGNED

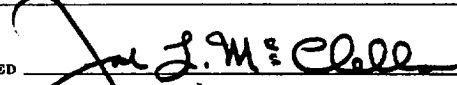

TITLE

OPERATOR

DATE

2-11-72

(This space for Federal or State office use)

PERMIT NO.

APPROVAL DATE

FEB 15 1972

DISTRICT ENGINEER

APPROVED BY



TITLE

DATE

FEB 15 1972

CONDITIONS OF APPROVAL, IF ANY:

**NEW MEXICO OIL CONSERVATION COMMISSION
WELL LOCATION AND ACREAGE DEDICATION PLAT**

Form C-102
Supersedes C-128
Effective 1-1-65

All distances must be from the outer boundaries of the Section.

Operator JACK L. MCCLELLAN			Lease NORTH KING CAMP UNIT		Well No. 6
Unit Letter G	Section 17	Township 13 SOUTH	Range 29 EAST	County CHAVES	
Actual Footage Location of Well: 1980 feet from the NORTH line and 1980 feet from the EAST line					
Ground Level Elev. 3677⁰	Producing Formation QUEEN	Pool WILDCAT	Dedicated Acreage 40		

1. Outline the acreage dedicated to the subject well by colored pencil or hatchure marks on the plat below.
2. If more than one lease is dedicated to the well, outline each and identify the ownership thereof (both as to working interest and royalty).
3. If more than one lease of different ownership is dedicated to the well, have the interests of all owners been consolidated by communitization, unitization, force-pooling, etc?

☐ Yes ☐ No If answer is "yes," type of consolidation _____

If answer is "no," list the owners and tract descriptions which have actually been consolidated. (Use reverse side of this form if necessary.) _____

No allowable will be assigned to the well until all interests have been consolidated (by communitization, unitization, forced-pooling, or otherwise) or until a non-standard unit, eliminating such interests, has been approved by the Commission.

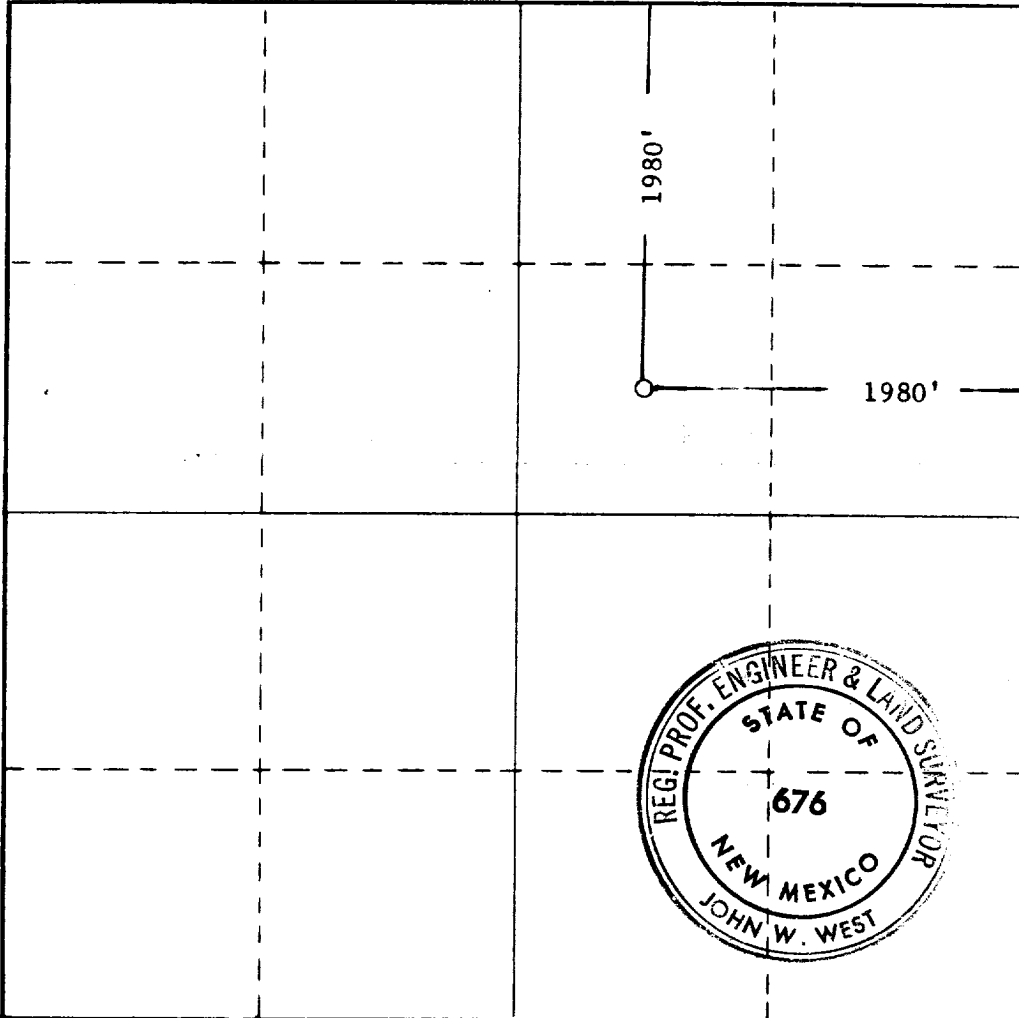

CERTIFICATION

I hereby certify that the information contained herein is true and complete to the best of my knowledge and belief.

Jack L. McClellan
Name

JACK L. MCCLELLAN

Position

OPERATOR

Company

JACK L. MCCLELLAN

Date

FEBRUARY 11, 1972

RECEIVED

I hereby certify that the well location shown on this plat is the location in the field notes of actual surveys made by me or under my supervision and that the same is true to the best of my knowledge and belief.

Date Surveyed

2-6-1972

Registered Professional Engineer and/or Land Surveyor

John W. West
Certificate No. **676**

